

COUNTY COMMISSION MEETING - JANUARY 20, 1997

REGULAR SESSION

BE IT REMEMBERED THAT:

COUNTY COMMISSION MET PURSUANT TO ADJOURNMENT IN REGULAR SESSION OF THE SULLIVAN COUNTY BOARD OF COMMISSIONERS THIS MONDAY MORNING, JANUARY 20, 1997, 9:00 O'CLOCK A. M., IN BLOUNTVILLE, TENNESSEE. PRESENT AND PRESIDING WAS HONORABLE GIL HODGES, COUNTY EXECUTIVE, GAY B. FEATHERS, COUNTY CLERK AND KEITH CARR, SHERIFF OF SAID BOARD OF COMMISSIONERS OF SULLIVAN COUNTY, TO WIT:

The meeting was called to order by County Executive, Gil Hodges. Commissioner Aubrey Kiser gave the invocation and pledge to the flag was led by County Executive, Gil Hodges.

Commissioners present and answering roll call are as follows:

CAROL BELCHER	JACK JONES
JAMES R. "JIM" BLALOCK	JAMES L. KING, JR.
BRYAN K. BOYD	AUBREY L. KISER, JR.
JUNE CARTER	CARL KRELL
RAYMOND C. CONKIN, JR.	DWIGHT MASON
TOM DANIEL	GARY MAYES
O. W. FERGUSON	WAYNE MCCONNNELL
MIKE GONCE	PAUL MILHORN
RALPH P. HARR	RONALD E. REEDY
EDLEY HICKS	MICHAEL E. SURGENOR
PAT HUBBARD	MARK A. VANCE
MARVIN HYATT	EDDIE WILLIAMS

24 Present

Motion was made by Commissioner Mike Surgeonr and second by Commissioner Marvin Hyatt to approve the minutes of the regular session of County Commission held on December 16, 1996. This motion was approved by voice vote of the Commission.

The following pages indicates the action taken by the Commission on re-zoning requests, Notary applicants, Notary Bonds, Quarterly Reports and resolutions.

3/8

RESOLUTION NUMBER 1

TO THE HONORABLE GIL HODGES, COUNTY EXECUTIVE, AND THE MEMBERS OF THE SULLIVAN COUNTY BOARD OF COMMISSIONERS IN Regular SESSION THIS THE 20th DAY OF January 1997.

RESOLUTION AUTHORIZING The Sullivan County Board of Commissioners to Consider Amendments to the Sullivan County Zoning Resolution as Amended

WHEREAS, TENNESSEE CODE ANNOTATED; SECTION _____, AUTHORIZES COUNTIES TO _____

NOW, THEREFORE BE IT RESOLVED by the Board of County Commissioners of Sullivan County, Tennessee, assembled in Regular Session on the 20th day of January 1996.

THAT WHEREAS, The attached rezoning petitions have been duly initiated, have been before the Planning Commission (recommendations enclosed), and have received a public hearing as required; and

WHEREAS, Such rezoning petitions will require an amendment to the Sullivan County Zoning Resolution;

NOW THEREFORE BE IT RESOLVED, That the Sullivan County Board of Commissioners consider the attached rezoning petitions and vote upon the proposed amendments, individually or otherwise at the discretion of the Commission, by roll call vote and that the vote be valid and binding and that any necessary amendments to the official zoning map be made so.

All resolutions in conflict herewith be and the same rescinded insofar as such conflict exist.

This resolution shall become effective on _____, 19__, the public welfare requiring it.

Duly passed and approved this 20th day of January, 1997

Attested: Ray B. Feather Date: 1-20-97 Gil Hodges Date: 1-20-97
County Clerk County Executive

INTRODUCED BY COMMISSIONER Belcher ESTIMATED COST: _____
SECONDED BY COMMISSIONER Kiser FUND: _____

Committee Action	Approved	Disapproved	Deferred	Date
Administrative				
Budget				
Executive				

Commission Action	Aye	Nay	Pass	Absent	Total
Roll Call					
Voice Vote	X				

COMMENTS: Motion by: Commisisoner Harr
2nd by: Commissioner Hyatt TO APPROVE

APPROVED 1/20/97 voice vote

SULLIVAN COUNTY BOARD OF COUNTY COMMISSIONERS

January 20, 1997

Consider the following:

- (1) **File # 11/96-2** A request by Living Praise Assembly of God to rezone the property described below from R-1 to PBD:

REQUEST APPROVED 1/20/97 Roll Call 15 Aye, 9 Nay

"Being a tract of land located in the 10th Civil District at the intersection of Fleming Road, Lucy Road and Ernie Drive and further described as parcel 33.00 group A map 14F of the Sullivan County Tax Maps."

The Planning Commission took the following action:

"File No. 11/96-2, Living Praise Assembly of God Request

Living Praise Assembly of God requested that a tract of land located in the 10th Civil District at the intersection of Fleming Road, Lucy Road and Ernie Drive be rezoned from R-1 to PBD to permit the location of future commercial development.

Bob Yates and others were present representing the applicant and spoke in support of the request. No opposition was presented. Staff noted that the area surrounding the request was predominately single family home development and that existing business uses were existing prior to adoption of zoning. Staff stated that the proposed zoning was incompatible with the existing land use patterns and recommended the request be denied.

Motion Barnes, second Kiser to deny the request as recommended by staff. Vote in favor of the motion unanimous.

- (2) **File # 12/96-1** A request by Charles D. Bernard to rezone the property described below from R-1 to B-3:

REQUEST DISAPPROVED 1/20/97 ROLL CALL 11 Aye, 13 Nay

"Being a tract of land located in the 13th Civil District on the south side of S. Eastman Road approximately 1900 feet north of its intersection with S. Wilcox Drive and further described as parcel 1.20 group A map 76B of the Sullivan County Tax Maps."

The Planning Commission took the following action:

"File No. 12/96-1, Charles D. Bernard Request

Charles D. Bernard requested that a tract of land located in the 13th Civil District on the south side of S. Eastman Road approximately 1900 feet north of its intersection with S. Wilcox Drive be rezoned from R-1 to B-3 to permit the location of retail sales.

The applicant was present and spoke in support of the request. No opposition was presented. Staff noted that the area surrounding the request was single family home development and that all existing non residential uses were existing prior to adoption of zoning. Staff stated that the proposed zoning was incompatible with existing land use patterns and that potential traffic and parking problems at the site would negatively impact the neighborhood. Staff recommended the request be denied.

Motion Brown, second Barnes to deny the request as recommended by staff. Vote in favor of the motion unanimous.

VIRGINIA

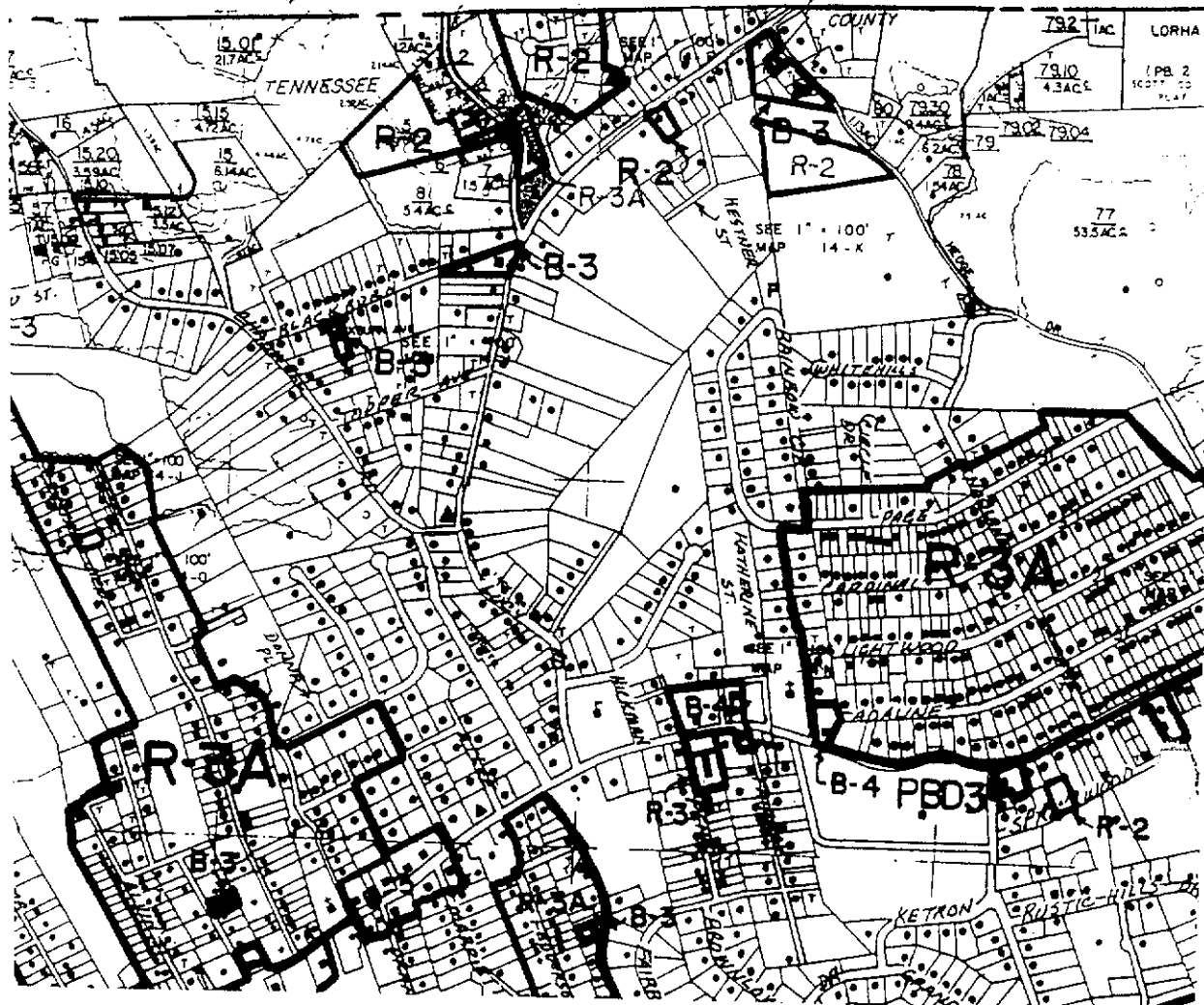

REZONING REQUEST Sullivan County, Tennessee From R-1 To PBD

1" = 800'
 Scale

Lot Size: 203' x 150'
 Civil District: 10

NORTH

November 19, 1996

File # 11/96-2

NORTH

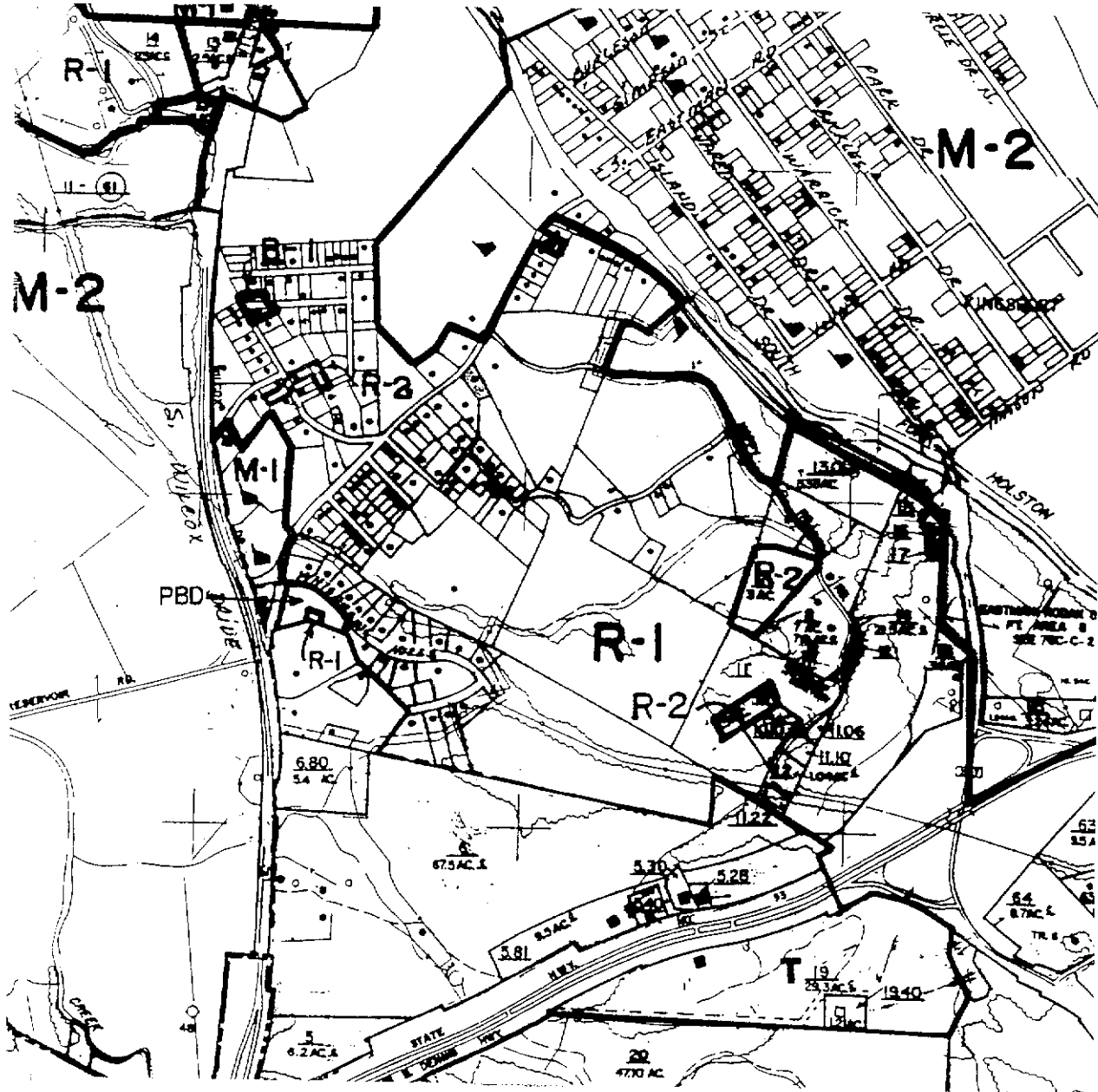

STATE OF TENNESSEE
COUNTY OF SULLIVAN

JANUARY 20, 1997

ELECTION OF NOTARIES

Linda Corbitt /
Beverly K. Crawford
Anita L. DeBoard
F. Douglas Ellis
Ruth P. Ford
Denise R. Freeman
Venita A. Gaminde
Louella S. Hall
Paul A. Harr
Theresa D. Jennings
Misty Manis
D. Scott Peak
Robin Poole
Barbara J. Prater
Deborah M. Reynolds
Jimmy D. Rock
Elizabeth J. Schultz
Janice Shaffer
Linda A. Smith
Stephen C. Stanfield
Elaine S. White

Upon motion made by Commissioner Ralph Harr and second by
Commissioner Marvin Hyatt to approve the above named Notary
Applicants, said motion was approved by roll call vote of the
Commission.

24 Aye

JANUARY 20, 1997

APPROVAL OF NOTARY PUBLIC
SURETY BONDS

Charles E. Beach

Carl W. Vogel

Elizabeth Davis Beach

Todd L. Yates

Charlotte H. Blachburn

Jason Bright

John E. Childress, Jr.

Elizabeth S. Collins

Joyce Crosswhite

Murry C. Groseclose, III

Jerri R. Hale

Doris J. Harless

L. Baxter Hood

Timothy W. Hudson

Sandra L. Jones

Sandra D. King

Peggy Ann Lane

Myers N. Massengill

Hilda Louise McKenzie

Kenneth A. Morrell

Sabrina D. Morton

Deborah R. Nelson

Leslie Ann Parsons

K. Ann Price

Allen J. Smith

David W. Tipton

Upon motion made by Commissioner
Ralph Harr and second by Commissioner
Marvin Hyatt to approve the Notary
Bonds of the persons listed hereon,
said motion was approved by roll call
vote of the Commission. 24 Aye

APPROVAL

OF

QUARTERLY REPORTS

) Upon motion made by Commissioner Harr and
) second by Commissioner Hyatt to approve all
) quarterly reports submitted for approval,
) said motion was approved by voice vote of
) the Commission.

324

SUBSTITUTE

RESOLUTION NUMBER 52

TO THE HONORABLE GIL HODGES, COUNTY EXECUTIVE, AND THE MEMBERS OF THE SULLIVAN COUNTY BOARD OF COMMISSIONERS IN Regular SESSION THIS THE 16th DAY OF December 19 96.

RESOLUTION AUTHORIZING Transfer of Vacant State Employee Position to County Employee Position [Administrative Services Assistant]

WHEREAS, TENNESSEE CODE ANNOTATED; SECTION _____, AUTHORIZES COUNTIES TO _____

NOW, THEREFORE BE IT RESOLVED by the Board of County Commissioners of Sullivan County, Tennessee, assembled in Regular Session on the 16th day of December 19 96.

THAT WHEREAS The Administrative Services Assistant position at the Sullivan County Health department is vacant, and

WHEREAS Any vacancy occurring in a State position may become a County position if approved by the Board of Commissioners.

NOW, THEREFORE BE IT RESOLVED That the Administrative Services Assistant position be transferred from the State of Tennessee to Sullivan County and that funding in the FY 1996-97 budget for this position be allocated as follows:

FROM: 55110.300 [Local Health Department/Contracted Services] \$31,488.24

TO: 55110.100 Personnel \$24,000.00

58600.201 Matching FICA 1,488.00

58600.204 TN Consolidated Retirement 1,773.60

58600.212 Matching Medicare 348.00

58600.206 Employee Life Insurance 38.64

58600.207 Employee Health Insurance 3,574.68

58600.208 Employee Dental Insurance 265.32

AMEND:

Comm. Blalock-If State ceases to fund their portion of this position, it will be terminated.

AMEND: All resolutions in conflict herewith be and the same rescinded insofar as such conflict exist.

Motion by:

Comm. Boyd

2nd by: The Health Department no longer participate in the Sex Education program in the schools after end of this school year.

Comm. Vance 1/20/97 Duly passed and approved this 20th day of January 1997

Bay B. Feathers
County Clerk

Date: 1-20-97 *Gil Hodges*
County Executive Date: 1-20-97

INTRODUCED BY COMMISSIONER Hicks ESTIMATED COST: \$31,488.24
SECONDED BY COMMISSIONER Hyatt FUND: Health Department

Committee Action	Approved	Disapproved	Deferred	Date
Administrative	✓			12-2-96
Budget				
Executive	✓			12-4-96

Commission Action	Aye	Nay	Pass	Absent	Total
Roll Call	17	7			
Voice Vote					

COMMENTS: First Reading 11/18/96

Motion by: Comm. Blalock, 2nd by: Comm. Boyd TO DEFER

DEFERRED 12/16/96 Motion by: Comm. Mayes, 2nd by: Comm. Blalock

TO DEFER FAILED 1/20/97 ROLL CALL APPROVED AS AMENDED 1/20/97

AMENDMENT PASSED 1/20/97 ROLL CALL 15 Aye, 8 Nay, 1 Pass

RESOLUTION NUMBER # 3

TO THE HONORABLE GIL HODGES, COUNTY EXECUTIVE, AND THE MEMBERS OF THE SULLIVAN COUNTY BOARD OF COMMISSIONERS IN Regular SESSION THIS THE 16th DAY OF December 1996.

RESOLUTION AUTHORIZING Requesting Elected Officials to Define a Human Resources Department and its Duties

WHEREAS, TENNESSEE CODE ANNOTATED; SECTION _____ AUTHORIZES COUNTIES TO _____

NOW, THEREFORE BE IT RESOLVED by the Board of County Commissioners of Sullivan County, Tennessee, assembled in Regular Session on the 16th day of December 1996.

THAT WHEREAS, Situations continually occur, requiring time and resources by the county commission, elected officials and their staffs, that could be handled by a Human Resources Department, and

WHEREAS, In the past it has required court actions to settle some of the problems, and

WHEREAS, In the past several Resolutions have addressed the creation of a Human Resources Department, each time lacking enough support to pass,

NOW, Therefore be it resolved that the task of defining a Human Resources Department and its duties be assigned to the Elected Officials, or their representatives, [except the School Department] with the County Executive acting as chairperson, and

FURTHER BE IT RESOLVED, That this task force report back to the County Commission on or before the March, 1997 stated meeting, giving the Commission time to review and fund a Human Resources Department, if passed, by the budget year of 1997-1998,

All resolutions in conflict herewith be and the same rescinded insofar as such conflict exist.

This resolution shall become effective on _____, 19__, the public welfare requiring it.

Duly passed and approved this 20th day of January, 1997

Attested:

County Clerk

Date: 1-20-97

County Executive

Date: 1-20-97

INTRODUCED BY COMMISSIONER Blalock ESTIMATED COST: _____
SECONDED BY COMMISSIONER Daniel FUND: _____

Committee Action	Approved	Disapproved	Deferred	Date
Administrative	✓			1/6/97
Budget				
Executive	✓			1/4/97

Commission Action	Aye	Nay	Pass	Absent	Total
Roll Call	23			1	
Voice Vote					

COMMENTS: FIRST READING : 12/16/96 APPROVED 1/20/97 ROLL CALL

TO THE HONORABLE GIL HODGES, COUNTY EXECUTIVE, AND THE MEMBERS OF THE SULLIVAN COUNTY BOARD OF COMMISSIONERS IN Regular SESSION THIS THE 16th DAY OF December 19 96.

RESOLUTION AUTHORIZING Sullivan County Board of Commissioners to Establish a Committee and Strategic [Long Range] Plan for Sullivan County

WHEREAS, TENNESSEE CODE ANNOTATED; SECTION _____ AUTHORIZES COUNTIES TO _____

NOW, THEREFORE BE IT RESOLVED by the Board of County Commissioners of Sullivan County, Tennessee, assembled in Regular Session on the 16th day of December 19 96

THAT WHEREAS, Based on the existing County Budget, on-going fund requests, plus the problems/proposals facing Sullivan County, a customer focused long range plan is needed. This strategic plan should provide future direction for Sullivan County with a proactive approach to management and planning rather than a reactive approach. Existing funding priorities may not represent the wishes of the Sullivan County tax payers. Therefore, criteria like (future investment versus non-investment) and resulting priorities should be established with tax payer input, and

WHEREAS, The Sullivan County Commission should form a committee to prepare a macro level [to be defined by steering committee members], long range financial plan for Sullivan County. This plan should contain a five (5) year projection of revenues and a five (5) year projection of appropriations or expenditures [with supporting objectives/goals and ultimate approval by the full County Commission], and

~~WHEREAS, A steering committee should be appointed to develop this strategic [long range] plan. The steering committee should be comprised of fifteen (15) Sullivan County citizens nominated by the Commissioner(s) from each Commission District, with the number of representatives based on the population of each district [see attached listing]. Input to the steering committee and the strategic plan should be made by Commissioners, all other committee's [i.e., Insurance Library, Consolidated Services, etc.] plus all Sullivan County Departments, and the tax payers of Sullivan County. Detailed type guidance to the steering committee will be required from the Director, Accounts and Budgets. (SEE ATTACHED AMENDMENT FOR THIS PARAGRAPH).~~

NOW THEREFORE BE IT RESOLVED, That the Sullivan County Board of Commissioners authorizes the establishment of a committee and strategic [long range] plan as heretofore described in this Resolution.

All resolutions in conflict herewith be and the same rescinded insofar as such conflict exist.

This resolution shall become effective on _____, 19____, the public welfare requiring it.

Duly passed and approved this 20th day of January, 19 97

Attested:

County Clerk

Date: 1-20-97

County Executive

Date: 1-20-97

INTRODUCED BY COMMISSIONER Krell ESTIMATED COST: _____
SECONDED BY COMMISSIONER Carter FUND: _____

Committee Action	Approved	Disapproved	Deferred	Date
Administrative	✓			1/4/97
Budget				
Executive				

AMENDMENTS TO RESOLUTION NUMBER 4

1/20/97

PARAGRAPH (3)

WHEREAS, A steering committee should be appointed to develop this strategic (long range) plan. The steering committee should be comprised of eleven (11) Sullivan County citizens appointed by the Commissioner(s) from each Commission District, AND, one representative appointed by each of the seven constitutionally elected offices, the Highway Department, Education Department and Health Department plus the County Attorney to serve as an ex-officio member - 21 members and the County Attorney. The Chairperson will be decided by the Steering Committee. Input to the steering committee and the strategic plan should be made by Commissioners, all other committee's (i.e Insurance, Library, Consolidated Services, etc.) plus all Sullivan County Departments and the taxpayers of Sullivan County. Detailed type guidance to the steering committee will be required from the Director of Accounts and Budgets. Status reports will be presented to the full Commission by the Steering Committee.

Commission Action	Aye	Nay	Pass	Absent	Total
Roll Call	21	3			
Voice Vote					

COMMENTS: FIRST READING 12/16/96 APPROVED AS AMENDED 1/20/97
ROLL CALL

RESOLUTION NUMBER 135

TO THE HONORABLE GIL HODGES, COUNTY EXECUTIVE, AND THE MEMBERS OF THE SULLIVAN COUNTY BOARD OF COMMISSIONERS IN Regular SESSION THIS THE 16th DAY OF December 19 96.

RESOLUTION AUTHORIZING Amending Sullivan County Library Budget for FY 1996-97 for the Purpose of Increasing Certain Employee Wages and Work Schedules

WHEREAS, TENNESSEE CODE ANNOTATED; SECTION _____, AUTHORIZES COUNTIES TO _____

NOW, THEREFORE BE IT RESOLVED by the Board of County Commissioners of Sullivan County, Tennessee, assembled in Regular Session on the 16th day of December 19 96.

THAT WHEREAS, Sullivan County Library personnel are experiencing an increased work load due to an expanding daily circulation and in assisting patrons in the use of the Library's computer equipment, and

WHEREAS, Some part-time personnel have been employed since 1976 and are still compensated at the minimum wage level, and

WHEREAS, The Director of the Sullivan County Library, with sixteen (16) employees and five (5) branch libraries under her supervision, should be compensated with a salary equivalent to her job description,

NOW, THEREFORE BE IT RESOLVED, That the Sullivan County Board of Commissioners approves funding from General Fund/Undesignated Fund Balance (Account 39000.000) in FY 1996-97 budget to Account 56500.100 (Libraries) to be allocated as shown on the attachment.

All resolutions in conflict herewith be and the same rescinded insofar as such conflict exist.

This resolution shall become effective on _____, 19__, the public welfare requiring it.

Duly passed and approved this ____ day of _____, 19__.

Attested: _____ Date: _____ Date: _____
County Clerk County Executive

INTRODUCED BY COMMISSIONER Carter ESTIMATED COST: _____
SECONDED BY COMMISSIONER Hubbard FUND: _____

Committee Action	Approved	Disapproved	Deferred	Date
Administrative	✓			1/1/96
Budget				
Executive <i>No Action</i>				1/8/97

Commission Action	Aye	Nay	Pass	Absent	Total
Roll Call					
Voice Vote					

COMMENTS: FIRST READING 12/16/96 (WITHDRAWN) (SEE RESOLUTION 1/20/97 #15)

GAYVERN M. MOORE
323-6413

ACCOUNTS BUDGETS
SULLY COUNTY
Box 29 • Phone 323-6409
BLOUNTVILLE, TENNESSEE 37617



*Attachment
Res # 13-5*

PAYROLL &
EMPLOYEE BENEFITS

56500.100 LIBRARY 1996 - 1997 BUDGET YEAR

<u>PART-TIME ASSISTANTS TO BRANCH MANAGERS</u>	<u>YEARLY INCREASE</u>	<u>JAN/JUNE INCREASE</u>
--	------------------------	--------------------------

The following employees hours worked are changing from 969 hrs per year to 1196 hrs per year. Hourly rate from 4.75 to 5.25.

D. LEONARD	1,676.25	838.12
T. ENGLISH	1,676.25	838.12
K. BROWN	1,676.25	838.12

The following employees hours worked are changing from 780 hrs per year to 1196 hrs. per year. Hourly rate from 4.75 to 5.25.

J. FEATHERS	2,574.00	1,287.00
-------------	----------	----------

The following employees hours worked are changing from 761 hrs per year to 1196 hrs. per year. Hourly rate from 4.75 to 5.25.

	2,664.25	1,332.12
--	----------	----------

PART-TIME JANITOR

D. Rhoton 156 hrs. to 208 hrs (52 hrs	247.00	123.50
---------------------------------------	--------	--------

PART-TIME ASST. TO FULL-TIME (BOOK PROCESSING)

E. Price (1040 hrs to 1820 hrs)		
4.75 to 6.76		
\$4,940.00 to 12,303.20	7,363.20	3,681.60

FULL-TIME LIBRARIAN

K. Hamrick 2080 (\$29,155.88 to \$30,155.88)		
14.02 to 15.46		
\$1,000.00 ea. yr for 3 yrs.	1,000.00	500.00
	<u>\$18,877.20</u>	<u>\$9,438.58</u>

ABOVE PERSONNEL TO RECEIVE 100% OF ANY
FUTURE PAY INCREASES GIVEN BY THE CO.

*attach
Res # 13 5
Page 2*

		<u>YEARLY INCREASE</u>	<u>6 MOS INCREASE</u>
MATCHING FICA	\$18,877.20 x 6.20%	\$1,170.38	\$ 585.19
" " MEDICARE	\$18,877.20 x 1.45%	\$ 273.71	\$ 186.85
RETIREMENT	\$ 8,363.20 x 7.39%	\$ 618.04	\$ 309.02
MEDICAL INS. FOR FULL-TIME EMPLOYEE		\$3,574.68	\$1787.34
DENTAL "	"	\$ 265.32	\$ 132.66
LIFE "	"	\$ 38.64	\$ 19.32
		<u>\$5,940.77</u>	<u>\$3020.38</u>
 TOTAL SALARY INCREASE INCLUDING BENEFITS		 \$24,817.97	 \$12,458.96

WITHDRAWN 1/20/97 see resolution #15
315

RESOLUTION NUMBER 46

TO THE HONORABLE GIL HODGES, COUNTY EXECUTIVE, AND THE MEMBERS OF THE SULLIVAN COUNTY BOARD OF COMMISSIONERS IN Regular SESSION THIS THE 16th DAY OF December 19 96.

RESOLUTION AUTHORIZING Additional Employee for Office of the County Clerk

WHEREAS, TENNESSEE CODE ANNOTATED; SECTION _____ AUTHORIZES COUNTIES TO _____

NOW, THEREFORE BE IT RESOLVED by the Board of County Commissioners of Sullivan County, Tennessee, assembled in Regular Session on the 16th day of December 19 96

THAT WHEREAS, The Office of the County Clerk is preparing to provide an additional service to Sullivan County tax payers by issuing motor vehicle titles, and _____

WHEREAS, The State of Tennessee will reimburse the County two dollars (\$2.00) for each title issued, it being estimated that an average of 3,500 titles per month will be handled, and _____

WHEREAS, One (1) additional employee is needed to provide this service, with the employee's salary to be generated from the service fees, _____

NOW, THEREFORE BE IT RESOLVED, That the Sullivan County Board of Commissioners approves the appropriation of \$10,252.11 from Undesignated Fund Balance [Account 39000.000 to Account 52501.100 [County Clerk] to be allocated as shown on the attachment.

All resolutions in conflict herewith be and the same rescinded insofar as such conflict exist.

This resolution shall become effective on _____, 19__, the public welfare requiring it.

Duly passed and approved this 20th day of January, 19 97

Attest: B. Feathers Date: 1-20-97 Gil Hodges Date: 1-20-97
County Clerk County Executive

INTRODUCED BY COMMISSIONER King ESTIMATED COST: _____
SECONDED BY COMMISSIONER Harr FUND: _____

Committee Action	Approved	Disapproved	Deferred	Date
Administrative <u>Tabled</u>				<u>1/6/97</u>
Budget	<u>✓</u>			<u>12/11/96</u>
Executive				

Commission Action	Aye	Nay	Pass	Absent	Total
Roll Call	23			1	
Voice Vote					

COMMENTS: FIRST READING 12/16/96 APPROVED 1/20/97 Roll Call

*Attachment
Row # 146*

Amounts to support request for County Clerk - Budget amendment
for six months at \$7.00 per hour.

45510	Estimated fees generated from issuance of titles (6 months)	\$40,500.00
52501 100	County Clerk	\$ 7,280.00
58600 000	<u>Employee Benefits</u>	
68600 201	Matching FICA	\$ 451.36
58600 205	Employee & Dependent Ins.	\$1950.00
58600 204	Tennessee Consoli- dated Retirement System	\$ 465.19
58600 212	Matching Medicare	\$ 105.56
	Total Employee Benefits	<u>\$ 2,972.11</u>
	TOTAL APPROPRIATIONS AMEND	\$10,252.11

RESOLUTION NO. 167

TO THE HONORABLE GIL HODGES, COUNTY EXECUTIVE, AND THE MEMBERS OF THE SULLIVAN COUNTY BOARD OF COMMISSIONERS IN REGULAR SESSION THIS THE 16th DAY OF DECEMBER, 1996.

RESOLUTION AUTHORIZING Abandonment of Excess Right-of-Way on Moreland Drive (13th Civil District)

WHEREAS, TENNESSEE CODE ANNOTATED; SECTION _____ AUTHORIZES COUNTIES TO _____

NOW, THEREFORE BE IT RESOLVED by the Board of County Commissioners of Sullivan County, Tennessee assembled in Regular Session on the 16th day of December, 1996,

THAT, WHEREAS, George R. Greear, as the owner of Parcels 1 and 22, Block B, Tax Map 91C, has requested the abandonment of the excess right-of-way on Moreland Drive adjacent to the aforesaid parcels (Tract 1 being .60 acres, more or less, and Tract 2 being .42 acres, more or less) and has requested that said excess right-of-way be transferred to him; and

WHEREAS, transference of said property will be in accordance with the attached map entitled "Rudy's Place" for George Rudy Greear dated July 28, 1996 and will be at no expense to the county as said property owner will pay for all surveys, appraisals, deeds and recording fees; and

WHEREAS, on September 19, 1996 the Kingsport Regional Planning Commission voted to recommend to the Sullivan County Board of Commissioners that it vacate the excessive right-of-way as shown on the aforesaid map;

NOW, THEREFORE, BE IT RESOLVED that the excess right-of-way as shown on the attached map be declared abandoned and that said property be transferred to George R. Greear at no expense to Sullivan County.

FURTHER BE IT RESOLVED that the County Executive be authorized to execute a Quitclaim Deed transferring said property to George R. Greear upon approval by all parties and upon approval of said Quitclaim Deed by the Sullivan County Attorney.

Amend;
1/20/97
Comm. Hubbard

We agreed to sell to Mr. Greear at the appraised value of \$1900.00.

All resolutions in conflict herewith be and the same rescinded insofar as such conflict exist.

This resolution shall become effective on _____, 19__, the public welfare requiring it.

Duly passed and approved this 20th day of January, 19 97

Attested: Pat Hubbard
County Clerk

Date: 1-20-97 Gil Hodges
County Executive Date: 1-20-97

INTRODUCED BY COMMISSIONER Pat Hubbard ESTIMATED COST: _____
SECONDED BY COMMISSIONER James Blalock FUND: _____

Committee Action	Approved	Disapproved	Deferred	Date
Administrative <u>No Action</u>				<u>1/6/97</u>
Budget				
Executive				

RESOLUTION NO. 467
Page Two

Commission Action	Aye	Nay	Pass	Absent	Total
Roll Call	19	3	1	1	
Voice Vote					

COMMENTS: DEFERRED 12/16/96 APPROVED AS AMENDED 1/20/97
ROLL CALL

RESOLUTION NUMBER 218

TO THE HONORABLE GIL HODGES, COUNTY EXECUTIVE, AND THE MEMBERS OF THE SULLIVAN COUNTY BOARD OF COMMISSIONERS IN Regular SESSION THIS THE 16th DAY OF December 1996.

RESOLUTION AUTHORIZING Approval of the Sullivan County Road Atlas [Revised December 1, 1996]

WHEREAS, TENNESSEE CODE ANNOTATED; SECTION _____ AUTHORIZES COUNTIES TO _____

NOW, THEREFORE BE IT RESOLVED by the Board of County Commissioners of Sullivan County, Tennessee, assembled in Regular Session on the 16th day of December 1996

THAT BE IT RESOLVED, That the Sullivan County Board of Commissioners approves the Sullivan County Road Atlas [Revised December 1, 1996].

All resolutions in conflict herewith be and the same rescinded insofar as such conflict exist.

This resolution shall become effective on _____, 19__, the public welfare requiring it.

Duly passed and approved this 20th day of January, 1997

Attested: Ray B. Feathers Date: 1-20-97 Gil Hodges Date: 1-20-97
County Clerk County Executive

INTRODUCED BY COMMISSIONER Blalock ESTIMATED COST: _____
SECONDED BY COMMISSIONER Reedy FUND: _____

Committee Action	Approved	Disapproved	Deferred	Date
Administrative	✓			1/6/97
Budget				
Executive	✓			1/8/97

Commission Action	Aye	Nay	Pass	Absent	Total
Roll Call	23			1	
Voice Vote					

COMMENTS: FIRST READING 12/16/96 APPROVED 1/20/97 ROLL CALL

0338

~~#21~~
#8

ROAD ATLAS
of
SULLIVAN COUNTY, TENNESSEE

REVISED 12/01/96

REVISED DECEMBER 1, 1996

NAME	MAP #	SEC	C.D.	LEN.	ESTIMATED	
					R.O.W.	CL
ABBEY ROAD	106	6	14	0.05	50	1
ACORN CIRCLE	124	7	9	0.03	40-50	1
ACORN COURT	111	7	16	0.05	40	1
ADAIR AVENUE	12	4	12	0.15	30-50	3
ADAIR COURT	106	6	14	0.05	40	2
ADALINE STREET	14	4	10	0.4	50	3
ADAMS ACRES DRIVE	49	4	5	0.1	40	3
ADAMS CHAPEL ROAD	65	7	1	1.3	50	1
ADAMS ROAD	64	7	5	1.5	20-50	4
ADAMS STREET	49	4	5	0.15	50	1
ADRIAN DRIVE	48	6	7	0.23	50	1
AKARD LANE	17	4	6	0.75	30-50	1
AKARD PLACE	36	7	5	0.05	30-50	3
AKARD STREET	36	4	5	0.05	40	2
ALABAMA STREET	31	4	10	0.4	30-50	2
ALCOA DRIVE	31	4	10	0.4	40	2
ALDEN STREET	49	4	7	0.1	50	1
ALDERS PLACE	36	7	5	0.2	50	1
ALDERS PLACE EXTENSION	36	7	5	0.2	50	2
ALEX LANE	52	7	5	0.3	30-50	3
ALHAMBRA DRIVE	36	7	5	0.15	50	1
ALLGOOD ROAD	29	4	12	0.05	40	3
ALLISON COURT	123	7	20	0.28	50	2
ALLISON COVE TRAIL	123	7	20	0.49	50	2
ALLISON ROAD (COLLECTOR)	124	7	20	4.05	60	1
ALLISON TIMBERS ROAD	123	7	20	0.11	50	2
ALMAROAD LANE	66	7	5	0.1	12-50	3
ALMAROAD ROAD	66	7	5	0.15	20-50	3
ALPINE	90	6	13	0.1	20-50	4
ALTAMONT DRIVE	92	6	14	0.17	50	2
ALVIN STREET	31	4	10	0.25	30-50	2
AMBROSIA DRIVE	118	6	15	0.25	50	2
AMELIA COURT	63	6	7	0.07	50	2
AMES STREET	76	6	13	0.1	20-50	3
AMHURST LANE	19	4	5	0.2	50	1
AMITY DRIVE	36	7	5	0.45	50	1
ANCO DRIVE	76	6	13	0.28	30-50	2
ANCO PLACE	76	6	13	0.35	40	2
ANDERSON LANE	17	4	6	0.12	40	3
ANDERSON ROAD	66	7	5	0.14	25-50	3
ANDERSON STREET	51	4	5	0.25	50	1
ANDREW STREET	14	4	10	0.15	20-50	3
ANDY COLE ROAD	98	7	16	0.4	20-50	4
ANN STREET	68	5	4	0.25	50	1
ANNGEA LANE	30	4	11	0.1	50	1
ANSLEY STREET	76	6	13	0.07	40	2
APACHE DRIVE	49	7	7	0.35	50	1
APPLEBERRY CIRCLE	106	6	14	0.06	40	2
APPLE RIDGE DRIVE	67	7	4	0.21	50	1
APPLE TREE	97	5	16	0.02	25-50	4
AQUEDUCT COURT E.	118	6	15	0.03	40	2
AQUEDUCT COURT W.	118	6	15	0.03	40	2
ARAPAHO DRIVE	49	4	7	0.03	50	1
ARCADIA DRIVE	15	4	10	1.5	30-40	1

ARCH HICKS ROAD	109	7	8	0.5	20-50	4
ARCH STREET	54	5	21	0.05	50	1
ARCHCREST STREET	48	4	10	0.25	30-50	2
ARCHDALE DRIVE	121	6	14	0.35	50	1
ARGONNE STREET	91	6	13	0.21	50	4
ARLEY STREET	48	4	7	0.05	40	2
ARLINGTON CIRCLE	106	6	14	0.28	40	1
ARLINGTON COURT	106	6	14	0.07	40	1
ARLINGTON DRIVE	106	6	14	0.12	40	1
ARLINGTON PLACE	106	6	14	0.05	40	1
ARMSTRONG DRIVE	31	4	10	0.21	30-50	1
ARNOLD WAY	40	5	22	0.4	30-40	1
ARONDALE COURT	48	4	7	0.05	40	1
ARROW CIRCLE	105	6	13	0.05	50	2
ARROWOOD DRIVE	105	6	13	0.2	30-50	2
ASBURY STREET	14	4	10	0.3	30-50	1
ASCOT DRIVE	119	6	14	0.5	50	2
ASH LANE	82	7	4	0.05	40	1
ASPEN STREET	48	4	10	0.05	25-50	2
ASTOR STREET	48	4	10	0.2	30-50	2
ATLAS DRIVE	82	5	4	0.1	50	2
ATLEE STREET	14	4	10	0.1	40	1
AURORA ROAD	120	6	14	0.2	40	1
AUSTIN POWDER ROAD	65	7	5	0.5	20-50	2
AUSTIN SPRINGS RD. SA-8220(C	135	7	9	2.85	60	1
AUTUMN KNOLL COURT	105	6	13	0.1	40	1
AVA DRIVE	92	6	14	0.28	50	1
AVONDALE ROAD	92	6	14	0.2	30-50	2
AYRSHIRE ROAD	36	4	5	0.1	50	1
AZTEC DRIVE	49	7	7	0.2	50	1

B

B.F.B. ROAD	94	7	18	0.04	30-50	2
BACON ROAD	120	6	14	0.09	20-50	3
BAILEY ROAD	64	6	7	0.25	50	1
BAILEYTON ROAD SA-8201	117	6	15	0.4	50	1
BAINES AVENUE	31	4	10	0.25	30-50	3
BAINES DRIVE	40	5	22	0.05	20-50	3
BAINES ROAD	90	6	15	0.05	20-50	4
BAKER CEMETARY ROAD	16	4	6	0.1	30-50	3
BAKER DRIVE	51	4	5	0.08	30-50	3
BALL ROAD	36	7	5	0.1	40	2
BANCROFT CHAPEL ROAD	32	4	10	1.8	30-50	1
BANNER STREET	64	7	5	0.15	30-50	3
BARBARA DRIVE	108	7	18	0.1	30-50	2
BARE HOLLOW ROAD	135	7	9	0.42	20-50	3
BAREFOOT LANDINGS DRIVE	94	7	18	0.24	50	2
BARGER DRIVE	50	4	6	0.1	30-50	3
BARGER HOLLOW RD. SA-8233	50	4	6	1.3	30-40	1
BARGER ROAD	50	4	6	0.6	30-50	2
BARNETT DRIVE	105	6	13	0.01	40	1
BARNETTE ROAD	112	5	16	1.01	20-50	3

BARR ROAD	50	4	6	1.5	30-50	2
BARRINGTON COURT	106	6	14	0.04	50	1
BASIN ROAD	100	5	3	0.06	30-50	3
BAYBERRY DRIVE	120	6	14	0.24	50	2
BAY HILL DRIVE	134	7	20	0.03	20-50	2
BAYS MOUNTAIN TRAIL	90	6	15	0.9	20-50	3
BAYWOOD DRIVE	134	7	20	0.75	30-50	2
BEALER ROAD	54	5	21	0.1	30-50	2
BEAR DRIVE	68	5	4	0.15	40	1
BEAR HOLLOW ROAD	39	5	2	0.6	20-50	3
BEAUMONT LANE	68	5	4	0.25	50	1
BEAVER CIRCLE	82	7	4	0.15	40	1
BEAVER CREEK RD. SA-8216 (C)	82	7	4	2.5	30-60	2
BEAVER LANE	30	4	11	0.1	30-50	4
BEAVER ROAD	82	7	4	0.4	50	1
BECK DRIVE	108	7	20	0.3	30-50	3
BECKLEY DRIVE	36	4	5	0.1	50	1
BEECH FOREST ROAD	69	5	21	1	30-50	3
BEECHNUT CITY ROAD	34	4	6	0.4	30-50	3
BEECHWOOD CIRCLE	68	5	21	0.36	50	1
BEECHWOOD COURT	106	6	13	0.14	50	1
BEECHWOOD DRIVE	92	6	14	1.2	50	1
BEECHWOOD ROAD	107	6	14	1.2	30-50	2
BEELER STREET	36	4	5	0.05	30-50	3
BEGLEY STREET	94	7	18	0.11	50	1
BEIDLEMAN CREEK ROAD	55	5	1	2.1	40	2
BEIDLEMAN ROAD	70	5	1	0.03	20-50	4
BEL AIR LANE	106	6	14	0.08	50	2
BELDEN ROAD	30	4	11	0.25	40	2
BELL FLOWER COURT	119	6	14	0.04	40	2
BELL HOLLOW ROAD	104	6	15	0.8	30-40	2
BELL RIDGE DRIVE	29	4	12	0.45	40-50	2
BELL RIDGE ROAD	29	4	12	1.35	40-50	2
BELL STREET	94	7	18	0.59	50	1
BELL STREET EXTENSION	94	7	18	0.09	50	1
BELLE AVENUE	124	7	9	0.19	30-50	1
BELLE FOREST COURT	106	6	14	0.16	40	2
BELMONT COURT	104	6	15	0.08	50	1
BELSAV DRIVE	90	6	13	0.26	40	2
BELVEDERE LANE	92	6	14	0.23	30-50	2
BENNY MOWELL ROAD	102	6	15	0.3	20-50	3
BENTLEY STREET	14	4	10	0.05	30-50	3
BERTSIE SHIPLEY ROAD	116	6	15	0.45	15-50	4
BESSIE MORRISON ROAD	117	6	15	0.15	15-50	4
BETHANY STREET	13	4	12	0.03	40	4
BETHEL DRIVE SA-8236	67	7	4,5	2.85	30-60	2
BETHEL LANE	31	4	10	0.2	50	1
BEULAH CHURCH DRIVE	107	6	14	0.85	30-50	2
BEULAH CHURCH ROAD	107	7	18	1.7	30-50	2
BEULAH LAND DRIVE	82	5	16	0.1	50	1
BEULAH PARK DRIVE	107	6	14	0.35	40	2
BIG ARM BRANCH ROAD	126	7	16	1.3	15-50	3
BIG ARM ROAD	126	7	16	0.7	30-50	2
BIG ECHO COURT	92	6	14	0.07	50	1
BIG HOLLOW ROAD	66	7	5,8	3.7	40	2
BIG RIDGE ROAD	103	6	15	2.48	30-50	2
BIG SPRINGS ROAD	84	5	3	2.9	30-50	2
BILL ROAD	96	7	8	0.42	50	1

BILL MOODY TRAIL	50	4	5	0.2	30-50	3
BIRCH STREET	66	7	5	0.25	50	1
BISHOP ROAD	118	6	15	0.5	20-50	3
BLACKBURN AVENUE	14	4	10	0.3	40	2
BLACKBURN CIRCLE	19	4	5	0.2	40	2
BLACKBURN DRIVE	19	4	5	0.55	40	2
BLACKBURN ROAD	66	7	5	0.2	40	1
BLACKFOOT DRIVE	49	4	7	0.1	50	1
BLAIR GAP ROAD	102	6	15	1.05	40-50	1
BLAKLEY DRIVE	105	6	13	1.13	40-50	1
BLALOCK ROAD	134	7	9	0.25	40	3
BLARNEY PLACE	63	6	7	0.1	40	1
BLARNEY ROAD	63	6	7	0.1	40	1
BLOOMINGDALE RD.SA-8229(C)	46	4	10,11	9.5	40-60	1
BLOUNTVILLE BY PASS	51	4	5	0.5	50	1
BLOUNTVILLE CEMETERY ROAD	65	4	5	0.2	30-50	3
BLUE HAVEN DRIVE	92	6	14	0.44	50	1
BLUE HERON LANE	122	7	20	0.5	30-50	2
BLUEGRASS DRIVE	90	6	15	0.2	50	1
BLUFF ROAD	33	4	6,7	1.65	30-50	3
BLYTHEWOOD DRIVE	48	6	7	0.05	40	2
BOB DYKES ROAD	116	6	15	0.15	15-50	4
BOBBY DRIVE	30	4	11	0.2	50	1
BOND TOWN ROAD	79	7	18	1.05	50	1
BONNIE DRIVE	51	4	5	0.2	30-50	3
BOOHER DRIVE	54	5	1,21	1.7	40	2
BOOHER LANE	38	5	2	0.65	30-50	2
BOONE DAM ROAD	107	7	18	0.65	50	1
BOONE LAKE CIRCLE	96	7	4	0.15	50	1
BOONE RIDGE DRIVE	108	7	13	0.25	40	2
BOOTH COURT	121	6	14	0.1	50	1
BOOZY CREEK ROAD	33	4	6	1.55	30-50	1
BOSS ROAD	48	6	7	0.45	40	2
BOWLIN LANE	30	4	11	0.06	20-50	3
BOWMAN CREEK ROAD	79	7	7,18	0.85	30-50	2
BOWMAN FORD ROAD	135	7	9	0.35	30-50	2
BOXWOOD CIRCLE	107	6	14	0.08	30-50	4
BOXWOOD COURT	124	7	9	0.05	40	1
BOXWOOD LANE	33	4	6	0.1	50	1
BOYD ROAD	84	5	3	0.9	40	1
BRADFORD LANE	92	6	14	0.1	50	2
BRADFORD ROAD	134	7	20	0.05	40	2
BRAGG ROAD	103	6	15	0.3	20-50	4
BRANCH COURT	65	7	5	0.03	30-50	4
BRANCH LANE	1	5	19	0.49	30-50	4
BRANCH ROAD	118	6	15	1.4	40	1
BRASWELL-BAKER ROAD	36	4	5	0.15	50	3
BREEDING LANE	30	4	11	0.25	20-50	3
BRENTWOOD DRIVE	12	4	12	0.4	40	2
BRIARFIELD DRIVE	29	4	12	0.11	50	2
BRICKLEY STREET	31	4	10	0.05	30-50	3
BRIDWELL HEIGHTS ROAD	48	6	7	1.01	40-50	2
BRIGHTWOOD LANE	92	6	14	0.13	30-50	2
BRISCOE CIRCLE	54	5	21	0.1	40	2
BRISCOE CIRCLE EXTENSION	54	5	21	0.1	40	1
BRISTOL AVENUE	51	7	5	0.05	30-50	2
BRISTOL CAVERNS HWY (STATE)	38	5		0		
BRISTOL METALS ROAD	54	5	21	0.4	50	1

BRITTANY DRIVE	106	6	14	0.11	50	1
BROCKWAY DRIVE	92	6	13	0.16	50	1
BRONTE DRIVE	51	7	5	0.07	40	1
BROOKDALE DRIVE	124	7	9	0.31	50	1
BROOKFIELD DRIVE	107	6	14	0.75	30-50	2
BROOKFIELD LANE	107	6	14	0.25	30-50	2
BROOKLAWN DRIVE	31	4	11	0.4	50	1
BROOKLEA CIRCLE	82	7	4	0.1	50	1
BROOKSHIRE DRIVE	36	4	5	0.1	50	1
BROOKSIDE CIRCLE	47	4	11	0.25	40	2
BROOKSIDE DRIVE	31	4	10,11	1.5	40	2
BROOKSIDE LANE	82	5	4	0.2	40	1
BROOKSIDE SCHOOL LANE	31	4	10	0.19	40-50	2
BROOKVALLEY DRIVE	48	4	7	0.04	50	2
BROOKWOOD COURT	63	6	7	0.12	50	2
BROWDER ROAD	78	6	7	0.3	30-50	1
BROWN CIRCLE	94	7	18	0.55	30-50	3
BROWN DRIVE	68	5	4	0.13	20-50	3
BROWN KYTE ROAD	126	7	4	0.4	20-50	4
BROWN ROAD	137	7	16	0.2	16-50	4
BROWN STREET	68	5	4	0.65	40	1
BROWNLAW ROAD	31	4	10	0.3	50	2
BROYLES LANE	68	5	21	0.85	30-50	2
BROYLES ROAD	68	5	21	0.2	20-50	2
BRUCE DOAN ROAD	79	7	18	0.5	30-40	3
BRUMLEY STREET	12	4	12	0.03	40	2
BUCHANAN DRIVE	83	5	21	0.14	20-50	4
BUCHANAN LANE	113	5	3	0.8	20-50	3
BUCHANAN ROAD	53	5	21	0.19	15-50	4
BUCHELEW DRIVE	106	6	14	0.67	50	1
BUCKLES DRIVE	61	6	13	0.15	40	2
BUENA VISTA DRIVE	64	7	7	0.1	40	1
BUFFALO ROAD SA-8225	81	7	8	1.51	30-50	2
BULLIS ROAD	107	7	18	0.15	20-50	3
BULLOCK HOLLOW RD. SA-8239	54	5	3,21	5.1	40	2
BUNCOMBE ROAD	66	7	5	1.5	30-50	2
BUNKER HILL RD. SA-8222(C)	125	7	16	2.2	60	1
BURDINE ROAD	123	7	20	0.35	50-60	3
BURLESON STREET	61	6	13	0.2	30-50	2
BURNING TRAIL	91	6	13	0.6	50	2
BURNSIDE DRIVE	92	6	14	0.05	40	2
BUTTERMILK ROAD (C)	78	6	7	1.6	40-60	1
BUTTERMILK ROAD E.	78	6	7	0.2	20-50	1
BYRD STREET	14	4	10	0.03	30-50	3

C

CAGLE ROAD	111	7	16	0.1	20-50	4
CAIN DRIVE	63	6	7	0.5	50	1
CAIN STREET	14	4	10	0.25	50	2
CALUMET CIRCLE	118	6	15	0.04	40	2
CALUMET COURT	118	6	15	0.03	40	2
CAMBRIDGE CIRCLE	19	4	5	0.05	50	1

CAMBY DRIVE	91	6	13	0.24	50	2
CAMELOT DRIVE	54	5	21	0.7	50	1
CAMP PLACID ROAD	65	7	5	1.1	30-50	1
CAMP TOM HOWARD ROAD	58	5	19	0.4	30-50	3
CAMPBELL CROSS ROAD	81	7	5	0.1	15-50	4
CAN SELLS ROAD	108	7	20	0.4	12-50	4
CANEY DRIVE	30	4	11	0.05	30-50	2
CANNON STREET	48	4	10	0.25	30-50	2
CANNONERO COURT	118	6	15	0.15	40	1
CANT HOOK HILL ROAD	54	5	21	0.7	20-50	3
CANTERBURY DRIVE	64	7	5	0.36	50	1
CANTON ROAD	107	6	14	0.75	40	2
CANYON TRAIL	91	6	13	0.02	50	4
CAPRI STREET	31	4	10	0.25	30-50	2
CARDEN HOLLOW RD. SA-8236(C)	36	7	4,5	2.33	60	1
CARDINAL STREET	14	4	10	0.37	50	3
CARL DYKES ROAD	116	6	15	0.1	20-50	3
CARLTON LANE	124	7	9,16	0.85	30-50	2
CARLTON LANE EXTENSION	124	7	9	0.03	40	2
CARLTON ROAD	36	4	5	0.9	50	1
CAROL HILL DRIVE	80	7	5	0.12	40	2
CAROL LANE	80	7	5	0.2	40	1
CAROL LANE EXTENSION	80	7	5	0.03	40	1
CAROLE STREET	30	4	11	0.05	30-50	2
CAROLINA AVENUE	38	5	2	1.3	40	1
CAROLINA POTTERY DRIVE	64	7	5	0.25	60	1
CARR DRIVE	51	4	5	0.3	40-50	1
CARR HOLLOW ROAD	125	7	16	0.45	30-50	4
CARRIAGE LANE	80	5	8	0.24	50	2
CARROLL COURT	66	7	5	0.05	40	1
CARROLLWOOD DRIVE	31	4	10	0.12	50	2
CARROLLWOOD HEIGHTS ROAD	31	4	10	0.6	25-50	2
CARTER HILL ROAD	123	7	9,20	0.8	40	2
CARTERS VALLEY GARDEN	13	4	12	0.2	30-50	3
CASCADE STREET	48	4	10	0.1	30-50	2
CASH AVENUE	79	7	18	0.5	30-50	2
CASSIDY COURT	49	7	7	0.05	40	1
CASSIDY ROAD	49	7	7	0.4	40	1
CASTAWAY DRIVE	107	6	14	0.13	50	2
CASTLE OAKS DRIVE	92	6	14	0.12	50	2
CASTLETON COURT	104	6	15	0.02	40	2
CATAWBA LANE	64	6	7	1.45	40	3
CAVE HILL ROAD	81	7	5,8	1.1	30-50	2
CAVERN ROAD	39	5	1	1.4	30-50	1
CEDAR AVENUE	90	6	13	0.15	30-50	3
CEDARBROOK COURT	48	6	7	0.08	40	2
CEDAR BRANCH ROAD	63	6	7	1.85	30-40	2
CEDAR COURT	92	6	14	0.05	40	2
CEDAR CREST DRIVE	106	6	14	0.05	50	2
CEDAR DRIVE	104	6	15	0.13	30-50	2
CEDAR LANE	55	5	1	0.25	50	2
CEDAR ROAD	53	5	21	0.15	40	1
CEDAR STREET EXT.	97	7	16	0.03	25-50	4
CEDAR TREE	97	5	16	0.03	25-50	4
CEDARWOOD COURT (NOT CO.)	107			0		
CEMETERY LANE	136	7	16	0.06	15-50	4
CEMETERY ROAD	81	7	4	0.3	20-50	3
CENTENARY ROAD (SPLIT)	93	7	4	3.2	20-40	3

CENTER DRIVE	108	7	18	0.6	40	2
CENTERBROOK CIRCLE	106	6	14	0.41	50	1
CENTRAL HEIGHTS RD. SA-8231	34	4	6	1.8	30-50	1
CHADWELL ROAD (C)	14	4	10	1.6	30-60	2
CHANDLER STREET	12	4	12	0.05	20-50	3
CHANNEY DRIVE	15	4	10	0.11	40	2
CHAPEL DRIVE	12	4	12	0.2	30-50	2
CHARLIE AVENUE	96	7	8	0.63	50	1
CHARLIE JOHN CIRCLE	68	5	4	0.09	40	2
CHARLTON GREEN DRIVE	120	6	14	0.27	50	1
CHASE STREET	92	6	14	0.15	30-50	3
CHATEAUGAY ROAD	14	4	10	0.15	50	2
CHEEKWOOD DRIVE	14	4	10	0.3	50	2
CHELSEA CIRCLE	118	6	15	0.03	40	2
CERRY COURT	35	4	6	0.1	20-50	3
CERRY LANE	82	7	4	0.15	40	1
CERRY ROAD	124	7	9	0.1	30-50	2
CERRY STREET	51	7	5	0.2	50	1
CERRYWOOD COURT	36	4	5	0.05	50	1
CHERT DRIVE	92	6	14	0.18	50	1
CHESTERFIELD DRIVE	106	6	13	0.75	50	1
CHESTNUT RIDGE ROAD	47	4	7	1.7	30-40	1
CHESTNUT STREET	51	7	5	0.05	50	1
CHEYENNE LANE	49	4	7	0.1	40	1
CHILDRESS FERRY ROAD	63	6	7	2.2	30-40	2
CHINQUAPIN GROVE SA-8222(C)	126	7	16	4.75	60	1
CHIO WAY	92	6	13	0.1	40	2
CHIPPEWA LANE	48	4	7	0.15	50	1
CHRISTOPHER COURT	50	4	5	0.12	50	2
CHRISTUS DRIVE	83	5	16	0.16	50	1
CHRISTY DRIVE	104	6	15	0.1	50	2
CHUCKY AVENUE	30	4	11	0.09	50	1
CHURCH CIRCLE	21	5	2	0.15	15-50	4
CHURCH HILL DRIVE	104	6	15	0.45	50	2
CHURCH HILL ROAD	95	7	8	0.2	40	3
CHURCH LANE	31	4	11	0.15	40	2
CHURCH ROAD	118	6	15	2.01	30-50	2
CHURCH ROAD S.	118	6	15	0.75	30-50	2
CHURCH STREET	66	7	5	0.05	25-50	3
CHURCH VIEW DRIVE	105	6	13	0.44	40	1
CHURCH VIEW DRIVE EXTENSION	105	6	13	0.1	30-50	3
CIRCLE DRIVE	126	7	16	0.9	30-50	2
CIRCLE DRIVE N.	61	6	13	0.01	40	2
CIRCLE PLACE	31	4	10	0.02	50	3
CIRCLE ROAD	19	4	5	0.05	30-50	3
CIRCLE STREET	14	4	20	0.1	50	2
CITATION CIRCLE	104	6	15	0.16	40	1
CLAREMONT ROAD	30	4	11	0.45	30-40	2
CLARK CEMETERY ROAD	36	7	5	0.08	30-50	2
CLARK DRIVE	57	5	19	0.11	20-50	4
CLARK HILL ROAD	55	5	1	0.4	20-50	4
CLARK LANE	36	7	5	0.2	40	1
CLARK PLACE	51	4	5	0.3	40	2
CLARK ROAD	35	4	5	0.3	15-50	4
CLAYMORE DRIVE	106	6	14	0.49	50	1
CLAYTON STREET	91	6	13	0.08	50	1
CLEAR BRANCH CIRCLE	65	7	5	0.3	50	1
CLEAR BRANCH DRIVE	65	7	5	0.15	50	1

CLEARVIEW STREET	90	6	15	0.3	20-50	3
CLEEK ROAD	47	4	10	0.75	40	3
CLIFFSIDE DRIVE	33	4	6	0.2	50	1
CLIFFVIEW DRIVE	92	6	14	0.25	30-50	2
CLIPSE ROAD	13	4	11	0.09	50	2
CLOVER BOTTOM DRIVE	90	6	15	0.3	30-50	2
CLOVER LEAF COURT	48	6	7	0.04	40	1
COAL PIT HOLLOW LANE	117	6	15	0.5	20-50	4
COAL PIT HOLLOW ROAD	103	6	15	0.5	20-50	4
COCHISE TRAIL	49	7	7	0.9	50	1
COLD SPRINGS CHURCH ROAD	23	5	22	0.8	40	2
COLD SPRINGS ROAD	33	4	6	0.85	50	1
COLE HOLLOW ROAD	16	4	6	1.85	30-50	2
COLE LIGHT ROAD	117	6	15	0.16	15-50	4
COLE ROAD	33	4	6	0.1	20-50	3
COLEBROOK LANE	40	5	22	0.35	30-50	3
COLEY STREET	30	4	11	0.15	30-50	2
COLLEGE STREET	135	7	9	0.1	20-50	3
COLLINGWOOD DRIVE	19	4	5	0.55	50	1
COLLINS LANE	68	5	4	0.25	30-50	3
COLONIAL COURT	92	6	13	0.1	40	2
COLONIAL HTS RD. SA-8209(C)	92	6	14	1.4	60	1
COLONIAL VIEW ROAD	106	6	14	0.23	40	1
COLONY DRIVE	19	7	5	0.1	40	2
COMBS ROAD	126	7	16	0.15	30-50	3
COMMANCHE DRIVE	49	4	7	0.2	50	1
COMMISSION DRIVE	30	4	11	0.05	50	2
CONCORD CIRCLE	19	4	5	0.1	50	1
CONCORD STREET	48	4	10	0.2	50	1
COOK HOLLOW ROAD	36	4	5	0.55	30-50	2
COOKS VALLEY ROAD (C)	48	6	7	6.08	60	2
COPE ROAD	108	7	18	0.15	15-50	3
CORALWOOD COURT	106	6	14	0.05	40	2
CORALWOOD DRIVE	106	6	14	0.29	50	1
CORK LANE	63	6	7	0.05	40	1
CORY WAY	106	6	14	0.1	50	1
COTTONWOOD COURT	124	7	9	0.04	40	1
COTTONWOOD LANE	124	7	9	0.23	40	1
COUNTRY DRIVE	48	6	7	0.7	50	1
COUNTRY MEADOW CIRCLE	68	5	21	0.2	50	1
COUNTRYSHIRE COURT	106	6	14	0.57	50	1
COUNTY HILL ROAD	66	4	5	0.5	40	1
COUNTY HOME ROAD	51	4	5	1.1	30-50	1
COURTLAND DRIVE	106	6	14	0.05	40	1
COURTNEY DRIVE	63	6	7	0.12	50	1
COVE STREET	30	4	11	0.1	30-50	3
COX HOLLOW ROAD SA-8204 (C)	105	6	13,14	2.1	60	1
CRABAPPLE LANE	106	6	14	0.13	50	1
CRANSHAW DRIVE	75	6	13	0.35	40	2
CRANSHAW DRIVE EXTENSION	75	6	13	0.05	20-50	3
CRAWFORD LANE	79	7	18	0.3	20-50	3
CRAWFORD ROAD	116	6	15	0.1	15-50	4
CREE STREET	48	4	7	0.2	50	1
CREEK DRIVE	116	6	15	0.45	20-50	3
CREEKMORE DRIVE	90	6	15	0.1	30-50	2
CRESCENT DRIVE	68	5	21	0.2	50	1
CRESTVIEW STREET	69	5	21	0.23	40	1
CROCKETT HILL ROAD	30	4	11	0.2	20-50	3

CROCKETT STREET	68	5	4	0.15	40	1
CROFTON DRIVE	54	5	21	0.13	50	1
CROSS ANCHOR PLACE	109	7	20	0.04	50	1
CROSS COMMUNITY ROAD (SPLIT)	35	4	5	2.15	30-50	3
CROSSWHITE ROAD	35	4	5	0.25	20-50	3
CROWE ROAD	84	5	1	0.05	20-50	4
CRUMLEY CEMETARY ROAD	99	5	3	0.18	15-50	4
CRUSSELL DRIVE	96	7	8	0.15	30-50	2
CRUSSELL ROAD	96	7	8	0.2	30-50	3
CRYSTAL SPRINGS ROAD	33	4	6	0.15	40	1
CRYSTAL VIEW STREET	14	4	10	0.25	30-50	2
CUNNNINGHAM LANE	54	5	2	0.3	30-50	3
CURTIS COURT	48	6	7	0.23	50	1
CURTIS HOLLOW ROAD	135	7	9	0.25	20-50	4

D

D. DROKE ROAD	96	7	8,9	1.05	40	2
DAIL STREET	51	4	5	0.1	50	1
DAIRY CIRCLE	51	7	5	0.2	30-50	2
DAKOTA DRIVE	49	7	7	0.2	50	1
DALTON VIEW DRIVE	34	4	6	0.25	30-50	3
DANCY LANE	107	6	14	0.25	50	1
DARLINGTON DRIVE	30	4	11	0.3	50	1
DARNELL DRIVE	12	4	12	0.15	25-50	3
DART DRIVE	19	4	5	0.05	50	2
DARTMOUTH DRIVE	19	4	5	0.45	50	1
DARYL LANE	65	7	5	0.2	40	2
DE LEE DRIVE	92	6	14	0.52	50	1
DEADRIK DRIVE	92	6	14	0.2	50	2
DEAN ROAD	104	6	13	0.16	12-50	3
DECK LANE	108	7	18	0.6	30-50	3
DECK ROAD	19	4	6	0.1	30-50	3
DECK STREET	106	6	13	0.12	30-50	3
DECK VALLEY DRIVE	18	4	6	0.45	30-50	3
DECK VALLEY LANE	18	4	6	0.8	30-50	3
DECK VALLEY ROAD	18	4	6	1.5	30-50	3
DECK VALLEY ROAD TN-VA	19	4	6	0.3	30-50	3
DEER RIDGE COURT	106	6	14	0.04	40	2
DEERFIELD DRIVE	54	5	21	0.45	50	1
DEERLICK ROAD	108	7	20	1.75	30-50	2
DEERWOOD LANE	106	6	14	0.06	40	1
DEHAVEN PLACE	30	4	11	0.1	40	3
DELIVIA STREET	30	4	11	0.07	20-50	3
DENTONS LANE	9	5	19	0.3	15-50	4
DENTON ROAD	8	5	19	0.25	20-50	4
DENTON VALLEY ROAD	58	5	19	6.6	30-50	3
DENTONS VALLEY ROAD	1	5	19	1.4	20-50	3
DERBY DRIVE	104	6	15	0.51	50	1
DERTING STREET	30	4	11	0.15	30-50	1
DEVAULT BRIDGE RD.SA-8215(C)	109	7	8,20	4.2	60	1
DEVENS COURT	78	6	7	0.09	50	
DEVINE CIRCLE	105	6	13	0.1	40	1
DEWBERRY CIRCLE	106	6	14	0.06	40	3

DEXTER ROAD	13	4	11	0.15	50	3
DIANA AVENUE	75	6	13	0.13	40	1
DIANA CIRCLE	75	6	13	0.05	40	2
DIANA ROAD	75	6	13	0.2	40	1
DICKSON ROAD	14	4	10	0.1	40	2
DILLOW CIRCLE	121	6	14	0.2	22-50	3
DILLOW DRIVE	107	6	14	0.56	30-50	3
DINSMORE STREET	30	4	11	0.25	30-50	3
DISHNER ROAD	19	4	5	0.01	20-50	3
DIXON ALLEY	66	7	5	0.1	15-50	4
DOCK ROAD	56	5	1	0.03	15-30	4
DOE ROAD	67	7	4	0.05	40	1
DOGWOOD DRIVE	92	6	14	0.6	30-50	2
DOGWOOD LANE	79	7	18	0.1	50	1
DOGWOOD TRAIL	124	7	9	0.33	50	1
DONNA PLACE	14	4	10	0.03	40	3
DONNIE CRAWFORD ROAD	103	6	15	0.1	12-50	4
DORAN HOLLOW ROAD	93	7	18	0.95	20-50	3
DOUBLE SPRINGS ROAD	119	6	14	0.8	10-50	1
DOVER LANE	19	4	5	0.2	50	1
DOWNS COURT	118	6	15	0.03	40	2
DRAKE ROAD	9	5	19	0.25	30-50	2
DROKE LANE	16	4	6	0.95	40	1
DRUID HILLS	106	6	14	0.3	50	2
DRY BRANCH ROAD (STATE-44)	97	7		0		
DUBLIN ROAD	63	6	7	0.3	50	1
DULANEY ROAD	36	7	5	0.02	30-50	2
DUMFRIES ROAD	36	4	5	0.2	50	1
DUNCAN LANE	55	5	1	0.04	15-50	3
DUNLAP ROAD SA-8211	94	7	18	3.05	30-50	2
DUNWOODY COURT	63	6	7	0.09	50	3
DUTCHESS DRIVE	106	6	14	0.13	40	1
DYKES ROAD	117	6	15	0.2	15-50	3

E

E. CARTERS VALLEY RD. (C)	12	4	12	0.7	60	2
E.M. CROSS ROAD	96	7	8	0.05	30-50	4
EADS ROAD	110	7	16	0.2	20-50	3
EAGLE STREET	30	4	11	0.15	50	1
EARHART ROAD	67	7	4	0.3	30-50	3
EASLEY DRIVE	91	6	13	0.38	50	3
EASLEY ROAD	90	6	13	0.2	20-50	1
EAST CAMPGROUND ROAD	119	6	14,15	1.01	30-50	2
EAST CENTRAL	36	4	5	0.3	40-50	1
EASTBROOK DRIVE	92	6	13	0.41	50	2
EASTERN STAR RD. SA-8207	120	6	14	1.01	40-50	1
EASTLAND DRIVE	105	6	13	0.23	50	1
EASTLAND PLACE	105	6	13	0.07	50	1
EASTWOOD DRIVE	68	5	4	0.15	40	1
EASY STREET	105	6	13	0.26	50	2
EATON ROAD	51	7	8	0.37	30	4
EATON STATION ROAD	48	4	7	0.23	30-50	2

EAUCLAIR STREET	48	6	7	0.45	50	1
ECHO LANE	82	5	4	0.04	20-50	3
ECHO LANE EXT.	82	5	4	0.04	20-50	3
EDENS VIEW ROAD	48	4	7	0.56	40-50	2
EDGEFIELD ROAD	140	7	9	1.6	40	2
EDGEWOOD CIRCLE	106	6	14	0.05	40	2
EDISON STREET	12	4	12	0.1	30-50	3
EDITH ROAD	48	6	7	0.1	20-50	3
EDMOND CIRCLE	92	6	14	0.03	40	2
EDWARDS LANE	33	4	6	0.19	14-50	4
EGYPT ROAD	97	7	4,16	3.7	30-50	2
ELIE ROAD	98	5	16	0.2	12-50	4
ELIZABETHTON HWY. SA8243,8247	111	7	16	3.2	40-50	1
ELLA DRIVE	50	4	5	0.15	40	2
ELLEN STREET	48	6	7	0.25	30-50	2
ELLIS ROAD	65	7	5	0.7	30-50	2
ELM LANE	82	7	4	0.35	40	1
ELMHURST DRIVE	92	6	14	0.45	50	2
EMERALD DRIVE	48	6	7	0.1	40	1
EMERSON STREET	30	4	11	0.07	30-50	3
EMMETT RD. SA-8240,8241(C)	55	5	1	2.9	30-60	2
EMMETT WAY	55	5	1	0.53	30-50	3
EMORY CHURCH ROAD	63	6	7	1.65	50	1
EMORY LANE	14	4	10	0.2	30-50	3
ENTERPRISE RD. SA-8216 (C)	96	7	8,20	4.65	30-60	1
EPPS ROAD	12	4	12	0.14	30-50	3
ERIC COURT	63	6	7	0.06	40	1
ERNIE DRIVE	14	4	10	0.2	50	1
ERWAY COURT	78	6	7	0.17	50	3
ESSEX DRIVE	82	7	4	0.6	50	1
ESTEP ROAD	126	7	16	0.2	20-50	3
ESTERVILLE ROAD	15	4	10	0.65	30-50	2
ETHEL BEARD ROAD	81	7	8	1.3	30-50	2
ETHEL DRIVE	47	4	7	0.1	30-50	3
EUCLID ROAD	30	4	11	0.05	50	1
EVERGREEN DRIVE	33	4	6	0.3	30-50	1
EVERGREEN ROAD	92	6	14	0.13	30-50	3
EXETER LANE	65	7	5	0.15	50	2
EXIDE DRIVE SA-8235 (C)	67	7	4	1.5	80	1

F

FAIN DRIVE SA-8213	94	7	8	0.55	30-50	3
FAIN ROAD	51	4	5	0.4	30-50	1
FAIRBANKS STREET	31	4	10	0.3	50	2
FAIRFAX ROAD	14	4	10	0.2	30-50	2
FAIRFORD LANE	51	7	5	0.3	50	1
FAIRHAVEN DRIVE	66	7	4	0.17	50	1
FAIRHAVEN LANE	99	5	3	0.1	15-50	4
FAIRHILL ROAD	48	4	10	0.1	50	1
FAIRLANE DRIVE	92	6	14	0.05	40	2
FAIRLAWN DRIVE	92	6	14	0.22	50	2
FAIRVIEW SCHOOL ROAD	80	7	8	2.43	30-50	2
FAIRWAY DRIVE	66	7	4	0.45	50	1

FAIRWAY EST. DRIVE	81	7	4	0.3	50	1
FAIRWOOD DRIVE	54	5	2	0.1	50	1
FAIRWOOD STREET	30	4	11	0.07	40	2
FALL CREEK RD.SA-8209 (C)	48	6	7	4.4	60	1
FARRAGUT ROAD	54	5	21	0.11	50	1
FARRIS ROAD	30	4	11	0.1	30-50	2
FAULK LANE	31	4	10	0.2	50	2
FEDDERSON STREET	31	4	10	0.5	50	2
FERNCLIFF DRIVE	14	4	10	0.15	50	1
FERNWOOD DRIVE	92	6	14	0.33	50	2
FERRY ROAD	77	6	14	0.07	40	3
FIELDCREST ROAD	64	6	7	3.3	30-50	2
FIELDPOND DRIVE	63	6	7	0.05	40	2
FIELDSTONE DRIVE	63	6	7	0.35	50	1
FIFTH STREET	36	4	5	0.35	25-50	2
FILLERS ROAD	110	7	20	0.2	20-50	4
FIRST AVENUE	53	5	21	0.2	50	2
FISHER DRIVE	48	4	7	0.1	20-50	3
FLANDERS STREET	12	4	12	0.19	30-50	3
FLANARY STREET	13	4	12	0.12	20-50	3
FLAT CREEK LANE	79	7	18	0.16	40	1
FLATWOODS ROAD	84	5	1	2.3	40-50	1
FLEENOR DRIVE	64	4	9	0.1	30-50	2
FLEMING ROAD	14	4	10	0.25	40	2
FLETCHER AVENUE	12	4	12	0.01	40	1
FLORENCE DRIVE	65	4	5	0.15	50	1
FLOYD HOLLOW ROAD	135	7	9	0.2	20-50	3
FLOYD STREET	30	4	11	0.08	50	2
FOGLEMEN DRIVE	34	4	6	0.2	30-50	3
FONDULAC DRIVE	106	6	14	0.22	50	1
FONTANA STREET	31	4	10	0.25	30-50	2
FOOTHILLS DRIVE	51	7	5	0.07	50	1
FOOTHILLS ROAD	92	6	14	0.78	50-60	1
FORD AVENUE	92	6	14	0.15	50	1
FORD ROAD	78	7	18	0.23	20-50	3
FORDTOWN ROAD (C)	106	6	14	3.92	40-60	1
FOREGO COURT	104	6	15	0.02	40	3
FOREST CIRCLE	30	4	11	0.03	40	1
FOREST EDGE COURT	92	6	14	0.1	40	2
FOREST HILLS DRIVE	92	6	14	0.4	50	2
FOREST VIEW DRIVE	30	4	11	1.01	40	2
FOREST VIEW ROAD (C)	30	4	11	1.55	60	1
FORRESTER ROAD	124	7	9	0.13	16-50	3
FOX CHASE DRIVE	78	6	7	0.16	50	2
FOX HOLLOW LANE	136	7	9	0.85	30-50	3
FOX HOLLOW ROAD	125	7	16	0.25	30-50	3
FOX PATH COURT	106	6	14	0.08	50	1
FOXCROFT DRIVE	49	6	7	0.06	50	1
FOXFIRE LANE	48	4	7	0.4	50	1
FOXFIRE PLACE	48	4	7	0.6	50	1
FOXFIRE TRAIL	48	4	7	0.35	50	1
FOXPORT ROAD	119	6	13	0.18	50	1
FOXWOOD LANE	63	6	7	0.05	40	1
FRADY ROAD	48	6	7	0.15	20-50	3
FRANKLIN DRIVE	66	7	5	0.6	40-50	1
FREDRICK STREET	14	4	10	0.15	30-50	3
FREEMAN DRIVE	12	4	12	0.03	30-50	3
FREEMAN ROAD	78	6	7	1.9	40-50	1

FREEMONT DRIVE	92	6	14	0.12	50	2
FREEWILL DRIVE	31	4	10	0.05	40	2
FRIENDSHIP DRIVE	41	5	19	0.42	40	3
FRIENDSHIP ROAD	41	5	19	1.2	20-60	3
FRITZ HOLLOW ROAD	99	5	3	0.5	15-50	4
FRONTIER DRIVE	63	6	7	0.18	50	1

G

G.B. HALL ROAD	106	6	14	0.21	20-50	4
GAINES STREET	48	4	10	0.2	30-50	2
GALE AVENUE	31	4	10	0.25	30-50	3
GALE LANE	13	4	11	0.15	50	3
GALEMONT DRIVE	90	6	13	0.4	40	2
GALLOWAY ROAD	91	6	13	0.28	20-50	3
GALLOWAY STREET	12	4	12	0.1	30-50	2
GAMMON ROAD	108	7	18	0.7	40	2
GARDEN GROVE DRIVE	51	4	5	0.15	40	2
GARFIELD DRIVE	48	4	10	0.2	25-50	2
GARLAND AVENUE	90	6	15	0.1	30-50	2
GARLAND STREET	30	4	11	0.2	30-50	2
GARMON DRIVE	106	6	14	0.07	40	2
GARWOOD DRIVE	107	6	14	0.05	50	3
GATEWOOD DRIVE	121	6	14	0.05	50	1
GEISLER ROAD	122	7	20	1.2	30-50	2
GENTRY COURT	67	7	4	0.04	40	1
GEORGE CARR ROAD	81	7	5	0.2	30-50	4
GIBBS ROAD	30	4	11	0.1	40	2
GIFFORD ROAD	53	5	21	0.15	30-50	3
GLADEMILL DRIVE	106	6	14	0.12	50	2
GLASGOW LANE	63	6	7	0.15	50	2
GLEASON STREET	12	4	12	0.05	30-50	3
GLEN ALPINE ROAD (C)	90	6	13,15	1.13	40-60	1
GLENBURN ROAD	90	6	12	0.3	40	2
GLENCLIFF DRIVE	106	6	14	0.24	50	1
GLEN HAVEN DRIVE	82	5	16	0.14	50	1
GLENDOR DRIVE	68	5	4	0.02	50	2
GLENDORA DRIVE	121	6	14	0.2	50	1
GLENMONT COURT	90	6	15	0.11	40	2
GOLD DUST DRIVE	51	4	5	0.05	50	1
GOLDIE CRAWFORD ROAD	117	6	15	0.05	21-50	4
GOLF PARK DR.	78	6	7	0.01	50	1
GOOD VIEW DRIVE	31	4	10	0.35	30-50	3
GOODMAN CEMETERY ROAD	108	7	20	0.2	30-50	3
GOODS DRIVE	93	7	18	0.2	30-50	3
GOTTLAND SHOALS RD.(C)	93	7	18	2.01	30-60	3
GOVERNMENT ROAD	9	5	19	1.55	30-50	3
GRACE STREET	38	5	2	0.3	40	2
GRADY LIGHT ROAD	116	6	15	0.9	15-50	4
GRAGG LANE	75	6	13	0.1	20-50	3
GRANDOR LANE	69	5	21	0.13	40	1
GRANDOR STREET	54	5	21	0.4	50	1
GRANDVIEW CIRCLE	31	4	10	0.3	50	2

GRANDVIEW COURT	63	6	7	0.25	50	1
GRANDVIEW DRIVE	31	4	10	0.3	50	2
GRANT PLACE	76	6	13	0.15	40	1
GRASSLAND COURT	63	6	7	0.15	50	1
GRAVEL TOP ROAD	49	4	5	0.25	40	2
GRAVELY ROAD SA-8228 (C)	30	4	11,12	2.27	40-60	1
GRAVEYARD ROAD	70	5	1	0.2	15-50	3
GRAY ROAD	53	5	21	0.3	15-50	4
GRAYBEAL ROAD	97	7	16	0.3	20-50	4
GREEN COURT	107	7	18	0.07	40	2
GREEN DRIVE	66	7	8	0.15	40	2
GREEN HILL DRIVE	38	5	2	0.1	50	1
GREEN HILLS DRIVE	92	6	14	0.3	50	2
GREEN LAKE DRIVE	92	6	14	0.25	40	2
GREEN LANE	79	7	18	0.1	50	1
GREEN MEADOW DRIVE	92	6	14	0.22	50	2
GREEN ROAD	70	5	1	0.1	20-50	3
GREEN SPRINGS ROAD	69	5	21	0.05	30-50	2
GREENBIAR ROAD	92	6	14	0.02	30-50	4
GREENGATE ROAD	92	6	14	0.4	50	1
GREENLEAF DRIVE	92	6	13	0.15	50	2
GREENLEAF ROAD	66	7	4	0.12	50	1
GREENTREE DRIVE	49	4	5	0.33	50	1
GREENWAY ROAD	66	7	5	0.07	50	3
GREENWOOD DRIVE	126	5	16	0.1	15-50	4
GREENWOOD LANE	92	6	14	0.12	35-50	2
GREGORY ROAD	12	4	12	0.2	30-50	2
GREY FOX DRIVE	48	4	7	0.3	50	1
GREYBIL HOLLOW ROAD	99	5	3	0.5	15-50	4
GREYSTONE DRIVE	81	7	8	0.2	30-50	3
GRIMES CIRCLE	106	6	14	0.05	40	1
GROSS ROAD	111	7	16	0.5	20-50	4
GROVE DRIVE	92	6	14	0.3	40	1
GUM SPRINGS ROAD	117	6	15	1.23	40	2
GUNNINGS AVENUE	64	7	5	0.2	30-50	3
GUSTAVIS AVENUE	119	6	13	0.38	50	2
GUSTAVIS COURT	105	6	13	0.05	40	2

H

HAGA ROAD	76	6	13	0.3	30-50	1
HALL CIRCLE	107	6	14	0.2	30-50	3
HALL ROAD	121	6	14	0.5	30-50	2
HALO DRIVE	48	6	7	0.05	30-50	3
HAMILTON DRIVE	108	7	18	0.6	50	2
HAMILTON HILL ROAD	82	7	4	1.05	30-50	2
HAMILTON LANE	82	5	4	0.3	20-50	4
HAMILTON PLACE	92	6	14	0.15	20-50	2
HAMILTON ROAD	108	7	18	3.05	20-50	2
HAMILTON TRAIL	123	7	20	1.65	30-50	2
HAMILTON WAY	92	6	14	0.1	30-50	2
HAMMER ROAD	66	7	5	0.1	50	1
HAPPY HILL ROAD	76	6	13	0.68	30-50	2

HARBOR COURT	96	7	8	0.04	40	1
HARBOR SPRINGS ROAD	62	6	7	0.1	30-50	3
HARDING ROAD	106	6	14	0.17	50	2
HARKLEROAD ROAD	97	7	16	0.15	20-50	2
HARKLEROAD STREET	14	4	10	0.3	50	1
HAROLD HILL ROAD	75	6	13	0.25	30-50	3
HARR DRIVE	35	4	5	0.1	20-50	3
HARR LANE	34	4	6	0.4	20-50	3
HARR ROAD	25	5	19	0.2	30-50	3
HARR TOWN ROAD SA-8232 (C)	49	4	6-7	3.7	40-60	2
HARR TRAIL ROAD	34	4	6	1.15	30-50	2
HARRINGTON HOLLOW ROAD	83	5	3	1.1	20-50	2
HARRISON AVENUE	12	4	12	0.65	20-50	1
HASH HOLLOW ROAD	12	4	12	0.25	30-50	3
HASKEL MILHORN ROAD	108	7	20	0.3	14-50	3
HASKEL WHITAKER ROAD	95	7	8	0.3	20-50	3
HAVEN DRIVE	92	6	14	0.3	40	2
HAVENETTE COURT	92	6	14	0.11	40	3
HAW RIDGE DOCK ROAD	108	7	20	0.25	30-50	3
HAW RIDGE ROAD	109	7	20	2.15	30-50	2
HAW RIDGE ROAD E.	108	7	20	0.01	20-50	3
HAWK STREET	94	7	18	0.27	50	1
HAWKINS LANE	107	7	18	0.1	50	3
HAWLEY ROAD	65	7	5,18	2.7	40	2
HAWLEY ROAD W.	79	7	18	0.35	30-50	3
HAYES LANE	84	5	3	0.05	20-50	4
HAYES ROAD	84	5	3	0.55	20-30	3
HAYES ROAD EXTENSION	84	5	3	0.19	30-50	3
HAYES STREET	30	4	11	0.1	50	1
HAYNES DRIVE	12	4	12	0.15	30-50	3
HAYWOOD DRIVE	30	4	11	0.2	50	2
HEATH ROAD	111	7	16	0.3	20-50	3
HEATHER GLEN DRIVE	119	6	14	0.21	40-50	2
HEATHERVIEW COURT	106	6	14	0.15	40	1
HEATHERWOOD LANE	121	6	14	0.1	50	1
HEDGE DRIVE	14	4	10	0.85	30-50	2
HEDGEROW COURT	119	6	14	0.18	50	2
HELMSDALE DRIVE	64	6	7	0.06	50	1
HEMLOCK COURT	124	7	9	0.06	40	1
HEMLOCK DRIVE	77	6	14	0.15	40	2
HEMLOCK PARK DRIVE	77	6	14	0.1	20-50	3
HEMLOCK PARK PLACE	77	6	14	0.14	30-50	3
HEMLOCK ROAD SA-8208,8209	92	6	14	1.55	40	2
HENDRICKSON ROAD	81	7	8	0.1	20-50	3
HENRY HARR ROAD	64	6	7	1.5	40-50	2
HENRY LANE	121	6	14,18	0.3	30-50	3
HENRY ROAD	95	7	8	0.17	30-50	4
HENSEN AVENUE	124	7	9	0.16	40	1
HENSON HILL ROAD	70	5	1	0.5	30-50	3
HENSON LANE	55	5	1	0.2	20-50	3
HENSON ROAD	23	5	22	1.1	40	1
HERITAGE CIRCLE	54	5	21	0.06	50	1
HERRON DRIVE	107	7	18	0.3	50	1
HEYFORD DRIVE	51	4	5	0.25	50	1
HI DRIVE	106	6	14	0.08	40	1
HIALEAH DRIVE	104	6	15	0.03	50	1
HICKAM ORCHARD ROAD	15	4	10	0.2	20-50	3
HICKAM STREET	14	4	10	0.05	60	2

HICKMAN CHURCH ROAD	50	4	6	0.25	50	3
HICKMAN DRIVE	35	4	5	0.2	20-50	4
HICKMAN ROAD	95	7	8	0.25	30-50	3
HICKORY COURT	111	7	16	0.05	40	1
HICKORY HILL ROAD	97	5	16	0.2	40	2
HICKORY LANE	82	7	4	0.1	40	1
HICKS AVENUE	15	4	10	0.15	30-50	3
HICKS HILL ROAD	125	7	9	0.1	20-50	4
HICKS HOLLOW LANE	66	7	5	0.2	15-50	3
HICKS HOLLOW ROAD	32	4	10	0.4	30-50	3
HICKS LANE	15	4	10	0.3	20-50	3
HICKS ROAD	124	7	9	0.45	50	2
HIDDEN ACRES COURT	31	4	10	0.2	20-50	3
HIDDEN ACRES ROAD	119	6	13	1.19	60	1
HIDDEN PINES DRIVE	119	6	15	0.1	50	1
HIDDEN VALLEY ROAD	106	6	14	1.2	50	1
HIDEAWAY FARM ROAD	109	7	20	1.01	30-50	2
HIGH CIRCLE	68	5	4	0.35	50	2
HIGH OAK ROAD	68	5	4	0.03	50	2
HIGH STREET	135	7	9	0.15	50	1
HIGHFIELD ROAD	19	4	5	0.2	40	2
HIGHLAND DRIVE	66	7	5	0.1	40	2
HIGHLEA DRIVE	92	6	14	0.09	50	2
HIGHRIDGE DRIVE	33	4	7	1.35	30	2
HIGHRIDGE STREET	36	7	5	0.35	50	1
HILL COUNTRY TRAIL	19	4	5	0.2	50	1
HILL DRIVE	68	5	21	0.1	50	1
HILL LANE	33	4	6	0.05	30-50	2
HILL ROAD	49	6	7	1.01	50	1
HILL TOP CIRCLE	68	5	4	0.16	50	1
HILLANDALE DRIVE	92	6	14	0.3	50	1
HILLARD ROAD	39	5	2	0.02	20-50	4
HILLSBORO DRIVE	36	4	5	0.15	50	1
HILLSBORO ROAD	66	7	5	0.5	50	1
HILLTOP DRIVE	66	7	4	0.05	50	1
HILLTOP ROAD	34	4	6	0.05	30-50	3
HILLVIEW ROAD	119	6	13	0.14	50	2
HILLVIEW STREET	68	5	21	0.05	50	1
HILLVUE DRIVE	106	6	4	0.1	50	1
HILTON HILL ROAD	93	7	18	0.55	50	2
HILTON STREET	92	6	13	0.1	30-50	3
HINES ROAD	34	4	6	0.25	30-50	2
HINKLE DRIVE	70	5	1	0.15	15-50	4
HINKLE ROAD	75	6	13	0.2	16-50	3
HISTORIC HILLS ROAD	91	6	13	0.18	40	2
HOBART STREET	48	6	7	0.15	50	1
HOBBS HOLLOW ROAD	34	4	6	1.3	30-50	2
HOBBS STREET	48	6	7	0.09	40	1
HOLCOMB STREET	31	4	10	0.45	30-50	3
HOLDEN DRIVE	107	6	14	0.2	20-50	3
HOLIDAY HILLS ROAD	48	6	7	0.25	50	1
HOLLAND DRIVE	92	6	2	0.1	40	2
HOLLY POINT	124	7	9	0.05	40	1
HOLLYDALE DRIVE	121	6	14	0.15	50	1
HOLSTON DRIVE	79	7	18	2.01	30-50	3
HOLSTON INDUSTRIAL DRIVE	79	7	18	0.16	50	1
HOLSTON INSTITUTE DRIVE	65	7	5	0.35	30-50	2
HOLSTON VALLEY GOLF CRS RD	38	5	2	0.17	20-50	3

HOLSTON VIEW DAM ROAD	55	5	1	2.85	40	2
HOLSTON VIEW TRAIL	40	5	22	0.25	20	4
HOMESTEAD DRIVE	92	6	13	0.31	50	1
HONEYCUT DRIVE	104	6	15	0.2	15-50	4
HONEYSUCKLE DRIVE	106	6	14	0.15	20-50	3
HONEYSUCKLE LANE	90	6	15	0.1	30-50	2
HONEYSUCKLE PLACE	106	6	14	0.2	20-50	3
HOOD ROAD	75	6	13	0.8	30-50	2
HOOD ROAD W.	75	6	13	0.4	40	2
HOOKER ROAD	17	4	6	1.5	30-50	2
HOOT OWL HOLLOW ROAD	55	5	1	0.2	20-50	4
HOOVEN STREET	48	4	10	0.25	30-50	4
HOPKINS ROAD	96	7	8	0.35	20-50	3
HOPKINS STREET	63	6	7	0.1	50	1
HORSESHOE BEND	118	6	15	0.23	40	1
HORSESHOE DRIVE	106	6	14	0.33	20-50	3
HORTON DRIVE	36	7	5	0.3	50	1
HOUSTON LANE	110	7	9	0.15	30-50	4
HOWARD CEMETERY ROAD	14	4	10	0.07	50	2
HUCKLEBERRY ROAD	97	7	16	0.5	50	1
HUDSON ROAD	123	7	9	0.1	20-50	3
HUFFMAN HILL ROAD	135	7	9	0.25	40	2
HUFFMAN ROAD	135	7	9	0.1	30-50	2
HUGHES DRIVE	90	6	15	0.17	50	1
HUGHES ROAD	124	7	9	0.25	20-50	3
HUMPHREYS ROAD	135	7	9	0.7	30-50	2
HUNTERS CROSSING LANE	105	6	13	0.35	50	1
HUNTERS TRAIL	34	4	6	0.35	30-50	3
HUNTING HILL ROAD	110	7	9	1.8	40	2
HURON CIRCLE	49	4	7	0.04	50	1
HUTCHINSON DRIVE	30	4	11	0.4	50	1
HYATT HOLLOW ROAD	124	7	9	0.15	20-50	4
HYDAWAY PLACE	49	6	7	0.05	30-50	3
HYDER AVENUE	13	4	11	0.05	50	2
HYDER HILL ROAD SA-8219	134	7	9	0.5	20-50	3

I

I-81N (STATE)	51	4		0		
I-81S (STATE)	19	4		0		
IDLE HOUR ROAD	30	4	11	0.38	40	1
IDLEWILD DRIVE	90	6	15	0.2	30-50	2
IMPALA DRIVE	30	4	11	0.15	30-50	2
IMPERIAL CIRCLE	30	4	11	0.03	40	1
IMPERIAL DRIVE	120	6	14	0.12	40	1
INCA LANE	64	7	1	0.1	50	1
INDEPENDENCE DRIVE	30	4	11	0.7	30-50	2
INDEPENDENCE DRIVE E.	13	4	11	0.13	30-50	3
INDEPENDENCE DRIVE W.	13	4	11	0.13	30-50	3
INDIAN RIDGE DRIVE	30	4	11	0.1	50	1
INDIAN ROAD	109	7	20	0.18	40	2
INDUSTRIAL PARK ROAD	124	7	9	1.55	60	1
INTERMONT LANE	39	5	22	0.06	50	1

IROQUOIS LANE	49	7	7	0.05	50	1
ISAAC STREET	31	4	10	0.05	30-50	3
ISLAND COURT	97	5	16	0.2	40	2
ISLAND DRIVE	61	6	13	0.15	40	2
ISLAND LANE	35	4	5	0.05	30-50	3
ISLAND ROAD SA-8233	35	4	5	12.9	30-60	2
ISLAND ROAD N.E.	19	4	5	0.23	40	2
ISLEY DRIVE	78	7	7	0.65	30-50	1
ISLEY ROAD SA-8233	50	4	5	0.8	30-50	2
IVANHOE STREET	90	6	15	0.15	30-50	2
IVORY STREET	76	6	13	0.15	40	1
IVY DALE	121	6	14	0.05	50	1
IVY DRIVE	92	6	14	0.25	30-50	2

J

J.A. HODGE ROAD	134	7	20	0.7	30-50	2
J.H. FAUVER ROAD	34	4	6	1.3	30-50	1
JACKSON HOLLOW ROAD	107	6	14	1.5	30-50	2
JACOB CREEK ROAD	41	5	19	0.35	30-50	1
JADE COURT	48	4	7	0.05	40	1
JARED DRIVE SA-8208	61	6	13	0.62	40	1
JARRETT DRIVE	112	5	16	0.25	20-50	3
JAYNE ROAD	75	6	13	0.1	40	2
JEAN STREET	121	6	14	0.15	50	1
JENKINS HOLLOW ROAD	112	5	16	0.6	12-50	4
JENKINS ROAD	99	5	3	0.3	20-50	4
JETT ROAD	76	6	13	0.13	30-50	1
JOBE ROAD	98	5	3	0.14	20-50	4
JOHN PHILLIPS ROAD	103	6	15	0.11	20-50	4
JOHNNY CARRIER HOLLOW	84	5	3	0.38	30-50	3
JOHNSON CEMETERY ROAD	35	4	5	0.6	15-50	3
JOHNSON CHAPEL ROAD	19	4	6	0.85	30-50	1
JOHNSON HOLLOW ROAD	35	4	5	0.65	30-50	2
JONES CEMETARY ROAD	137	7	4	0.3	15-50	4
JONES HOLLOW ROAD	39	5	1	0.2	20-50	3
JONES LANE	125	7	16	0.15	20-50	4
JONES ROAD	7	5	22	0.23	20-50	3
JONESBORO DRIVE	111	7	16	0.45	30-50	3
JONESBORO ROAD	124	7	9	0.9	30-50	2
JULIP DRIVE	106	6	14	0.15	50	1
JUNIPER CIRCLE	68	5	4	0.13	50	1
JUSTIN DRIVE	121	6	14	0.05	40	2

K

KALLEN DRIVE	13	4	11	0.45	50	2
KALUNA AVENUE	82	7	4	0.35	50	1

KANAN DRIVE	105	6	13	0.25	50	1
KATHERINE STREET	14	4	10	0.2	30-50	2
KATIE LANE	52	7	5	0.4	20-50	3
KAYLOR ROAD	126	5	16	0.1	20-50	3
KEENBURG ROAD	137	7	16	0.3	15-50	3
KEENELAND COURT	104	6	15	0.04	40	2
KEITH ROAD	19	4	5	0.2	40	2
KELLY LANE	48	4	7	0.3	30-50	3
KELSO COURT	104	6	15	0.07	40	2
KENDLEWORTH DRIVE	75	6	13	0.15	30-50	2
KENDRICKS CREEK RD.SA-8204(C	106	6	14	3.01	50-60	1
KENDRICK STREET	92	6	14	0.1	50	1
KENDRICKS HOLLOW ROAD	35	4	5	0.55	10-50	2
KENNEDY DRIVE	91	6	13	0.08	50	2
KENNERLY ADDITION ROAD	106	6	14	0.1	10-50	4
KENNY STREET	51	7	5	0.05	30-50	2
KENTFIELD DRIVE	30	4	11	0.15	50	1
KERRY COURT	30	4	11	0.03	50	2
KESTNER STREET	14	4	10	0.12	40	2
KESTNERS ROAD	24	5	22	0.1	20-50	4
KETRON DRIVE	31	4	10	0.2	50	2
KEYSTONE DRIVE	51	7	5	0.4	50	1
KILKENNY ROAD	49	6	7	0.4	50	1
KIM DRIVE	107	6	14	0.45	30-50	2
KIMBERLY DRIVE	92	6	14	0.05	40	2
KIMBERLY ROAD	105	6	13	0.5	40	1
KIMBERLY STREET	36	4	5	0.3	50	1
KINCAID STREET	30	4	11	0.55	30-50	2
KING LANE	23	5	22	0.72	30-50	3
KINGSBERRY COURT	106	6	14	0.06	40	3
KINGFISHER COURT	106	6	14	0.12	40	1
KINGS GRANT ROAD	91	6	13	0.09	50	2
KINGS RIDGE DRIVE	63	6	7	0.2	40	2
KINGS ROAD	124	7	9	0.31	50-70	1
KINGS VIEW ROAD	30	4	11	0.07	50	2
KINGSLEY AVENUE	31	4	10	0.6	30-50	2
KINGSPORT HIGHWAY (STATE-11W	20	4		0		
KINGSTON ROAD	66	7	4	0.26	50	1
KINKEAD DRIVE	19	4	5	0.1	40	4
KINZER LANE	13	4	11	0.1	30-50	2
KIOWA STREET	49	4	7	0.65	50	1
KISTNER ROAD	118	6	15	0.4	20-50	3
KITZMILLER ROAD	120	6	14	0.25	30-50	3
KNOB PARK ROAD	23	5	22	2.01	30-50	2
KNOBVIEW ROAD	51	4	5	0.25	50	1
KNOTTSBURY LANE	64	7	5	0.1	40	2
KNOX POPE ROAD	103	6	15	0.5	20-50	4
KYTE ROAD	112	5	16	0.4	15-50	4

L

L. JONES ROAD	124	7	9	1.05	40	2
LAKE AIRE	107	6	14	0.2	40	1

LAKE BREEZE DRIVE	108	7	18	0.05	40	2
LAKE DRIVE	109	7	20	0.6	30-50	2
LAKE FOREST DRIVE	107	6	14	0.53	40-50	1
LAKE HOLLOW ROAD	95	7	8	0.2	50	1
LAKE PARK COURT	63	6	7	0.15	50	1
LAKE PARK DRIVE	63	6	7	0.3	50	1
LAKE POINT COURT	95	7	8	0.05	40	2
LAKE POINT DRIVE	140	7	20	1.38	30-50	2
LAKECREST DRIVE	92	6	14	0.75	30-50	2
LAKEFIELD CIRCLE	92	6	14	0.05	30-50	2
LAKEFRONT LANE	96	7	16	0.19	40	2
LAKENHEATH DRIVE	51	7	5	0.35	50	1
LAKERIDGE DRIVE	107	6	14	0.1	30-50	2
LAKERIDGE STREET	107	6	14	0.85	30-50	2
LAKESHORE DRIVE	106	6	14	0.37	50	1
LAKESHORE ROAD	96	7	4	0.7	50	1
LAKESIDE DOCK DRIVE	108	7	18	0.97	40	2
LAKESIDE LANE	92	6	14	0.2	40	2
LAKEVIEW CIRCLE	92	6	14	0.6	50	2
LAKEVIEW DOCK ROAD	55	5	1	2.4	20-50	3
LAKEVIEW DRIVE	97	7	16	0.55	40	2
LAKEVIEW STREET	81	7	8	0.05	20-50	3
LAKEWIND DRIVE N.	109	7	20	0.17	40	2
LAKEWIND DRIVE S.	109	7	20	0.16	40	2
LAKEWOOD DRIVE	106	6	14	0.16	40	1
LAMBERTH STREET	48	4	10	0.15	30-50	2
LANA VIEW DRIVE	48	4	7	0.15	50	2
LANCASTER DRIVE	106	6	14	0.28	50	1
LANCER ROAD	31	4	11	0.25	50	2
LONDON COURT	48	6	7	0.06	40	1
LANE HOLLOW ROAD	141	7	9	0.66	25-50	3
LANE ROAD	104	6	15	0.3	30-50	3
LARKINS STREET	54	5	21	0.2	50	1
LARKMEADOWS CIRCLE	83	5	21	0.15	50	1
LARKSPUR DRIVE	30	4	11	0.4	50	1
LATIMER STREET	30	4	11	0.15	30-50	2
LATTURE LANE	17	4	6	0.8	30-50	1
LAURA LAND	57	5	19	0.12	20-50	4
LAUREL COURT	124	7	9	0.06	40	1
LAUREL DRIVE	36	4	5	0.1	50	2
LAWSON DRIVE	34	4	6	0.4	40	2
LAZY ACRES	53	5	21	0.2	30-50	1
LAZY LANE	92	6	14	0.23	50	2
LEANING PINE ROAD	90	6	15	0.17	50	2
LEBANON ROAD SA-8209	92	6	14	3.23	40-50	1
LEELAND DRIVE	30	4	11	0.5	30-50	2
LEHIGH STREET	48	4	10	0.07	30-50	2
LEMAY DRIVE	48	6	7	0.12	50	1
LENOIR ROAD	31	4	10	0.65	40	2
LEONARD LANE	50	4	5	0.35	30-50	1
LEONARD ROAD	52	7	4	0.13	15-50	3
LESLIE COURT	106	6	14	0.1	40	1
LESTER ROAD	33	4	6	0.3	30-50	2
LEWIS ROAD	83	5	16	0.29	20-50	3
LEWIS STREET	67	7	4	0.1	50	2
LIBERTY CHURCH ROAD	121	6	14	0.5	40	2
LIGHT CEMETERY ROAD	116	6	15	0.2	20-50	4
LIGHT HOLLOW ROAD	116	6	15	1.4	30-50	1

LIGHT STREET	92	6	14	0.3	30-50	2
LIGHT STREET EXTENSION	92	6	14	0.1	25-50	3
LIGHTWOOD STREET	14	4	10	0.5	50	3
LINCOLNSHIRE CIRCLE	119	6	14	0.11	50	3
LINDA COURT	48	6	7	0.06	40	1
LINDENWOOD DRIVE	92	6	13	0.13	50	1
LINDKAYE DRIVE	92	6	14	0.09	50	2
LINK ROAD	36	7	5	0.1	30-50	2
LISA LANE	124	7	9	0.52	40-50	1
LITTLE ECHO COURT	92	6	14	0.05	50	1
LITTLE OAK RD.(FOREST SER.)	72	5		0		
LITTLE VALLEY ROAD	90	6	13	0.55	30-50	4
LITTLETON ROAD	117	6	15	0.25	20-50	3
LIVE OAK DRIVE	30	4	11	0.1	40	1
LOCKPOINT CIRCLE	91	6	13	0.04	50	1
LOCUST HILL LANE	54	5	21	0.08	40	1
LOCUST STREET	48	4	10	0.05	30-50	3
LOLA MERE DRIVE	15	4	10	0.11	40	3
LONE OAK DRIVE	92	6	14	0.25	30-50	3
LONE OAK LANE	36	4	5	0.1	25-50	3
LONE STAR RD. (STATE-347)	103	6		0		
LONESOME PINE ROAD	48	6	7	0.2	50	1
LONEWOOD DRIVE	107	6	14	0.3	50	1
LONG HOLLOW ROAD	90	6	13	1.01	30-50	2
LONG STREET	12	4	12	0.15	30-50	3
LONGVIEW DRIVE	68	5	21	0.15	50	1
LOOKOUT DRIVE	106	6	14	0.12	40	1
LORI'S LANE	123	7	20	0.28	50	2
LOUDERMILK DRIVE	55	5	1	0.12	30-50	3
LOUISE LANE	65	4	5	0.5	50	1
LOWE ROAD	110	7	9	0.15	30-50	4
LOWRANCE DRIVE	31	4	10	0.46	50	2
LUCERNE LANE	107	6	14	0.05	50	1
LUCINDA ROAD	31	4	11	0.07	50	1
LUCY PLACE	14	4	10	0.15	40-50	2
LUCY ROAD	14	4	10	0.85	50	2
LUKE MCKAMEY ROAD	123	7	20	0.3	20-50	3
LYNCH ROAD	29	4	12	1.3	30-50	2
LYNN ROAD	63	6	7	1.6	40	2
LYNNWOOD COURT	48	4	7	0.05	40	1
LYONS ROAD	126	7	16	0.4	15-50	4

M

M. ROAD	30	4	11	0.15	20-50	3
MACK COURT	92	6	13	0.04	40	2
MAGIC VIEW DRIVE	30	4	11	0.45	30-50	2
MAGNOLIA COURT	124	7	9	0.1	40	1
MAHLON DRIVE	92	6	14	0.2	50	2
MAIN STREET SA-8220	135	7	9	0.35	40	1
MALONE ROAD	136	7	9	0.1	20-50	4
MANCHESTER PLACE	106	6	14	0.11	40	1
MANDAN ROAD	48	4	7	0.2	50	1

MAPLE DRIVE	36	7	5	0.15	30-50	2
MAPLE LANE	51	7	5	0.05	50	1
MAPLE STREET SA-8213	94	7	18	0.25	30-50	2
MAPLEHURST LANE SA-8226	82	7	4	0.4	50	1
MAPLEVIEW DR.	51	7	5	0.12	25-50	3
MAPLEWOOD STREET	90	6	15	0.2	30-50	2
MARBLE STREET	90	6	13	0.02	40	4
MARCUM AVENUE	29	4	12	0.05	20-50	4
MARCUS STREET	121	6	14	0.05	25-50	3
MARCUS STREET E.	121	6	14	0.05	25-50	3
MARIETTA STREET	31	4	10	0.2	40	2
MARION STREET	30	4	11	0.07	30-50	3
MARKET STREET SA-8232	33	4	6	0.7	30-50	1
MARLENE DRIVE	38	5	2	0.2	40	2
MARY JANE ROAD	103	6	15	0.3	25-50	3
MASENGILL ROAD SA-8234	51	4	5	2.2	30-50	2
MASENGILL AVENUE	51	4	5	0.1	30-50	3
MASENGILL PARK ROAD	96	7	8	0.55	30-50	2
MASENGILL PLACE	125	7	16	0.15	50	2
MAYFAIR ROAD	106	6	14	0.08	50	2
MAYFIELD AVENUE	12	4	12	0.45	40-50	2
MAYFIELD DRIVE	68	5	21	0.18	50	1
MAYWOOD DRIVE	30	4	11	0.25	50	1
MCCLAIN ROAD	15	4	10	0.74	40	1
MCCONNELL STREET	32	4	10	0.1	30-50	3
MCCREARY AVE	14	4	10	0.05	50	3
MCCULLEY LANE	91	6	13	0.2	30-50	2
MCCULLEY PLACE	91	6	13	1.85	30-50	2
MCFARLAND DRIVE	48	4	10	0.17	30-50	2
MCGREGOR DRIVE	30	4	11	0.35	40	2
MCINTOSH DRIVE	106	6	14	0.35	50	1
MCKAMEY STREET	135	7	9	0.2	20-50	4
MCKEE ROAD	123	7	9	0.5	30-50	3
MCKENZIE DRIVE	29	4	12	0.02	30-50	2
MCKINNEY DRIVE	76	6	13	0.2	30-50	2
MCKINNEY STREET	76	6	13	0.22	30-50	2
MCLANEY ROAD	136	7	9	0.35	30-50	4
MCLEAN DRIVE	12	4	12	0.1	40	2
MCMURRAY ROAD	33	4	7	0.2	20-50	3
MCNEIL STREET	12	4	12	0.15	30-50	3
MCTEER DRIVE	92	6	14	0.25	50	2
MEADE TRAIL	92	6	14	0.2	30-50	2
MEADOW BROOK DRIVE	106	6	14	0.21	50	1
MEADOW BROOK LANE	33	4	6	0.15	50	1
MEADOW CREEK RD. SA-8240 (C)	55	5	1	0.7	30-60	2
MEADOW CREST DRIVE	106	6	14	0.05	40	1
MEADOW DALE CIRCLE	106	6	14	0.05	40	1
MEADOW DRIVE	68	5	21	0.1	50	1
MEADOW GLADE CIRCLE	106	6	14	0.05	60	1
MEADOW GLEN CIRCLE	106	6	14	0.03	40	1
MEADOW GLEN DRIVE	19	4	5	0.11	50	1
MEADOW LANE	106	6	14	1.65	50	1
MEADOW LANE EXTENSION	92	6	14	0.02	40	3
MEADOW LARK LANE	67	7	11	0.1	40	1
MEADOW STREET	20	4	5	0.1	20-50	3
MEADOW VIEW ROAD	19	4	5	2.05	30-50	2
MEGAN COURT	78	6	7	0.1	40	3
MELLWOOD DRIVE	30	4	11	0.05	50	2

MELROSE	91	6	13	0.13	20-50	3
MEMORIAL BLVD. (STATE-126)	48	6		0		
MERMAN ROAD	106	6	14	1.01	50	1
MERRY ANNE DRIVE	96	7	8	0.15	50	1
MERRY OAKS DRIVE	106	6	14	0.09	50	1
MESA DRIVE	105	6	13	0.13	50	2
METHODIST BIBLE CAMP ROAD	94	7	8	0.3	30-50	3
METHODIST CHURCH STREET	135	7	9	0.12	20-50	3
MIA DRIVE	19	7	5	0.15	50	2
MICHELLE DRIVE	31	4	10	0.1	50	2
MIDFIELD DRIVE	68	5	21	0.15	50	1
MIDWAY DRIVE	36	4	5	0.55	30-50	2
MILBURN AVENUE	31	4	10	0.15	50	2
MILDEN HALL ROAD	51	7	5	0.3	50	1
MILHORN DRIVE	82	7	4	0.25	30-50	2
MILHORN ROAD	121	6	14	0.3	30-50	3
MILL CREEK RD. SA-8203 (C)	104	6	15	3.46	60	2
MILL ROAD	33	4	6	0.16	20-50	3
MILLER HOLLOW ROAD	112	5	16	0.4	10-50	4
MILLINGTON COURT	119	6	14	0.07	50	1
MINGA ROAD	108	7	18	1.7	40	1
MINGA STORE ROAD	121	7	18	0.4	30-50	3
MINUTEMAN DRIVE	82	5	4	0.15	50	1
MISSION DRIVE	51	7	5	0.1	15-50	4
MISTY DRIVE	90	6	13	0.2	50	2
MITCHELL ROAD	120	6	14	2.45	40	1
MITCHELL-KIDD DRIVE	96	7	8	0.25	40	2
MOBLEY ROAD	66	7	5	0.1	20-50	3
MOCCASIN STREET S.	12	4	12	0.06	30-50	3
MOCKINGBIRD LANE	105	6	13	0.5	30-50	2
MOCKINGBIRD PLACE	50	4	5	0.13	40	1
MOHAWK CIRCLE	49	7	7	0.03	40	1
MOHAWK STREET	12	4	12	0.3	30-50	3
MOHICAN LANE	49	7	7	0.1	50	1
MONTANA AVENUE	30	4	11	0.3	20-50	3
MONTE VISTA DRIVE	30	4	11	0.6	50	1
MONTEZUMA ROAD	49	4	7	1.15	50	1
MONTFORD DRIVE	92	6	14	0.08	50	2
MONTSWEAG COURT	119	6	15	0.3	40	2
MONTVUE ROAD	106	6	14	0.06	50	3
MOODY DRIVE	63	6	7	0.25	50	1
MOODY LANE	78	6	7	0.15	40	2
MOORE DRIVE	35	4	5	0.25	30-50	2
MOORE ROAD	70	5	1	0.43	20-50	4
MORELAND DRIVE SA-8208 (C)	76	6	13,14	2.9	100+	1
MORELOCK DRIVE	80	7	5	0.9	50	2
MORELOCK ROAD	116	6	15	0.4	20-50	4
MORELOCK STREET	31	4	10,11	1.4	40-50	2
MORNING DOVE DRIVE	106	6	14	0.21	50	1
MORNINGDALE DRIVE	119	6	13	0.08	50	2
MORRELL CREEK LANE	85	5	1	1.3	30-50	2
MORRELL CREEK ROAD	84	5	1	1.85	30-50	2
MORRELL DRIVE	33	4	6	0.2	30-50	3
MORRELL ROAD	84	5	1	0.14	20-50	3
MORRELL TOWN ROAD	84	5	1	1.01	40	2
MORRISON AVENUE	31	4	10	0.15	50	2
MORSBY COURT	14	4	10	0.05	50	1
MORTON HOLLOW ROAD	33	4	6	0.4	20-50	3

MOTTERN DRIVE	51	4	5	0.07	30-50	3
MOUNT AREA DRIVE	36	7	5	0.45	50	1
MOUNT HOLSTON ROAD	99	5	3,16	2.01	30-50	2
MOUNT VERNON DRIVE	48	4	10	0.26	30-50	2
MOUNT VIEW ROAD	91	6	13	0.23	50	2
MOUNTAIN MEADOWS DRIVE	123	7	20	0.14	50	2
MOUNTAIN ROAD (FOREST SERVIC	57	5		0		
MOUNTAIN VIEW CIRCLE	124	7	9	0.2	50	1
MOUNTAIN VIEW COURT	81	7	8	0.12	50	1
MOUNTAIN VIEW DR. SA-8220	135	7	9	2.1	40-50	2
MOUNTAIN VIEW LANE	125	7	16	0.15	30-50	3
MOUNTAIN VIEW ROAD	111	7	16	1.1	30-50	2
MUDDY CRK RD. SA-8213,8214(C	65	7	5-8-18	4.9	30-60	1
MULLENIX LANE	104	6	15	0.05	15-50	3
MULLENIX ROAD	116	6	15	0.4	15-50	3
MURRELL ROAD	103	6	15	2.14	40-50	1
MUSTANG DRIVE	48	4	10	0.15	30-50	2
MYRANDA LANE	13	4	11	0.15	30-50	3
MYRON STREET	30	4	11	0.1	50	1

N

N. HARR TRAIL ROAD	34	4	6	0.1	30-50	2
N. HOLSTON RIVER DR.(C)	29	4	12	1.5	60	2
N. HOLSTON RIVER DRIVE EXT	12	4	12	0.25	20-50	3
N. PAPERVILLE ROAD	21	5	2	0.95	40	2
N. VALLEY VIEW CIRCLE	48	6	7	0.2	40	2
NANKATIE DRIVE	92	6	14	0.08	40	2
NAT MULLENIX ROAD	116	6	15	0.12	30-50	3
NATCHEZ LANE	49	4	7	0.25	50	1
NAVAHO LANE	64	7	7	0.05	50	1
NAVE CROSS ROAD	126	7	16	0.35	20-50	3
NAVE DRIVE	121	6	14	0.04	40	1
NEAL DRIVE	50	4	5	0.2	30-50	2
NEAL LANE	30	4	11	0.05	50	1
NED KING ROAD	135	7	9	0.25	30-50	3
NEELEY DRIVE	65	7	5	0.04	50	2
NEELEY LANE	65	7	5	0.05	50	2
NEELEY PLACE	65	7	5	0.2	40	2
NELSON AVENUE	124	7	9	0.47	50	1
NETTIE HILL ROAD	25	5	19	1.15	30-50	2
NEW BEASON WELL ROAD (C)	31	4	10	1.73	80	1
NEW BETHEL ROAD	123	7	20	1.1	40	2
NEW CAMP RIDGE ROAD	25	5	19	0.1	20-50	4
NEW MOORE ROAD	76	6	13	0.6	50	1
NEW SUMMVERVILLE ROAD	105	6	13	0.85	50	1
NEWLAND AVENUE	14	4	10	0.45	50	2
NICOLE LANE	82	5	16	0.21	50	1
NITA STREET	38	5	2	0.1	40	2
NORTHCOTT CIRCLE	30	4	11	0.25	40	2
NORTHCOTT DRIVE	30	4	11	0.6	30-50	2
NORTHCOTT LANE	31	4	10	0.06	40	3
NORWOOD DRIVE	68	5	4	0.07	50	2

NOTTINGHAM ROAD	32	4	10	0.27	30-50	3
O						
O'DELL ROAD	69	5	21	0.3	15-50	4
OAK COURT	92	6	14	0.03	50	1
OAK DALE ROAD	96	7	4	0.55	40-60	2
OAK FOREST PLACE	105	6	13	0.35	50	1
OAK HAVEN DRIVE	105	6	13	0.18	50	1
OAK LANE	67	7	4	0.2	50	1
OAK PLACE	51	7	5	0.05	50	1
OAK STREET	51	7	5	0.4	50	1
OAK TREE LANE	92	6	14	0.04	40	2
OAKLAWN STREET	76	6	13	0.08	40	2
OAKLEAF DRIVE	92	6	13	0.1	60	1
OAKMONT DRIVE	106	6	14	0.68	60	1
OAKWOOD ROAD	35	4	5	1.2	40-60	1
OASIS LANE	75	6	13	0.15	30-50	2
ODD FELLOW ROAD	49	6	7	0.4	30-50	2
ODESSA ROAD	48	6	7	0.1	40	2
OFFIELD HOLLOW ROAD	55	5	1	0.6	15-50	4
OFFSET ROAD	9	5	19	0.35	40	1
OKEY MOWELL ROAD	102	6	15	0.2	20-50	4
OLD ADAMS CHAPEL ROAD	65	7	5	0.15	20-50	3
OLD AIRPORT ROAD	65	7	5	0.2	20-50	3
OLD BEASON WELL ROAD	31	4	10	1.25	50	2
OLD BEAVER CREEK ROAD	81	7	4	0.55	50	2
OLD BEIDLEMAN ROAD	55	5	1	0.4	30-50	3
OLD BELL HOLLOW ROAD	104	6	15	0.4	20-50	3
OLD BETHEL ROAD	67	7	4	0.25	40	1
OLD BLAIRS GAP ROAD	117	6	15	3.26	30-50	2
OLD CARDEN HOLLOW ROAD	67	7	4	0.5	20-50	4
OLD DUMP ROAD	51	7	5	0.1	20-50	4
OLD DUNLAP ROAD	93	7	18	0.1	30-50	3
OLD ELIZABETHTON HWY.SA-8221	97	7	16	2.2	30-50	2
OLD ELIZABETHTON HIGHWAY S.	125	7	16	0.85	30-50	2
OLD FALL CREEK ROAD	48	6	7	0.2	40	2
OLD FORDTOWN ROAD	120	6	14	0.6	30-50	1
OLD HARR TRAIL ROAD	34	4	6	0.05	30-50	3
OLD HICKORY TREE ROAD	55	5	1	2.1	40	2
OLD J.A. HODGE ROAD	134	7	20	0.15	30-50	3
OLD JONESBORO ROAD SA-8237	54	5	2,21	3.01	50	2
OLD MILL CREEK ROAD	104	6	15	0.04	40	2
OLD MILL ROAD (C)	63	6	7	0.1	30-60	3
OLD MORELAND DRIVE	91	6	13	0.28	40	2
OLD MOUNTAIN VIEW ROAD	125	7	16	0.04	30-50	3
OLD MUDDY CREEK ROAD	95	7	8	0.93	30-50	2
OLD OAK LANE	84	5	3	0.44	40	2
OLD PACTOLUS ROAD	76	6	13	0.1	20-50	4
OLD ROCK HILL ROAD	136	7	9	0.47	20-50	4
OLD SHADY ROAD	40	5	22	0.2	40	2
OLD SILVER GROVE ROAD	83	5	3	0.2	30-50	2
OLD STAGE COACH ROAD	65	7	5	0.35	30-50	2

OLD STAGE DRIVE	19	7	5	0.75	50	2
OLD STAGE ROAD	47	4	7	1.67	30-50	2
OLD STAGE TRAIL	36	7	5	1.25	40	2
OLD THOMAS BRIDGE ROAD	67	7	4	0.53	15-50	2
OLD WEAVER PIKE	83	5	3	1.01	40	2
OLD WHITE TOP ROAD	82	5	4	0.3	40	2
OLINGER DRIVE	15	4	10	1.01	30-50	2
OLINGER ROAD	33	4	6	0.3	30-50	3
OLLIS BOWERS HILL ROAD	33	4	10	0.45	30-50	1
OLYMPUS CIRCLE	120	6	14	0.06	40	1
OLYMPUS DRIVE	120	6	14	0.22	50	1
OMAR DRIVE	91	6	13	0.18	50	2
ONEIDA COURT	49	4	7	0.2	50	1
ORANGE STREET	31	4	10	0.1	30-50	2
ORBIN DRIVE	46	4	1	0.2	40	1
ORCHARD LANE	67	7	4	0.12	50	1
OREBANK ROAD (C)	48	4	10	1.47	30-60	2
ORVILLE LIGHT ROAD	116	6	15	0.26	15-50	4
OSAGE DRIVE	75	6	13	0.3	40	2
OSBORNES DRIVE	125	7	16	0.15	40	3
OSCEOLA DRIVE	49	4	7	0.15	50	1
OTARI DRIVE	76	6	13	0.55	40	1
OVERHILL DRIVE SA-8244	64	4	6	1.2	50	1
OVERHILL LANE	49	4	6	0.1	40	2
OVERHILL ROAD	31	4	10	0.1	30-50	3
OVERLOOK DRIVE	66	7	4	0.6	50	1
OVERLOOK ROAD	68	5	21	0.1	50	1
OVERVIEW COURT	92	6	14	0.03	40	2
OXFORD COURT	119	6	14	0.1	50	2

P

PACKINGHOUSE ROAD (C)	31	4	10	1.9	60	2
PACTOLUS EXTENSION	91	6	13	0.08	40	2
PACTOLUS ROAD	91	6	13	1.2	40-50	2
PADDLE CREEK ROAD	68	5	21	2.1	40	2
PAGE STREET	14	4	2	0.25	50	2
PAINTER CREEK ROAD	7	5	22	1.8	40	2
PAINTER ROAD	23	5	22	0.3	20-50	2
PAISLEY LANE	85	5	1	0.05	40	2
PALMER ROAD	90	6	13	0.3	20-50	3
PALMYRA DRIVE	120	6	14	0.07	40	1
PAMELA COURT	65	7	5	0.45	50	2
PAPERVILLE ROAD (C)	21	5	2	2.22	60	2
PARAMOUNT DRIVE	36	7	5	0.3	50	1
PARIS AVENUE	29	4	12	0.02	30-50	3
PARK DRIVE	61	6	13	0.44	40	2
PARK PLACE DR.	92	6	14	0.11	50	1
PARK RIDGE COURT	78	6	7	0.2	40	2
PARK TERRACE RD.	92	6	14	0.02	50	1
PARKVIEW CIRCLE	124	7	9	0.08	60	2
PARKER HILL DRIVE	12	4	12	0.1	30-50	3
PARKER LANE	29	4	12	0.85	30-50	3
PARKER STREET	48	6	7	0.15	30-50	3

PARKS ROAD	1	5	19	0.15	30-50	3
PARKWAY DRIVE	92	6	14	0.28	60	4
PARSON DRIVE	30	4	11	0.1	30-50	2
PARTON DRIVE	30	4	11	0.2	30-50	2
PARTRIDGE PLACE	106	6	14	0.12	40	1
PATRICK HENRY CIRCLE	107	6	14	0.55	40	1
PATTERSON HILL ROAD	81	7	8	1.2	25-50	3
PATTON CIRCLE	98	5	16	0.25	20-50	3
PATTY BRANCH ROAD	41	5	19	0.4	30-50	3
PAULINE ROAD	14	4	10	0.1	30-50	3
PEACH ORCHARD DRIVE	29	4	12	0.1	30-50	3
PEACHTREE DRIVE	48	4	7	0.04	40	1
PEALER ROAD	141	7	9	0.05	20	3
PEARL LANE	78	6	7	0.55	50	1
PEAVLER DRIVE	31	4	10	0.15	50	2
PEBBLE DRIVE	30	4	11	0.1	40	2
PEERS STREET	48	6	7	0.09	50	1
PEMBERTON ROAD (C)	55	5	22	2.35	30-60	2
PENDLETON ROAD	33	4	6	0.33	30-50	3
PENNSYLVANIA AVENUE	14	4	10	0.2	30-50	2
PENNSYLVANIA ROAD	90	6	13	0.07	30-50	2
PEOPLES ROAD	69	5	21	1.5	30-50	2
PEPPERTREE COURT	119	6	13	0.06	50	3
PEPPERTREE DRIVE	119	6	13	0.5	50	1
PERRY ROAD	126	7	16	0.2	20-50	3
PETERS ROAD	54	5	21	0.1	40	4
PETTYJOHN ROAD	63	6	7	0.85	50	1
PHEASANT COURT	106	6	14	0.05	40	2
PHILON DRIVE	31	4	11	0.09	50	1
PICKENS BRIDGE RD.SA-8217(C)	124	7	9	3.5	60	1
PICKENS ROAD	119	6	14	0.65	30-50	2
PIERCY STREET	94	7	18	0.5	50	1
PINE GROVE AVENUE	30	4	11	0.06	50	4
PINE HILL ROAD	125	7	16	0.75	30-50	2
PINE LAUREL CIRCLE	82	5	4	0.46	50	1
PINE RIDGE LANE	92	6	14	0.12	50	2
PINE RIDGE ROAD	111	7	16	0.4	50	1
PINECREST DRIVE	30	4	11	0.05	20-50	1
PINECREST ROAD	30	4	11	0.75	20-50	1
PINEHURST DRIVE	30	4	11	0.25	30-50	2
PINESPUR ROAD	66	7	5	0.15	40	1
PINEY AVENUE	124	7	9	0.42	50	1
PINEY FLATS ROAD SA-8217(C)	124	7	9	2.42	60	1
PINEY HILL ROAD	70	5	1	1	40	2
PINON DRIVE	92	6	14	0.15	50	2
PIONEER HAVEN LANE	92	6	13	0.1	40	2
PITKIN DRIVE	91	6	13	0.14	60	2
PITT ROAD	107	7	18	1.1	30-50	1
PLAINVIEW DRIVE	36	4	5	0.45	40	2
PLANK ROAD	125	7	16	0.1	16-50	4
PLANTATION DRIVE	106	6	14	0.23	50	2
PLEASANT GROVE ROAD	82	5	16	4.25	40	2
PLEASANT HILL CHURCH ROAD	80	7	5	0.2	30-50	3
PLEASANT HILL DRIVE	48	4	7	0.04	50	1
PLEASANT HILL PLACE	126	7	16	0.3	30-50	2
PLEASANT HILL ROAD	80	7	5	0.95	40	2
POCAHONTAS DRIVE	49	7	7	0.1	40	1
POLARIS DRIVE	82	5	4	0.1	50	1

POND SPRINGS ROAD	76	6	13	1.1	30-50	2
POND SPRINGS ROAD W.	91	6	13	0.48	50	2
PONDELLA AVENUE	31	4	10	0.2	30-50	3
POOR HOLLOW ROAD	63	6	7	1.3	20-50	2
POPLAR CIRCLE	68	5	4	0.05	50	1
POPLAR GROVE RD. (STATE-347)	105	6				
POPLAR HILL LANE	54	5	21	0.06	40	1
POPLAR RIDGE CHURCH ROAD	124	7	9	0.3	30-50	2
POPLAR RIDGE ROAD	124	7	9	1.2	40	2
PORTLAND AVENUE	31	4	10	0.2	40	2
POSSUM CREEK ROAD SA-8227	99	5	3,16	4	30-50	1
POST OAK DRIVE	121	6	14	0.35	50	1
POTATO HILL ROAD	104	6	15	0.42	40	1
POTTER LANE	8	5	19	0.1	30-50	2
POTTS HOLLOW ROAD	85	5	1	0.3	12-50	4
PRATT ROAD	12	4	12	0.1	15-50	3
PREAKNESS COURT	118	6	15	0.17	40	1
PRESCOTT STREET	31	4	10	0.03	50	2
PRICE ROAD	123	7	9	0.25	20-50	4
PRIDEMORE STREET	31	4	10	0.25	30-50	3
PRINCETON ROAD	90	6	13	1.8	40	1
PROFFITT LANE SA-8211	121	6	14	1.55	30-50	1
PROMISE LANE	12	4	12	0.38	15-50	4
PVT DR, ALICE	105	6		0		
PVT DR, AMANDAS	38	5		0		
PVT DR, APRIL	13	4		0		
PVT DR. ASHLEY OAKS	92	6				
PVT DR, B & I	97	7		0		
PVT DR, BALL ORCHARD	30	4		0		
PVT DR, BALL VILLAGE	104	6		0		
PVT DR, BALLARDS	65	7		0		
PVT DR, BANCROFT	32	4		0		
PVT DR, BARRETT	80	7		0		
PVT DR, BEN JONES	95	7		0		
PVT DR, BOOHERS	55	5		0		
PVT DR, BOONEWOOD	109	7		0		
PVT DR, BRAGG	103	6		0		
PVT DR, BRENTWOOD	18	4		0		
PVT DR, BROWNS	24	5		0		
PVT DR, BURDINES	123	7		0		
PVT DR, CAIN	64	6		0		
PVT DR, CAMPBELLS	55	5		0		
PVT DR, CANDY CREEK	94	7		0		
PVT DR, CARISIL						
PVT DR, CARTERS VALLEY	13	4		0		
PVT DR, CEDAR RIDGE	13	4		0		
PVT DR, CLARK	35	4		0		
PVT DR, CLIFFSIDE	107	7		0		
PVT DR, COLE HOLLOW	16	4		0		
PVT DR, COUNTRY VIEW	80	7		0		
PVT DR, CRICKET	134	7		0		
PVT DR. DALLAS VAUGHN	33	4		0		
PVT DR, DEAN	104	6		0		
PVT DR, DEARSTONE	35	4		0		
PVT DR, DEER RUN	84	5		0		
PVT DR, DEFRIECE	35	4		0		
PVT DR, DERICK	79	7		0		
PVT DR, DIXIE	54	5		0		

PVT DR, DOGWOOD	104	6	0
PVT DR, DOUGHERTY	123	7	0
PVT DR, DOUGLAS	93	7	0
PVT DR, DROKE FARM	106	6	0
PVT DR, DUNCAN	69	5	0
PVT DR, EATONS	52	7	0
PVT DR, EDENS	137	7	0
PVT DR, EDNA	14	4	0
PVT DR, EMORY HARR	48	6	0
PVT DR, ESSIES	24	5	0
PVT DR, EULA	18	4	0
PVT DR, FELTY	18	4	0
PVT DR, FERNWOODS	55	5	0
PVT DR, FREEMANS	34	4	0
PVT DR, GARLANDS	76	6	0
PVT DR, GEORGIA	31	4	0
PVT DR, GILDERS	107	6	0
PVT DR, GOOD VIEW	31	4	0
PVT DR, GUY HILL	99	5	0
PVT DR, H & E	111	7	0
PVT DR, H. BARNETT	55	5	0
PVT DR, HELTON	64	7	0
PVT DR, HENRYS	121	6	0
PVT DR, HILLBILLY	36	7	0
PVT DR, HILLSIDE	111	7	0
PVT DR, HILLWOODS	56	5	0
PVT DR, HINKLE	68	5	0
PVT DR, HONEYSUCKLE	104	6	0
PVT DR, HOUSTON	63	6	0
PVT DR, INDUSTRIAL	64	7	0
PVT DR, ISLEYS	122	7	0
PVT DR, J.D. WHITE	31	4	0
PVT DR, JOURNEYS END	69	5	0
PVT DR, JUANITAS	33	4	0
PVT DR, KANUGA	41	5	0
PVT DR, KESTNER	14	4	0
PVT DR, KITES	38	5	0
PVT DR, KNOB HILL	66	7	0
PVT DR, LA DOUX VIE	109	7	0
PVT DR, LAKE HAVEN	140	7	0
PVT DR, LEAS	84	5	0
PVT DR, LITTRELL	82	5	0
PVT DR, LOG CABIN	90	6	0
PVT DR, LOIS LANE	99	5	0
PVT DR, LONE OAK	36	4	0
PVT DR, LOWES	98	5	0
PVT DR, LUNSFORD	80	7	0
PVT DR, MAPLE HILL	121	6	0
PVT DR, MCMURRAY	33	4	0
PVT DR, MEMORY LANE	96	7	0
PVT DR, MISTY WOODS	33	4	0
PVT DR, MITCHELL	83	5	0
PVT DR, MOODY	118	6	0
PVT DR, MORELOCK	103	6	0
PVT DR, MORSE	63	6	0
PVT DR, MULLINEX	116	6	0
PVT DR, MUSSELMAN	106	6	0
PVT DR, NOKOMIS	90	6	0

PVT DR, OAK HILL	134	7	0		
PVT DR, ODUM	83	5	0		
PVT DR, OGDEN LN.	108	7	0		
PVT DR, OLD PARKER	48	6	0		
PVT DR, OLLIS ESTATE	70	5	0		
PVT DR, OSBORNES WAY	18	4	0		
PVT DR, PETERS	53	5	0		
PVT DR, PINE HILL	56	5	0		
PVT DR, PLEASANT HILL	83	5	0		
PVT DR, POINT SHORE	140	7	0		
PVT DR, POTEAT	78	6	0		
PVT DR, QUAIL	107	6	0		
PVT DR, RADIO WAY	64	6	0		
PVT DR, RAGSDALE	31	4	0		
PVT DR, RAMSEY	66	7	0		
PVT DR, REDBIRD	56	5	0		
PVT DR, RHODES	123	7	0		
PVT DR, RILEY-JAMES	107	6	0		
PVT DR, RODGERS OAK DALE	64	6	0		
PVT DR, ROGERS	41	5	0		
PVT DR, ROLLIN HILLS	17	4	0		
PVT DR, ROUSE	40	5	0		
PVT DR, RUSSELL LN.	39	5	0		
PVT DR, SAMMONS	65	7	0		
PVT DR, SET POINT	109	7	0		
PVT DR, SHANKLE	20	4	0		
PVT DR, SHELTERED COVE	95	7	0		
PVT DR, SHILOH	63	6	0		
PVT DR, SMITH HILL	67	7	0		
PVT DR, SMITHS	23	5	0		
PVT DR, SMOKEY HILL	65	7	0		
PVT DR, STEWART HILL	18	4	0		
PVT DR, STEWARTS	97	5	0		
PVT DR, STINE	34	4	0		
PVT DR, SUGAR HOLLOW ACRES	95	7	0		
PVT DR, SUMMER	63	6	0		
PVT DR, SUNNY LANE	108	7	0		
PVT DR, TALLMAN	35	4	0		
PVT DR, TALON	35	4	0		
PVT DR, TANASE LANE	41	5	0		
PVT DR, TIMBER MILL	81	7	0		
PVT DR, TRINITY COVE	41	5	0		
PVT DR, TRIVETTE	68	6	0		
PVT DR, TWIN HILL	104	6	0		
PVT DR, UNDERWOOD SPRINGS	112	5	0		
PVT DR, VALLEY HIGH	90	6	0		
PVT DR, VALLEY VIEW	33	4	0		
PVT DR, VANDERPOOL	32	4	0		
PVT DR, WALKERS	58	5	0		
PVT DR, WALTERS	24	5	0		
PVT DR, WATERSIDE	77	6	0		
PVT DR, WATKINS	65	7	0		
PVT DR, WHITELY	15	4	0		
PVT DR, WHITTNEY	69	5	0		
PVT DR, WILLIAMS	124	7	0		
PVT DR, WITCHER-5-6	70	5	0		
PYLE ROAD	40	5	22	0.14	15-50 4

Q

QUAIL HILL CIRCLE	106	6	14	0.05	40	2
QUAIL HEIGHTS COURT	106	6	14	0.1	40	2
QUAIL LANE	36	7	5	0.15	50	2
QUAIL POINT	106	6	14	0.04	50	2
QUALLS ROAD	30	4	11	0.2	30-50	3
QUEEN ANN COURT	124	7	9	0.14	40	2

R

R. MILLER ROAD	80	7	8	0.2	20-50	4
R.C. BARRETT ROAD	102	6	15	0.2	20-50	3
RAGSDALE ROAD	30	4	11	0.05	50	3
RAGSDALE STREET	30	4	11	0.4	50	1
RAGSDALE STREET EXTENSION	30	4	11	0.2	30-50	3
RAINBOW CIRCLE	14	4	10	0.5	50	2
RAMAH ROAD	31	4	11	0.07	50	1
RAMBLING LANE	126	5	16	0.4	15-50	4
RAMBLING ROAD	92	6	14	0.35	40	2
RAMEY ROAD	51	4	5	0.55	40	2
RAMEY STREET	29	4	12	0.07	50	4
RAMSEY AVENUE	29	4	12	0.05	40	2
RANDALL STREET	14	4	10	0.05	30-50	3
RANDICH DRIVE	13	4	11	0.2	50	3
RANGE ROAD	134	7	20	0.4	15-50	4
RANGEWOOD ROAD	134	7	20	1.2	30-50	2
RANIER DRIVE	92	6	14	0.32	50	2
RAVEN CIRCLE	91	6	13	0.09	50	2
RAVEN STREET	14	4	10	0.1	50	2
RAVENTREE DRIVE	119	6	7	0.05	50	2
RAYTHEON ROAD SA-8226	37	5	2.21	1.15	30-60	1
REBECCA STREET	68	5	4	0.4	30-50	3
RECTOR DRIVE	12	4	12	0.2	30-50	2
RED BUD LANE	50	4	5	0.6	30-50	3
RED CEDAR BRANCH ROAD	62	6	7	0.8	30-50	3
RED DEER ROAD	67	7	4	0.35	50	1
RED OAK LANE	106	6	14	0.17	50	2
RED OAK PLANTATION DRIVE	106	6	14	0.23	50	1
RED ROBIN LANE	48	6	7	0.2	30-50	2
REDSTONE DRIVE	82	5	4	0.25	50	1
REEDY CREEK DRIVE	34	4	6	0.25	30-50	3
REEDY CREEK LANE	34	4	6	0.2	30-50	3
REEDY CREEK ROAD	18	4	6	3.15	30-50	1
REGENCY DRIVE	106	6	14	0.27	50	2
REMINGTON COURT	120	6	14	0.18	50	2

RESERVOIR DRIVE	126	7	16	0.2	15-50	4
RESEVOIR ROAD SA-8202 (C)	75	6	13	4.72	40-50	1
REST AND BE THANKFUL LANE	91	6	13	0.04	40	2
RHEA AVENUE	51	4	5	0.25	50	1
RHOTEN COURT	92	6	14	0.05	50	3
RICE CROSS ROAD	109	7	20	1.35	40	2
RICH DRIVE	30	4	11	0.45	40	2
RICH DRIVE EXTENSION	30	4	10	0.3	40	2
RICHARDS LANE	126	7	16	0.3	15-50	4
RICHLAND DRIVE	92	6	14	0.1	50	3
RIDDLE CREEK ROAD	100	5	1	0.75	15-50	4
RIDDLE STREET	30	4	11	0.3	30-50	3
RIDGE CREST AVE.	30	4	11,12	0.5	40-50	3
RIDGE DRIVE	95	7	8	1.2	40	2
RIDGE HAVEN DRIVE	30	4	11	0.05	40	2
RIDGE HILL ROAD	52	7	4	0.2	20-50	3
RIDGE ROAD	90	6	15	1.1	30-50	2
RIDGEDALE DRIVE	54	5	2	0.3	50	1
RIDGEMONT DRIVE	92	6	14	0.15	50	2
RIDGEMONT STREET	36	7	5	0.3	50	1
RIDGETOP DRIVE	67	7	4	0.25	50	1
RIDGEWAY DRIVE	95	7	8	0.85	40	2
RIDGEWAY ROAD	76	6	13	0.68	30-50	2
RIDGEWAY STREET	68	5	1	0.1	50	1
RIDGEWOOD DRIVE	31	4	10	0.2	50	2
RILEY HOLLOW ROAD	99	5	3	0.4	20-50	3
RIM ROCK ROAD	91	6	13	0.18	50	2
RIPPLING RUN	92	6	13	0.2	40	2
RITTER COURT	92	6	14	0.04	40	2
RIVER BEND ROAD (C)	70	5	1	1.36	30-60	1
RIVER BRIDGE ROAD	121	7	18	0.15	20-50	3
RIVER ROAD	97	7	16	0.85	50	1
RIVERSIDE ROAD	97	5	16	4.25	30-50	1
RIVerview DRIVE	97	5	16	0.2	20-50	3
RIVerview ROAD	70	5	1	1	30-50	2
ROBERTS LANE	30	4	11	0.2	50	1
ROBIN COURT	48	4	7	0.08	40	3
ROBIN STREET	48	4	7	0.15	40	3
ROBINDALE LANE	92	6	14	0.09	60	2
ROBINWOOD ROAD	107	7	18	1.15	40	2
ROCK CITY ROAD (C)	32	4	10	2.1	30-60	2
ROCK DRIVE	36	7	5	0.15	50	1
ROCK HILL LANE	19	4	6	0.15	20-50	3
ROCK HILL ROAD	136	7	9	1.25	40	1
ROCKHOLD RD. (STATE-44)	99	5		0		
ROCK LANE	110	7	9	1.15	20-60	1
ROCK LEDGE	83	5	3	0.25	20-50	3
ROCK ROAD	36	7	5	0.2	30-50	1
ROCK SPRINGS DRIVE	104	6	13,15	2.1	30-50	2
ROCK SPRINGS RD.SA-8204,820(77	6	13	6.58	40-60	1
ROCK SPRINGS VALLEY ROAD	105	6	13	0.5	30-50	2
ROCK VALLEY DRIVE	105	6	13	0.24	50	1
ROCKWOOD STREET	48	4	10	0.08	30-50	2
ROCKY BRANCH ROAD	78	6	7	1	50	1
ROCKY LANE	30	4	11	0.25	30-50	3
ROCKY ROAD	30	4	11	0.05	30-50	3
ROCKY SPRINGS ROAD (C)	109	7	20	1.55	60	2
RODEFER DRIVE	34	4	6	0.1	30-50	3

RODEFER HOLLOW ROAD	17	4	6	1.15	30-50	1
RODEFER LANE	34	4	6	0.2	30-50	3
RODGERS OAK DAIL DRIVE	64	6	7	0.17	80-160	2
ROGERS AVENUE	30	4	11	0.5	30-50	1
ROGERS DRIVE	83	5	21	0.3	30-50	3
ROGERS LANE	68	5	21	0.1	20-50	3
ROGERS ROAD	55	5	1	0.2	15-50	4
ROLLER DRIVE	106	6	14	0.24	50	1
ROLLING HILLS	104	6	15	0.1	15-50	3
ROOTY BRANCH ROAD	39	5	1,22	1.3	30-50	1
ROSEBERRY ROAD	103	6	15	0.4	20-50	3
ROSEBERRY ROAD EXTENSION	103	6	15	0.1	10-50	1
ROSECLIFF DRIVE	49	4	5	0.05	50	1
ROSEDALE DRIVE	12	4	12	0.1	30-50	3
ROSEHAVEN COURT	92	6	14	0.1	40	2
ROSEMARY LANE	124	7	9	0.13	40	1
ROSEMONT DRIVE	36	7	5	0.15	50	1
ROSEMONT STREET	90	6	15	0.35	50	1
ROSEWOOD CIRCLE	63	6	7	0.1	40	1
ROSEWOOD DRIVE	31	4	10	0.19	50	1
ROSEWOOD LANE	63	6	7	0.25	40	1
ROWAN DRIVE	36	7	5	0.15	50	1
ROXANA DRIVE	64	6	7	0.07	50	1
ROXBURY LANE	63	6	7	0.1	40	1
ROYAL CIRCLE	105	6	13	0.06	50	2
ROYAL DRIVE	107	6	14	0.4	50	1
ROYAL OAK DRIVE	66	7	4	0.32	50	1
RUNNING DEER TRAIL	92	6	13	0.15	50	1
RUSH DRIVE	25	5	19	0.1	20-50	3
RUSHMORE ROAD	90	6	13	0.45	30-50	2
RUSSELL LANE	39	5	22	0.05	30-50	3
RUSSELL ROAD	66	7	5	0.05	50	1
RUST ROAD	57	5	19	0.3	20-50	4
RUSTIC HILLS DRIVE	31	4	10	0.6	50	2
RUTLEDGE DRIVE	68	5	21	0.2	50	1
RUTLEDGE LANE	95	7	18	0.2	15-50	4
RUTLEDGE ROAD	107	7	18	0.3	25-50	3
RUTLEDGE STREET	68	5	4	0.45	50	1
RYAN ROAD	103	6	15	0.3	20-50	3
RYDER CHURCH ROAD SA-8227	84	5	3	4	40-50	2

S

S. EASTMAN ROAD	61	6	13	1.1	50	1
S. SUMMER SOUND RD.	110	7	8	0.1	20-50	3
S. VALLEY VIEW CIRCLE	48	6	7	0.3	50	1
S. WILCOX DR. (STATE-126)	61	6		0		
SADDLE RIDGE DRIVE	48	6	7	0.2	40	2
SALEM STREET	30	4	11	0.15	40	2
SALLEY STREET	31	4	11	0.05	11-50	2
SALVATION ROAD	30	4	11	0.03	30-50	3
SAM GAMMON ROAD	107	7	18	0.35	20-50	3
SAMLOLA ROAD	49	7	5	0.7	30-50	2

SAMOSSET DRIVE	75	6	13	0.15	30-50	2
SAMUEL STREET	14	4	10	0.3	30-50	2
SAND BAR ROAD	69	5	1	0.6	15-50	3
SANDERS STREET	94	7	18	0.36	50	1
SANDPIPER CIRCLE	106	6	14	0.1	40	1
SANDRIDGE DRIVE	106	6	14	0.24	40	2
SANDY ROAD	31	4	11	0.07	50	1
SANDY POINTE STREET	94	6	18	0.17	50	2
SATANTA ROAD	48	4	7	0.25	50	1
SARATOGA ROAD	75	6	13	0.65	30-50	2
SASANOVA COURT	105	6	15	0.15	40	2
SAUL ROAD	36	4	5	0.1	20-50	4
SAVOY DRIVE	51	4	5	0.15	50	1
SAWYER CIRCLE	97	7	16	0.05	50	1
SCALF DRIVE	126	7	16	0.3	15-50	4
SCENIC COURT	92	6	14	0.09	40	2
SCENIC DRIVE	54	5	21	0.2	50	1
SCHOOL AVENUE	51	7	5	0.15	30-50	2
SCHOOL DRIVE	51	7	5	0.1	30-50	2
SCOTT DRIVE	91	6	13	0.15	25-50	3
SCOTT LANE	17	4	6	0.95	30-50	1
SCOTT ROAD	16	4	6	0.55	30-50	3
SCOTT STREET	32	4	10	0.05	30-50	3
SEAVER ROAD	75	6	13	0.55	30-50	2
SECOND AVENUE	53	5	21	0.3	50	2
SECOND STREET	36	4	5	0.07	25-50	3
SEDFIELD ROAD	76	6	13	0.09	40	1
SELENA STREET	48	6	7	0.15	30-50	3
SELENA STREET EXTENSION	48	6	7	0.1	30-50	3
SELKIRK DRIVE	63	6	7	0.07	50	1
SELLS ROAD	82	5	4,16	1.65	30-50	2
SEMINOLE LANE	49	4	7	0.15	50	1
SENECA ROAD	49	7	7	0.35	50	1
SENEKER LANE SA-8234	35	4	5,6	1.5	30-50	1
SENEKER ROAD	18	4	6	0.2	30-50	2
SEQUOYAH DRIVE	66	7	4	0.26	50	1
SHADOW LANE	63	6	7	0.1	20-50	3
SHADOW WOOD LANE	92	6	13	0.15	50	1
SHADOWTOWN ROAD SA-8212	64	7	7	2.36	40-50	1
SHADY FORD ROAD	40	5	22	0.23	15-50	4
SHADY LANE	41	5	19	0.04	40	3
SHADY VIEW ROAD	91	6	13	2.3	50	1
SHADYSIDE DRIVE	92	6	13	0.65	50	1
SHALE STREET	30	4	11	0.1	30-50	3
SHANKS ROAD	80	7	8	1.01	40	2
SHANNON STREET	63	6	7	0.3	40	1
SHARPS CREEK ROAD	41	5	19	1.8	30-50	2
SHARPS HOLLOW ROAD	83	5	3	1.01	40	2
SHARRON ROAD	30	4	11	0.35	50	1
SHATOLON COURT	80	7	5	0.12	40	2
SHAVER ROAD	95	7	8	0.15	25-50	3
SHAWNEE DRIVE	49	6	7	0.1	40	3
SHERILL DRIVE	105	6	13	0.11	30-50	4
SHIPLEY FERRY RD. SA-8210(C)	64	7	5,7	3.77	40-60	1
SHIPLEY FERRY ROAD E.	92	6	13	0.6	40-50	2
SHIPLEY FERRY ROAD W.	106	6	13	0.65	40-50	2
SHIPP SPRINGS ROAD (C)	30	4	11	0.9	60	1
SHOALS ROAD	77	6	14	0.05	40	3

SHOEMAKER COURT E.	118	6	15	0.03	40	1
SHOEMAKER COURT W.	118	6	15	0.02	40	1
SHORT HILL DRIVE	47	4	11	0.09	30-50	2
SHORT LANE	120	6	14	0.19	20-50	3
SHULER DRIVE	48	6	7	0.4	50	1
SIERRA DRIVE	48	4	10	0.2	50	1
SIGMAN HOLLOW ROAD	126	5	16	1.3	20-50	3
SILER DRIVE	31	4	10	0.11	40	2
SILVER GROVE RD. SA-8223 (C)	97	5	3,16	3.7	40-60	1
SILVER LEAF COURT	48	6	7	0.27	50	1
SILVERS CHAPEL ROAD	16	4	6	1.15	30-50	2
SIMPSON STREET	61	6	13	0.3	40	1
SINKING SPRINGS ROAD	55	5	1	0.5	40	2
SINKING SPRINGS ROAD EXT.	55	5	1	0.5	30-50	3
SIOUX DRIVE	49	7	7	0.2	50	1
SIR ECHO DRIVE	106	6	14	0.7	50	1
SIXTH STREET	36	4	5	0.3	25-50	3
SKELTON BLUFF ROAD	13	4	11	0.95	30-50	3
SKY VIEW DRIVE	30	4	11	0.1	30-50	3
SKY WA MO ROAD	126	5	16	2.2	20-50	3
SKYLAND DRIVE	68	6	4,21	0.26	50	1
SLAUGHTER STREET	104	6	13	0.26	20-50	2
SLEEPY HOLLOW ROAD	107	6	14	0.07	20-50	3
SLOAN DRIVE	36	7	5	0.1	40	1
SMILEY CIRCLE	51	4	5	0.2	40	1
SMILEY COURT	51	4	5	0.08	40	3
SMITH DRIVE	48	6	7	0.1	30-50	1
SMITH ROAD	107	6	14	0.1	40	2
SMITH STREET	30	4	11	0.5	30-50	3
SNAPPS FERRY ROAD SA-8204(C)	119	6	14	0.9	30-60	1
SONNETT COURT	118	6	15	0.2	50	1
SOURWOOD DRIVE	64	7	5	0.05	40	1
SOURWOOD HILL ROAD	19	4	5	0.1	50	1
SOUTH CREEK COURT	91	6	13	0.45	50	1
SOUTH HOLLOW ROAD	35	4	5	1.1	30-50	2
SOUTH HOLSTON DAM RD.SA8241	55	5	1	2.85	40	1
SOUTH ROAD	57	5	19	0.3	20-50	4
SOUTH WIND DRIVE	63	6	7	0.15	50	1
SOUTHRIDGE DRIVE	63	6	7	0.62	50	1
SOUTHWOOD DRIVE	91	6	13	0.6	50	1
SPANGLER ROAD	95	7	8	0.65	30-50	2
SPARDALE STREET	48	6	7	0.15	50	1
SPARROW ROAD	82	5	4	0.1	50	1
SPERRY CIRCLE	54	5	21	0.21	50	1
SPINDLETOP CIRCLE	118	6	15	0.07	50	1
SPINDLETOP COURT	118	6	15	0.04	40	2
SPORTSMAN DOCK ROAD	109	7	20	0.45	40	1
SPRING BROOK DRIVE	106	6	14	0.11	50	1
SPRING COURT	97	5	16	0.05	30-50	4
SPRING DRIVE	34	4	6	0.15	20-50	3
SPRING HILL DRIVE	48	4	7	0.25	40	1
SPRING LANE	92	6	14	0.04	50	2
SPRING STREET	66	7	5	0.25	40	1
SPRING VALLEY ROAD	54	5	2	0.3	50	1
SPRINGDALE DRIVE	39	5	22	1.01	50	3
SPRINGFIELD DRIVE	68	5	4,21	1.01	50	1
SPRINGVIEW STREET	63	6	7	0.2	50	1
SPRINGWOOD LANE	14	4	10	0.2	40	3

SPURGEON DRIVE	51	4	5	0.15	50	1
SPURGEON LANE	79	7	18	1.35	30-50	1
SPURGEON ROAD	64	7	7	0.35	40	2
STAGE COACH TRAIL	36	7	5	0.25	30-50	3
STAGE ROAD	32	4	10	0.8	30-50	2
STANFIELD ROAD	111	7	16	0.9	20-50	2
STANLEY STREET	51	7	5	0.05	30-50	2
STARDUST ROAD	104	6	15	0.6	30-50	1
STARDUST ROAD W.	104	6	15	0.1	30-50	3
STARLIGHT ROAD	104	6	15	0.3	25-30	1
STEADMAN ROAD	108	7	18	0.7	30-50	2
STEELE CREEK PARK ROAD	19	7	5	0.6	20-50	2
STEELES ROAD	19	4	5	0.1	20-50	3
STEEP HILL ROAD	63	6	7	0.1	40	1
STELLA STREET	12	4	12	0.05	30-50	3
STEVENSON HILL ROAD	108	7	18	1.01	30-60	2
STEVENWOOD DRIVE	36	4	5	0.25	50	1
STEWART ROAD	80	7	5	0.18	50	2
STONEY HILL	70	5	1	0.25	30-50	3
STONEY HOLLOW ROAD	70	5	1	0.7	20-50	3
STONEY POINT ROAD	78	6	7	0.15	30-50	3
STOUT ROAD	125	7	16	0.2	20-50	4
STRATTON PLACE	106	6	14	0.15	40	1
STUFFLE STREET	31	4	11	0.55	50	1
STUFFLE TERRACE	31	4	10	0.2	40	1
SUBURBIA DRIVE	51	4	5	0.1	40	1
SUE STREET	121	6	14	0.15	50	1
SUGAR HOLLOW DRIVE SA-8239	69	5	1,21	1.6	30-50	1
SUGAR HOLLOW ROAD	95	7	8	2.1	40-50	1
SUGAR HOLLOW TRAIL	95	7	8	0.8	40-50	1
SUGARTREE DRIVE	64	7	7	0.1	40	1
SUGARTREE ROAD	124	7	9	0.3	50	1
SUGARWOOD DRIVE	107	7	18	0.25	50	1
SUMMER HILLS COURT	106	6	14	0.12	50	2
SUMMER SOUND ROAD	96	7	8	1.7	40	2
SUMMERSET LANE	70	5	1	0.7	20-50	3
SUMMERTIME DRIVE	24	5	22	0.1	20-50	3
SUMMERSVIEW COURT	105	6	13	0.1	40	2
SUMMERVILLE ROAD	92	6	13	3.1	40-60	2
SUMMIT OAKS CIRCLE	92	6	13	0.25	40	1
SUMPTER ROAD	105	6	13	1.3	30-50	1
SUNBRIGHT DRIVE	63	6	7	0.17	50	1
SUNBURY COURT	48	6	7	0.07	50	2
SUNNY HILLS DRIVE	36	7	5	0.1	40	1
SUNNY LANE	31	4	11	0.3	30-50	2
SUNNYSIDE STREET	48	6	7	0.1	40	2
SUNNYVIEW DRIVE	12	4	12	0.4	30-50	3
SUNSET DRIVE	31	4	12	0.06	30-50	2
SUNSET ROAD	95	7	8	0.15	20-50	2
SURREY DRIVE	63	6	7	0.05	40	1
SWEET HOLLOW ROAD	1	5	19	1.52	30-50	3
SWEET KNOBS TRAIL	68	5	4	0.7	50	1
SYCAMORE DRIVE	81	7	4	0.5	50	1
SYLVAN DRIVE	92	6	14	0.1	50	2

T

TALL OAK COURT	92	6	14	0.11	50	2
TALL TREE DRIVE	106	6	14	0.35	30-50	3
TALLMAN DRIVE	35	4	5	0.1	40	1
TALLMAN ROAD	36	4	5	0.1	30-50	3
TAMS LANE	91	6	13	0.25	50	2
TANNER COURT	13	4	11	0.09	40	3
TANK HILL ROAD	135	7	9	0.6	20-50	4
TANSEY LANE	31	4	10	0.1	30-50	3
TARKINGTON STREET	30	4	11	0.15	30-50	3
TATE DRIVE	31	4	10	0.05	50	1
TATE ROAD	111	7	16	0.7	30-50	3
TAYLOR DRIVE	135	7	9	0.4	50	1
TAYLOR ROAD	17	4	6	0.2	20-50	3
TEABERRY CIRCLE	106	6	14	0.06	40	3
TEAL COURT	106	6	13	0.1	40	1
TECHNOLOGY COURT	124	7	9	0.09	60	1
TED DYKES ROAD	116	6	15	0.7	20-50	3
TEE DRIVE	66	7	4	0.02	50	1
TEMPLE STAR ROAD EXT.	103	6	15	0.1	30-50	2
TEMPLE STAR ROAD	103	6	15	0.25	30-50	2
TENNEVA STREET	12	4	12	0.15	30-50	3
TESTER HOLLOW ROAD	124	7	9	0.6	20-50	3
TEXAS STREET	12	4	12	0.02	20-50	4
THIRD STREET	36	4	5	0.1	25-50	3
THISTLEWOOD DRIVE	121	6	14	0.05	50	1
THOMAS ACRES ROAD	104	6	15	0.2	50	2
THOMAS LANE	82	7	4	1.25	20-50	2
THOMAS ROAD	23	5	22	0.5	12-50	4
THOMAS STREET	30	4	11	0.35	30-50	2
THOMPSON HOLLOW ROAD	124	7	9	0.8	20-50	3
THOMPSON STREET	30	4	11	0.4	50	1
THORNGROVE DRIVE	14	4	10	0.31	50	1
THREE OAKS DRIVE	90	6	15	0.2	30-50	3
TIFFANY COURT	106	6	14	0.13	50	1
TIFFANY LANE	19	4	5	0.2	50	1
TIFFANY STREET	63	6	7	0.07	50	1
TILSON HILL	90	6	13	0.07	30-50	3
TILSON ROAD	90	6	13	0.06	30-50	3
TIM WARREN ROAD	69	5	21	0.9	30-50	1
TIMBER RIDGE ROAD	112	7	16	2.88	30-50	2
TIMBERLAND CIRCLE	91	6	13	0.75	50	1
TIMBERLAND COURT	91	6	13	0.15	50	1
TIMBERTREE BRANCH ROAD	15	4	10	1.3	30-50	1
TIMRICK STREET	48	4	10	0.08	40	2
TINKER LANE	48	6	7	0.17	50	1
TIPTON LANE	51	4	5	0.7	30-50	3
TIPTON STREET	13	4	11	0.05	30-50	3
TODDMAN STREET	14	4	10	0.2	40	2
TOP TREE	66	7	4	0.05	50	1
TOPPER AVENUE	14	4	10	0.15	40	2
TORBETT ROAD	134	7	20	0.3	20-50	3
TORY ROAD	13	4	11	0.03	40	3
TOY CRAWFORD ROAD	103	6	15	0.07	20-50	4
TRAILS END ROAD	131	6	15	0.2	20-50	3

TRAILS END STREET	90	6	15	0.05	50	1
TRAVIS CIRCLE	14	4	10	0.05	40	2
TREVOR DRIVE	30	4	11	0.15	30-50	3
TRI-STATE LIME ROAD	16	4	6	1.01	40	1
TRIVETTE LANE	84	5	3	0.2	30-50	3
TROUBLESOME HOLLOW ROAD	85	5	1	2.7	30-50	2
TROY LANE	125	7	16	0.15	30-50	3
TULIP TREE ROAD	107	7	18	0.05	50	1
TURNER ROAD	99	5	3	1.01	40	1
TVA ROAD SOUTH	70	5	1	0.2	30-50	3
TWAIN CIRCLE	97	7	16	0.05	50	1
TWIN HILLS DRIVE	104	6	15	0.56	30-50	2
TWIN OAKS LANE	35	4	5	0.25	30-50	2
TYLER STREET	30	4	11	0.2	30-50	2

U

UNDERWOOD SPRING BRANCH ROAD	112	5	16	1.6	20-50	2
UPLAND DRIVE	106	6	14	0.13	50	1
UPLAND WAY	19	4	5	0.05	50	1

V

V.F.W. ROAD	92	6	14	0.2	50	2
V.I. RANCH ROAD	39	5	22	2.8	40	2
VA DEAD END ROAD 759	9	5	19	0.05	30-50	3
VALE AVENUE	69	5	21	0.15	30-50	1
VALLEY PIKE ROAD	38	5	2	0.5	30-50	2
VALLEY DRIVE	64	7	5	1.2	30-60	1
VALLEY ROAD	66	7	5	0.25	40	1
VALLEY STREET	30	4	11	0.18	40	3
VALLEYDALE DRIVE	119	6	13	0.34	50	1
VAN HORN STREET	14	4	10	0.2	30-50	3
VANCE LANE	126	7	16	0.06	20-50	3
VANCE TANK ROAD SA-8226	54	5	21	3.4	30-50	2
VERMONT DRIVE	30	4	11	0.6	30-50	2
VESTA AVENUE	76	6	13	0.7	15-50	4
VICKARS ROAD	111	7	9,16	3.25	40	1
VICTORY LANE	105	6	13	0.25	40	2
VIEW STREET	92	6	14	0.05	50	1
VINCENT LANE	75	6	13	0.1	20-50	3
VINE STREET	64	7	7	0.04	40	1
VIOLET STREET	121	6	14	0.35	40	1
VIRGINIA DRIVE	13	4	12	0.15	30-50	3

W

W. CLAY STREET	90	6	15	0.05	30-50	2
W. VALLEY VIEW CIRCLE	63	6	7	0.15	50	1
W.CARTERS VALL. RD.(STATE-34	12	4		0		
WACO COURT	91	6	13	0.05	50	2
WAGON WHEEL LANE	91	6	13	0.05	40	2
WAHOO DRIVE	107	7	18	0.1	50	3
WAHOO VALLEY RD. SA-8210	93	7	18	2.4	50	2
WAKEFIELD COURT	120	6	14	0.25	50	1
WALLACE LANE	39	5	22	0.15	20-50	3
WALLING ROAD	95	7	8	0.4	30-50	2
WALNUT GROVE ROAD	111	7	16	3.1	30-50	1
WALNUT HILL ROAD	36	4	5	1.55	50	1
WALNUT LANE	125	7	16	0.1	40	3
WALNUT TRAIL	36	4	5	0.1	30-50	2
WALTON COURT	92	6	14	0.26	50	1
WALTZ LANE	92	6	14	0.03	50	2
WAMPLER ROAD	53	5	21	0.5	10-50	4
WARD LANE	33	4	6	0.1	30-50	3
WARD PLACE	61	6	13	0.1	30-50	2
WARD ROAD	135	7	9	0.07	12-50	4
WARREN DRIVE	123	7	20	1.6	20-50	3
WARREN ROAD SA-8216 (C)	123	7	9,20	1.45	60	2
WARRICK DRIVE	61	6	13	0.09	40	2
WARRIOR DRIVE	92	6	14	0.4	30-50	2
WASSUM LANE	126	7	16	0.4	15-50	3
WATAUGA ROAD	23	5	22	0.3	15-50	4
WATERFORD DRIVE	63	6	7	0.35	50	1
WAYNE CONSTRUCTION ROAD	32	4	10	0.5	30-50	1
WAYNE STREET	30	4	11	0.1	30-50	2
WEAVER BRANCH ROAD SA-8218(C	110	7	9,16	4.24	60	1
WEAVER CREEK ROAD	113	5	3	1.1	20-50	3
WEAVER LANE	33	4	7	0.1	30-50	1
WEAVER PIKE (SPLIT-STATE-358	54	5		0		
WEBB COURT	38	5	2	0.2	40	2
WEBB DRIVE	136	7	9	0.1	20-50	4
WEBB ROAD	124	7	9	0.8	40	2
WEBBER ROAD	18	4	5	0.35	20-50	3
WEDGEWOOD CIRCLE	30	4	11	0.03	40	2
WELCH ROAD	30	4	11	0.35	50	1
WELK ROAD	29	4	12	0.06	30-50	3
WEMBECK DRIVE	48	4	7	0.3	40	2
WENDOVER DRIVE	92	6	14	0.2	40	2
WENTWORTH STREET	31	4	10	0.1	30-50	3
WESLEY DRIVE	123	7	20	0.29	50	2
WESSEX DRIVE	92	6	14	0.1	40	1
WEST CAMPGROUND ROAD	131	6	15	1.4	30-50	2
WEST CENTRAL	36	4	5	0.2	40	2
WEST VALLEY DRIVE (C)	118	6	15	1.4	50-60	1
WESTBROOK DRIVE	92	6	13	0.16	50	1
WESTFIELD DRIVE	105	6	13	1.5	30-50	1
WESTFIELD PLACE	105	6	13	0.42	40	1
WESTMINISTER PLACE	106	6	14	0.05	40	2
WESTVIEW DRIVE	65	7	5	0.15	40	2
WEXFORD LANE	64	7	5	0.25	50	1

WHIRLAWAY CIRCLE	118	6	15	0.04	50	1
WHISPERING HAVEN ROAD	118	6	15	0.3	50	2
WHISPERING HILL ROAD	35	4	5	0.15	40	2
WHISPERING HILLS DRIVE	76	6	13	0.25	40	1
WHISPERING WAY	92	6	14	0.36	50	1
WHISPERING WOODS DRIVE	82	5	4	0.4	50	1
WHITAKER ROAD	134	7	9	0.4	20-50	3
WHITAKER STREET	36	4	5	0.1	50	1
WHITCOMB STREET	48	4	10	0.07	30-50	1
WHITE HAWK WAY	92	6	13	0.1	40	2
WHITE HOLLOW ROAD	99	5	3	0.6	15-50	3
WHITE OAK LANE	92	6	14	0.12	50	2
WHITE ROAD	84	5	3	0.4	20-50	3
WHITE TOP CIRCLE	68	5	4	0.18	50	1
WHITE TOP ROAD SA-8226	82	5	4	3.01	40	2
WHITE TOP ROAD EXTENSION	82	5	4	0.05	50	2
WHITEHAVEN DRIVE	14	4	10	0.35	50	3
WHITEHEAD RD.	110	7	16	0.75	40	3
WHITEHILLS ROAD	14	4	10	0.15	50	2
WHITNEY LANE	69	5	21	0.2	50	1
WICKLOW DRIVE	64	6	7	0.06	50	1
WIDENER ROAD	92	6	14	0.09	50	2
WIL-RHO CIRCLE	31	4	10	0.3	30-50	3
WILD-ROSE LANE	15	4	10	0.1	40	3
WILDWOOD ROAD SA-8210	93	7	18	0.85	30-50	2
WILLARD DRIVE	92	6	18	0.19	50	2
WILLIAMS LANE	36	4	5	0.4	50	1
WILLOW BROOK DRIVE	81	7	4	0.2	50	2
WILLOW HOLLOW ROAD	106	6	14	0.15	40	3
WILLOW VIEW DRIVE	90	6	15	0.15	12-50	3
WILMONT DRIVE	92	6	14	0.15	50	1
WIMBERLY CIRCLE	36	7	5	0.25	50	1
WIMBERLY PLACE	30	4	11	0.05	40	2
WIMBERLY WAY	36	7	5	0.3	50	1
WINCHESTER LANE	19	4	5	0.05	50	1
WINDALE AVENUE	30	4	11	0.07	20-50	3
WINDING ROAD	51	4	5	0.15	40	2
WINDING WAY	51	4	5	0.15	40	2
WINDMERE PLACE	76	6	13	0.04	50	1
WINDSOR FOREST DRIVE	92	6	14	0.37	50	1
WINDY HILLS ROAD	68	5	4	0.5	15-50	4
WINE CIRCLE	49	7	7	0.85	50	1
WINEGAR AVENUE	12	4	12	0.05	30-50	3
WINEGATE ROAD	64	7	5	0.1	40	1
WINESAP ROAD	106	6	14	0.57	50	1
WINFIELD DRIVE	92	6	13	0.15	50	1
WINSTON CIRCLE	118	6	15	0.1	40	1
WINTERBROOK CIRCLE	120	6	14	0.07	40	2
WINTERBROOK DRIVE	120	6	14	0.07	50	1
WITHERSPOON DRIVE	107	6	14	0.25	40	1
WOLF BROS. ROAD	135	7	9	0.07	30-50	2
WOLFE AVENUE	31	4	10	0.05	20-50	3
WOLFE STREET	31	4	11	0.12	30-50	2
WONDERLAND DRIVE	14	4	10	0.5	50	1
WOOD COURT	106	6	14	0.04	40	2
WOOD HAVEN DRIVE	92	6	14	0.22	50	2
WOODBINE	23	5	22	0.2	30-50	3
WOODBINE LANE	23	5	22	0.03	30-50	4

WOODBERRY CIRCLE	106	6	14	0.04	40	2
WOODBROOK AVENUE	36	7	5	0.15	50	1
WOODCLIFT DRIVE	48	4	10	0.37	50	1
WOODCREST DRIVE	92	6	14	0.65	30-50	3
WOODFIELD DRIVE	90	6	15	0.1	50	1
WOODLAND CIRCLE	41	5	19	0.2	40	1
WOODLAND COURT	41	5	19	0.05	50	2
WOODLARK LANE	14	4	10	0.08	50	1
WOODLAWN DRIVE	103	6	15	0.2	40	3
WOODLAWN ROAD	103	6	15	0.2	40	3
WOODMERE DRIVE	92	6	14	0.08	50	2
WOODOAK DRIVE	63	6	7	0.1	40	1
WOODPOND COURT	63	6	7	0.05	40	1
WOODRIDGE CIRCLE	120	6	14	0.07	40	1
WOODS DRIVE	111	7	16	0.25	30-50	3
WOODS LANE	111	7	16	0.2	30-50	3
WOODS ROAD	125	7	16	1.1	30-50	3
WOODS STREET	33	4	6	0.12	40	1
WOODS WAY	48	4	7	0.3	50	1
WOODSTOCK PLACE	106	6	14	0.1	50	1
WOODSTONE DRIVE	106	6	14	0.15	50	1
WOODVALE ROAD	33	4	6	0.1	30-50	2
WOODVIEW COURT	105	6	13	0.21	50	2
WOODWAY CIRCLE	67	7	4	0.4	50	1
WOODWAY DRIVE	81	7	8	0.25	40	1
WORLEY DRIVE	55	5	1	0.05	30-50	3
WORLEY VANCE ROAD	125	7	16	0.15	30-50	3
WORTHINGTON DRIVE	91	6	13	0.3	50	2
WREN ROAD	22	5	22	0.2	30-50	3
WRENWOOD COURT	106	6	14	0.06	40	1
WRIGHT LANE	68	5	4	0.17	30-50	3
WYATT CEMETERY ROAD	25	5	19	0.08	20-50	4
WYATT HOLLOW ROAD	25	5	19	1.8	30-50	2
WYLINE LANE	51	7	5	0.1	50	1
WYNFIELD COURT	106	6	14	0.05	40	2
WYNHAVEN DRIVE	92	6	14	0.1	40	1
YOAKLEY ROAD	95	7	18	0.39	30-50	2
YOKLEY STREET	30	4	11	0.2	40	2
YORKTOWN ROAD	107	6	14	0.15	25-50	2
YOUNG ROAD	76	6	13	0.23	40	2
YOUTH CENTER ROAD	35	4	5	0.2	30-50	2

TOTAL MILES OF ROADS

922.05

TO THE HONORABLE GIL HODGES, COUNTY EXECUTIVE, AND THE MEMBERS OF THE SULLIVAN COUNTY BOARD OF COMMISSIONERS IN Regular SESSION THIS THE 16th DAY OF December 1996.

RESOLUTION AUTHORIZING Requesting Assistance from State of Tennessee to Resolve the Problem of Jail Overcrowding Due to Housing State Prisoners

WHEREAS, TENNESSEE CODE ANNOTATED; SECTION _____ AUTHORIZES COUNTIES TO _____

NOW, THEREFORE BE IT RESOLVED by the Board of County Commissioners of Sullivan County, Tennessee, assembled in Regular Session on the 16th day of December 1996

THAT WHEREAS The State of Tennessee has prescribed that its counties are required to house State prisoners, and _____

WHEREAS, Sullivan County houses no less than one hundred (100) State prisoners, and _____

WHEREAS, Sullivan County is not given the option of accepting or rejecting State prisoners leading to over crowding in the Sullivan County Jail, and requiring Sullivan County taxpayers to pay the full cost of expanding its facility, and _____

WHEREAS, The costs of housing State prisoners (medical, food, clothing, etc.) is paid for by the Sullivan County taxpayers, and _____

WHEREAS, The Sullivan County Sheriff has contacted officials in Nashville on numerous occasions, but the State has offered no long-term solutions. _____

NOW, THEREFORE BE IT RESOLVED, That the Sullivan County Board of Commissioners requests the County Executive to send a letter to the entire Sullivan County Delegation and to the Governor of Tennessee, expressing our desire to: 1) have the option of accepting or rejecting State prisoners, 2) increasing the daily allowance for housing State prisoners, 3) providing a block grant for the expansion of the Sullivan County Jail. _____

All resolutions in conflict herewith be and the same rescinded insofar as such conflict exist.

This resolution shall become effective on _____, 19__, the public welfare requiring it.

Duly passed and approved this 20th day of January, 1997

Attested:

County Clerk

Date: 1-20-97

County Executive

Date: 1-20-97

INTRODUCED BY COMMISSIONER Gonce ESTIMATED COST: _____
SECONDED BY COMMISSIONER Blalock FUND: _____

Committee Action	Approved	Disapproved	Deferred	Date
Administrative	✓			1/6/97
Budget				
Executive	✓			1/8/97

Commission Action	Aye	Nay	Pass	Absent	Total
Roll Call	23			1	
Voice Vote					

COMMENTS: FIRST READING 12/16/96 APPROVED 1/20/97 ROLL CALL

RESOLUTION NUMBER 10

TO THE HONORABLE GIL HODGES, COUNTY EXECUTIVE, AND THE MEMBERS OF THE SULLIVAN COUNTY BOARD OF COMMISSIONERS IN Regular SESSION THIS THE 20th DAY OF January 19 97.

RESOLUTION AUTHORIZING Amending the 1996-97 General Purpose School Budget

WHEREAS, TENNESSEE CODE ANNOTATED; SECTION _____ AUTHORIZES COUNTIES TO _____

NOW, THEREFORE BE IT RESOLVED by the Board of County Commissioners of Sullivan County, Tennessee, assembled in Regular Session on the 20th day of January 19 97

THAT WHEREAS, The public auction held earlier this fiscal year produced revenues in the amount of \$21,577.00 from the sale of surplus materials, and

WHEREAS, The Sullivan County Board of Education has approved the appropriation of these revenues back to the departments from which the items sold were derived,

NOW, THEREFORE BE IT RESOLVED, That the Sullivan County Board of Commissioners authorizes the following amendment to the 1996-97 General Purpose School Budget:

REVENUE - GENERAL PURPOSE SCHOOL FUND

FROM:	44130.000	Sale of Materials and Supplies	-\$21,577.00
TO:	71300.429	Vocational Ed. (Direct) Instructional Supplies	+\$ 5,709.00
	72620.338	Maint. of Plant-Maint. & Repair of Vehicles	+\$ 3,700.00
	72620.424	Maint. of Plant-Garage Supplies	+\$ 9,000.00
	72460.717	Maint. of Plant-Maint. Equipment	+\$ 2,416.00
	73100.418	Food Service - Equipment & Machinery Parts	+\$ 752.00

SEE ATTACHED AMENDMENT

All resolutions in conflict herewith be and the same rescinded insofar as such conflict exist.

This resolution shall become effective on _____, 19__, the public welfare requiring it.

Duly passed and approved this 20th day of January, 19 97:

Attest: B. Feathers Date: 1-20-97 Gil Hodges Date: 1-20-97
County Clerk County Executive

INTRODUCED BY COMMISSIONER MAYES ESTIMATED COST: _____
SECONDED BY COMMISSIONER HARR FUND: _____

Committee Action	Approved	Disapproved	Deferred	Date
Administrative				
Budget				
Executive	✓			1-9-97

Commission Action	Aye	Nay	Pass	Absent	Total
Roll Call	23			1	
Voice Vote					

COMMENTS: WAIVER OF RULES APPROVED 1/20/97 AS AMENDED

ROLL CALL

382

#10

Amendment

amend resolution as follows:

General Purpose School

Revenue	As submitted	Amendment	Amended
44130.000 Sale of Materials and Supplies	21,577.00	+\$2,560.00	\$24,137.00

Expenditures

71300.429 Vocational Education(Direct)			
Instructional Supplies	\$5,709.00		\$5,709.00
72620.338 Maintenance of Plant			
Maint. & Repair of Vehicles	\$3,700.00		\$3,700.00
72620.424 Maintenance of Plant			
Garage Supplies	\$9,000.00		\$9,000.00
72620.717 Maintenance of Plant			
Maintenance Equipment	\$2,416.00	+\$2,560.00	\$4,976.00
73100.418 Food Service			
Equipment & Machinery Parts	\$752.00		\$752.00

Maintenance Department sold additional scrap metal wants to have these funds appropriated to Maintenance Equipment account to purchase various equipment.

RESOLUTION NUMBER 11

TO THE HONORABLE GIL HODGES, COUNTY EXECUTIVE, AND THE MEMBERS OF THE SULLIVAN COUNTY BOARD OF COMMISSIONERS IN Regular SESSION THIS THE 20th DAY OF January 19 97.

RESOLUTION AUTHORIZING STOP Sign on Mountain Meadows Drive - 20th C.D.

WHEREAS, TENNESSEE CODE ANNOTATED, SECTION _____, AUTHORIZES COUNTIES TO _____

NOW, THEREFORE BE IT RESOLVED by the Board of County Commissioners of Sullivan County, Tennessee, assembled in Regular Session on the 20th day of January 19 97

THAT BE IT RESOLVED, That a STOP sign be placed on Mountain Meadows Drive at Hamilton Trail as recommended in the attached correspondence from the Sullivan County Highway Department.

All resolutions in conflict herewith be and the same rescinded insofar as such conflict exist.

This resolution shall become effective on _____, 19____, the public welfare requiring it.

Duly passed and approved this 20th day of January, 19 97

Attested: B. Feathers Date: 1-20-97 Gil Hodges Date: 1-20-97
County Clerk County Executive

INTRODUCED BY COMMISSIONER Hyatt ESTIMATED COST: _____
SECONDED BY COMMISSIONER Mason FUND: _____

Committee Action	Approved	Disapproved	Deferred	Date
Administrative				
Budget				
Executive				

Commission Action	Aye	Nay	Pass	Absent	Total
Roll Call	23			1	
Voice Vote					

COMMENTS: WAIVER OF RULES APPROVED 1/20/97 ROLL CALL

384

**SULLIVAN COUNTY
HIGHWAY DEPARTMENT**

SULLIVAN COUNTY
P.O. BOX 590
BLOUNTVILLE, TENNESSEE 37617

John R. LeSueur, Jr.
Commissioner of Roads

*Attachment
Res # 11*

279-2820

January 8, 1997

COMMISSIONERS: Marvin Hyatt
Dwight Mason

Dear Commissioners:

I would like to request that you consider passing the following resolution:

A STOP sign be placed on Mountain Meadows Drive at Hamilton Trail, in the 20th Civil District.

If you have any questions, please feel free to contact me.

Sincerely,

Wayne Jones
Wayne Jones
Traffic Coordinator

WJ/jb

c: Shirley Gurganus

RESOLUTION NUMBER 12

TO THE HONORABLE GIL HODGES, COUNTY EXECUTIVE, AND THE MEMBERS OF THE SULLIVAN COUNTY BOARD OF COMMISSIONERS IN Regular SESSION THIS THE 20th DAY OF January, 1997.

RESOLUTION AUTHORIZING Speed Limit and No Parking on Pavement Signs on roads in the 5th and 21st C.D.

WHEREAS, TENNESSEE CODE ANNOTATED; SECTION _____, AUTHORIZES COUNTIES TO _____

NOW, THEREFORE BE IT RESOLVED by the Board of County Commissioners of Sullivan County, Tennessee, assembled in Regular Session on the 20th day of January 1997.

THAT BE IT RESOLVED, That "NO PARKING ON PAVEMENT" signs be posted on the 100 Block of First Avenue (21st C.D.) as requested by signature of residents on the attached petition, and,

FURTHER BE IT RESOLVED, That a 25 MPH speed limit be placed on Florence Drive (5th C.D.) as recommended in the attached correspondence from the Sullivan County Highway Department.

All resolutions in conflict herewith be and the same rescinded insofar as such conflict exist.

This resolution shall become effective on _____, 19____, the public welfare requiring it.

Duly passed and approved this 20th day of January, 1997

Attested:

County Clerk

Date: 1-20-97

County Executive

Date: 1-20-97

INTRODUCED BY COMMISSIONER Milhorn ESTIMATED COST: _____
SECONDED BY COMMISSIONER Belcher/Hicks FUND: _____

Committee Action	Approved	Disapproved	Deferred	Date
Administrative				
Budget				
Executive				

Commission Action	Aye	Nay	Pass	Absent	Total
Roll Call	23			1	
Voice Vote					

COMMENTS: WAIVER OF RULES APPROVED 1/20/97 ROLL CALL

0886

**SULLIVAN COUNTY
HIGHWAY DEPARTMENT**

P.O. BOX 590
BLOUNTVILLE, TENNESSEE 37617

John R. LeSueur, Jr.
Commissioner of Roads

*Attachment
Res # 12*

279-2820

January 8, 1997

COMMISSIONERS: Carol Belcher
Edley Hicks
Paul Milhorn

Dear Commissioners:

I would like to request that you consider passing the following resolution:

NO PARKING ON PAVEMENT signs be posted on the 100 BLOCK of FIRST AVENUE, in the 21st Civil District. (See attached petition.)

A 25 MPH SPEED LIMIT be placed on Florence Drive in the 5th Civil District.

If you have any questions, please feel free to contact me.

Sincerely,

Wayne Jones
Wayne Jones
Traffic Coordinator

WJ/jb

c: Shirley Gurganus

Enclosure: Petition

We the undersigned are in agreement that a "No Parking" zone and signs placed accordingly on the 100 block of First Avenue in Bristol, Tennessee:

Attachment
Page # 12

Name:	Address(optional):	Date:
L.D. & Leta Malone	189 First Ave	10-29-96
Travis Leonard	170 1st Ave	10-29-96
Chad Love	156 1st Ave	10-29-96
Charles D. Geyer	189 1st Ave	10-29-96
Frank & Jean Love	164 1st Ave	10-29-96

This should have read "No Parking on Pavement"
I talked to you on the 10/28/96

This is the signature on the No Parking signs we would like posted. Due to unsafe conditions and blocking of the street, children play & have almost been hit also there have been several close calls where auto have almost crashed. Your attention to this problem will be appreciated, I have also talked to Hwy-Dept. Thank you,

TO THE HONORABLE GIL HODGES, COUNTY EXECUTIVE, AND THE MEMBERS OF THE SULLIVAN COUNTY BOARD OF COMMISSIONERS IN Regular SESSION THIS THE 20th DAY OF January 1997.

RESOLUTION AUTHORIZING Acceptance of a Local Law Enforcement Block Grant in the Amount of \$43,707.00 from the Bureau of Justice Assistance [LEBG Grant #96LBVX2021]

WHEREAS, TENNESSEE CODE ANNOTATED; SECTION _____, AUTHORIZES COUNTIES TO _____

NOW, THEREFORE BE IT RESOLVED by the Board of County Commissioners of Sullivan County, Tennessee, assembled in Regular Session on the 20th day of January 1997.

THAT WHEREAS, Resolution No. 24, approved July 15, 1996 authorized the County Executive to apply for grant funds available through the U.S. Bureau of Justice Assistance, and

WHEREAS, Sullivan County received approval for the Local Law Enforcement Block Grant in the amount of \$43,707.00,

NOW, THEREFORE BE IT RESOLVED, That the Sullivan County Board of Commissioners approves acceptance of grant funds in the amount of \$43,707.00 from the Bureau of Justice Assistance, and further, authorizes the County Executive to duly execute the appropriate documents of said grant.

All resolutions in conflict herewith be and the same rescinded insofar as such conflict exist.

This resolution shall become effective on _____, 19__, the public welfare requiring it.

Duly passed and approved this 20th day of January, 1997

Attested: B. Feather Date: 1-20-97 Gil Hodges Date: 1-20-97
County Clerk County Executive

INTRODUCED BY COMMISSIONER Conkin ESTIMATED COST: _____
SECONDED BY COMMISSIONER Milhorn FUND: _____

Committee Action	Approved	Disapproved	Deferred	Date
Administrative				
Budget				
Executive				

Commission Action	Aye	Nay	Pass	Absent	Total
Roll Call	23			1	
Voice Vote					

COMMENTS: WAIVER OF RULES APPROVED 1/20/97 ROLL CALL



U.S. Department of Justice

Office of Justice Programs

Office for Civil Rights

Washington, DC 20531

389
*Attachment
Res # 13*

September 30, 1996

Gil D. Hodges
County Executive
County of Sullivan
Main Street Courthouse
PO Box 589
Blountville, TN 37617

Dear Law Enforcement Block Grantee:

Congratulations on your recent award. Because you have submitted Certified Assurances that your agency is in compliance with applicable civil rights laws, this office has determined that you have met this requirement in the Department of Justice regulations governing recipients of Federal financial assistance (see 28 C.F.R. sec. 42.204, Applicants' Obligations). As Director of the Office for Civil Rights (OCR), Office of Justice Programs, I would like to offer you my assistance in completing the conditions of these Assurances, specifically Nos. 13, 14, and 15, as the grant goes forward.

As you know, equal opportunity for the participation of women and minority individuals in employment and services provided under programs and activities receiving Federal financial assistance is required by law. Therefore, if there has been a federal or state court or administrative agency finding of discrimination against your agency, please forward a copy of such order or consent decree, as required by Assurance No. 14, to OCR at the U.S. Department of Justice, Office of Justice Programs, Office for Civil Rights, 633 Indiana Avenue, N.W., Washington, D.C. 20531.

(1) If you have already submitted an EEOP as part of another award from the Office of Justice Programs (OJP) within this grant period, or if you have certified that no EEOP is required, it is not necessary for you to submit another at this time. Simply send a copy of the letter you received from OCR showing that your EEOP or certification is acceptable.

Additional Instructions For Grantees Receiving \$500,000 Or More:

In accordance with Assurance No. 15, and as a recipient of \$500,000 or more (or \$1,000,000 in an 18-month period), with 50 or more employees, you must submit an Equal Employment Opportunity Plan (EEOP) within 60 days from the date of this letter to OCR at the above address. (1)

Alternatively, the grantee may choose to complete an EEOP Short Form, in lieu of sending its own comprehensive EEOP, and return it to OCR within 60 days of the date of this letter. This easy-to-follow EEOP Short Form reduces paperwork and preparation time considerably and will ensure a quicker OCR review and approval. The enclosed Seven-Step Guide to the Design and Development of an EEOP (which includes a Certification Form and an EEOP Short Form) will assist you in completing this requirement.

NOTE: If agency has under 50 employees, regardless of amount of award, no EEOP is required; however, grantee must return applicable portion of Certification Form to OCR within 60 days.

PURSUANT TO THE SPECIAL CONDITION REGARDING EEOP'S GOVERNING THIS AWARD, RECIPIENT ACKNOWLEDGES THAT FAILURE TO SUBMIT AN ACCEPTABLE EEOP IS A VIOLATION OF ITS CERTIFIED ASSURANCES AND MAY RESULT IN SUSPENSION OF DRAWDOWN OF FUNDS UNTIL EEOP HAS BEEN APPROVED BY THE OFFICE FOR CIVIL RIGHTS.

Additional Instructions For Grantees Receiving \$25,000 Or More, But Under \$500,000:

Pursuant to Department of Justice regulations, each grantee that receives \$25,000 or more and has 50 or more employees is required to maintain an Equal Employment Opportunity Plan (EEOP) on file for review by OCR upon request. Moreover, if the grantee is awarded \$1,000,000 in an eighteen (18) month period, it must submit an acceptable EEOP to OCR. Please complete the applicable section of the attached Certification Form and return it to OCR within 60 days of the date of this letter.

NOTE: If agency has under 50 employees, regardless of amount of award, no EEOP is required; however, grantee must return applicable portion of Certification Form to OCR within 60 days.

Additional Instructions For Grantees Receiving Under \$25,000:

A recipient of under \$25,000 is not required to maintain or submit an Equal Employment Opportunity Plan (EEOP) in accordance with Assurance No. 15.

Instructions for All Grantees:

In addition, all recipients, regardless of their type, the monetary amount awarded, or the number of employees in their workforce, are subject to the prohibitions against discrimination in any funded program or activity. OCR may require all recipients, through selected compliance reviews, to submit data to ensure their services are delivered in an equitable manner to all segments of the service population and their employment practices (2) are in compliance with equal employment opportunity requirements.

If you have any questions, or need additional help please call OCR at (202) 307-0690.

Sincerely,

Inez Alfonso-Lasso

Inez Alfonso-Lasso
Director, Office for Civil Rights

Enclosure

(2) The employment practices of certain Indian Tribes are not covered by Title VII of the Civil Rights Act of 1964, 42 U.S.C. sec. 2000e.

TO THE HONORABLE GIL HODGES, COUNTY EXECUTIVE, AND THE MEMBERS OF THE SULLIVAN COUNTY BOARD OF COMMISSIONERS IN Regular SESSION THIS THE 15th DAY OF July 19 96.

RESOLUTION AUTHORIZING Sheriff's Department to Apply for A Local Law Enforcement Block Grant in the Amount of \$43,707.00

WHEREAS, TENNESSEE CODE ANNOTATED; SECTION _____ AUTHORIZES COUNTIES TO _____

NOW, THEREFORE BE IT RESOLVED by the Board of County Commissioners of Sullivan County, Tennessee, assembled in Regular Session on the 15th day of July 19 96.

THAT WHEREAS, The Omnibus FY 1996 Appropriations Act, (Public Law 104-134), authorizes the Director of the Bureau of Justice Assistance to make funds available to units of local government under the Local Law enforcement Block Grants Program for the purposes of reducing crime and improving public safety, and

WHEREAS, Funds may be used for various purposes including training, procuring equipment and technology, enhancing security measures and establishing crime prevention programs.

NOW THEREFORE BE IT RESOLVED, That the Sullivan County Board of Commissioners authorizes the County Executive to submit an application to the Local Law Enforcement Block Grants Program for a grant in the amount of \$43,707.00.

WAIVER OF RULES REQUESTED

All resolutions in conflict herewith be and the same rescinded insofar as such conflict exist.

This resolution shall become effective on _____, 19____, the public welfare requiring it.

Duly passed and approved this 15 day of July, 19 96

Attested: _____ Date: _____
County Clerk County Executive

INTRODUCED BY COMMISSIONER Conkin ESTIMATED COST: _____
SECONDED BY COMMISSIONER Milhom FUND: _____

Committee Action	Approved	Disapproved	Deferred	Date
Administrative				
Budget				
Executive				

Commission Action	Aye	Nay	Pass	Absent	Total
Roll Call	22			2	
Voice Vote					

COMMENTS: WAIVER OF RULES APPROVED 7/15/96 ROLL CALL

*Res #13
Attached for
Info only*

TO THE HONORABLE GIL HODGES, COUNTY EXECUTIVE, AND THE MEMBERS OF THE SULLIVAN COUNTY BOARD OF COMMISSIONERS IN Regular SESSION THIS THE 20th DAY OF January 1997.

RESOLUTION AUTHORIZING Entering into an Agreement with the United States Forestry Service to Lease Property on South Holston Mountain to be Utilized as a Communications Site

WHEREAS, TENNESSEE CODE ANNOTATED; SECTION _____, AUTHORIZES COUNTIES TO _____

NOW, THEREFORE BE IT RESOLVED by the Board of County Commissioners of Sullivan County, Tennessee, assembled in Regular Session on the 20th day of January 1997.

THAT WHEREAS, The United States Forestry Service is authorized by the Act of October 21, 1976 (90-Stat.2743;43 USC1701, Et Seq.) to lease forestry land to governmental agencies to be used as communication sites, and

WHEREAS, The Sullivan County Emergency Management Agency entered into a lease agreement in August of 1991 for a communication site on the northern slope of South Holston Mountain, and

WHEREAS, The former site of the National Weather Service installation on Holston Mountain is available for lease as a communications site, and in consideration of its location will better serve the needs of Sullivan County, and

WHEREAS, Constructed on this site is a 30'x35' two-story building which provides enhanced emergency power, security and protection from man made or natural disasters, and

WHEREAS, All rental fees will be waived by the United States Forest Service under the authority of 36-CFR 251.57 (b) (1), and

WHEREAS, If approval is granted to lease the National Weather Service site, Sullivan County will be released from its agreement with the United States Forestry Service for lease of its existing communications site on the north slope of South Holston Mountain, and

NOW, THEREFORE BE IT RESOLVED, That the Sullivan County Board of Commissioners authorizes entering into an agreement with the United States Forestry Service for the purpose of leasing the former site of the National Weather Service installation on Holston Mountain, and further, authorizes the County Executive to execute the appropriate documents to institute said lease.

WAIVER OF RULES REQUESTED

All resolutions in conflict herewith be and the same rescinded insofar as such conflict exist.

This resolution shall become effective on _____, 19__, the public welfare requiring it.

Duly passed and approved this 20th day of January, 1997.

Attested:

County Clerk

Date: 1-20-97

County Executive

Date: 1-20-97

INTRODUCED BY COMMISSIONER Mayes ESTIMATED COST: _____

SECONDED BY COMMISSIONER Williams/Kiser FUND: _____

Committee Action	Approved	Disapproved	Deferred	Date
Administrative				
Budget				
Executive				

Commission Action	Aye	Nay	Pass	Absent	Total
Roll Call	20	3		1	
Voice Vote					

COMMENTS: WAIVER OF RULES APPROVED 1/20/97 ROLL CALL

File Code: 2720

Date: December 18, 1996

*Attachment
Res # 14*

Mr. Jerry A. Fleenor, Director
Sullivan County Emergency Management Agency
P.O. Box 389
3193 Highway 126
Blountville, TN 37617

Dear Mr. Fleenor:

Enclosed are two copies of your lease for the facilities previously owned by the National Weather Service on Site #6 Holston Mountain Electronic Site. Please sign and date the Communication Use Lease on page 9 on both copies. Attached to the lease is a copy of the Holston Mountain Electronic Site Plan as Exhibit A and Stipulations for the Lease as Exhibit B. Please sign both copies of Exhibit B on page 2. Return all copies intact for approval by the Issuing Officer. Upon approval, we will return one copy for your records.

The permit issued to the Office of Emergency Preparedness #1086 on Site #1 Holston Mountain is terminated effective this date. As noted in Exhibit B of your lease, you are to vacate site #1 within one year from the date of the lease.

If you have any questions concerning your lease, please contact Pete Irvine at (423)542-2942 or Ruby Cato of this office at (423)476-9700.

Sincerely,

Ruby J. Cato
for W. L. KEARNEY
Fire, Lands, Minerals, and
S&PF Staff Officer

Enclosures

TITLE: SITE 6 AND ROAD
 DATE: 11 DECEMBER 1996 TIME: 16:32:39
 DISTANCE: 3969.72 FT. AREA: 1.26 ACRES
 ERROR IN CLOSURE IS 1 IN .243 OR .41%

SCALE: 21.22 IN = 1 MILE

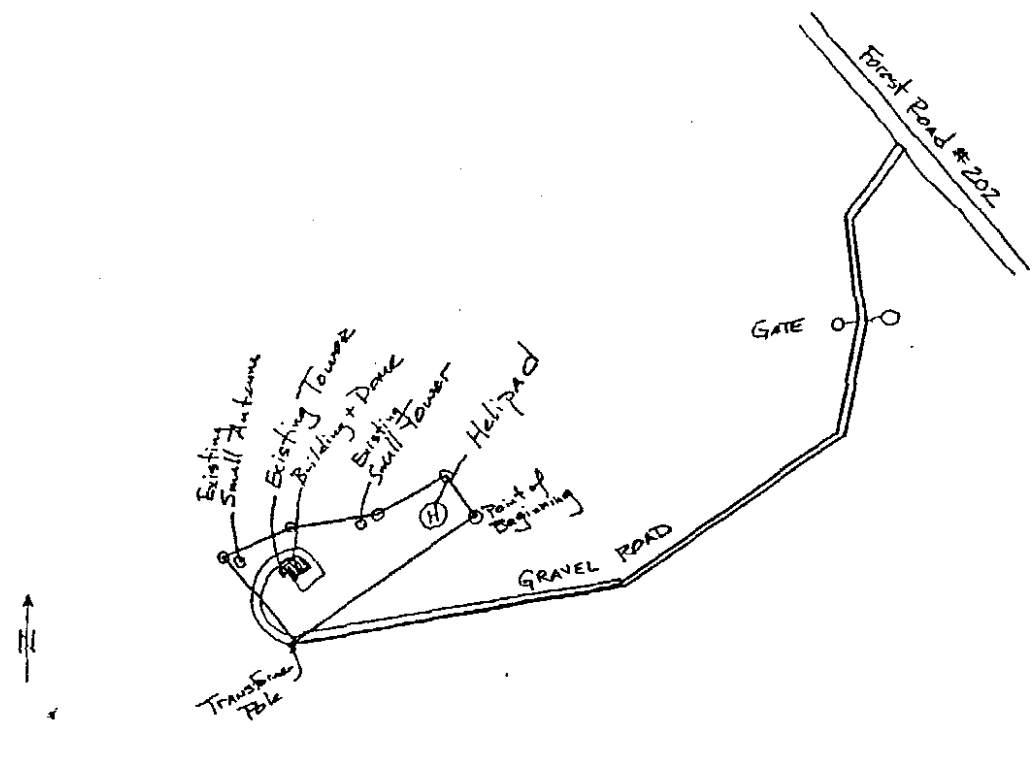

660.00 feet

O = Rebar pin set
 AVERAGE ROAD WIDTH = 14 feet

01 SITE 6 AND ROAD		
370.00'	+10.00 %	236.00'
550.00	+10.00	80.00
430.00	+10.00	56.00
185.00	+10.00	10.00
165.00	+10.00	352.00
140.00	+10.00	36.00
14.00	+0.00	126.00
140.00	+10.00	216.00
165.00	+10.00	172.00
185.00	+10.00	190.00
430.00	+10.00	236.00
550.00	+10.00	260.00
186.00	+3.00	315.00
120.00	+2.00	68.00
150.00	+8.00	81.00
127.00	+6.00	62.00
80.00	+3.00	140.00
.00	.00	.00

EXHIBIT C. Site 6, H.M.E.S.

Site 6
 HOLSTON MOUNTAIN ELECTRONIC SITE
 Approximate Site Boundaries
 Traversed by FBI and DF, 12/9/96
 Formerly operated by National Weather Service
 under MOU dated December 11, 1967

0796

THE UNITED STATES
DEPARTMENT OF AGRICULTURE
FOREST SERVICE
COMMUNICATIONS USE LEASE

Sullivan County Emergency Management Agency of P.O. Box 389
(Lessee Name) (Billing Address - 1)

3193 Highway 126 Blountville TN 37617
(Billing Address -2) (City) (ST) (Zip Code)

THIS LEASE, dated this _____ day of _____, 1996, by and between the UNITED STATES OF AMERICA, acting through the Forest Service, Department of Agriculture (hereinafter called the "United States" or "Forest Service"), as authorized by the Act of October 21, 1976, (90 Stat. 2743; 43 U.S.C. 1701, et seq.), and Sullivan County Emergency Management Agency, its agents, successors, and assigns (hereinafter called the "Lessee").

The United States and the Lessee are jointly referred to herein as the "Parties." As used herein, the "Authorized Officer" refers to the Forest Service official having the delegated authority to execute and administer this lease. Generally, unless otherwise indicated, such authority may be exercised by the Forest Supervisor or District Ranger of the National Forest wherein the following described lands are located.

The United States, for and in consideration of the terms and conditions contained herein and the payment to the United States of a rental in advance by the Lessee, does hereby grant to the Lessee a lease for the following described lands in the Counties of Carter and Sullivan, State of Tennessee: A portion of the Holston Mountain Communication Site, detailed as Site 6, and with dimensions as shown on enclosed map, titled Exhibit C of the Communication Site Plan (hereinafter called the "property"). The Lessee accepts this lease and possession of the property, subject to any valid existing rights, and agrees not to use the property, or any part thereof, except as a site for only the construction, operation, maintenance, and termination of a communications facility.

The existing facilities include a 30' x 35' two-story building with radar dome, a 1600' long gated driveway and parking area, a helipad, a 2000-gallon buried diesel storage tank, a buried drinking water tank, and a septic tank and leach field, and 2 existing towers on approximately 4 acres. SCEMA will erect a 100 foot guyed tower adjacent to the existing building. All construction, operation, and maintenance of facilities to be in accordance with Exhibit B which is made a part of this lease.

The location of the property is shown generally on the site plan dated as amended 10/3/77 for the Holston Mountain Communications Site which is attached and made part hereof as Exhibit A.

The dated and initialled exhibit(s), attached hereto, are incorporated into and made a part of this instrument as fully and effectively as if they were set forth herein in their entirety.

The parties agree that this lease is made subject to the following terms and conditions.

I. TENURE, RENEWAL AND TRANSFERABILITY

A. This lease shall terminate at one minute after midnight on December 31, 2006. Termination at the end of the lease term shall occur by operation of law and shall not require any additional notice or documentation by the Authorized Officer. This lease is not renewable; but the Lessee has the right to request a new lease pursuant to paragraph "C" below.

B. The Lessee shall undertake and pursue with due diligence construction and operation that is authorized by this lease. To the extent specified in Exhibit B, operation shall commence on May 1, 1997. This lease shall terminate if operation does not commence by that date, unless the parties agree in writing, in advance, to an extension of the commencement date.

C. If the Lessee desires a new lease upon termination of this lease, the Lessee shall notify the Authorized Officer accordingly, in writing. The notice must be received by the Authorized Officer at least one year prior to the end of the lease term. The Authorized Officer will determine if the use should continue and, if it is to continue, if a new lease should be issued to the Lessee and under what conditions. The Authorized Officer shall require payment of any amounts owed the United States under any Forest Service authorization before issuance of another authorization.

D. This lease is assignable with prior written approval of the Authorized Officer, except when the rental has been waived in whole or part. Renting of space does not constitute an assignment under this clause.

II. RENTAL (Fees Waived Under Authority 36 CFR 251.57(b)(1))

A. The Lessee must pay in advance an annual rental determined by the Authorized Officer in accordance with law, regulation, and policy. The annual rental will be adjusted by the Authorized Officer to reflect changes in fair market value, annual adjustments using the Consumer Price Index-Urban (CPI-U), changes in tenant occupancy, or phase-in of rental, if applicable.

B. Rentals are due at the close of business on January 1 of each year for which a payment is due. Payments due the United States for this use shall be deposited at P.O. Box 60000 File No. 41658, San Francisco, CA 94160-1658 in the form of a check, draft, or money order payable to Forest Service, USDA. If the due date for the rental or rental calculation statement falls on a non-work day, the charges shall not apply until the close of business on the next workday. This lease terminates if rent is not received by the Forest Service within 90 calendar days of the due date.

C. Pursuant to the Federal Claims Collection Act of 1966, as amended, 31 U.S.C. 3717, et seq., regulations at 7 CFR Part 3, Subpart B and 4 CFR Part 102, an interest charge shall be assessed on any amount due but not received by the due date. Interest shall accrue from the date the payment or financial statement was due. Administrative costs will also be assessed in the event that two or more billings are required for delinquent accounts. In addition, an administrative penalty at a percentage rate prescribed by law or regulation will be assessed for failure to pay any portion of the debt that is more than 90 days past due. This paragraph shall survive the termination or revocation of this lease, regardless of cause.

D. Disputed rentals are due and payable by the due date. No appeal of rentals will be considered by the Forest Service without full payment of the disputed amount.

III. RESPONSIBILITIES OF THE LESSEE

A. The Lessee is authorized to rent space and provide other services to customers and/or tenants and shall charge each customer/tenant a reasonable rental without discrimination for the use and occupancy of the facilities and services provided. The Lessee shall impose no unreasonable restrictions nor any restriction restraining competition or trade practices. By October 15 of each year, the Lessee shall provide the Authorized Officer a certified statement listing all tenants and customers, by category of use in the facility on September 30th of that year.

B. All development, operation and maintenance of the authorized facility, improvements, and equipment located on the property shall be in accordance with stipulations in the communications site plan approved by the Authorized Officer. If required by the Authorized Officer, all plans for development, layout, construction, or alteration of improvements on the property as well as revisions of such plans, must be prepared by a licensed engineer, architect, and or landscape architect. Such plans must be approved in writing by the Authorized Officer before commencement of any work. After completion, as-built plans, maps, surveys, or other similar information will be provided to the Authorized Officer and appended to the communications site plan.

C. The Lessee will comply with applicable Federal, State, county, and municipal laws, regulations and standards for public health and safety, environmental protection, siting, construction, operation, and maintenance in exercising the rights granted by this lease. The obligations of the Lessee under this lease are not contingent upon any duty of the Authorized Officer, or other agent of the United States, to inspect the premises. A failure by the United States, or other governmental officials, to inspect is not a defense to noncompliance with any of the terms or conditions of this lease. Lessee waives all defenses of laches or estoppel against the United States. The Lessee shall at all times keep the title of the United States to the property free and clear of all liens and encumbrances.

D. Use of communications equipment is contingent upon the possession of a valid Federal Communications Commission (FCC) or Director of Telecommunications Management/Interdepartmental Radio Advisory Committee (DTM/IRAC) authorization, and the operation of the equipment is in strict compliance with applicable requirements of FCC or IRAC. A copy of each applicable license or authorization shall at all times be maintained by the Lessee for each transmitter being operated. The Lessee shall provide the Authorized Officer, when requested, with current copies of all licenses for equipment in or on facilities covered by this lease.

E. The Lessee shall ensure that equipment within his or her facility (including tenant and customer equipment) operates in a manner which will not cause harmful interference with the operation of existing equipment on or adjacent to the communications site. If the Authorized Officer or authorized official of the Federal Communications Commission (FCC) determines that the Lessee's use interferes with existing equipment, the Lessee will promptly take the necessary steps to eliminate or reduce the harmful interference to the satisfaction of the Authorized Officer or FCC official.

F. When requested by the Authorized Officer, the Lessee will furnish technical information concerning the equipment located on the property.

IV. LIABILITIES

A. The Lessee assumes all risk of loss to the authorized improvements.

B. The Lessee shall comply with all applicable Federal, State, and local laws, regulations, and standards, including but not limited to, the Federal Water Pollution Control Act, 33 U.S.C. 1251 et seq., the Resource Conservation and Recovery Act, 42 U.S.C. 6901 et seq., the Comprehensive Environmental Response, Control, and Liability Act, 42 U.S.C. 9601 et seq., and other relevant environmental laws, as well as public health and safety laws and other laws relating to the siting, construction, operation, and maintenance of any facility, improvement, or equipment on the property.

C. The Lessee shall indemnify, defend, and hold the United States harmless for any violations incurred under any such laws and regulations or for judgments, claims, or demands assessed against the United States in connection with the Lessee's use or occupancy of the property. The Lessee's indemnification of the United States shall include any loss by personal injury, loss of life or damage to property in connection with the occupancy or use of the property during the term of this lease. Indemnification shall include, but is not limited to, the value of resources damaged or destroyed; the costs of restoration, cleanup, or other mitigation; fire suppression or other types of abatement costs; third party claims and judgments; and all administrative, interest, and other legal costs. This paragraph shall survive the termination or revocation of this lease, regardless of cause.

D. The Forest Service has no duty, either before or during the lease term, to inspect the property or to warn of hazards and, if the Forest Service inspects the property, it shall incur no additional duty nor any liability for hazards not identified or discovered through such inspections. This paragraph shall survive the termination or revocation of this lease, regardless of cause.

E. The Lessee has an affirmative duty to protect from damage the land, property, and interests of the United States.

F. In the event of any breach of the lease by the Lessee, the Authorized Officer may, on reasonable notice, cure the breach for the account at the expense of the Lessee. If the Forest Service at any time pays any sum of money or does any act which will require payment of money, or incurs any expense, including reasonable attorney's fees, in instituting, prosecuting, and/or defending any action or proceeding to enforce the United States rights hereunder, the sum or sums so paid by the United States, with all interests, costs and damages shall, at the election of the Forest Service, be deemed to be additional rental hereunder and shall be due from the Lessee to the Forest Service on the first day of the month following such election.

V. OTHER PROVISIONS

A. Nondiscrimination. The Lessee shall at all times operate the described property and its appurtenant areas and its buildings and facilities, whether or not on the property, in full compliance with Title VI of the Civil Rights Act of 1964 and all requirements imposed by or pursuant to the regulations issued thereunder by the Department of Agriculture and in effect on the date this lease is granted to the end that no person in the United States shall, on the grounds of race, sex, color, religion, or national origin, be excluded from participation in, be denied the benefits of, or be subjected to discrimination under any of the programs or activities provided thereon.

B. Revocation, Termination, and Suspension.

1. General. For purposes of this lease, termination, revocation, and suspension refer to the cessation of uses and privileges under the lease.

"Revocation" refers to an action by the Authorized Officer to end the lease because of noncompliance with any of the prescribed terms, abandonment, or for reasons in the public interest. Revocations are appealable.

"Termination" refers to the cessation of the lease under its own terms without the necessity for any decision or action by the Authorized Officer. Termination occurs automatically when, by the terms of the lease, a fixed or agreed upon condition, event, or time occurs. For example, the lease terminates at expiration. Terminations are not appealable.

"Suspension" refers to a revocation which is temporary and the privileges may be restored upon the occurrence of prescribed actions or conditions. Suspensions are appealable.

2. This lease may be suspended or revoked upon breach of any of the conditions herein or upon nonuse. Nonuse refers to a failure to operate the facilities on the property for a period of one years.

3. Except in emergencies, the Authorized Officer shall give the Lessee written notice of the grounds for revocation or suspension and a reasonable time, not to exceed 90 days, to complete the corrective action. After 90 days, the Forest Service is entitled to such remedies as provided herein.

4. This lease may be revoked at the discretion of the Forest Service when in the public interest. When revoked in the public interest, the Lessee shall be compensated subject to the availability of appropriated funds. Compensation shall be based upon the initial cost of improvements located on the lease, less depreciation as allocated over the life of the improvements as declared by the Lessee's Federal tax amortization schedules.

5. Any discretionary decisions or determinations by the Authorized Officer on revocation or suspension are subject to the appeal regulations at 36 CFR 251, Subpart C, or revisions thereto.

6. In the event the Authorized Officer decides not to issue a new lease, or the Lessee does not desire a new lease, the Authorized Officer and the Lessee shall, within six months prior to the termination date of this lease, agree upon a mitigation plan to restore and stabilize the site.

In the event this lease is revoked for noncompliance, the Lessee shall remove all structures and improvements within 180 days, except those owned by the United States, and shall restore the site as nearly as reasonably possible to its original condition unless this requirement is otherwise waived in writing by the Authorized Officer.

If the Lessee fails to remove all structures or improvements within the prescribed period, they shall become the property of the United States and may be sold, destroyed, or otherwise disposed of without any liability to the United States.

C. Members of Congress. No member of or Delegate to Congress or Resident Commissioner shall benefit from this lease either directly or indirectly, except when the lease provides a general benefit to a corporation.

D. Reservations. This lease is granted subject to the following reservations by the United States:

1. The right to all natural resource products now or hereafter located on the property unless stated otherwise, and the right to utilize or dispose of such resources insofar as the rights of the Lessee are not unreasonably affected.
2. The right to modify the communications site plan as deemed necessary.
3. The right to enter upon the lease and inspect all facilities to assure compliance with the conditions of this lease.
4. The right of the United States to require common use of the property, and the right to authorize use of the property for compatible uses, including the subsurface and air space.

In the event of any conflict between any of the preceding printed clauses or any provisions thereof and any of the following clauses or any provision thereof, the preceding printed clauses shall control.

1. The permitted area will be maintained to present a clean, neat, and orderly appearance. Trash, debris, unusable machinery, improvements, etc., will be disposed of currently. Building materials, firewood, etc., will be neatly stacked.
2. All butane, propane, or other liquified petroleum gas equipment shall be installed and operated in accordance with the laws and regulations of the State.
3. This permit is not exclusive; that is, the Forest Service reserves the right to use or permit others to use any part of the permitted area for any purpose, provided such use does not interfere with the rights and privileges hereby authorized.
4. The holder will reduce to writing all of its agreements with authorized users of the facilities covered by this permit, specifying therein, as a separate item, the rental and service charge for the use of said facilities, and will furnish a true copy of each such agreement and any changes therein to the authorized officer.

5. The Forest Service reserves the right to authorize joint use by others of the building, antenna support structures, driveway, and/or parking area, subject to conditions a and b of clause III, and payment by the joint user of an equitable rental to the holder.

6. This permit is contingent upon the existence of applicable Federal Communications Commission (FCC) or Director of Telecommunications Management/Interdepartment Radio Advisory Committee (DTM/IRAC) authorizations and operation of the equipment covered in strict compliance with applicable requirements of FCC or IRAC and the technical data set forth on Form FS-2700-10, Technical Data-Electronic Type Land Use. Said forms are to be attached and made a part of this permit.

The holder will supply the Forest Service with amended form FS-2700-10 whenever necessary to reflect changes or additions, which must receive prior approval of the FCC or DTM/IRAC following prescribed procedures.

7. Each radio or electronic transmitter covered by this permit shall be operated only by the holder of a current and valid Federal Communications Commission (FCC) license or Interdepartmental Radio Advisory Committee (IRAC) authorization applicable thereto. A legible copy of each applicable license or authorization shall at all times be posted on the cabinet or rack of each transmitter being operated. Each such copy shall indicate each person or entity authorized under the license of authorization to operate the transmitter.

8. The holder shall not install, use, or allow the installation or use of any radio or electronic equipment on or within the premises covered by this permit without prior issuance of a special-use permit by the Forest Service.

9. All transmitting and receiving equipment, including power supplies, shall be mounted in enclosed metal cabinets or standard racks with effective radio-frequency protective metal shielding covers. All electronic equipment, including associated cables, wiring, auxiliary equipment, and antenna systems, shall be installed and maintained in a clean, neat, and orderly manner, and shall be electrically and mechanically sound.

10. The Forest Service reserves the right to enlarge or reduce the area of the site described herein, provided that the area actually occupied by the buildings shall not be excluded therefrom. The Forest Service further reserves the right, in conformity with sound engineering practices, to require the holder to discontinue the use of the parking lots or service roads or any portions thereof, and to relocate the utility lines and equipment, the antenna, and any other improvements constructed on the site except the buildings, to any other locations within or outside the boundaries of the site described herein.

11. The operation of the equipment covered by this permit shall not interfere with United States Government radio or electronic operations already in existence on National Forest land within two (2) miles of the site to which this permit refers. The permittee shall at its own expense take all action necessary to prevent or eliminate such interferences. If it does not eliminate such interference within ten (10) days after receipt of notice from the Forest Service to do so, this permit may be terminated forthwith.

ACCEPTED this _____ day of _____, 19 ____, I, the undersigned have read, understand and accept the terms and conditions of this lease.

Lessee

IN WITNESS WHEREOF, the Forest Service, by its Authorized Officer, has executed this lease on the day and year first written above.

UNITED STATES OF AMERICA

for Forest Supervisor
Authorized Officer (Title)
Forest Service
Department of Agriculture

SUBSTITUTE

RESOLUTION NUMBER

15

TO THE HONORABLE GIL HODGES, COUNTY EXECUTIVE, AND THE MEMBERS OF THE SULLIVAN COUNTY BOARD OF COMMISSIONERS IN Regular SESSION THIS THE 20th DAY OF January 1997.

RESOLUTION AUTHORIZING Amending Sullivan County Library Budget for FY 1996-97 for the Purpose of Increasing Certain Employees Work Schedule

WHEREAS, TENNESSEE CODE ANNOTATED; SECTION _____ AUTHORIZES COUNTIES TO _____

NOW, THEREFORE BE IT RESOLVED by the Board of County Commissioners of Sullivan County, Tennessee, assembled in Regular Session on the 20th day of January 1997.

THAT WHEREAS, Sullivan County Library personnel are experiencing an increased work load due to an expanding daily circulation and in assisting patrons in the use of the Library's computer equipment, and

WHEREAS, Sullivan Gardens Library is in need of additional hours for janitorial service,

NOW, THEREFORE BE IT RESOLVED, That the Sullivan County Board of Commissioners approves the increase in the hourly work schedule of the personnel listed on the attachment, and further, authorizes the appropriation of funds from the General Fund Undesignated Fund Balance (Account 39000.000) for the FY 1996-97 budget to Account 56500.100 (Libraries) to fund the increase in payroll expenditures. The amount of the funding required to complete the FY 1996-97 budget year shall be determined by the Director, Accounts and Budgets.

All resolutions in conflict herewith be and the same rescinded insofar as such conflict exist.

This resolution shall become effective on _____, 19__, the public welfare requiring it.

Duly passed and approved this 20th day of January, 1997

Attested: B. Feathers Date: 1/20/97 Gil Hodges Date: 1-20-97
County Clerk County Executive

INTRODUCED BY COMMISSIONER Carter ESTIMATED COST: _____
SECONDED BY COMMISSIONER Hubbard FUND: _____

Committee Action	Approved	Disapproved	Deferred	Date
Administrative				
Budget				
Executive				

Commission Action	Aye	Nay	Pass	Absent	Total
Roll Call	19	4		1	
Voice Vote					

COMMENTS: WAIVER OF RULES APPROVED 1/20/97 ROLL CALL

INCREASED HOURLY WORK SCHEDULE - LIBRARY PERSONNEL

56500.100 - Libraries FY 1996-97 Budget

Part-time Assistants to Branch Mgrs	Annual Increase	FY 1996-97 Increase
Increasing hours <u>from 969 to 1196</u> hours annually are:		
D. Leonard (+227 hrs.)	<u>\$1,078.25</u>	<u>\$ 539.12</u>
T. English (+227 hrs.)	<u>\$1,078.25</u>	<u>\$ 539.12</u>
K. Brown (+227 hrs.)	<u>\$1,078.25</u>	<u>\$ 539.12</u>
Increasing hours <u>from 780 to 1196</u> hours annually is:		
J. Feathers (+416 hrs.)	<u>\$1,976.00</u>	<u>\$ 988.00</u>
Increasing hours <u>from 761 to 1196</u> hours annually is:		
D. McMillian (+435 hrs.)	<u>\$2,066.25</u>	<u>\$1,033.13</u>
Part-time Custodian		
Increasing hours <u>from 156 to 208</u> hours annually is:		
D. Rhoton (+52 hrs.)	<u>\$ 247.00</u>	<u>\$ 123.50</u>
TOTAL ANNUAL HOURS INCREASED:		1,584
EMPLOYEE BENEFITS:		+ Matching FICA & Medicare

408

RESOLUTION NUMBER

18

TO THE HONORABLE GIL HODGES, COUNTY EXECUTIVE, AND THE MEMBERS OF THE SULLIVAN COUNTY BOARD OF COMMISSIONERS IN Regular SESSION THIS THE 20th DAY OF January 1997.

RESOLUTION AUTHORIZING Amendment to the Projects List of the Sewer Agreement

WHEREAS, TENNESSEE CODE ANNOTATED; SECTION _____ AUTHORIZES COUNTIES TO _____

NOW, THEREFORE BE IT RESOLVED by the Board of County Commissioners of Sullivan County, Tennessee, assembled in Regular Session on the 20th day of January 1997.

THAT WHEREAS, The Chief Executive Officers of the County and City met in February, 1996 and agreed to the modification of the projects list (Exhibit "A").

NOW THEREFORE BE IT RESOLVED, That the projects list (Exhibit "A") be amended to change the funding of the Carter's Valley (North Kingsport) trunk line to the year 1999 and the funding of the sewer trunk lines presently scheduled for 1999, 2000, and 2001, respectively, be moved to one year later.

WAIVER OF RULES REQUESTED

All resolutions in conflict herewith be and the same rescinded insofar as such conflict exist.

This resolution shall become effective on _____, 19____, the public welfare requiring it.

Duly passed and approved this 20th day of January, 1997

Attested:

County Clerk

Date: 1-20-97

County Executive

Date: 1-20-97

INTRODUCED BY COMMISSIONER Reedy ESTIMATED COST: _____
SECONDED BY COMMISSIONER Williams/Boyd FUND: _____

Committee Action	Approved	Disapproved	Deferred	Date
Administrative				
Budget				
Executive				

Commission Action	Aye	Nay	Pass	Absent	Total
Roll Call	20	1	2	1	
Voice Vote					

COMMENTS: WAIVER OF RULES APPROVED 1/20/97 ROLL CALL

*Attachment
Res # 18*

EXHIBIT "A"

Proposed Trunk Lines

Name	Est. Cost	Year To Fund
<u>Kingsport</u>		
E. Stone Drive	\$2,000,000	1997-98
N. Beason Well, Bloomingdale	1,000,000	1996-97
Cedar Grove, Rosetree	900,000	1996-97
Carter's Valley (N. Kingsport)	2,000,000	1999
W. Shipley Ferry Road	600,000	1996-97
Steadman Farm Industrial Park	1,000,000	1998
Miscellaneous Short Lines	<u>500,000</u>	As needed
Total	\$8,000,000	

Bristol

Whitetop Creek, Phase 1	\$2,110,000	2001
Whitetop Creek, Phase 2	2,390,000	2002-03
Evans Creek Pump Station Upgrade	850,000	2003
Hwy. 11-W, Reedy Creek, Phase 1	2,040,000	2003-04
Hwy. 11-W, Reedy Creek, Phase 2	2,285,000	2004-05
Miscellaneous Short Lines	<u>825,000</u>	As needed
Total	\$10,500,000	

Bluff City

Highway 19-E Corridor	\$ 1,500,000	2000
-----------------------	--------------	------

Total For All Projects \$20,000,000

Trunk Lines Now Funded or Under Construction:

Kingsport - Horse Creek, Indian Springs
 Bristol - Back Creek, Walnut Hills, Maple Hills (Hwy. 126)

(As amended by Mayors and County Executive - February 1996)

1990 constitution, OAG 93-43

ily resource centers may
r to coordinate state and
line with children. Each
school board shall appoint
an advisory council for
majority of each advisory

on, classroom support and
recreation agency to plan and
on for such approval shall
staff from the school and/or
guidance counselors, social
workers. In establishing family
the departments of health,
services, and youth develop.

ed to award grants of up to
agencies for the purpose of
centers. Beginning with the
source centers receiving such
at least twice the number of
2003-1994 school years.

oved family resource centers
te funding for:
elementary schools;

risk;
sk children;

te;
enagers; and
schools.

interagency services/resources
crisis intervention, respite care,
on with behavioral/emotional

function of being the center of
for such families.

the function of helping families
tions of service their child and/or
194, ch. 974, § 6; 1994, ch. 985,

Effective Dates: Acts 1994, ch. 974, § 1
1991.
1994, ch. 985, § 7, July 1, 1994.

49-2-118. School safety zones. — (a) Any county or municipality is hereby authorized to establish school safety zones.

(b) As used in this section, unless the content otherwise requires:

(1) "School" means any public or private elementary, secondary, or vocational, technical school; and

(2) "School property" means all property used for school purposes, including, but not limited to, school playgrounds.

(c) A school safety zone is the territory located within one thousand feet (1,000') of school property.

(d) The superintendent of schools, with the approval of the board of education, may develop a method of marking school safety zones, including the use of signs. Signs or other markings shall be located in a visible manner on or near each school indicating that such area is a school safety zone, that such zone extends one thousand feet (1,000') from school property and that the delivery or sale of a controlled substance to a minor in such school safety zone will subject the offender to an enhanced punishment. The state board of education shall assist the local education agency in complying with the posting provisions of this subsection. (Acts 1994, ch. 973, §§ 1, 2.)

Compiler's Note: Acts 1994, ch. 973, § 3 provides that if any provision of that act or the application thereof to any person or circumstance is held invalid, then all provisions and applications of that act are declared to be invalid and void. Effective Dates: Acts 1994, ch. 973, § 4, July 1, 1994.

PART 2—BOARDS OF EDUCATION

49-2-201. Election or appointment. — (a)(1) Notwithstanding any other law to the contrary, there shall be a board of education elected by the people. Except in counties with a county charter or metropolitan government charter, the board shall consist of no more members than the number of members authorized by general law or private act for boards of education in existence on January 1, 1993, except during transition periods following district reappointment. The members of the board shall be elected for a term of four (4) years, and may succeed themselves. For the first election held pursuant to this section, in order to establish staggered terms of office, the members from even-numbered districts shall be elected for a term of two (2) years, and the members of odd-numbered districts shall be elected for four (4) years. Members of county and municipal boards of education shall be residents of and elected from districts of substantially equal population established by resolution of the local legislative body. Members of special school district boards of education shall be elected according to special or private act, but shall be popularly elected on a staggered term basis. Vacancies occurring on the board shall be filled by the local legislative body. In special school districts, vacancies on the board arising from death or resignation shall be filled by the special school district school board. Any person so appointed shall serve until a successor is elected and qualifies according to law. The successor shall be elected at the next general election for which candidates have a sufficient time to qualify under the law. All elections for school board members shall be conducted on a nonpartisan basis, and no person seeking a position on a board shall campaign as the nominee or representative of any political party.

Attachment
Res # 17

PUBLIC NOTICE

SULLIVAN COUNTY BOARD OF COUNTY COMMISSIONERS

The Sullivan County Board of County Commissioner will hold a public hearing on Monday, January 20, 1997 at 9:00 A. M. in the Sullivan County Courthouse, Blountville, Tennessee to consider the following requests.

- (1) Living Praise Assembly of God requested that a tract of land located in the 10th Civil District at the intersection of Fleming Road, Lucy Road and Ernie Drive be rezoned from R-1 to PBD to permit the location of future commercial development.
- (2) Charles D. Bernard requested that a tract of land located in the 13th Civil District on the south side of S. Eastman Road approximately 1900 feet north of its intersection with S. Wilcox Drive be rezoned from R-1 to B-3 to permit the location of retail sales.

The public is cordially invited to attend this public hearing and comment upon any rezoning request. For more information, please call 323-6440.

AND THEREUPON COUNTY COMMISSION ADJOURNED TO MEET
AGAIN IN REGULAR SESSION FEBRUARY 17, 1997.

GIL HODGES, COUNTY EXECUTIVE