

COUNTY COMMISSION - REGULAR SESSION

JANUARY 18, 1999

BE IT REMEMBERED THAT:

COUNTY COMMISSION MET PURSUANT TO ADJOURNMENT IN ADJOURNED SESSION OF THE SULLIVAN COUNTY BOARD OF COMMISSIONERS THIS MONDAY MORNING, JANUARY 18, 1999, 9:00 A.M. IN BLOUNTVILLE, TENNESSEE. PRESENT AND PRESIDING WAS HONORABLE GIL HODGES, COUNTY EXECUTIVE, JEANIE F. GAMMON, COUNTY CLERK AND WAYNE ANDERSON, SHERIFF OF SAID BOARD OF COMMISSIONERS,

TO WIT:

The Commission was called to order by County Executive, Gil Hodges. Sheriff Wayne Anderson opened the commission and Commissioner Dennis Houser gave the invocation. Pledge to the flag was led by County Executive, Gil Hodges.

Commissioners present and answering roll call are as follows:

CAROL J. BELCHER
BRYAN K. BOYD
FRED CHILDRESS
MIKE CONCE
DENNIS HOUSER
SAMUEL JONES
JAMES "BUDDY" KING
DWIGHT MASON
WAYNE MCCONNELL
RANDY MORRELL
ARCHIE PIERCE
MARK A VANCE

JAMES R. "JIM" BLALOCK
JUNE CARTER
O. W. FERGUSON
RALPH HARR
MARVIN HYATT
ELLIOTT KILGORE
JAMES L. KING, JR.
GARY MAYES
PAUL MULHORN
HOWARD PATRICK
MICHAEL B. SURGENOR
EDDIE WILLIAMS

24 PRESENT 0 ABSENT

The following pages indicates the action taken by the Commission on re-zoning requests, approval of notary applications and personal surety notary bonds, motions, resolutions and other matters subject to the approval of the Board of Commissioners.

Public Comments:

Those speaking during the public comment time were as follows:

1. Bobby Goodson

Motion was made by Comm. Harr and seconded by Comm. Vance to approve the minutes of the Dec. 21, 1998 regular session of County Commission. Motion was approved by voice vote.

Quarterly Reports filed this regular session, Jan. 18, 1999 were as follows: Sullivan County Purchasing, Sullivan County Commissioner of Highways, and Sullivan County Safety & Insurance.

STATE OF TENNESSEE
COUNTY OF SULLIVAN

ELECTION OF NOTARIES

DECEMBER 21, 1998

William Larry Barrett

Karen N. Belcher

Benita J. Bowman

Dennis Crawford

C. Rhenea Cross

Jill N. DeLoach

Peggy Jo Eades

J. Wesley Edens

E. E. Fields

Rita J. Flick

Howard W. Francis

Phillip A. Franklin

Linda S. Fuller

Kita Gibson

Cynthia Hagey

Sandra Harkleroad

Shelby Jean Hensley

Beth Hicks

Justine C. Hill

Brenda Hurley

Luther H. Icenhour, Jr.

Vickie G. Johnson

Erma Kate Kern

Wanda W. Kilby

Michael David Light

Pamela M. Light

Carlene A. Mancuso

Terry McCroskey

Betty M. McGhee

Lori A. Miller

Rob Nicar

Mark A. Parsons

Lynda Peterson

Samuel H. Saul

Thomas F. Sullivan

David Tucker

Juanita Webb

UPON MOTION MADE COMM. HARR AND SECONDED
BY COMM. HYATT TO APPROVE THE NOTARY
APPLICATIONS HEREON, SAID MOTION WAS
APPROVED BY ROLL CALL VOTE OF THE COMMISSION
24 AYE.

STATE OF TENNESSEE
COUNTY OF SULLIVAN

APPROVAL OF NOTARY
PUBLIC SURETY BONDS

JANUARY 18, 1999

Donna L. Bandy

Donald W. Cole

Orville L. Cox

Charles Fritts

Martha L. Haywood

Mitch Moore

Paul A. Morrell

Natalie J. Owens

Hilliary D. Phillips

Earl W. Simpson, Jr.

David L. Clark

James S. Montgomery

UPON MOTION MADE BY COMM. HARR AND SECONDED BY COMM HYATT TO APPROVE
THE NOTARY BONDS OF THE ABOVE NAMED INDIVIDUALS, SAID MOTION WAS
APPROVED BY ROLL CALL VOTE OF THE COMMISSION.
24 AYE.

RESOLUTION NUMBER 1

TO THE HONORABLE GIL HODGES, COUNTY EXECUTIVE, AND THE MEMBERS OF THE SULLIVAN COUNTY BOARD OF COMMISSIONERS IN Regular SESSION THIS THE 18th DAY OF January, 1999.

RESOLUTION AUTHORIZING The Sullivan County Board of Commissioners to Consider Amendments to the Sullivan County Zoning Resolution as Amended

WHEREAS, TENNESSEE CODE ANNOTATED; SECTION _____, AUTHORIZES COUNTIES TO _____

NOW, THEREFORE BE IT RESOLVED by the Board of County Commissioners of Sullivan County, Tennessee, assembled in Regular Session on the 18th day of January 1999.

THAT WHEREAS, The attached rezoning petitions have been duly initiated, have been before the Planning Commission (recommendations enclosed), and have received a public hearing as required; and

WHEREAS, Such rezoning petitions will require an amendment to the Sullivan County Zoning Resolution;

NOW THEREFORE BE IT RESOLVED, That the Sullivan County Board of Commissioners consider the attached rezoning petitions and vote upon the proposed amendments, individually or otherwise at the discretion of the Commission, by roll call vote and that the vote be valid and binding and that any necessary amendments to the official zoning map be made so.

All resolutions in conflict herewith be and the same rescinded insofar as such conflict exist.

This resolution shall become effective on _____, 19__, the public welfare requiring it.

Duly passed and approved this 18 day of January, 1999

James F. Hammen Date: 1/18/99 _____ Date: _____
County Clerk County Executive

INTRODUCED BY COMMISSIONER Belcher ESTIMATED COST: _____

SECONDED BY COMMISSIONER Ferguson FUND: _____

Committee Action	Approved	Disapproved	Deferred	Date
Administrative				
Budget				
Executive				

Commission Action	Aye	Nay	Pass	Absent	Total
Roll Call					
Voice Vote	X				

COMMENTS: Motion made by Comm. Vance and seconded by Comm. Hyatt to approve. Approved 1/18/99 Voice Vote

PUBLIC NOTICE
SULLIVAN COUNTY BOARD OF COUNTY COMMISSIONERS

The Sullivan County Board of County Commissioners will hold a public hearing on Monday, January 18, 1999 at 9:00 A.M. in the Sullivan County Courthouse, Blountville, TN to consider the following requests:

- (1) Consider a request by Jessie Sampson to rezone a tract of land located in the 6th Civil District on the north side of Harritown Road approximately 800 feet east of its intersection with Lester Road from R-1 to R-2 to permit the location of a single-wide mobile home.
- (2) Consider a request by Robert and James and Edna Hart to rezone a tract of land located in the 9th Civil District on the south side of U.S. Hwy. 11-E approximately 800 feet south of its intersection with Taylor Road from A-1 to PBD to permit the location of future commercial development.
- (3) Consider a request by Arthur Roberts Jr. to rezone a tract of land located in the 8th Civil District on the north side of Buffalo Road at its intersection with Fairview School Road from R-1 to B-3 to permit the location of a convenience store.
- (4) Consider a request by Brad Carly to rezone a tract of land located in the 11th Civil District on the north side of Bloomingdale Pike approximately 400 feet west of its intersection with Sunny Lane from R-1 to B-3 to permit the location of general business.
- (5) Consider a request by R.K. Moore to rezone a tract of land located in the 10th Civil District on the west side of John B. Dennis at its intersection with Bloomingdale Pike from R-1 to PBD to permit the location of future commercial development.
- (6) Consider a request by Margaret Diggs to rezone a tract of land located in the 4th Civil District on the north side of Old Thomas Bridge Road approximately 1600 feet west of its intersection with U.S. 11-E from A-1 to B-3 to permit the location of a silk screening business.

The public is cordially invited to attend this public hearing and comment upon any rezoning request. For more information, please call 323-6440.

JAN. 18, 1999

[illegible]

SULLIVAN COUNTY BOARD OF COUNTY COMMISSIONERS

January 18, 1999

Consider the following:

- (1) **File # 10/98-4** A request by Jessie Sampson to rezone the property described below from R-1 to R-2:
Request Approved 1/18/99 Roll Call Vote 22 Aye, 2 Nay
 "Being a tract of land lying in the 6th Civil District on the north side of Harrtown Road approximately 800 feet east of its intersection with Lester Road and further described as the northwest corner of parcel 162.00 map 33 of the Sullivan County Tax Maps 100 feet in depth by 150 feet in length."

The Planning Commission took the following action:

" File No. 10/98-4, Jessie Sampson Request

Jessie Sampson requested that a tract of land located in the 6th Civil District on the north side of Harrtown Road approximately 800 feet east of its intersection with Lester Road be rezoned from R-1 to R-2 to permit the location of a single-wide mobile home.

Andrew Cole represented the applicant. No opposition was heard. Staff stated the request was incompatible with existing zoning and predominate land use patterns and recommended it be denied.

Motion Hickam, second H. Barnes to deny the request as recommended by staff. Vote in favor of the motion: Hickam, H. Barnes, Childress, Brown; opposed: Belcher, Boggs, S. Barnes, Mullins - vote tied 4 to 4, the motion failed due to the lack of a majority of vote of the quorum present.

Motion Boggs, second Belcher to approve the request due to the presence of existing mobile homes in the area, vote in favor of the motion: Boggs, Belcher, S. Barnes, Mullins, Hickam; opposed: H. Barnes, Brown, Childress; the motion carried 5 to 3.

- (2) **File # 12/98-1** A request by Robert and James and Edna Hart to rezone the property described below from A-1 to PBD:

WITHDRAWN 1/18/99

"Being a tract of land lying in the 9th Civil District on the south side of U.S. Hwy. 11-E approximately 800 feet south of its intersection with Taylor Road and further described as parcel 41 map 135 of the Sullivan County Tax Maps."

The Planning Commission took the following action:

" File No. 12/98-1, Robert and James and Edna Hart Request

Robert and James and Edna Hart requested that a tract of land located in the 9th Civil District on the south side of U.S. Hwy. 11-E approximately 800 feet south of its intersection with Taylor Road be rezoned from A-1 to PBD to permit the location of future commercial development.

Robert Hart, Joe Wilson, and Joe Parrott, Engineer spoke in support of the request and presented a proposed site plan. Mr. Hart contended that potential development would be beneficial to the county and would be compatible with existing development along US 11-E. John Patterson representing the Rocky Mount Historical site spoke in opposition to the request citing potential negative impact on the Rocky Mount site. Don Watson spoke stating that he represented 200 families present at the meeting or named in petitions presented to the commission, who were opposed to the Hart request. Mr. Watson stated the proposed zoning change was incompatible and intrusive in regard to existing residential development and would negatively impact residential property values and peace and quiet in the area as well as create increased dangerous traffic conditions. Planning Commissioners spoke S. Barnes pointed to potentially very dangerous traffic conflict points along US 11-E and Taylor Road that would be increased by the proposed zoning. Mullins and Brown stated that the proposed business development was well planned and Boggs stated that US 11-E should be developed for business. Planning staff stated that the proposed zoning did not conform to recommendations contained in the Land Use and Zoning Plan for the U. S. Highway 11-E corridor prepared by the planning commission and adopted by unanimous vote on August 18, 1998. Staff recommended the request be denied based on the August 18 plan proposals.

- 1 -

138 Lake Meadow Drive
Gray, TN. 37615
January 14, 1999

Mr. David Parker
Sullivan County Planning and Zoning
PO Box 509
Blountville, TN. 37617

Reference: Appeal to Sullivan County Commission for rezoning from A1 to
PBD, Parcel 41, Tax Map 26, District 9, Highway 11 E, property
owned by Robert, Edna Ruth and James Paul Hart.

Dear Sir:

In response to our request dated December 17, 1998, you notified us by
your letter dated December 17, 1998 that an appeal has been scheduled for
9:00 am January 18, 1999. We have now determined that we do not want to
appeal and request that the appeal be removed from the agenda of the
Commission Meeting.

We apologize for any inconvenience this has caused to your office and to
the County Commission.

Sincerely,

Robert C. Hart

James Paul Hart

Edna Ruth Hart

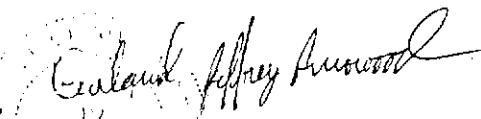
Commission Expires 7-29-2002

Motion Childress, second S. Barnes to deny the request based on comments of area opposition and staff recommendation. Vote in favor of the motion: Childress, S. Barnes, Hickam, H. Barnes, Greene, Belcher; opposed: Brown, Boggs, Mullins. The motion carried 6 to 3.

- (3) File # 12/98-2 A request by Arthur Roberts Jr. to rezone the property described below from R-1 to B-3: Motion made by Milhorn, 2nd by Houser to refer back to Planning Comm. Motion Approved 1/18/99 Voice Vote.
"Being a tract of land lying in the 8th Civil District on the north side of Buffalo Road at its intersection with Fairview School Road and further described as parcel 3.20 map96 of the Sullivan County Tax Maps."

The Planning Commission took the following action:

" File No. 12/98-2, Arthur Roberts Jr. Request

Arthur Roberts Jr. requested that a tract of land located in the 8th Civil District on the north side of Buffalo Road at its intersection with Fairview School Road be rezoned from R-1 to B-3 to permit the location of a convenience store.

The applicant was not present. Oden Crawford and other residents of the area spoke in opposition to the request stating that it would be incompatible and intrusive with existing residential development and contribute to increased dangerous traffic conditions. Staff stated the request was not compatible with existing land use and zoning patterns and recommended it be denied.

Motion Barnes, second Boggs to deny the request based on opposition statements and staff recommendation. Vote in favor of the motion unanimous.

- (4) File # 12/98-5 A request by Brad Carty to rezone the property described below from R-1 to B-3: Request Approved 1/18/99 Roll Call Vote 24 Aye.
"Being a tract of land lying in the 11th Civil District on the north side of Bloomingdale Pike approximately 400 feet west of its intersection with Sunny Lane and further described as parcels 3.00 and 4.00 groupA map31H of the Sullivan County Tax Maps."

The Planning Commission took the following action:

" File No. 12/98-5, Brad Carty Request

Brad Carty requested that a tract of land located in the 11th Civil District on the north side of Bloomingdale Pike approximately 400 feet west of its intersection with Sunny Lane be rezoned from R-1 to B-3 to permit the location of general business.

The applicant was present. No opposition was presented. Staff stated that there were potential septic system development problems and that the request was not compatible with predominate land use and zoning patterns on adjacent properties and recommended the request be denied.

Motion H. Barnes, second Boggs, to deny the request as recommended by staff. Vote in favor of the motion: H. Barnes, Boggs, Childress; opposed: Hickam, Brown, Mullins, Belcher, S. Barnes. The motion fails 3 to 5.

Motion Mullins, second S. Barnes, to approve the request based on existing B-3 zoning in the area. Vote in favor of the motion: Mullins, S. Barnes, Brown, Belcher, Hickam; opposed: Childress, Boggs, H. Barnes. The motion carried 5 to 3.

- (5) File # 12/98-9 A request by R.K. Moore to rezone the property described below from R-1 to PBD: Request Approved 1/18/99. Roll Call Vote 24 Aye.
"Being a tract of land lying in the 10th Civil District on the west side of John B. Dennis at its intersection with Bloomingdale Pike and further described as parcels 7 and 8 group E map 31H of the Sullivan County Tax Maps."

The Planning Commission took the following action:

" File No. 12/98-9, R.K. Moore Request

R.K. Moore requested that a tract of land located in the 10th Civil District on the west side of John B. Dennis at its intersection with Bloomingdale Pike be rezoned from R-1 to FBD to permit the location of future commercial development.

Rick Moore of Mitch Cox Development spoke in support of the request. No opposition was presented. Staff stated the request was compatible with existing land use patterns and recommended approval.

Motion Boggs, second Brown to approve the request as recommended by staff. Vote in favor of the motion: Boggs, Brown, Hickam, S. Barnes, H. Barnes, Childress, Mullins, opposed: none; abstain: Belcher. The motion carried 7 to 0 with 1 abstention.

(6) File # 12/98-10 A request by Margaret Diggs to rezone the property described below from A-1 to B-3:

Request approved 1/18/99 Roll Call Vote 24 Aye.

"Being a tract of land lying in the 4th Civil District on the north side of Old Thomas Bridge Road approximately 1600 feet west of its intersection with U.S.11-E and further described as the easterly portion of parcel 64 map 67 of the Sullivan County Tax Maps shown as lot 3 on a subdivision plat of the property."

The Planning Commission took the following action:

" File No. 12/98-10, Margaret Diggs Request

Margaret Diggs requested that a tract of land located in the 4th Civil District on the north side of Old Thomas Bridge Road approximately 1600 feet west of its intersection with U.S.11-E be rezoned from A-1 to B-3 to permit the location of a silk screening business.

Ron Ramsey was present representing Margaret Diggs. No opposition was presented. Staff stated the requested zoning was incompatible with surrounding residential development and zoning and recommended it be denied.

Motion H. Barnes, second Childress to approve the request based on existing use of the property. Vote in favor of the motion: H. Barnes, Childress, Hickam, S. Barnes, Brown, Boggs; opposed: Mullins, abstain: Belcher. The motion carried 6 to 1 with 1 abstention.

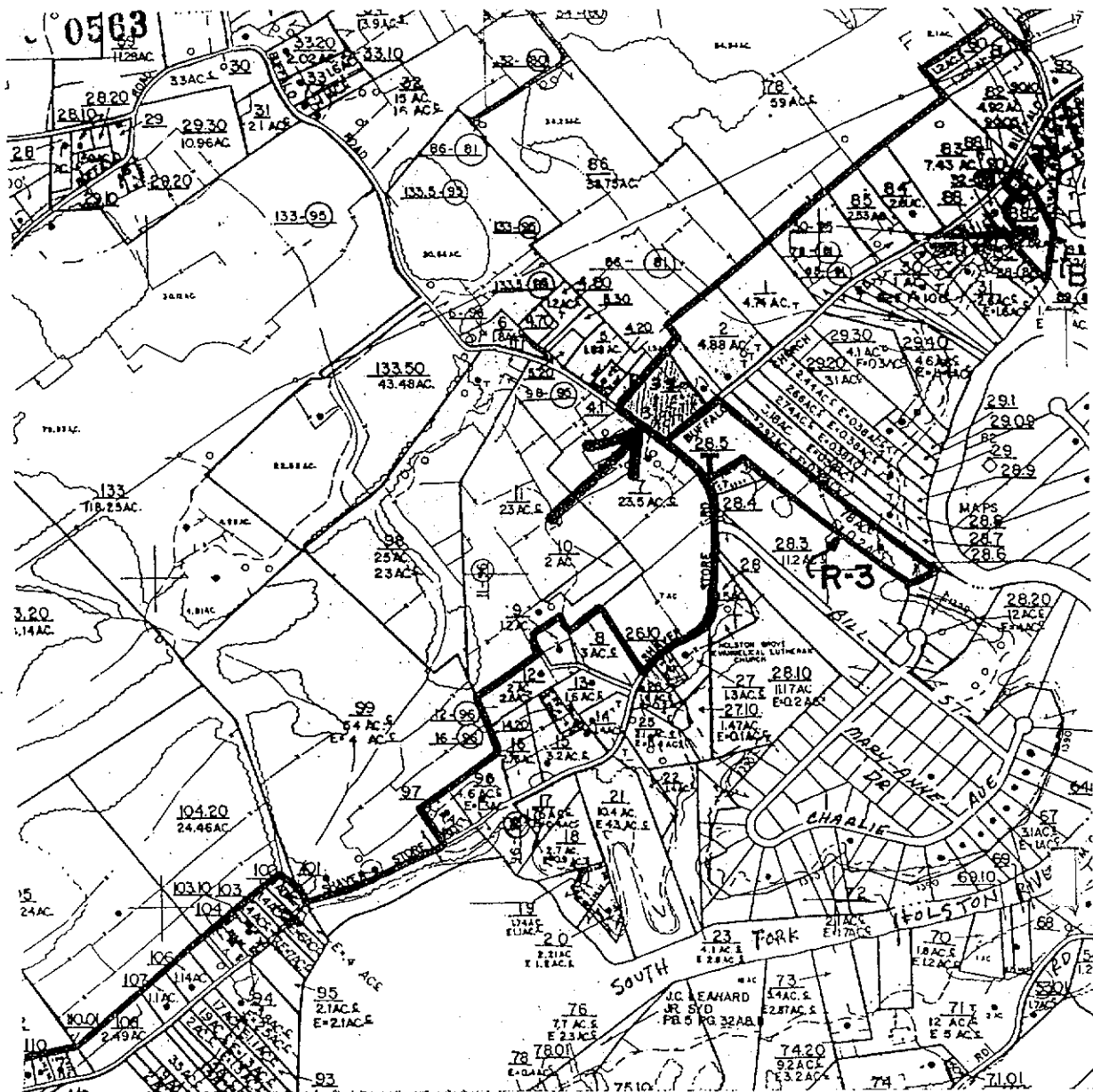

REZONING REQUEST
 Sullivan County, Tennessee
 From R-1 To B-3

1" = 800'
 Scale

Lot Size: 3.04 acre
 Civil District: 8



December 15, 1998

File # 12/98-2

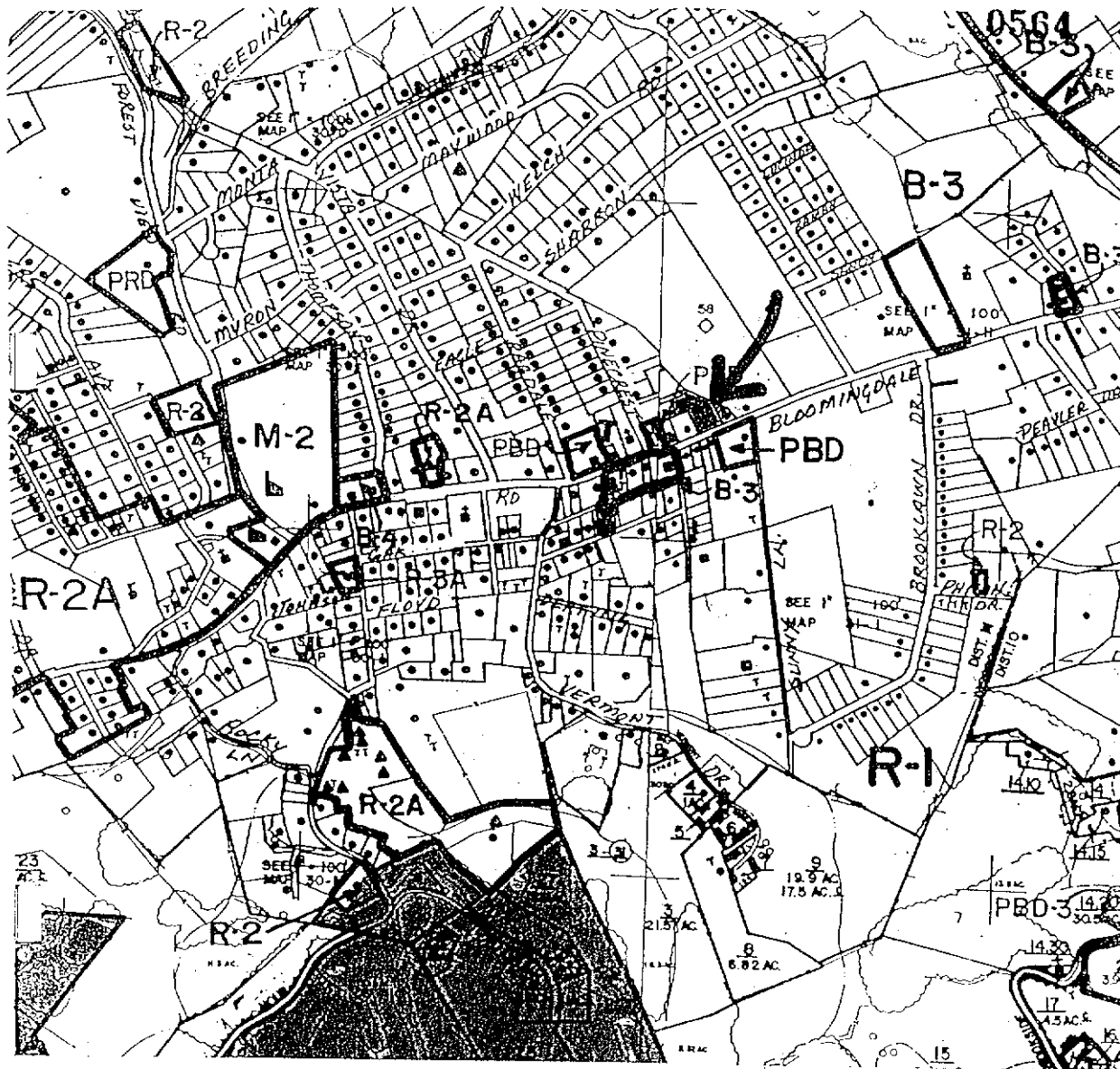

REZONING REQUEST Sullivan County, Tennessee From R-1 To B-3

1" = 800'
 Scale

Lot Size: 1 acre
 Civil District: 11



December 15, 1998

File # 12/98-5

0565

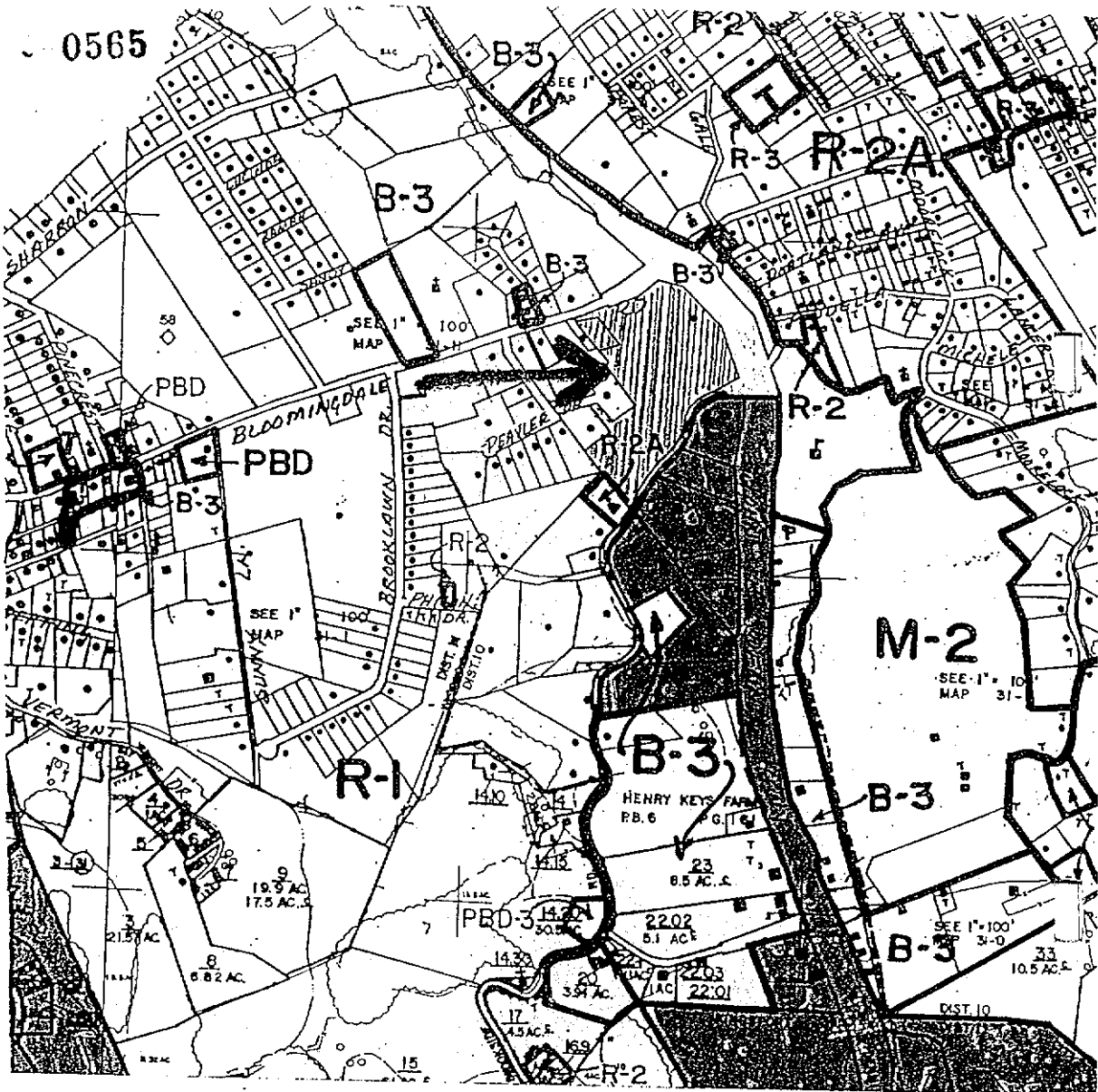

REZONING REQUEST
Sullivan County, Tennessee
From R-1 To PBD

1" = 800'
Scale

Lot Size: 12
Civil District: 10



December 15, 1998

File # 12/98-9

File # 12/98-10

TO THE HONORABLE GIL HODGES, COUNTY EXECUTIVE, AND THE MEMBERS OF THE SULLIVAN COUNTY BOARD OF COMMISSIONERS IN Regular SESSION THIS THE 21st DAY OF December 1998.

RESOLUTION AUTHORIZING Approval of the Sullivan County Road Atlas

WHEREAS, TENNESSEE CODE ANNOTATED; SECTION _____ AUTHORIZES COUNTIES TO _____

NOW, THEREFORE BE IT RESOLVED by the Board of County Commissioners of Sullivan County, Tennessee, assembled in Regular Session on the 21st day of December 1998.

THAT WHEREAS. The following is a summary of roads which were added to or deleted from the Sullivan County Road Atlas:

FROM 12-1-97 TO 11-30-98

ROAD ADDITIONS

DATE	SUBDIVISION AND ROAD	C.D.	TAXMAP	LENGTH	R.O.W.	CLASS	P.B. & Pg
Mar-98	KENWOOD SUBDIVISION						
	KENWOOD COURT	6	18	0.09	40	1	48-82
Jul-98	HIGHLAND MEADOWS SUBDIVISION						
	DALE VIEW DRIVE (1400')	6	17,18	0.27	50	1	49-62
	WOODS EDGE DRIVE (750')	6	17,18	0.14	50	1	49-62
	HIGHLAND MEADOWS DRIVE (1630')	6	17,18	0.31	50	1	49-62
Jul-98	COUNTRY MEADOWS SUBDIVISION #2						
	MORSE DRIVE	21	68	0.31	50	1	6-262
	GRAY STREET	21	68	0.1	50	1	6-262
Jul-98	SPRINGFIELD ACRES SUBDIVISION						
	LINDA'S WAY	4	68	0.31	50	1	49-65
Jul-98	ALLISON TIMBERS SUBDIVISION SEC.2						
	ALLISON TIMBERS ROAD	20	123	0.27	50	1	49-67
	FOXDALE LANE	20	123	0.21	50	1	49-67
Oct-98	LAKES EDGE SUBDIVISION						
	LAKE VISTA CIRCLE	8	96	0.22	50-60	1	50-40
	RIDGEPOINT COURT	8	96	0.1	50-60	1	50-40
	LAKES EDGE DRIVE	8	96	0.08	50-60	1	50-40
Nov-98	ROYAL RIDGE SUBDIVISION						
	MILLARD LANE	5	66	0.09	40	1	50-51
Nov-98	Hunting Hill Rd.						
	distance listed incorrectly was 1.2 now 3.2	9	110	2.0	30-50	2	
	TOTAL			4.5			

11-30-98

ROADS TO DELETE

DATE	NAME	C.D.	TAXMAP	LENGTH	R.O.W.	CLASS	REASON
May-98	EARHART ROAD	4	67	0.3	30-50	3	CITY OF BRIST.
May-98	EXIDE DRIVE	4	67	1.37	80	1	CITY OF BRIST.
May-98	OLD THOMAS BRIDGE ROAD	4	67	0.33	15-50	2	CITY OF BRIST.
May-98	BRISTOL METALS ROAD	21	54	0.4	50	1	CITY OF BRIST.
May-98	RAYTHEON ROAD	21	54	1.15	30-60	1	CITY OF BRIST.
May-98	VANCE TANK ROAD	21	54	0.87	30-50	2	CITY OF BRIST.
May-98	MEADOW VIEW ROAD	5	19	1.68	30-50	2	CITY OF BRIST.
May-98	KINKEAD DRIVE	5	79	0.1	30-50	2	CITY OF BRIST.
May-98	WALNUT HILL ROAD	5	36	0.8	50	1	CITY OF BRIST.
May-98	STEELES ROAD	5	19	0.1	20-50	3	CITY OF BRIST.
May-98	OLD STAGE DRIVE	5	19	0.4	50	2	CITY OF BRIST.
May-98	MEADOW STREET	5	20	0.1	20-50	3	CITY OF BRIST.
May-98	WHITETOP ROAD	4	82	0.79	40	2	CITY OF BRIST.
May-98	SWEET KNOBS TRAIL	4	67-68	0.5	50	1	CITY OF BRIST.
May-98	WHITETOP EXTENSION	4	82	0.05	50	2	CITY OF BRIST.
May-98	OLD BETHEL DRIVE	4	67	0.15	40	1	CITY OF BRIST.
Jul-98	DIANA AVENUE	13	75	0.02	40	1	CITY OF KPT.
Aug-98	LEBANON ROAD	14	92	0.09	40-50	1	CITY OF KPT.
Feb-98	MORELAND DRIVE	13	75	0.47	100+	1	CITY OF KPT.
	SCOTT DRIVE	13	91	0.15	25-50	2	CITY OF KPT.
Aug-98	WENDOVER DRIVE	14	92	0.05	40	2	CITY OF KPT.
Nov-98	WENDOVER DRIVE	14	92	0.03	40	2	CITY OF KPT.
	TOTAL			9.9			

RESOLUTION No. 176
Page Two

NOW, THEREFORE BE IT RESOLVED, That the Sullivan County Board of Commissioners approves the Sullivan County Road Atlas as revised December 1, 1998, a copy of which is attached hereto.

All resolutions in conflict herewith be and the same rescinded insofar as such conflict exist.

This resolution shall become effective on _____, 19__ the public welfare requiring it.

Duly passed and approved this 18 day of January, 1999

Attested: J. Hammond Date: 1-18-99 _____ Date: _____
County Executive

INTRODUCED BY COMMISSIONER McConnell ESTIMATED COST: _____
SECONDED BY COMMISSIONER Blalock FUND: _____

Committee Action	Approved	Disapproved	Deferred	Date
Administrative				
Budget				
Executive				

Commission Action	Aye	Nay	Pass	Absent	Total
Roll Call	24				
Voice Vote					

COMMENTS: FIRST READING 12/21/98 APPROVED 01/18/99 ROLL CALL VOTE

ROAD ATLAS
of
SULLIVAN COUNTY, TENNESSEE

Revised 12/01/98
Resolution No. 17

12/11/98

COUNTY ATLAS

ROAD NAME	MAP#	SECT.	C.D.	LENGTH	R.O.W.	CL
A						
ABBEY ROAD	106	6	14	0.05	50	1
ACORN CIRCLE	124	7	9	0.03	40-50	1
ACORN COURT	111	7	16	0.05	40	1
ADAIR AVENUE	12	4	12	0.15	30-50	3
ADAIR COURT	106	6	14	0.05	40	2
ADALINE STREET	14	4	10	0.4	50	3
ADAMS ACRES DRIVE	49	4	5	0.1	40	3
ADAMS CHAPEL ROAD	65	7	1	1.3	5	1
ADAMS ROAD	64	7	5	1.5	20-50	4
ADAMS STREET	49	4	5	0.15	50	1
ADRIAN DRIVE	48	6	7	0.23	50	1
AKARD LANE	17	4	6	0.75	30-50	1
AKARD PLACE	36	7	5	0.05	30-50	3
AKARD STREET	36	4	5	0.05	40	2
ALABAMA STREET	31	4	10	0.4	30-50	2
ALCOA DRIVE	31	4	10	0.4	40	2
ALDEN STREET	49	4	7	0.1	50	1
ALDERS PLACE	36	7	5	0.2	50	1
ALDERS PLACE EXTENSION	36	7	5	0.2	50	2
ALEX LANE	52	7	5	0.3	30-50	3
ALHAMBRA DRIVE	36	7	5	0.15	50	1
ALLGOOD ROAD	29	4	12	0.05	40	3
ALLISON COURT	123	7	20	0.28	50	2
ALLISON COVE TRAIL	123	7	20	0.49	50	2
ALLISON ROAD (collector)	124	7	20	4.05	60	1
ALLISON TIMBERS ROAD	123	7	20	0.38	50	2
ALMAROAD LANE	66	7	5	0.1	12-50	3
ALMAROAD ROAD	66	7	5	0.15	20-50	3
ALPINE	90	6	13	0.1	20-50	4
ALTAMONT DRIVE	92	6	14	0.17	50	2
ALVIN STREET	31	4	10	0.25	30-50	2
AMBROSIA DRIVE	118	6	15	0.25	50	2
AMELIA COURT	63	6	7	0.07	50	2
AMES STREET	76	6	13	0.1	20-50	3
AMHURST LANE	19	4	5	0.2	50	1
AMITY DRIVE	36	7	5	0.45	50	1
ANCO DRIVE	76	6	13	0.28	30-50	2
ANCO PLACE	76	6	13	0.35	40	2
ANDERSON LANE	17	4	6	0.12	40	3
ANDERSON ROAD	66	7	5	0.14	25-50	3
ANDERSON STREET	51	4	5	0.25	50	1
ANDREW STREET	14	4	10	0.15	20-50	3
ANDY COLE ROAD	98	7	16	0.4	20-50	4
ANN STREET	68	5	4	0.25	50	1
ANNGEA LANE	30	4	11	0.1	50	1
ANSLEY STREET	76	6	13	0.07	40	2
APACHE DRIVE	49	4	7	0.35	50	1
APPLEBERRY CIRCLE	106	6	14	0.06	40	2

0571

12/11/98

COUNTY ATLAS

ROAD NAME	MAP#	SECT.	C.D.	LENGTH	R.O.W.	CL
APPLE RIDGE DRIVE	67	7	4	0.21	50	1
APPLE TREE	97	5	16	0.02	25-50	4
AQUEDUCT COURT E.	118	6	15	0.03	40	2
AQUEDUCT COURT W.	118	6	15	0.03	40	2
ARAPAHO DRIVE	49	4	7	0.03	50	1
ARCADIA DRIVE	15	4	10	1.5	30-40	1
ARCH HICKS ROAD	109	7	8	0.5	20-50	4
ARCH STREET	54	5	21	0.05	50	1
ARCHCREST STREET	48	4	10	0.25	30-50	2
ARCHDALE DRIVE	121	6	14	0.35	50	1
ARGONNE STREET	91	6	13	0.21	50	4
ARLEY STREET	48	4	7	0.05	40	2
ARLINGTON CIRCLE	106	6	14	0.28	40	1
ARLINGTON COURT	106	6	14	0.07	40	1
ARLINGTON DRIVE	106	6	14	0.12	40	1
ARLINGTON PLACE	106	6	14	0.05	40	1
ARMSTRONG DRIVE	31	4	10	0.21	30-50	1
ARNOLD WAY	40	5	22	0.4	30-40	1
ARONDALE COURT	48	4	7	0.05	40	1
ARROW CIRCLE	105	6	13	0.05	50	2
ARROWOOD DRIVE	105	6	13	0.2	30-50	2
ASBURY STREET	14	4	10	0.3	30-50	1
ASCOT DRIVE	119	6	14	0.5	50	2
ASH LANE	82	7	4	0.05	40	1
ASPEN STREET	48	4	10	0.05	25-50	2
ASTOR STREET	48	4	10	0.2	30-50	2
ATLAS DRIVE	82	5	4	0.1	50	2
ATLEE STREET	14	4	10	0.1	40	1
AURORA ROAD	120	6	14	0.2	40	1
AUSTIN POWDER ROAD	65	7	5	0.5	20-50	2
AUSTIN SPRINGS RD(SA-8220)	135	7	9	2.85	60	1
AUTUNM KNOLL COURT	105	6	13	0.1	40	1
AVA DRIVE	92	6	14	0.28	50	1
AVONDALE ROAD	92	6	14	0.2	30-50	2
AYRSHIRE ROAD	36	4	5	0.1	50	1
AZTEC DRIVE	49	4	7	0.2	50	1
B						
B.F.B. ROAD	94	7	18	0.05	30-50	2
BACON ROAD	120	6	14	0.09	20-50	3
BAILEY ROAD	64	6	7	0.25	50	1
BAILEYTON ROAD (SA-8201)	117	6	15	0.4	50	1
BAINES AVENUE	31	4	10	0.25	30-50	3
BAINES DRIVE	40	5	22	0.05	20-50	3
BAINES ROAD	90	6	15	0.05	20-50	4
BAKER CEMETARY ROAD	16	4	6	0.1	30-50	3
BAKER DRIVE	51	4	5	0.08	30-50	3
BALL ROAD	36	7	5	0.1	40	2
BANCROFT CHAPEL ROAD	32	4	10	1.8	30-50	1
BANNER STREET	64	7	5	0.15	30-50	3
BARBARA DRIVE	108	7	18	0.1	30-50	2

ROAD NAME	MAP#	SECT.	C.D.	LENGTH	R.O.W.	CL
BARE HOLLOW ROAD	135	7	9	0.42	20-50	3
BAREFOOT LANDINGS DRIVE	94	7	18	0.24	50	2
BARGER DRIVE	50	4	6	0.1	30-50	3
BARGER HOLLOW RD. (SA-8233)	50	4	6	1.3	30-40	1
BARGER ROAD	50	4	6	0.6	30-50	2
BARNETT DRIVE	105	6	13	0.01	40	1
BARNETTE ROAD	112	5	16	1.01	20-50	3
BARR ROAD	50	4	6	1.5	30-50	2
BARRINGTON COURT	106	6	14	0.04	50	1
BASIN ROAD	100	5	3	0.06	30-50	3
BAYBERRY DRIVE	120	6	14	0.24	50	2
BAY HILL DRIVE	134	7	20	0.03	20-50	2
BAYS MOUNTAIN TRAIL	90	6	15	0.9	20-50	3
BAYWOOD DRIVE	134	7	20	0.75	30-50	2
BEALER ROAD	54	5	21	0.1	30-50	2
BEAR DRIVE	68	5	4	0.15	40	1
BEAR HOLLOW ROAD	39	5	2	0.6	20-50	3
BEAUMONT LANE	68	5	4	0.25	50	1
BEAVER CIRCLE	82	7	4	0.15	40	1
BEAVER CREEK RD (SA-8216)	82	7	4	2.5	30-60	2
BEAVER LANE	30	4	11	0.1	30-50	4
BEAVER ROAD	82	7	4	0.4	50	1
BECK DRIVE	108	7	20	0.3	30-50	3
BECKLEY DRIVE	36	4	5	0.1	50	1
BEECH FOREST ROAD	69	5	21	1	30-50	3
BEECHNUT CITY ROAD	34	4	6	0.4	30-50	3
BEECHWOOD CIRCLE	68	5	21	0.36	50	1
BEECHWOOD COURT	106	6	13	0.14	50	1
BEECHWOOD DRIVE	92	6	14	1.2	50	1
BEECHWOOD ROAD	107	6	14	1.2	30-50	2
BEELER STREET	36	4	5	0.05	30-50	3
BEGLEY STREET	94	7	18	0.11	50	1
BEIDLEMAN CREEK ROAD	55	5	1	2.1	40	2
BEIDLEMAN ROAD	70	5	1	0.03	20-50	4
BEL AIR LANE	106	6	14	0.08	50	2
BELDEN ROAD	30	4	11	0.25	40	2
BELL FLOWER COURT	119	6	14	0.04	40	2
BELL HOLLOW ROAD	104	6	15	0.8	30-40	2
BELL RIDGE DRIVE	29	4	12	0.45	40-50	2
BELL RIDGE ROAD	29	4	12	1.35	40-50	2
BELL STREET	94	7	18	0.59	50	1
BELL STREET EXTENSION	94	7	18	0.09	50	1
BELLE AVENUE	124	7	9	0.19	30-50	1
BELLE FOREST COURT	106	6	14	0.16	40	2
BELMONT COURT	104	6	15	0.08	50	1
BELSAY DRIVE	90	6	13	0.26	40	2
BELVEDERE LANE	92	6	14	0.23	30-50	2
BENNY MOWELL ROAD	102	6	15	0.3	20-50	3
BEN JENKINS ROAD (WASH. CO.)	121					
BENTLEY STREET	14	4	10	0.05	30-50	3
BERTSIE SHIPLEY ROAD	116	6	15	0.45	15-50	4

ROAD NAME	MAP#	SECT.	C.D.	LENGTH	R.O.W.	CL
BESSIE MORRISON ROAD	117	6	15	0.15	15-50	4
BETHANY STREET	13	4	12	0.03	40	4
BETHEL DRIVE (SA-8236)	67	7	4,5	2.85	30-60	2
BETHEL LANE	31	4	10	0.2	50	1
BEULAH CHURCH DRIVE	107	6	14	0.85	30-50	2
BEULAH CHURCH ROAD	107	7	18	1.7	30-50	2
BEULAH LAND DRIVE	82	5	16	0.29	50	1
BEULAH PARK DRIVE	107	6	14	0.35	40	2
BIG ARM BRANCH ROAD	126	7	16	1.3	15-50	3
BIG ARM ROAD	126	7	16	0.7	30-50	2
BIG ECHO COURT	92	6	14	0.07	50	1
BIG HOLLOW ROAD	66	7	5,8	3.7	40	2
BIG RIDGE ROAD	103	6	15	2.48	30-50	2
BIG SPRINGS ROAD	84	5	3	2.9	30-50	2
BILL ROAD	96	7	8	0.42	50	1
BILL MOODY ROAD	50	4	5	0.2	30-50	3
BIRCH STREET	66	7	5	0.25	50	1
BISHOP ROAD	118	6	15	0.5	20-50	3
BLACKBURN AVENUE	14	4	10	0.3	40	2
BLACKBURN CIRCLE	19	4	5	0.2	40	2
BLACKBURN DRIVE	19	4	5	0.55	40	2
BLACKBURN ROAD	66	7	5	0.2	40	1
BLACKFOOT DRIVE	49	4	7	0.1	50	1
BLAIR GAP ROAD	102	6	15	1.05	40-50	1
BLAKLEY DRIVE	105	6	13	1.13	40-50	1
BLALOCK ROAD	134	7	9	0.25	40	3
BLANCH'S VIEW DRIVE	82	5	16	0.09	50	1
BLARNEY PLACE	63	6	7	0.1	40	1
BLARNEY ROAD	63	6	7	0.1	40	1
BLOOMINGDALE RD. (SA-8229)	46	4	10,11	9.5	40-60	1
BLOUNTVILLE BY-PASS	51	4	5	0.5	50	1
BLOUNTVILLE CEMETARY ROAD	65	4	5	0.2	30-50	3
BLUE HAVEN DRIVE	92	6	14	0.44	50	1
BLUE HERON LANE	122	7	20	0.05	30-50	2
BLUEGRASS DRIVE	90	6	15	0.2	50	1
BLUFF ROAD	33	4	6,7	1.65	30-50	3
BLYTHEWOOD DRIVE	48	6	7	0.05	40	2
BOB DYKES ROAD	116	6	15	0.15	15-50	4
BOB JOBE ROAD (WASH. CO.)	120					
BOBBY DRIVE	30	4	11	0.2	50	1
BOND TOWN ROAD	79	7	18	1.05	50	1
BONNIE DRIVE	51	4	5	0.2	30-50	3
BOOHER DRIVE	54	5	1,21	1.7	40	2
BOOHER LANE	38	5	2	0.65	30-50	2
BOONE DAM ROAD	107	7	18	0.65	50	1
BOONE LAKE CIRCLE	96	7	4	0.15	50	1
BOONE RIDGE DRIVE	108	7	13	0.25	40	2
BOOTH COURT	121	6	14	0.1	50	1
BOOZY CREEK ROAD	33	4	6	1.55	30-50	1
BOSS ROAD	48	6	7	0.45	40	2
BOWLIN LANE	30	4	11	0.06	20-50	3

12/11/98

COUNTY ATLAS

ROAD NAME	MAP#	SECT.	C.D.	LENGTH	R.O.W.	CL
BOWMAN CREEK ROAD	79	7	7,18	0.85	30-50	2
BOWMAN FORD ROAD	135	7	9	0.35	30-50	2
BOXWOOD CIRCLE	107	6	14	0.08	30-50	4
BOXWOOD COURT	124	7	9	0.05	40	1
BOXWOOD LANE	33	4	6	0.1	50	1
BOYD ROAD	84	5	3	0.9	40	1
BRADFORD LANE	92	6	14	0.1	50	2
BRADFORD ROAD	134	7	20	0.05	40	2
BRAGG ROAD	103	6	15	0.3	20-50	4
BRANCH COURT	65	7	5	0.03	30-50	4
BRANCH LANE	1	5	19	0.49	30-50	4
BRANCH ROAD	118	6	15	1.4	40	1
BRASWELL-BAKER ROAD	36	4	5	0.15	50	3
BREEDING LANE	30	4	11	0.25	20-50	3
BRENTWOOD DRIVE	12	4	12	0.4	40	2
BRIARFIELD DRIVE	29	4	12	0.11	50	2
BRICKLEY STREET	31	4	10	0.05	30-50	3
BRIDWELL HEIGHTS ROAD	48	6	7	1.01	40-50	2
BRIGHTWOOD LANE	92	6	14	0.13	30-50	2
BRISCOE CIRCLE	54	5	21	0.1	40	2
BRISCOE CIRCLE EXTENSION	54	5	21	0.1	40	1
BRISTOL AVENUE	51	7	5	0.05	30-50	2
BRISTOL CAVERNS HWY (STATE)	38	5		0		
BRITTANY DRIVE	106	6	14	0.11	50	1
BROCKWAY DRIVE	92	6	13	0.16	50	1
BRONTE DRIVE	51	7	5	0.07	40	1
BROOKDALE DRIVE	124	7	9	0.31	50	1
BROOKFIELD DRIVE	107	6	14	0.75	30-50	2
BROOKFIELD LANE	107	6	14	0.25	30-50	2
BROOKLAWN DRIVE	31	4	11	0.4	50	1
BROOKLEA CIRCLE	82	7	4	0.1	50	1
BROOKSHIRE DRIVE	36	4	5	0.1	50	1
BROOKSIDE CIRCLE	47	4	11	0.25	40	2
BROOKSIDE DRIVE	31	4	10,11	1.5	40	2
BROOKSIDE LANE	82	5	4	0.2	40	1
BROOKSIDE SCHOOL LANE	31	4	10	0.19	40-50	2
BROOKVALEY DRIVE	48	4	7	0.04	50	2
BROOKWOOD COURT	63	6	7	0.12	50	2
BROWDER ROAD	78	6	7	0.3	30-50	1
BROWN CIRCLE	94	7	18	0.55	30-50	3
BROWN DRIVE	68	5	4	0.13	20-50	3
BROWN KITE ROAD	126	7	4	0.4	20-50	4
BROWN ROAD	137	7	16	0.2	16-50	4
BROWN STREET	68	5	4	0.65	40	1
BROWNLOW ROAD	31	4	10	0.3	50	2
BROYLES LANE	68	5	21	0.85	30-50	2
BROYLES ROAD	68	5	21	0.2	20-50	2
BRUCE DOAN ROAD	79	7	18	0.5	30-40	3
BRUMLEY STREET	12	4	12	0.03	40	2
BUCHANAN DRIVE	83	5	21	0.14	20-50	4
BUCHANAN LANE	113	5	3	0.8	20-50	3

ROAD NAME	MAP#	SECT.	C.D.	LENGTH	R.O.W.	CL
BUCHANAN ROAD	53	5	21	0.19	15-50	4
BUCHELEW DRIVE	106	6	14	0.67	50	1
BUCKLES DRIVE	61	6	13	0.15	40	2
BUENA VISTA DRIVE	64	4	7	0.1	40	1
BUFFALO ROAD (SA-8225)	81	7	8	1.51	30-50	2
BULLIS ROAD	107	7	18	0.15	20-50	3
BULLOCK HOLLOW ROAD (SA-8239)	54	5	3.21	5.1	40	2
BUNCOMBE ROAD	66	7	5	1.5	30-50	2
BUNKER HILL RD. (SA-8222)	125	7	16	2.2	60	1
BURDINE ROAD	123	7	20	0.35	50-60	3
BURLESON STREET	61	6	13	0.2	30-50	2
BURNING TRAIL	91	6	13	0.6	50	2
BURNSIDE DRIVE	92	6	14	0.05	40	2
BUTTERMILK ROAD	78	6	7	1.6	40-60	1
BUTTERMILK ROAD E.	78	6	7	0.2	20-50	1
BYRD STREET	14	4	10	0.03	30-50	3

C

CAGLE ROAD	111	7	16	0.1	20-50	4
CAIN DRIVE	63	6	7	0.5	50	1
CAIN STREET	14	4	10	0.25	50	2
CALUMET CIRCLE	118	6	15	0.04	40	2
CALUMET COURT	118	6	15	0.03	40	2
CAMBRIDGE CIRCLE	19	4	5	0.05	50	1
CAMBY DRIVE	91	6	13	0.24	50	2
CAMELOT DRIVE	54	5	21	0.7	50	1
CAMP PLACID ROAD	65	7	5	1.1	30-50	1
CAMP TOM HOWARD ROAD	58	5	19	0.4	30-50	3
CAMPBELL CROSS ROAD	81	7	5	0.1	15-50	4
CAN SELLS ROAD	108	7	20	0.4	18598	4
CANEY DRIVE	30	4	11	0.05	30-50	2
CANNON STREET	48	4	10	0.25	30-50	2
CANNONERO COURT	118	6	15	0.15	40	1
CANT HOOK HILL ROAD	54	5	21	0.7	20-50	3
CANTERBURY DRIVE	64	4	5	0.36	50	1
CANTON ROAD	107	6	14	0.75	40	2
CANYON TRAIL	91	6	13	0.02	50	4
CAPRI STREET	31	4	10	0.25	30-50	2
CARDEN HOLLOW RD. (SA-8236)	36	7	4.5	2.33	60	1
CARDINAL STREET	14	4	10	0.37	50	3
CARL DYKES ROAD	116	6	15	0.1	20-50	3
CARLTON LANE	124	7	9.16	0.85	30-50	2
CARLTON LANE EXTENSION	124	7	9	0.03	40	2
CARLTON ROAD	36	4	5	0.9	50	1
CARNEGIE COURT	105	6	13	0.03	40	1
CAROL HILL DRIVE	80	7	5	0.12	40	2
CAROL LANE	80	7	5	0.2	40	1
CAROL LANE EXTENSION	80	7	5	0.03	40	1
CAROLE STREET	30	4	11	0.05	30-50	2
CAROLINIA AVENUE	38	5	2	1.3	40	1
CARR DRIVE	51	4	5	0.3	40-50	1

12/11/98

COUNTY ATLAS

ROAD NAME	MAP#	SECT.	C.D.	LENGTH	R.O.W.	CL
CARR HOLLOW ROAD	125	7	16	0.45	30-50	4
CARRIAGE LANE	80	5	8	0.24	50	2
CARROL COURT	66	7	5	0.05	40	1
CARROLLWOOD DRIVE	31	4	10	0.12	50	2
CARROLLWOOD HEIGHTS ROAD	31	4	10	0.6	25-50	2
CARTER HILL ROAD	123	7	9,20	0.8	40	2
CARTERS VALLEY GARDEN	13	4	12	0.2	30-50	3
CASCADE STREET	48	4	10	0.1	30-50	2
CASH AVENUE	79	7	18	0.5	30-50	2
CASSIDY COURT	49	4	7	0.05	40	1
CASSIDY ROAD	49	4	7	0.4	40	1
CASTAWAY DRIVE	107	6	14	0.13	50	2
CASTLE OAKS DRIVE	92	6	14	0.12	50	2
CASTLETON COURT	104	6	15	0.02	40	2
CATAWBA LANE	64	6	7	1.45	40	3
CAVE HILL ROAD	81	7	5,8	1.1	30-50	2
CAVERN ROAD	39	5	1	1.4	30-50	1
CEDAR AVENUE	90	6	13	0.15	30-50	3
CEDARBROOK COURT	48	4	7	0.8	40	2
CEDAR BRANCH ROAD	63	6	7	1.85	30-40	2
CEDAR COURT	92	6	14	0.05	40	2
CEDAR CREST DRIVE	106	6	14	0.05	50	2
CEDAR DRIVE	104	6	15	0.13	30-50	2
CEDAR LANE	55	5	1	0.25	50	2
CEDAR ROAD	53	5	21	0.15	40	1
CEDAR STREET EXTENSION	97	7	16	0.03	25-50	4
CEDAR TREE	97	5	16	0.03	25-50	4
CEDARWOOD COURT	107	6	14	0.1	50	1
CEMETERY LANE	136	7	16	0.06	15-50	4
CEMETERY ROAD	81	7	4	0.3	20-50	3
CENTENARY ROAD (SPLIT)	93	7	4	3.2	20-40	3
CENTER DRIVE	108	7	18	0.6	40	2
CENTERBROOK CIRCLE	106	6	14	0.41	50	1
CENTERL HEIGHTS RD.(SA-8231)	34	4	6	1.8	30-50	1
CHADWELL ROAD	14	4	10	1.6	30-60	2
CHANDLER STREET	12	4	12	0.05	20-50	3
CHANEY DRIVE	15	4	10	0.11	40	2
CHAPEL DRIVE	12	4	12	0.2	30-50	2
CHARLIE AVENUE	96	7	8	0.63	50	1
CHARLIE JOHN CIRCLE	68	5	4	0.09	40	2
CHARLTON GREEN DRIVE	120	6	14	0.27	50	1
CHASE STREET	92	6	14	0.15	30-50	3
CHATEAUGAY ROAD	14	4	10	0.15	50	2
CHEEKWOOD DRIVE	14	4	10	0.3	50	2
CHELSEA CIRCLE	118	6	15	0.03	40	2
CHERRY COURT	35	4	6	0.1	20-50	3
CHERRY LANE	82	7	4	0.15	40	1
CHERRY ROAD	124	7	9	0.1	30-50	2
CHERRY STREET	51	7	5	0.2	50	1
CHERRYWOOD COURT	36	4	5	0.05	50	1
CHERT DRIVE	92	6	14	0.18	50	1

ROAD NAME	MAP#	SECT.	C.D.	LENGTH	R.O.W.	CL
CHESTERFIELD DRIVE	106	6	13	0.75	50	1
CHESTNUT RIDGE DRIVE	47	4	7	1.7	30-40	1
CHESTNUT STREET	51	7	5	0.05	50	1
CHEYENNE LANE	49	4	7	0.1	40	1
CHILDRESS FERRY ROAD	63	6	7	2.2	30-40	2
CHINQUAPIN GROVE (SA-8222)	126	7	16	4.75	60	1
CHIO WAY	92	6	13	0.1	40	2
CHIPPEWA LANE	48	4	7	0.15	50	1
CHRISTOPHER COURT	50	4	5	0.12	50	2
CHRISTUS DRIVE	83	5	16	0.16	50	1
CHRISTY DRIVE	104	6	15	0.1	50	2
CHUCKY AVENUE	30	4	11	0.09	50	1
CHURCH CIRCLE	21	5	2	0.15	15-50	4
CHURCH HILL DRIVE	104	6	15	0.45	50	2
CHURCH HILL ROAD	95	7	8	0.2	40	3
CHURCH LANE	31	4	11	0.15	40	2
CHURCH ROAD	118	6	15	2.01	30-50	2
CHURCH ROAD S.	118	6	15	0.75	30-50	2
CHURCH STREET	66	7	5	0.05	25-50	3
CHURCH VIEW DRIVE	105	6	13	0.44	40	1
CHURCH VIEW DRIVE EXTENSION	105	6	13	0.1	30-50	3
CIRCLE DRIVE	126	7	16	0.9	30-50	2
CIRCLE DRIVE N.	61	6	13	0.01	40	2
CIRCLE PLACE	31	4	10	0.02	50	3
CIRCLE ROAD	19	4	5	0.05	30-50	3
CIRCLE STREET	14	4	20	0.1	50	2
CITATION CIRCLE	104	6	15	0.16	40	1
CLAREMONT ROAD	30	4	11	0.45	30-40	2
CLARK CEMETERY ROAD	36	7	5	0.08	30-50	2
CLARK DRIVE	57	5	19	0.11	20-50	4
CLARK HILL ROAD	55	5	1	0.4	20-50	4
CLARK LANE	36	7	5	0.2	40	1
CLARK PLACE	51	4	5	0.3	40	2
CLARK ROAD	35	4	5	0.3	15-50	4
CLAYMORE DRIVE	106	6	14	0.49	50	1
CLAYTON STREET	91	6	13	0.08	50	1
CLEAR BRANCH CIRCLE	65	7	5	0.3	50	1
CLEAR BRANCH DRIVE	65	7	5	0.15	50	1
CLEARVIEW STREET	90	6	15	0.3	20-50	3
CLEEK ROAD	47	4	10	0.75	40	3
CLEVELAND ROAD (VA-665)	6					
CLIFFSIDE DRIVE	33	4	6	0.2	50	1
CLIFFVIEW DRIVE	92	6	14	0.25	30-50	2
CLIPSE ROAD	13	4	11	0.09	50	2
CLUB POINTE	81	7	8	0.1	50	1
CLOVER BOTTOM DRIVE	90	6	15	0.3	30-50	2
CLOVER LEAF COURT	48	6	7	0.04	40	1
COAL PIT HOLLOW LANE	117	6	15	0.5	20-50	4
COAL PIT HOLLOW ROAD	103	6	15	0.5	20-50	4
COCHISE TRAIL	49	4	7	0.9	50	1
COLD SPRINGS CHURCH ROAD	23	5	22	0.8	40	2

12/11/98

COUNTY ATLAS

ROAD NAME	MAP#	SECT.	C.D.	LENGTH	R.O.W.	CL
COLD SPRINGS ROAD	33	4	6	0.85	50	1
COLE HOLLOW ROAD	16	4	6	1.85	30-50	2
COLE LIGHT ROAD	117	6	15	0.16	15-50	4
COLE ROAD	33	4	6	0.1	20-50	3
COLEBROOK LANE	40	5	22	0.35	30-50	3
COLEY STREET	30	4	11	0.15	30-50	2
COLLEGE STREET	135	7	9	0.1	20-50	3
COLLINGWOOD DRIVE	19	4	5	0.55	50	1
COLLINS LANE	68	5	4	0.25	30-50	3
COLONIAL COURT	92	6	13	0.1	40	2
COLONIAL HEIGHTS RD. (SA-8209)	92	6	14	1.4	60	1
COLONIAL VIEW ROAD	106	6	14	0.23	40	1
COMBS ROAD	126	7	16	0.15	30-50	3
COMMANCHE DRIVE	49	4	7	0.2	50	1
COMMISSION DRIVE	30	4	11	0.05	50	2
CONCORD CIRCLE	19	4	5	0.1	50	1
CONCORD STREET	48	4	10	0.2	50	1
COOK HOLLOW ROAD	36	4	5	0.55	30-50	2
COOKS VALLEY ROAD	48	6	7	6.08	60	2
COPE ROAD	108	7	18	0.15	15-50	3
CORALWOOD COURT	106	6	14	0.05	40	2
CORALWOOD DRIVE	106	6	14	0.29	50	1
CORK LANE	63	6	7	0.05	40	1
CORY WAY	106	6	14	0.1	50	1
COTTONWOOD COURT	124	7	9	0.04	40	1
COTTONWOOD LANE	124	7	9	0.23	40	1
COUNTRY DRIVE	48	4	7	0.7	50	1
COUNTRY MEADOW CIRCLE	68	5	21	0.2	50	1
COUNTRYSHIRE COURT	106	6	14	0.57	50	1
COUNTY HILL ROAD	66	4	5	0.5	40	1
COUNTY HOME ROAD	51	4	5	1.1	30-50	1
COUNTY PARK ROAD (VA-663)	7					
COURTLAND DRIVE	106	6	14	0.05	40	1
COURTNEY DRIVE	63	6	7	0.12	50	1
COVE STREET	30	4	11	0.1	30-50	3
COX HOLLOW RD. (SA-8204)	105	6	13,14	2.1	60	1
COX MILL ROAD (VA-670)	8					
CRABAPPLE LANE	106	6	14	0.13	50	1
CRANSHAW DRIVE	75	6	13	0.2	40	2
CRANSHAW DRIVE EXTENSION	75	6	13	0.05	20-50	3
CRAWFORD LANE	79	7	18	0.3	20-50	3
CRAWFORD ROAD	116	6	15	0.1	15-50	4
CREE STREET	48	4	7	0.2	50	1
CREEK DRIVE	116	6	15	0.45	20-50	3
CREEKMORE DRIVE	90	6	15	0.1	30-50	2
CRESENT DRIVE	68	5	21	0.2	50	1
CRESTVIEW STREET	69	5	21	0.23	40	1
CROCKETT HILL ROAD	30	4	11	0.2	20-50	3
CROCKETT STREET	68	5	4	0.15	40	1
CROFTON DRIVE	54	5	21	0.13	50	1
CROSS ANCHOR PLACE	109	7	20	0.04	50	1

ROAD NAME	MAP#	SECT.	C.D.	LENGTH	R.O.W.	CL
CROSS COMMUNITY ROAD	35	4	5	2.15	30-50	3
CROSSWHITE ROAD	35	4	5	0.25	20-50	3
CROWE ROAD	84	5	1	0.05	20-50	4
CRUMLEY CEMETARY ROAD	99	5	3	0.18	15-50	4
CRUSSELL DRIVE	96	7	8	0.15	30-50	2
CRUSSELL ROAD	96	7	8	0.2	30-50	3
CRYSTAL SPRINGS ROAD	33	4	6	0.15	40	1
CRYSTAL VIEW STREET	14	4	10	0.25	30-50	2
CUNNINGHAM LANE	54	5	2	0.3	30-50	3
CURTIS COURT	48	6	7	0.23	50	1
CURTIS HOLLOW ROAD	135	7	9	0.25	20-50	4

D

D. DROKE ROAD	96	7	8,9	1.05	40	2
DAIL STREET	51	4	5	0.1	50	1
DAIRY CIRCLE	51	7	5	0.2	30-50	2
DAKOTA DRIVE	49	4	7	0.2	50	1
DALTON VIEW DRIVE	34	4	6	0.25	30-50	3
DALE VIEW DRIVE	17	4	6	0.27	50	
DANCY LANE	107	6	14	0.25	50	1
DARK HOLLOW ROAD (WASH. CO.)	132					
DARLINGTON DRIVE	30	4	11	0.3	50	1
DARNELL DRIVE	12	4	12	0.15	25-50	3
DART DRIVE	19	4	5	0.05	50	2
DARTMOUTH DRIVE	19	4	5	0.45	50	1
DARYL LANE	65	7	5	0.2	40	2
DE LEE DRIVE	92	6	14	0.52	50	1
DEADRICK DRIVE	92	6	14	0.2	50	2
DEAN ROAD	104	6	13	0.16	12-50	3
DECK LANE	108	7	18	0.4	30-50	3
DECK ROAD	19	4	6	0.1	30-50	3
DECK STREET	106	6	13	0.12	30-50	3
DECK VALLEY DRIVE	18	4	6	0.45	30-50	3
DECK VALLEY LANE	18	4	6	0.8	30-50	3
DECK VALLEY ROAD	18	4	6	1.5	30-50	3
DECK VALLEY ROAD TN-VA	19	4	6	0.3	30-50	3
DEER RIDGE COURT	106	6	14	0.04	40	2
DEERFIELD DRIVE	54	5	21	0.45	50	1
DEERLICK ROAD	108	7	20	1.75	30-50	2
DEERWOOD LANE	106	6	14	0.06	40	1
DEHAVEN PLACE	30	4	11	0.1	40	3
DELIVIA STREET	30	4	11	0.07	20-50	3
DENTONS LANE	9	5	19	0.3	15-50	4
DENTON ROAD	8	5	19	0.25	20-50	4
DENTON VALLEY ROAD	58	5	19	6.6	30-50	3
DENTONS VALLEY ROAD	1	5	19	1.4	20-50	3
DERBY DRIVE	104	6	15	0.51	50	1
DERTING STREET	30	4	11	0.15	30-50	1
DEVAVLT BRIDGE RD. (SA-8215)	109	7	8,20	4.2	60	1
DEVENS COURT	78	6	7	0.09	50	
DEVINE CIRCLE	105	6	13	0.1	40	1

12/11/98

COUNTY ATLAS

ROAD NAME	MAP#	SECT.	C.D.	LENGTH	R.O.W.	CL
DEWBERRY CIRCLE	106	6	14	0.06	40	3
DEXTER ROAD	13	4	11	0.15	50	3
DIANA AVENUE	75	6	13	0.11	40	1
DIANA CIRCLE	75	6	13	0.05	40	2
DIANA ROAD	75	6	13	0.2	40	1
DICKSON ROAD	14	4	10	0.1	40	2
DILLOW CIRCLE	121	6	14	0.2	22-50	3
DILLOW DRIVE	107	6	14	0.56	30-50	3
DINSMORE STREET	30	4	11	0.25	30-50	3
DISHNER ROAD	19	4	5	0.01	20-50	3
DIXON ALLEY	66	7	5	0.1	15-50	4
DOCK ROAD	56	5	1	0.03	15-30	4
DOE ROAD	67	7	4	0.05	40	1
DOGWOOD DRIVE	92	6	14	0.6	30-50	2
DOGWOOD DRIVE (WASH. CO.)	131					
DOGWOOD LANE	79	7	18	0.1	50	1
DOGWOOD TRAIL	124	7	9	0.33	50	1
DONNA PLACE	14	4	10	0.03	40	3
DONNIE CRAWFORD ROAD	103	6	15	0.1	12-50	4
DORAN HOLLOW ROAD	93	7	18	0.95	20-50	3
DOUBLE SPRINGS ROAD	119	6	14	0.8	10-50	1
DOUBLE SPRINGS ROAD (WASH. CO.)	131					
DOVER LANE	19	4	5	0.2	50	1
DOWNES COURT	118	6	15	0.03	40	2
DRAKE ROAD	9	5	19	0.25	30-50	2
DROKE LANE	16	4	6	0.95	40	1
DROKE ROAD (VA-673)	8					
DRUID HILLS	106	6	14	0.3	50	2
DRY BRANCH ROAD (STATE-44)	97	7		0		
DUBLIN ROAD	63	6	7	0.3	50	1
DULANEY ROAD	36	7	5	0.02	30-50	2
DUMFRIES ROAD	36	4	5	0.2	50	1
DUNCAN LANE	55	5	1	0.04	15-50	3
DUNLAP RD. (SA-8211)	94	7	18	3.05	30-50	2
DUNWOODY COURT	63	6	7	0.09	50	3
DUTCHESS DRIVE	106	6	14	0.13	40	1
DYKES ROAD	117	6	15	0.2	15-50	3

E

EAST CARTERS VALLEY ROAD	12	4	12	0.7	40-60	2
E.M. CROSS ROAD	96	7	8	0.05	30-50	4
EADS ROAD	110	7	16	0.2	20-50	3
EAGLE STREET	30	4	11	0.15	50	1
EASLEY DRIVE	91	6	13	0.38	50	3
EASLEY ROAD	90	6	13	0.2	20-50	1
EAST CAMPGROUND ROAD	119	6	14,15	1.01	30-50	2
EAST CENTRAL	36	4	5	0.3	40-50	1
EASTBROOK DRIVE	92	6	13	0.41	50	2
EASTERN STAR RD. (SA-8207)	120	6	14	1.01	40-50	1
EASTLAND DRIVE	105	6	13	0.23	50	1
EASTLAND PLACE	105	6	13	0.07	50	1

ROAD NAME	MAP#	SECT.	C.D.	LENGTH	R.O.W.	CL
EASTWOOD DRIVE	68	5	4	0.15	40	1
EASY STREET	105	6	13	0.26	50	2
EATON ROAD	51	7	8	0.37	30	4
EATON STATION ROAD	48	4	7	0.23	30-50	2
EAUCLAIR STREET	48	6	7	0.45	50	1
ECHO LANE	82	5	4	0.04	20-50	3
ECHO LANE EXTENSION	82	5	4	0.04	20-50	3
EDENS VIEW ROAD	48	4	7	0.56	40-50	2
EDGEFIELD ROAD	140	7	9	1.6	40	2
EDGEWOOD CIRCLE	106	6	14	0.05	40	2
EDISON STREET	12	4	12	0.1	30-50	3
EDITH ROAD	48	6	7	0.1	20-50	3
EDMOND CIRCLE	92	6	14	0.03	40	2
EDWARDS LANE	33	4	6	0.19	14-50	4
EGYPT ROAD	97	7	4,16	3.7	30-50	2
ELIE ROAD	98	5	16	0.2	12-50	4
ELIZABETHTON HWY. (SA-8243,8247)	111	7	16	3.2	40-50	1
ELLA DRIVE	50	4	5	0.15	40	2
ELLEN STREET	48	6	7	0.25	30-50	2
ELLIS ROAD	65	7	5	0.7	30-50	2
ELM LANE	82	7	4	0.35	40	1
ELMHURST DRIVE	92	6	14	0.45	50	2
EMERALD DRIVE	48	6	7	0.1	40	1
EMERSON STREET	30	4	11	0.07	30-50	3
EMMETT RD. (SA-8240,8241)	55	5	1	2.9	30-60	2
EMMETT WAY	55	5	1	0.53	30-50	3
EMORY CHURCH ROAD	63	6	7	1.65	50	1
EMORY LANE	14	4	10	0.2	30-50	3
ENTERPRISE RD. (SA-8216)	96	7	8,20	4.65	30-60	1
EPPS ROAD	12	4	12	0.14	30-50	3
ERIC COURT	63	6	7	0.06	40	1
ERNIE DRIVE	14	4	10	0.2	50	1
ERWAY COURT	78	6	7	0.17	50	3
ESSEX DRIVE	82	7	4	0.6	50	1
ESTEP ROAD	126	7	16	0.2	20-50	3
ESTERVILLE ROAD	15	4	10	0.65	30-50	2
ETHEL BEARD ROAD	81	7	8	1.3	30-50	2
ETHEL DRIVE	47	4	7	0.1	30-50	3
EUCLID ROAD	30	4	11	0.05	50	1
EVERGREEN DRIVE	33	4	6	0.3	30-50	1
EVERGREEN ROAD	92	6	14	0.13	30-50	3
EXETER LANE	65	7	5	0.15	50	2
EXIDE DRIVE (SA-8235)	67	7	4	0.13	80	1

F

FAIN DRIVE (SA-8213)	94	7	8	0.55	30-50	3
FAIN ROAD	51	4	5	0.4	30-50	1
FAIRBANKS STREET	31	4	10	0.3	50	2
FAIRFAX ROAD	14	4	10	0.2	30-50	2
FAIRFORD LANE	51	7	5	0.3	50	1
FAIRHAVEN DRIVE	66	7	4	0.17	50	1

12/11/98

COUNTY ATLAS

ROAD NAME	MAP#	SECT.	C.D.	LENGTH	R.O.W.	CL
FAIRHAVEN LANE	99	5	3	0.1	15-50	4
FAIRHILL ROAD	48	4	10	0.1	50	1
FAIRLANE DRIVE	92	6	14	0.05	40	2
FAIRLAWN DRIVE	92	6	14	0.22	50	2
FAIRVIEW SCHOOL ROAD	80	7	8	2.43	30-50	2
FAIRWAY DRIVE	66	7	4	0.45	50	1
FAIRWAY EST. DRIVE	81	7	4	0.3	50	1
FAIRWOOD DRIVE	54	5	2	0.1	50	1
FAIRWOOD STREET	30	4	11	0.07	40	2
FALL CREEK RD. (SA-8209)	48	6	7	4.4	60	1
FARRAGUT ROAD	54	5	21	0.11	50	1
FARRIS ROAD	30	4	11	0.1	30-50	2
FAULK LINE	31	4	10	0.2	50	2
FEDDERSON STREET EXTENSION	31	4	10	0.09	30-50	3
FEDDERSON STREET	31	4	10	0.5	50	2
FERNCLIFF DRIVE	14	4	10	0.15	50	1
FERNWOOD DRIVE	92	6	14	0.33	50	2
FERRY ROAD	77	6	14	0.07	40	3
FIELDCREST ROAD	64	6	7	3.3	30-50	2
FIELDPOND DRIVE	63	6	7	0.05	40	2
FIELDSTONE DRIVE	63	6	7	0.35	50	1
FIFTH STREET	36	4	5	0.35	25-50	2
FILLERS ROAD	110	7	20	0.2	20-50	4
FIRST AVENUE	53	5	21	0.2	50	2
FISHER DRIVE	48	4	7	0.1	20-50	3
FLANDERS STREET	12	4	12	0.19	30-50	3
FLANARY STREET	13	4	12	0.12	20-50	3
FLAT CREEK LANE	79	7	18	0.16	40	1
FLATWOODS ROAD	84	5	1	2.3	40-50	1
FLEENOR DRIVE	64	4	9	0.1	30-50	2
FLEMING ROAD	14	4	10	0.25	40	2
FLETCHER AVENUE	12	4	12	0.01	40	1
FLORENCE DRIVE	65	4	5	0.15	50	1
FLOYD HOLLOW ROAD	135	7	9	0.2	20-50	3
FLOYD STREET	30	4	11	0.08	50	2
FOGLEMAN DRIVE	34	4	6	0.2	30-50	3
FONDULAC DRIVE	106	6	14	0.22	50	1
FONTANA STREET	31	4	10	0.25	30-50	2
FOOTHILLS DRIVE	51	7	5	0.07	50	1
FOOTHILLS ROAD	92	6	14	0.78	50-60	1
FORD AVENUE	92	6	14	0.15	50	1
FORD CREEK ROAD (WASH. CO.)	120					
FORD ROAD	78	7	18	0.23	20-50	3
FORDTOWN ROAD	106	6	14	3.92	40-60	1
FOREGO COURT	104	6	15	0.02	40	3
FOREST CIRCLE	30	4	11	0.03	40	1
FOREST EDGE COURT	92	6	14	0.1	40	2
FOREST HILLS DRIVE	92	6	14	0.4	50	2
FOREST VIEW DRIVE	30	4	11	1.01	30-50	2
FOREST VIEW ROAD	30	4	11	1.55	60	1
FORRESTER ROAD	124	7	9	0.13	16-50	3

ROAD NAME	MAP#	SECT.	C.D.	LENGTH	R.O.W.	CL
FOX CHASE DRIVE	78	6	7	0.16	50	2
FOX HOLLOW LANE	136	7	9	0.85	30-50	3
FOX HOLLOW ROAD	125	7	16	0.25	30-50	3
FOX PATH COURT	106	6	14	0.08	50	1
FOXCROFT DRIVE	49	4	7	0.06	50	1
FOXDALE LANE	123		20	0.21	50	
FOXFIRE LANE	48	4	7	0.4	50	1
FOXFIRE PLACE	48	4	7	0.6	50	1
FOXFIRE TRAIL	48	4	7	0.35	50	1
FOXPORT ROAD	119	6	13	0.18	50	1
FOXWOOD LANE	63	6	7	0.05	40	1
FRADY ROAD	48	6	7	0.15	20-50	3
FRANKLIN DRIVE	66	7	5	0.6	40-50	1
FREDRICK STREET	14	4	10	0.15	30-50	3
FREEMAN DRIVE	12	4	12	0.03	30-50	3
FREEMAN ROAD	78	6	7	1.9	40-50	1
FREEMONT DRIVE	92	6	14	0.12	50	2
FREEWILL DRIVE	31	4	10	0.05	40	2
FRIENDSHIP DRIVE	41	5	19	0.42	40	3
FRIENDSHIP ROAD	41	5	19	1.2	20-60	3
FRITZ HOLLOW ROAD	99	5	3	0.5	15-50	4
FRONTIER DRIVE	63	6	7	0.18	50	1

G

G.B. HALL ROAD	106	6	14	0.21	20-50	4
GAINES STREET	48	4	10	0.2	30-50	2
GALE AVENUE	31	4	10	0.25	30-50	3
GALE LANE	13	4	11	0.15	50	3
GALEMONT DRIVE	90	6	13	0.4	40	2
GALLOWAY ROAD	91	6	13	0.28	20-50	3
GALLOWAY STREET	12	4	12	0.1	30-50	2
GAMMON ROAD	108	7	18	0.7	40	2
GARDEN GROVE DRIVE	51	4	5	0.15	40	2
GARFIELD DRIVE	48	4	10	0.2	25-50	2
GARLAND AVENUE	90	6	15	0.1	30-50	2
GARLAND STREET	30	4	11	0.2	30-50	2
GARMON DRIVE	106	6	14	0.07	40	2
GARWOOD DRIVE	107	6	14	0.05	50	3
GATEWOOD DRIVE	121	6	14	0.05	50	1
GEISLER ROAD	122	7	20	1.2	30-50	2
GENTRY COURT	67	7	4	0.04	40	1
GEORGE CARR ROAD	81	7	5	0.2	30-50	4
GIBBS ROAD	30	4	11	0.1	40	2
GIFFORD ROAD	53	5	21	0.15	30-50	3
GLADEMILL DRIVE	106	6	14	0.12	50	2
GLASGOW LANE	63	6	7	0.15	50	2
GLEASON STREET	12	4	12	0.05	30-50	3
GLEN ALPINE ROAD	90	6	13,15	1.13	40-60	1
GLENBURN ROAD	90	6	12	0.3	40	2
GLENCLIFF DRIVE	106	6	14	0.24	50	1
GLEN HAVEN DRIVE	82	5	16	0.35	50	1

12/11/98

COUNTY ATLAS

ROAD NAME	MAP#	SECT.	C.D.	LENGTH	R.O.W.	CL
GLENDOR DRIVE	68	5	4	0.02	50	2
GLENDORA DRIVE	121	6	14	0.2	50	1
GLENMONT COURT	90	6	15	0.11	40	2
GOLD DUST DRIVE	51	4	5	0.05	50	1
GOLDIE CRAWFORD ROAD	117	6	15	0.1	21-50	4
GOLF PARK DRIVE	78	6	7	0.01	50	1
GOOD VIEW DRIVE	31	4	10	0.35	30-50	3
GOODMAN CEMETERY ROAD	108	7	20	0.2	30-50	3
GOODS DRIVE	93	7	18	0.2	30-50	3
GOTTLAND SHOALS ROAD	93	7	18	2.01	30-60	3
GOVERNMENT ROAD	9	5	19	1.55	30-50	3
GRACE STREET	38	5	2	0.3	40	2
GRADY LIGHT ROAD	116	6	15	0.08	15-50	4
GRAGG LANE	75	6	13	0.1	20-50	3
GRANDOR LANE	69	5	21	0.13	40	1
GRANDOR STREET	54	5	21	0.4	50	1
GRANDVIEW CIRCLE	31	4	10	0.3	50	2
GRANDVIEW COURT	63	6	7	0.25	50	1
GRANDVIEW DRIVE	31	4	10	0.3	50	2
GRANT PLACE	76	6	13	0.15	40	1
GRASSLAND COURT	63	6	7	0.15	50	1
GRAVEL TOP ROAD	49	4	5	0.25	40	2
GRAVELY ROAD (SA-8228)	30	4	11,12	2.27	40-60	1
GRAVEYARD ROAD	70	5	1	0.2	15-50	3
GRAY ROAD	53	5	21	0.3	15-50	4
GRAY STATION ROAD (WASH.CO.)	121					
GRAY STREET	68	5	21	0.1	50	
GRAYBEAL ROAD	97	7	16	0.3	20-50	4
GREEN COURT	107	7	18	0.07	40	2
GREEN DRIVE	66	7	8	0.15	40	2
GREEN HILL DRIVE	38	5	2	0.1	50	1
GREEN HILLS DRIVE	92	6	14	0.3	50	2
GREEN LAKE DRIVE	92	6	14	0.25	40	2
GREEN LANE	79	7	18	0.1	50	1
GREEN MEADOW DRIVE	92	6	14	0.22	50	2
GREEN ROAD	70	5	1	0.1	20-50	3
GREEN SPRINGS ROAD	69	5	21	0.05	30-50	2
GREEN SPRINGS ROAD (VA-75)	7					
GREENBRIAR ROAD	92	6	14	0.02	30-50	4
GREENGATE ROAD	92	6	14	0.4	50	1
GREENLEAF DRIVE	92	6	13	0.15	50	2
GREENLEAF ROAD	66	7	4	0.12	50	1
GREENTREE DRIVE	49	4	5	0.33	50	1
GREENWAY ROAD	66	7	5	0.07	50	3
GREENWOOD DRIVE	126	5	16	0.1	15-50	4
GREENWOOD LANE	92	6	14	0.12	35-50	2
GREGORY ROAD	12	4	12	0.2	30-50	2
GREY FOX DRIVE	48	4	7	0.3	50	1
GREYBIL HOLLOW ROAD	99	5	3	0.5	15-50	4
GREYSTONE DRIVE	81	7	8	0.2	30-50	3
GRIMES CIRCLE	106	6	14	0.05	40	1

ROAD NAME	MAP#	SECT.	C.D.	LENGTH	R.O.W.	CL
GROSS ROAD	111	7	16	0.5	20-50	4
GROVE DRIVE	92	6	14	0.3	40	1
GUM SPRINGS ROAD	117	6	15	1.23	40	2
GUNNINGS AVENUE	64	7	5	0.2	30-50	3
GUSTAVIS AVENUE	119	6	13	0.38	50	2
GUSTAVIS COURT	105	6	13	0.05	40	2

H

HAGA ROAD	76	6	13	0.3	30-50	1
HALL CIRCLE	107	6	14	0.2	30-50	3
HALL ROAD	121	6	14	0.5	30-50	2
HALO DRIVE	48	6	7	0.05	30-50	3
HAMILTON DRIVE	108	7	18	0.6	50	2
HAMILTON HILL ROAD	82	7	4	1.05	30-50	2
HAMILTON LANE	82	5	4	0.3	20-50	4
HAMILTON PLACE	92	6	14	0.15	20-50	2
HAMILTON ROAD	108	7	18	3.05	20-50	2
HAMILTON TRAIL	123	7	20	1.65	30-50	2
HAMILTON WAY	92	6	14	0.1	30-50	2
HAMMER ROAD	66	7	5	0.1	50	1
HAPPY HILL ROAD	76	6	13	0.68	30-50	2
HARBOR COURT	96	7	8	0.04	40	1
HARBOR SPRINGS ROAD	62	6	7	0.1	30-50	3
HARDING ROAD	106	6	14	0.17	50	2
HARKLEROAD ROAD	97	7	16	0.15	20-50	2
HARKLEROAD STREET	14	4	10	0.3	50	1
HAROLD HILL ROAD	75	6	13	0.05	30-50	3
HARR DRIVE	35	4	5	0.1	20-50	3
HARR LANE	34	4	6	0.4	20-50	3
HARR ROAD	25	5	19	0.2	30-50	3
HARR TOWN ROAD (SA-8232)	49	4	6,7	3.7	40-60	2
HARR TRAIL ROAD	34	4	6	1.15	30-50	2
HARRINGTON HOLLOW ROAD	83	5	3	1.1	20-50	2
HARRISON AVENUE	12	4	12	0.65	20-50	1
HASH HOLLOW ROAD	12	4	12	0.25	30-50	3
HASKEL MILHORN ROAD	108	7	20	0.3	14-50	3
HASKEL WHITAKER ROAD	95	7	8	0.3	20-50	3
HAVEN DRIVE	92	6	14	0.3	40	2
HAVENETTE COURT	92	6	14	0.11	40	3
HAW RIDGE DOCK ROAD	108	7	20	0.25	30-50	3
HAW RIDGE ROAD	109	7	20	2.15	30-50	2
HAW RIDGE ROAD E.	108	7	20	0.01	20-50	3
HAWK STREET	94	7	18	0.27	50	1
HAWKINS LANE	107	7	18	0.1	50	3
HAWLEY ROAD	65	7	5,18	2.7	40	2
HAWLEY ROAD W.	79	7	18	0.35	30-50	3
HAYES LANE	84	5	3	0.05	20-50	4
HAYES ROAD	84	5	3	0.55	20-30	3
HAYES ROAD EXTENSION	84	5	3	0.19	30-50	3
HAYES STREET	30	4	11	0.1	50	1
HAYNES DRIVE	12	4	12	0.15	30-50	3

12/11/98

COUNTY ATLAS

ROAD NAME	MAP#	SECT.	C.D.	LENGTH	R.O.W.	CL
HAYWOOD DRIVE	30	4	11	0.2	50	2
HEATH ROAD	111	7	16	0.3	20-50	3
HEATHER GLEN DRIVE	119	6	14	0.21	40-50	2
HEATHERVIEW COURT	106	6	14	0.15	40	1
HEATHERWOOD LANE	121	6	14	0.1	50	1
HEDGE DRIVE	14	4	10	0.85	30-50	2
HEDGEROW COURT	119	6	14	0.18	50	2
HELMSDALE DRIVE	64	4	7	0.06	50	1
HEMLOCK COURT	124	7	9	0.06	40	1
HEMLOCK DRIVE	77	6	14	0.15	40	2
HEMLOCK PARK DRIVE	77	6	14	0.1	20-50	3
HEMLOCK PARK PLACE	77	6	14	0.14	30-50	3
HEMLOCK ROAD (SA-8208,8209)	92	6	14	1.55	40	2
HENDRICKSON ROAD	81	7	8	0.1	20-50	3
HENRY HARR ROAD	64	6	7	1.5	40-50	2
HENRY LANE	121	6	14,18	0.3	30-50	3
HENRY ROAD	95	7	8	0.17	30-50	4
HENSEN AVENUE	124	7	9	0.16	40	1
HENSON HILL ROAD	70	5	1	0.5	30-50	3
HENSON LANE	55	5	1	0.2	20-50	3
HENSON ROAD	23	5	22	1.1	40	1
HERITAGE CIRCLE	54	5	21	0.06	50	1
HERRON DRIVE	107	7	18	0.3	50	1
HEYFORD DRIVE	51	4	5	0.25	50	1
HI DRIVE	106	6	14	0.08	40	1
HIALEAH DRIVE	104	6	15	0.03	50	1
HICKAM ORCHARD ROAD	15	4	10	0.2	20-50	3
HICKAM STREET	14	4	10	0.05	60	2
HICKMAN CHURCH ROAD	50	4	6	0.25	50	3
HICKMAN DRIVE	35	4	5	0.2	20-50	4
HICKMAN ROAD	95	7	8	0.25	30-50	3
HICKORY COURT	111	7	16	0.05	40	1
HICKORY HILL ROAD	97	5	16	0.2	40	2
HICKORY LANE	82	7	4	0.1	40	1
HICKS AVENUE	15	4	10	0.15	30-50	3
HICKS HILL ROAD	125	7	9	0.1	20-50	4
HICKS HOLLOW LANE	66	7	5	0.2	15-50	3
HICKS HOLLOW ROAD	32	4	10	0.4	30-50	3
HICKS LANE	15	4	10	0.3	20-50	3
HICKS ROAD	124	7	9	0.45	50	2
HIDDEN ACRES COURT	31	4	10	0.2	20-50	3
HIDDEN ACRES ROAD	119	6	13	1.19	60	1
HIDDEN PINES DRIVE	119	6	15	0.1	50	1
HIDDEN VALLEY ROAD	106	6	14	1.2	50	1
HIDEAWAY FARM ROAD	109	7	20	1.01	30-50	2
HIGH CIRCLE	68	5	4	0.35	50	2
HIGH OAK ROAD	68	5	4	0.03	50	2
HIGH STREET	135	7	9	0.15	50	1
HIGHFIELD ROAD	19	4	5	0.2	30-50	2
HIGHLAND DRIVE	66	7	5	0.1	40	2
HIGHLAND MEADOWS DRIVE	17	4	6	0.31	50	

ROAD NAME	MAP#	SECT.	C.D.	LENGTH	R.O.W.	CL
HIGHLEA DRIVE	92	6	14	0.09	50	2
HIGHRIDGE DRIVE	33	4	7	1.35	30	2
HIGHRIDGE STREET	36	7	5	0.35	50	1
HILL COUNTRY TRAIL	19	4	5	0.2	50	1
HILL DRIVE	68	5	21	0.1	50	1
HILL LANE	33	4	6	0.05	30-50	2
HILL ROAD	49	4	7	1.01	50	1
HILL TOP CIRCLE	68	5	4	0.16	50	1
HILLANDALE DRIVE	92	6	14	0.3	50	1
HILLARD ROAD	39	5	2	0.02	20-50	4
HILLSBORO DRIVE	36	4	5	0.15	50	1
HILLSBORO ROAD	66	7	5	0.5	50	1
HILLTOP DRIVE	66	7	4	0.05	50	1
HILLTOP ROAD	34	4	6	0.05	30-50	3
HILLVIEW ROAD	119	6	13	0.14	50	2
HILLVIEW STREET	68	5	21	0.05	50	1
HILLVUE DRIVE	106	6	4	0.1	50	1
HILTON HILL ROAD	93	7	18	0.55	50	2
HILTON STREET	92	6	13	0.1	30-50	3
HINES ROAD	34	4	6	0.25	30-50	2
HINKLE DRIVE	70	5	1	0.15	15-50	4
HINKLE ROAD	75	6	13	0.2	16-50	3
HISTORIC HILLS ROAD	91	6	13	0.18	40	2
HOBART STREET	48	4	7	0.15	50	1
HOBBS HOLLOW ROAD	34	4	6	1.3	30-50	2
HOBBS STREET	48	6	7	0.09	40	1
HOLCOMB STREET	31	4	10	0.45	30-50	3
HOLDEN DRIVE	107	6	14	0.2	20-50	3
HOLIDAY HILLS ROAD	48	6	7	0.25	50	1
HOLLAND DRIVE	92	6	2	0.1	40	2
HOLLY POINT	124	7	9	0.05	40	1
HOLLYDALE DRIVE	121	6	14	0.15	50	1
HOLSTON DRIVE	79	7	18	2.01	30-50	3
HOLSTON INDUSTRIAL DRIVE	79	7	18	0.16	50	1
HOLSTON INSTITUTE DRIVE	65	7	5	0.35	30-50	2
HOLSTON VALLEY GOLF CRS ROAD	38	5	2	0.17	20-50	3
HOLSTON VIEW DAM ROAD	55	5	1	2.85	40	2
HOLSTON VIEW TRAIL	40	5	22	0.25	20	4
HOMESTEAD DRIVE	92	6	13	0.31	50	1
HONEYCUT DRIVE	104	6	15	0.2	15-50	4
HONEYSUCKLE DRIVE	106	6	14	0.15	20-50	3
HONEYSUCKLE LANE	90	6	15	0.1	30-50	2
HONEYSUCKLE PLACE	106	6	14	0.2	20-50	3
HOOD ROAD	75	6	13	0.8	30-50	2
HOOD ROAD W.	75	6	13	0.4	40	2
HOOKE ROAD	17	4	6	1.5	30-50	2
HOOT OWL HOLLOW ROAD	55	5	1	0.2	20-50	4
HOOVEN STREET	48	4	10	0.25	30-50	4
HOPKINS ROAD	96	7	8	0.35	20-50	3
HOPKINS STREET	63	4	7	0.1	50	1
HORIZON DRIVE	8					

12/11/98

COUNTY ATLAS

ROAD NAME	MAP#	SECT.	C.D.	LENGTH	R.O.W.	CL
HORSESHOE BEND	118	6	15	0.23	40	1
HORSESHOE DRIVE	106	6	14	0.33	20-50	3
HORTON DRIVE	36	7	5	0.3	50	1
HORTON HWY (WASH. CO.)	130					
HOUSTON LANE	110	7	9	0.15	30-50	4
HOWARD CEMETERY ROAD	14	4	10	0.07	50	2
HUCKLEBERRY ROAD	97	7	16	0.5	50	1
HUDSON ROAD	123	7	9	0.1	20-50	3
HUFFMAN HILL ROAD	135	7	9	0.25	40	2
HUFFMAN ROAD	135	7	9	0.1	30-50	2
HUGHES DRIVE	90	6	15	0.17	50	1
HUGHES ROAD	124	7	9	0.25	20-50	3
HUMPHREYS ROAD	135	7	9	0.7	30-50	2
HUNTERS CROSSING LANE	105	6	13	0.35	50	1
HUNTERS TRAIL	34	4	6	0.35	30-50	3
HUNTING HILL ROAD	110	7	9	3.2	30-50	2
HURON CIRCLE	49	4	7	0.04	50	1
HUTCHINSON DRIVE	30	4	11	0.4	50	1
HYATT HOLLOW ROAD	124	7	9	0.15	20-50	4
HYDAWAY PLACE	49	4	7	0.05	30-50	3
HYDER AVENUE	13	4	11	0.05	50	2
HYDER HILL ROAD (SA-8219)	134	7	9	0.5	20-50	3
I						
I-81 N	51	4		0		
I-81 S	19	4		0		
IDLE HOUR ROAD	30	4	11	0.38	40	1
IDLEWILD DRIVE	90	6	15	0.2	30-50	2
IMPALA DRIVE	30	4	11	0.15	30-50	2
IMPERIAL CIRCLE	30	4	11	0.03	40	1
IMPERIAL DRIVE	120	6	14	0.12	40	1
INCA LANE	64	4	1	0.1	50	1
INDEPENDENCE DRIVE	30	4	11	0.7	30-50	2
INDEPENDENCE DRIVE E.	13	4	11	0.13	30-50	3
INDEPENDENCE DRIVE W.	13	4	11	0.13	30-50	3
INDIAN RIDGE DRIVE	30	4	11	0.1	50	1
INDIAN ROAD	109	7	20	0.18	40	2
INDUSTRIAL PARK ROAD	124	7	9	1.55	60	1
INTERMONT LANE	39	5	22	0.06	50	1
IROQUOIS LANE	49	4	7	0.05	50	1
ISAAC STREET	31	4	10	0.05	30-50	3
ISLAND COURT	97	5	16	0.2	40	2
ISLAND DRIVE	61	6	13	0.15	40	2
ISLAND LANE	35	4	5	0.05	30-50	3
ISLAND ROAD (SA-8233)	35	4	5	12.9	30-60	2
ISLAND ROAD N.E.	19	4	5	0.23	40	2
ISLEY DRIVE	78	7	7	0.65	30-50	1
ISLEY ROAD (SA-8233)	50	4	5	0.8	30-50	2
IVANHOE STREET	90	6	15	0.15	30-50	2
IVORY STREET	76	6	13	0.15	40	1
IVY DALE	121	6	14	0.05	50	1

ROAD NAME	MAP#	SECT.	C.D.	LENGTH	R.O.W.	CL
IVY DRIVE	92	6	14	0.25	30-50	2
J						
J.A. HODGE ROAD	134	7	20	0.7	30-50	2
J.H. FAUVER ROAD	34	4	6	1.3	30-50	1
JACKSON HOLLOW ROAD	107	6	14	1.5	30-50	2
JACOB CREEK ROAD	41	5	19	0.35	30-50	1
JADE COURT	48	4	7	0.05	40	1
JAMES COURT	45	7	20	0.03	40	1
JAMESTOWN DRIVE	46	7	20	0.27	50	1
JARED DRIVE (SA-8208)	61	6	13	0.62	40	1
JARRETT DRIVE	112	5	16	0.25	20-50	3
JAYNE ROAD	75	6	13	0.25	40	2
JEAN STREET	121	6	14	0.15	50	1
JENKINS HOLLOW ROAD	112	5	16	0.6	12-50	4
JENKINS ROAD	99	5	3	0.3	20-50	4
JETT ROAD	76	6	13	0.13	30-50	1
JOBE ROAD	98	5	3	0.14	20-50	4
JOHN PHILLIPS ROAD	103	6	15	0.11	20-50	4
JOHNNY CARRIER HOLLOW	84	5	3	0.38	30-50	3
JOHNSON CEMETERY ROAD	35	4	5	0.6	15-50	3
JOHNSON CHAPEL ROAD	19	4	6	0.85	30-50	1
JOHNSON HOLLOW ROAD	35	4	5	0.55	30-50	2
JONES CEMETERY ROAD	137	7	4	0.3	15-50	4
JONES HOLLOW ROAD	39	5	1	0.2	20-50	3
JONES LANE	125	7	16	0.15	20-50	4
JONES ROAD	7	5	22	0.23	20-50	3
JONESBORO DRIVE	111	7	16	0.45	30-50	3
JONESBORO ROAD	124	7	9	0.9	30-50	2
JULIP ROAD	106	6	14	0.15	50	1
JUNIPER CIRCLE	68	5	4	0.13	50	1
JUSTIN DRIVE	121	6	14	0.05	40	2

K

KALLEN DRIVE	13	4	11	0.45	50	2
KALUNA AVENUE	82	7	4	0.35	50	1
KANAN DRIVE	105	6	13	0.25	50	1
KATHERINE STREET	14	4	10	0.2	30-50	2
KATIE LANE	52	7	5	0.4	20-50	3
KAYLOR ROAD	126	5	16	0.1	20-50	3
KEENBURG ROAD	137	7	16	0.3	15-50	3
KEENELAND COURT	104	6	15	0.04	40	2
KEITH ROAD	19	4	5	0.2	40	2
KELLY LANE	48	4	7	0.3	30-50	3
KELSO COURT	104	6	15	0.07	40	2
KENDLEWORTH DRIVE	75	6	13	0.15	30-50	2
KENDRICKS CREEK RD. (SA-8204)	106	6	14	3.01	50-60	1
KENDRICK STREET	92	6	14	0.1	50	1
KENDRICKS HOLLOW ROAD	35	4	5	0.55	10-50	2
KENNEDY DRIVE	91	6	13	0.08	50	2
KENNERLY ADDITION ROAD	106	6	14	0.1	10-50	4

ROAD NAME	MAP#	SECT.	C.D.	LENGTH	R.O.W.	CL
KENNY STREET	51	7	5	0.05	30-50	2
KENWOOD COURT	18		6	0.09	40	
KENTFIELD DRIVE	30	4	11	0.15	50	1
KERRY COURT	30	4	11	0.03	50	2
KESTNER STREET	14	4	10	0.12	40	2
KESTNERS ROAD	24	5	22	0.1	20-50	4
KETRON DRIVE	31	4	10	0.2	50	2
KEYSTONE DRIVE	51	7	5	0.4	50	1
KILKENNY ROAD	49	4	7	0.4	50	1
KIM DRIVE	107	6	14	0.45	30-50	2
KIMBERLY DRIVE	92	6	14	0.06	40	2
KIMBERLY ROAD	105	6	13	0.5	40	1
KIMBERLY STREET	36	4	5	0.3	50	1
KINCAID STREET	30	4	11	0.55	30-50	2
KING LANE	23	5	22	0.72	30-50	3
KINGSBERRY COURT	106	6	14	0.06	40	3
KINGFISHER COURT	106	6	14	0.12	40	1
KINGS GRANT ROAD	91	6	13	0.09	50	2
KINGS RIDGE DRIVE	63	6	7	0.2	40	2
KINGS ROAD	124	7	9	0.31	50-70	1
KINGS VIEW ROAD	30	4	11	0.07	50	2
KINGSLEY AVENUE	31	4	10	0.6	30-50	2
KINGSPORT HWY (11-W)	20	4		0		
KINGSTON ROAD	66	7	4	0.26	50	1
KINZER LANE	13	4	11	0.1	30-50	2
KIOWA STREET	49	4	7	0.65	50	1
KISTNER ROAD	118	6	15	0.4	20-50	3
KITZMILLER ROAD	120	6	14	0.25	30-50	3
KITZMILLER ROAD (WASH. CO.)	120					
KNOB PARK ROAD	23	5	22	2.01	30-50	2
KNOBVIEW ROAD	51	4	5	0.25	50	1
KNOBVIEW ROAD EXTENSION	51	4	22	0.04	30-50	3
KNOTTSBURY LANE	64	7	5	0.1	40	2
KNOX POPE ROAD	103	6	15	0.5	20-50	4
KYTE ROAD	112	5	16	0.4	15-50	4
L						
L JONES ROAD	124	7	9	1.05	40	2
LAKE AIRE	107	6	14	0.2	40	1
LAKE BREEZE DRIVE	108	7	18	0.05	40	2
LAKE DRIVE	109	7	20	0.6	30-50	2
LAKE FOREST DRIVE	107	6	14	0.53	40-50	1
LAKE HOLLOW ROAD	95	7	8	0.2	50	1
LAKE PARK COURT	63	6	7	0.15	50	1
LAKE PARK DRIVE	63	6	7	0.3	50	1
LAKE POINT COURT	95	7	8	0.05	40	2
LAKE POINT DRIVE	140	7	20	1.38	30-50	2
LAKE ROAD (VA-664)	7					
LAKE VISTA CIRCLE	96	7	8	0.22	50	
LAKES EDGE DRIVE	96	7	8	0.08	50-60	
LAKECREST DRIVE	92	6	14	0.75	30-50	2

ROAD NAME	MAP#	SECT.	C.D.	LENGTH	R.O.W.	CL
LAKEFIELD CIRCLE	92	6	14	0.05	30-50	2
LAKEFRONT LANE	96	7	16	0.19	40	2
LAKENHEATH DRIVE	51	7	5	0.35	50	1
LAKERIDGE DRIVE	107	6	14	0.1	30-50	2
LAKERIDGE STREET	107	6	14	0.85	30-50	2
LAKESHORE DRIVE	106	6	14	0.37	50	1
LAKESHORE ROAD	96	7	4	0.7	50	1
LAKESIDE DOCK DRIVE	108	7	18	0.97	40	2
LAKESIDE LANE	92	6	14	0.2	40	2
LAKEVIEW CIRCLE	92	6	14	0.6	50	2
LAKEVIEW DOCK ROAD	55	5	1	2.4	20-50	3
LAKEVIEW DRIVE	97	7	16	0.55	40	2
LAKEVIEW STREET	81	7	8	0.05	20-50	3
LAKEWIND DRIVE N.	109	7	20	0.17	40	2
LAKEWIND DRIVE S.	109	7	20	0.16	40	2
LAKEWOOD DRIVE	106	6	14	0.16	40	1
LAMBERTH STREET	48	4	10	0.15	30-50	2
LANA VIEW DRIVE	48	4	7	0.15	50	2
LANCASTER DRIVE	106	6	14	0.28	50	1
LANCER ROAD	31	4	11	0.25	50	2
LONDON COURT	48	6	7	0.06	40	1
LANE HOLLOW ROAD	141	7	9	0.66	25-50	3
LANE ROAD	104	6	15	0.3	30-50	3
LARKINS STREET	54	5	21	0.2	50	1
LARKMEADOWS CIRCLE	83	5	21	0.15	50	1
LARKSPUR DRIVE	30	4	11	0.4	50	1
LATIMER STREET	30	4	11	0.15	30-50	2
LATTURE LANE	17	4	6	0.8	30-50	1
LAURA LAND	57	5	19	0.12	20-50	4
LAUREL COURT	124	7	9	0.06	40	1
LAUREL DRIVE	36	4	5	0.1	50	2
LAWSON DRIVE	34	4	6	0.4	40	2
LAZY ACRES	53	5	21	0.2	30-50	1
LAZY LANE	92	6	14	0.23	50	2
LAZY LANE (WASH. CO.)	131					
LEANING PINE ROAD	90	6	15	0.17	50	2
LEBANON ROAD (SA-8209)	92	6	14	3.14	40-50	1
LEELAND DRIVE	30	4	11	0.5	30-50	2
LEHIGH STREET	48	4	10	0.07	30-50	2
LEMAY DRIVE	48	6	7	0.12	50	1
LENOIR ROAD	31	4	10	0.65	40	2
LEONARD LANE	50	4	5	0.35	30-50	1
LEONARD ROAD	52	7	4	0.13	15-50	3
LESLIE COURT	106	6	14	0.1	40	1
LESTER ROAD	33	4	6	0.3	30-50	2
LEWIS ROAD	83	5	16	0.29	20-50	3
LEWIS STREET	67	7	4	0.1	50	2
LIBERTY CHURCH ROAD	121	6	14	0.5	40	2
LIGHT CEMETERY ROAD	116	6	15	0.2	20-50	4
LIGHT HOLLOW ROAD	116	6	15	1.4	30-50	1
LIGHT STREET	92	6	14	0.3	30-50	2

12/11/98

COUNTY ATLAS

ROAD NAME	MAP#	SECT.	C.D.	LENGTH	R.O.W.	CL
LIGHT STREET EXTENSION	92	6	14	0.1	25-50	3
LIGHTWOOD STREET	14	4	10	0.5	50	3
LINCOLNSHIRE CIRCLE	119	6	14	0.11	50	3
LINDA COURT	48	6	7	0.06	40	1
LINDA'S WAY	68		4	0.31	50	
LINDENWOOD DRIVE	92	6	13	0.13	50	1
LINDKAYE DRIVE	92	6	14	0.09	50	2
LINK ROAD	36	7	5	0.1	30-50	2
LINK ROAD (WASH. CO.)	131					
LISA LANE	124	7	9	0.52	40-50	1
LITTLE ECHO ROAD	92	6	14	0.05	50	1
LITTLE OAK ROAD (FOREST SERVICE)	72	5		0		
LITTLE VALLEY ROAD	90	6	13	0.45	30-50	4
LITTLETON ROAD	117	6	15	0.25	20-50	3
LIVE OAK DRIVE	30	4	11	0.1	40	1
LOCHRIDGE BEND	47	6	14	0.19	40-50	1
LOCKPOINT CIRCLE	91	6	13	0.04	50	1
LOCUST HILL LANE	54	5	21	0.08	40	1
LOCUST STREET	48	4	10	0.05	30-50	3
LOLA MERE DRIVE	15	4	10	0.11	40	3
LONE OAK DRIVE	92	6	14	0.25	30-50	3
LONE OAK LANE	36	4	5	0.1	25-50	3
LONE STAR RD. (STATE-347)	103	6		0		
LONESOME PINE ROAD	48	4	7	0.5	50	1
LONEWOOD DRIVE	107	6	14	0.3	50	1
LONG HOLLOW ROAD	90	6	13	1.01	30-50	2
LONG STREET	12	4	12	0.15	30-50	3
LONGVIEW DRIVE	68	5	21	0.15	50	1
LOOKOUT DRIVE	106	6	14	0.12	40	1
LORI'S LANE	123	7	20	0.28	50	2
LOUDERMILK DRIVE	55	5	1	0.12	30-50	3
LOUISE LANE	65	4	5	0.5	50	1
LOWE ROAD	110	7	9	0.15	30-50	4
LOWRANCE DRIVE	31	4	10	0.46	50	2
LUCERNE LANE	107	6	14	0.05	50	1
LUCINDA ROAD	31	4	11	0.07	50	1
LUCY PLACE	14	4	10	0.15	40-50	2
LUCY ROAD	14	4	10	0.85	50	2
LUKE McKAMEY ROAD	123	7	20	0.3	20-50	3
LYNCH ROAD	29	4	12	1.3	30-50	2
LYNN ROAD	63	6	7	1.6	40	2
LYNNWOOD COURT	48	4	7	0.05	40	1
LYONS ROAD	126	7	16	0.4	15-50	4

M

M. ROAD	30	4	11	0.15	20-50	3
MACK COURT	92	6	13	0.04	40	2
MAGIC VIEW DRIVE	30	4	11	0.45	30-50	2
MAGNOLIA COURT	124	7	9	0.1	40	1
MAHLON DRIVE	92	6	14	0.2	50	2
MAIN STREET (SA-8220)	135	7	9	0.35	40	1

ROAD NAME	MAP#	SECT.	C.D.	LENGTH	R.O.W.	CL
MALONE ROAD	136	7	9	0.1	20-50	4
MANCHESTER PLACE	106	6	14	0.11	40	1
MANDAN ROAD	48	4	7	0.2	50	1
MAPLE DRIVE	36	7	5	0.15	30-50	2
MAPLE LANE	51	7	5	0.05	50	1
MAPLE STREET (SA-8213)	94	7	18	0.25	30-50	2
MAPLEHURST LANE (SA-8226)	82	7	4	0.4	50	1
MAPLEVIEW DRIVE	51	7	5	0.12	25-50	3
MAPLEWOOD STREET	90	6	15	0.2	30-50	2
MARBLE STREET	90	6	13	0.02	40	4
MARCUM AVENUE	29	4	12	0.05	20-50	4
MARCUS STREET	121	6	14	0.05	25-50	3
MARCUS STREET E.	121	6	14	0.05	25-50	3
MARIETTA STREET	31	4	10	0.2	40	2
MARION STREET	30	4	11	0.07	30-50	3
MARKET STREET (SA-8232)	33	4	6	0.7	30-50	1
MARLENE DRIVE	38	5	2	0.2	40	2
MARY JANE ROAD	103	6	15	0.3	25-50	3
MASENGILL ROAD (SA-8234)	51	4	5	2.2	30-50	2
MASSENGILL AVENUE	51	4	5	0.1	30-50	3
MASSENGILL PARK ROAD	96	7	8	0.55	30-50	2
MASSENGILL PLACE	125	7	16	0.15	50	2
MAYFAIR ROAD	106	6	14	0.08	50	2
MAYFIELD AVENUE	12	4	12	0.45	40-50	2
MAYFIELD DRIVE	68	5	21	0.18	50	1
MAYWOOD DRIVE	30	4	11	0.25	50	1
McCLAIN ROAD	15	4	10	0.74	40	1
McCONNELL STREET	32	4	10	0.1	30-50	3
McCREARY AVENUE	14	4	10	0.05	50	3
McCULLEY LANE	91	6	13	0.2	30-50	2
McCULLEY PLACE	91	6	13	1.85	30-50	2
McFARLAND DRIVE	48	4	10	0.17	30-50	2
McGREGOR DRIVE	30	4	11	0.35	40	2
McINTOSH DRIVE	106	6	14	0.35	50	1
McKAMEY STREET	135	7	9	0.2	20-50	4
McKEE ROAD	123	7	9	0.5	30-50	3
McKENZIE DRIVE	29	4	12	0.02	30-50	2
McKINNEY DRIVE	76	6	13	0.2	30-50	2
McKINNEY STREET	76	6	13	0.22	30-50	2
McLANEY ROAD	136	7	9	0.35	30-50	4
McLEAN DRIVE	12	4	12	0.1	40	2
McMURRAY ROAD	33	4	7	0.2	20-50	3
McNEIL STREET	12	4	12	0.15	30-50	3
McTEER DRIVE	92	6	14	0.25	50	2
MEADE TRAIL	92	6	14	0.2	30-50	2
MEADOW BROOK DRIVE	106	6	14	0.21	50	1
MEADOW BROOK LANE	33	4	6	0.15	50	1
MEADOW CREEK RD. (SA-8240)	55	5	1	0.7	30-60	2
MEADOW CREST DRIVE	106	6	14	0.05	40	1
MEADOW DALE CIRCLE	106	6	14	0.05	40	1
MEADOW DRIVE	68	5	21	0.1	50	1

12/11/98

COUNTY ATLAS

ROAD NAME	MAP#	SECT.	C.D.	LENGTH	R.O.W.	CL
MEADOW GLADE CIRCLE	106	6	14	0.05	60	1
MEADOW GLEN CIRCLE	106	6	14	0.03	40	1
MEADOW GLEN DRIVE	19	4	5	0.11	50	1
MEADOW LANE	106	6	14	1.65	50	1
MEADOW LANE EXTENSION	92	6	14	0.02	40	3
MEADOW LARK LANE	67	7	11	0.1	40	1
MEADOW VIEW ROAD	19	4	5	0.37	30-50	2
MEGAN COURT	78	6	7	0.1	40	3
MELLWOOD DRIVE	30	4	11	0.05	50	2
MELODY LANE (WASH. CO.)	131					
MELROSE	91	6	13	0.13	20-50	3
MEMORIAL BLVD. (STATE-126)	48	6		0		
MERMAN ROAD	106	6	14	1.01	50	1
MERRY ANNE DRIVE	96	7	8	0.15	50	1
MERRY OAKS DRIVE	106	6	14	0.09	50	1
MESA DRIVE	105	6	13	0.19	50	2
METHODIST BIBLE CAMP ROAD	94	7	8	0.3	30-50	3
METHODIST CHURCH STREET	135	7	9	0.12	20-50	3
MICHELLE DRIVE	31	4	10	0.1	50	2
MIDFIELD DRIVE	68	5	21	0.15	50	1
MIDWAY DRIVE	36	4	5	0.55	30-50	2
MILBURN AVENUE	31	4	10	0.15	50	2
MILDEN HALL ROAD	51	7	5	0.3	50	1
MILHORN DRIVE	82	7	4	0.25	30-50	2
MILHORN ROAD	121	6	14	0.3	30-50	3
MILL CREEK RD. (SA-8203)	104	6	15	3.46	60	2
MILL ROAD	33	4	6	0.16	20-50	3
MILLARD LANE	66	7	5	0.09	40	
MILLER HOLLOW ROAD	112	5	16	0.4	10-50	4
MILLINGTON COURT	119	6	14	0.07	50	1
MINGA ROAD	108	7	18	1.7	40	1
MINGA STORE ROAD	121	7	18	0.4	30-50	3
MINUTEMAN DRIVE	82	5	4	0.15	50	1
MISSION DRIVE	51	7	5	0.1	15-50	4
MISTY DRIVE	90	6	13	0.2	50	2
MITCHELL ROAD	120	6	14	2.45	40	1
MITCHELL-KIDD DRIVE	96	7	8	0.25	40	2
MOBLEY ROAD	66	7	5	0.1	20-50	3
MOCCASIN STREET S.	12	4	12	0.06	30-50	3
MOCKINGBIRD LANE	105	6	13	0.5	30-50	2
MOCKINGBIRD PLACE	50	4	5	0.13	40	1
MOCK KNOB ROAD (VA-666)	6					
MOHAWK CIRCLE	49	4	7	0.03	40	1
MOHAWK STREET	12	4	12	0.3	30-50	3
MOHICAN LANE	49	4	7	0.1	50	1
MONTANA AVENUE	30	4	11	0.3	20-50	3
MONTE VISTA DRIVE	30	4	11	0.6	50	1
MONTEZUMA ROAD	49	4	7	1.15	50	1
MONTFORD DRIVE	92	6	14	0.08	50	2
MONTGOMERY ROAD (VA-884)	9					
MONTSWEAG COURT	119	6	15	0.3	40	2

ROAD NAME	MAP#	SECT.	C.D.	LENGTH	R.O.W.	CL
MONTVUE ROAD	106	6	14	0.06	50	3
MOODY DRIVE	63	6	7	0.25	50	1
MOODY LANE	78	6	7	0.15	40	2
MOORE DRIVE	35	4	5	0.25	30-50	2
MOORE ROAD	70	5	1	0.43	20-50	4
MORELAND DRIVE (SA-8208)	76	6	13,14	2.43	100+	1
MORELOCK DRIVE	80	7	5	0.9	50	2
MORELOCK ROAD	116	6	15	0.4	20-50	4
MORELOCK STREET	31	4	10,11	1.4	40-50	2
MORNING DOVE DRIVE	106	6	14	0.21	50	1
MORNINGDALE DRIVE	119	6	13	0.08	50	2
MORRELL CREEK LANE	85	5	1	1.3	30-50	2
MORRELL CREEK ROAD	84	5	1	1.85	30-50	2
MORRELL DRIVE	33	4	6	0.2	40-50	3
MORRELL ROAD	84	5	1	0.14	20-50	3
MORRELL TOWN ROAD	84	5	1	1.01	40	2
MORRISON AVENUE	31	4	10	0.15	50	2
MORSBY COURT	14	4	10	0.05	50	1
MORSE DRIVE	68		21	0.31	50	
MORTON HOLLOW ROAD	33	4	6	0.4	20-50	3
MOTTERN DRIVE	51	4	5	0.07	30-50	3
MOUNT AREA DRIVE	36	7	5	0.45	50	1
MOUNT HOLSTON ROAD	99	5	3,16	2.01	30-50	2
MOUNT VERNON DRIVE	48	4	10	0.26	30-50	2
MOUNT VIEW ROAD	91	6	13	0.23	50	2
MOUNTAIN MEADOWS DRIVE	123	7	20	0.14	50	2
MOUNTAIN ROAD (FOREST SERVICE)	57	5		0		
MOUNTAIN VIEW CIRCLE	124	7	9	0.2	50	1
MOUNTAIN VIEW COURT	81	7	8	0.12	50	1
MOUNTAIN VIEW DR. (SA-8220)	135	7	9	2.1	40-50	2
MOUNTAIN VIEW LANE	125	7	16	0.15	30-50	3
MOUNTAIN VIEW ROAD	111	7	16	1.1	30-50	2
MUDDY CREEK RD. (SA-8213,8214)	65	7	5,8,18	4.9	30-60	1
MULLENIX LANE	104	6	15	0.05	15-50	3
MULLENIX ROAD	116	6	15	0.4	15-50	3
MURRELL ROAD	103	6	15	2.14	40-50	1
MUSTANG DRIVE	48	4	10	0.15	30-50	2
MYRANDA LANE	13	4	11	0.15	30-50	3
MYRON STREET	30	4	11	0.1	50	1

N

N. HARR TRAIL ROAD	34	4	6	0.1	30-50	2
N. HOLSTON RIVER DRIVE	29	4	12	1.5	60	2
N. HOLSTON RIVER DRIVE EXT.	12	4	12	0.25	20-50	3
N. PAPERVILLE ROAD	21	5	2	0.95	40	2
N. VALLEY VIEW CIRCLE	48	4	7	0.2	40	2
NANKATIE DRIVE	92	6	14	0.08	40	2
NAT MULLENIX ROAD	116	6	15	0.12	30-50	3
NATCHEZ LANE	49	4	7	0.25	50	1
NAVAHO LANE	64	4	7	0.05	50	1
NAVE CROSS ROAD	126	7	16	0.35	20-50	3

ROAD NAME	MAP#	SECT.	C.D.	LENGTH	R.O.W.	CL
NAVE DRIVE	121	6	14	0.04	40	1
NEAL DRIVE	50	4	5	0.2	30-50	2
NEAL LANE	30	4	11	0.05	50	1
NED KING ROAD	135	7	9	0.25	30-50	3
NEELEY DRIVE	65	7	5	0.04	50	2
NEELEY LANE	65	7	5	0.05	50	2
NEELEY PLACE	65	7	5	0.2	40	2
NELSON AVENUE	124	7	9	0.47	50	1
NESTLEWOOD HOLLOW RD. (VA-710)	2					
NETTIE HILL ROAD	25	5	19	1.15	30-50	2
NEW BEASON WELL ROAD	31	4	10	1.73	80	1
NEW BETHEL ROAD	123	7	20	1.1	40	2
NEW CAMP RIDGE ROAD	25	5	19	0.1	20-50	4
NEW MOORE ROAD	76	6	13	0.25	50	1
NEW SUMMERVILLE ROAD	105	6	13	0.85	50	1
NEWLAND AVENUE	14	4	10	0.45	50	2
NICOLE LANE	82	5	16	0.21	50	1
NITA STREET	38	5	2	0.1	40	2
NORTHCOTT CIRCLE	30	4	11	0.25	40	2
NORTHCOTT DRIVE	30	4	11	0.6	30-50	2
NORTHCOTT LANE	31	4	10	0.06	40	3
NORWOOD DRIVE	68	5	4	0.07	50	2
NOTTINGHAM ROAD	32	4	10	0.27	30-50	3

O

O'DELL ROAD	69	5	21	0.3	15-50	4
OAK COURT	92	6	14	0.03	50	1
OAK DALE ROAD	96	7	4	0.55	40-60	2
OAK FOREST PLACE	105	6	13	0.35	50	1
OAK HAVEN DRIVE	105	6	13	0.18	50	1
OAK LANE	67	7	4	0.2	50	1
OAK PLACE	51	7	5	0.05	50	1
OAK STREET	51	7	5	0.4	50	1
OAK TREE LANE	92	6	14	0.04	40	2
OAKLAWN STREET	76	6	13	0.08	40	2
OAKLEAF DRIVE	92	6	13	0.1	60	1
OAKMONT DRIVE	106	6	14	0.68	60	1
OAKWOOD ROAD	35	4	5	1.2	40-60	1
OASIS LANE	75	6	13	0.15	30-50	2
ODD FELLOW	49	4	7	0.4	30-50	2
ODESSA ROAD	48	6	7	0.1	40	2
OFFIELD HOLLOW ROAD	55	5	1	0.6	15-50	4
OFFSET ROAD	9	5	19	0.35	40	1
OKEY MOWELL ROAD	102	6	15	0.2	20-50	4
OLD ADAMS CHAPEL ROAD	65	7	5	0.15	20-50	3
OLD AIRPORT ROAD	65	7	5	0.2	20-50	3
OLD BEASON WELL ROAD	31	4	10	1.25	50	2
OLD BEAVER CREEK ROAD	81	7	4	0.55	50	2
OLD BEIDLEMAN ROAD	55	5	1	0.4	30-50	3
OLD BELL HOLLOW ROAD	104	6	15	0.4	20-50	3
OLD BETHEL ROAD	67	7	4	0.25	40	1

ROAD NAME	MAP#	SECT.	C.D.	LENGTH	R.O.W.	CL
OLD BLAIRS GAP ROAD	117	6	15	3.26	30-50	2
OLD CARDEN HOLLOW ROAD	67	7	4	0.5	20-50	4
OLD DUMP ROAD	51	7	5	0.1	20-50	4
OLD DUNLAP ROAD	93	7	18	0.1	30-50	3
OLD ELIZABETHTON HWY. (SA-8221)	97	7	16	2.2	30-50	2
OLD ELIZABETHTON HIGHWAY S.	125	7	16	0.85	30-50	2
OLD FALL CREEK ROAD	48	6	7	0.2	40	2
OLD FORDTOWN ROAD	120	6	14	0.6	30-50	1
OLD HARR TRAIL ROAD	34	4	6	0.05	30-50	3
OLD HICKORY TREE ROAD	55	5	1	2.1	40	2
OLD J.A. HODGE ROAD	134	7	20	0.15	30-50	3
OLD JONESBORO ROAD (SA-8237)	54	5	2,21	3.01	50	2
OLD MILL CREEK ROAD	104	6	15	0.04	40	2
OLD MILL ROAD	63	6	7	0.1	30-60	3
OLD MORELAND DRIVE	91	6	13	0.28	40	2
OLD MOUNTAIN VIEW ROAD	125	7	16	0.04	30-50	3
OLD MUDDY CREEK ROAD	95	7	8	0.93	30-50	2
OLD OAK LANE	84	5	3	0.44	40	2
OLD PACTOLUS ROAD	76	6	13	0.1	20-50	4
OLD ROCK HILL ROAD	136	7	9	0.47	20-50	4
OLD SHADY ROAD	40	5	22	0.2	40	2
OLD SILVER GROVE ROAD	83	5	3	0.2	30-50	2
OLD STAGE COACH ROAD	65	7	5	0.35	30-50	2
OLD STAGE DRIVE	19	7	5	0.35	50	2
OLD STAGE ROAD	47	4	7	1.67	30-50	2
OLD STAGE TRAIL	36	7	5	1.25	40	2
OLD THOMAS BRIDGE ROAD	67	7	4	0.2	15-50	2
OLD WEAVER PIKE	83	5	3	1.01	40	2
OLD WHITE TOP ROAD	82	5	4	0.3	40	2
OLINGER DRIVE	15	4	10	1.01	30-50	2
OLINGER ROAD	33	4	6	0.3	30-50	3
OLLIS BOWERS HILL ROAD	33	4	10	0.45	30-50	1
OLYMPUS CIRCLE	120	6	14	0.06	40	1
OLYMPUS DRIVE	120	6	14	0.22	50	1
OMAR DRIVE	91	6	13	0.18	50	2
ONEIDA COURT	49	4	7	0.2	50	1
ORANGE STREET	31	4	10	0.1	30-50	2
ORBIN DRIVE	46	4	1	0.2	40	1
ORCHARD LANE	67	7	4	0.12	50	1
OREBANK ROAD	48	4	10	1.47	30-60	2
ORVILLE LIGHT ROAD	116	6	15	0.23	15-50	4
OSBORNES DRIVE	125	7	16	0.15	40	3
OSCEOLA DRIVE	49	4	7	0.15	50	1
OTARI DRIVE	76	6	13	0.55	40	1
OVERHILL DRIVE (SA-8244)	64	4	5	1.2	50	1
OVERHILL LANE	49	4	6	0.1	40	2
OVERHILL ROAD	31	4	10	0.1	30-50	3
OVERLOOK DRIVE	66	7	4	0.6	50	1
OVERLOOK ROAD	68	5	21	0.1	50	1
OVERVIEW COURT	92	6	14	0.03	40	2
OXFORD COURT	119	6	14	0.1	50	2

ROAD NAME	MAP#	SECT.	C.D.	LENGTH	R.O.W.	CL
P						
PACKINGHOUSE ROAD	31	4	10	1.9	60	2
PACTOLUS EXTENSION	91	6	13	0.08	40	2
PACTOLUS ROAD	91	6	13	1.2	30-50	2
PADDLE CREEK ROAD	68	5	21	2.1	40	2
PAGE STREET	14	4	2	0.25	50	2
PAINTER CREEK ROAD	7	5	22	1.8	40	2
PAINTER ROAD	23	5	22	0.3	20-50	2
PAISLEY LANE	85	5	1	0.05	40	2
PALMER ROAD	90	6	13	0.3	20-50	3
PALMYRA DRIVE	120	6	14	0.07	40	1
PAMELA COURT	65	7	5	0.5	50	2
PAPERVILLE ROAD	21	5	2	2.22	60	2
PARAMOUNT DRIVE	36	7	5	0.3	50	1
PARIS AVENUE	29	4	12	0.02	30-50	3
PARK DRIVE	61	6	13	0.44	40	2
PARK PLACE DRIVE	92	6	14	0.11	50	1
PARK RIDGE COURT	78	6	7	0.2	40	2
PARK TERRACE ROAD	92	6	14	0.02	50	1
PARKVIEW CIRCLE	124	7	9	0.08	60	2
PARKER HILL DRIVE	12	4	12	0.1	30-50	3
PARKER LANE	29	4	12	0.85	30-50	3
PARKER STREET	48	6	7	0.15	30-50	3
PARKS ROAD	1	5	19	0.15	30-50	3
PARKWAY DRIVE	92	6	14	0.28	60	4
PARSON DRIVE	30	4	11	0.1	30-50	2
PARTON DRIVE	30	4	11	0.2	30-50	2
PARTRIDGE PLACE	106	6	14	0.12	40	1
PATRICK HENRY CIRCLE	107	6	14	0.55	40	1
PATTERSON HILL ROAD	81	7	8	1.2	25-50	3
PATTON CIRCLE	98	5	16	0.25	20-50	3
PATTY BRANCH ROAD	41	5	19	0.4	30-50	3
PAULINE ROAD	14	4	10	0.1	30-50	3
PEACH ORCHARD DRIVE	29	4	12	0.1	30-50	3
PEACH TREE DRIVE	48	4	7	0.04	40	1
PEALER ROAD	141	7	9	0.05	20	3
PEARL LANE	78	5	7	0.55	50	1
PEAVLER DRIVE	31	4	10	0.15	50	2
PEBBLE DRIVE	30	4	11	0.1	40	2
PEERS STREET	48	6	7	0.09	50	1
PEMBERTON ROAD	55	5	22	2.35	30-60	2
PENDLETON ROAD	33	4	6	0.33	30-50	3
PENNSYLVANIA AVENUE	14	4	10	0.2	30-50	2
PENNSYLVANIA ROAD	90	6	13	0.07	30-50	2
PEOPLES ROAD	69	5	21	1.5	30-50	2
PEPPERTREE COURT	119	6	13	0.06	50	3
PEPPERTREE DRIVE	119	6	13	0.5	50	1
PERRY ROAD	126	7	16	0.2	20-50	3
PETERS ROAD	54	5	21	0.1	40	4
PETTYJOHN ROAD	63	6	7	0.85	50	1

ROAD NAME	MAP#	SECT.	C.D.	LENGTH	R.O.W.	CL
PHEASANT COURT	106	6	14	0.05	40	2
PHILON DRIVE	31	4	11	0.09	50	1
PICKENS BRIDGE RD. (SA-8217)	124	7	9	3.5	60	1
PICKENS ROAD	119	6	14	0.65	30-50	2
PIERCY STREET	94	7	18	0.5	50	1
PINE GROVE AVENUE	30	4	11	0.06	50	4
PINE HILL ROAD	125	7	16	0.75	30-50	2
PINE LAUREL CIRCLE	82	5	4	0.46	50	1
PINE RIDGE LANE	92	6	14	0.12	50	2
PINE RIDGE ROAD	111	7	16	0.4	50	1
PINECREST DRIVE	30	4	11	0.05	20-50	1
PINECREST ROAD	30	4	11	0.75	20-50	1
PINEHURST DRIVE	30	4	11	0.25	30-50	2
PINESPUR ROAD	66	7	5	0.15	40	1
PINEY AVENUE	124	7	9	0.42	50	1
PINEY FLATS ROAD (SA-8217)	124	7	9	2.42	60	1
PINEY HILL ROAD	70	5	1	1	40	2
PINON DRIVE	92	6	14	0.15	50	2
PIONEER HAVEN LANE	92	6	13	0.1	40	2
PITKIN DRIVE	91	6	13	0.14	60	2
PITT ROAD	107	7	18	1.1	30-50	1
PLAINVIEW DRIVE	36	4	5	0.45	40	2
PLANK ROAD	125	7	16	0.1	16-50	4
PLANTATION DRIVE	106	6	14	0.23	50	2
PLEASANT GROVE ROAD	82	5	16	4.25	40	2
PLEASANT HILL CHURCH ROAD	80	7	5	0.2	30-50	3
PLEASANT HILL DRIVE	48	4	7	0.04	50	1
PLEASANT HILL PLACE	126	7	16	0.3	30-50	2
PLEASANT HILL ROAD	80	7	5	0.95	40	2
POCAHONTAS DRIVE	49	4	7	0.1	40	1
POCAHONTAS TRAIL	45	7	20	0.03	40	1
POLARIS DRIVE	82	5	4	0.1	50	1
POND SPRINGS ROAD	76	6	13	1.1	30-50	2
POND SPRINGS ROAD W.	91	6	13	0.48	50	2
PONDELLA AVENUE	31	4	10	0.2	30-50	3
POOR HOLLOW ROAD	63	6	7	1.3	20-50	2
POPLAR CIRCLE	68	5	4	0.05	50	1
POPLAR GROVE RD. (STATE-347)	105	6				
POPLAR HILL LANE	54	5	21	0.06	40	1
POPLAR RIDGE CHURCH ROAD	124	7	9	0.3	30-50	2
POPLAR RIDGE ROAD	124	7	9	1.2	30-50	2
PORTLAND AVENUE	31	4	10	0.2	40	2
POSSUM CREEK RD. (SA-8227)	99	5	3,16	4	30-50	1
POST OAK DRIVE	121	6	14	0.35	50	1
POTATO HILL ROAD	104	6	15	0.42	40	1
POTTER LANE	8	5	19	0.1	30-50	2
POTTS HOLLOW ROAD	85	5	1	0.3	12--50	4
PRATT ROAD	12	4	12	0.1	15-50	3
PREAKNESS COURT	118	6	15	0.17	40	1
PRESCOTT STREET	31	4	10	0.03	50	2
PRICE ROAD	123	7	9	0.25	20-50	4

12/11/98

COUNTY ATLAS

ROAD NAME	MAP#	SECT.	C.D.	LENGTH	R.O.W.	CL
PRIDMORE STREET	31	4	10	0.25	30-50	3
PRINCETON ROAD	90	6	13	1.8	40	1
PROFFITT LANE (SA-8211)	121	6	14	1.55	30-50	1
PROMISE LANE	12	4	12	0.38	15-50	4
PVT. DR. ALICE	105	6		0		
PVT. DR. AMANDAS	38	5		0		
PVT. DR. APRIL	13	4		0		
PVT. DR. ASHLEY OAKS	92	6		0		
PVT. DR. B & I	97	7		0		
PVT. DR. BALL ORCHARD	30	4		0		
PVT. DR. BALL VILLAGE	104	6		0		
PVT. DR. BALLARDS	65	7		0		
PVT. DR. BANCROFT	32	4		0		
PVT. DR. BARRETT	80	7		0		
PVT. DR. BEN JONES	95	7		0		
PVT. DR. BOOTHERS	55	5		0		
PVT. DR. BOOHERTOWN	54	5		0		
PVT. DR. BOONEWOOD	109	7		0		
PVT. DR. BRAGG	103	6		0		
PVT. DR. BRENTWOOD	18	4		0		
PVT. DR. BROWNS	24	5		0		
PVT. DR. BURDINES	123	7		0		
PVT. DR. CAIN	64	6		0		
PVT. DR. CAMPBELLS	55	5		0		
PVT. DR. CANDY CREEK	94	7		0		
PVT. DR. CARISIL				0		
PVT. DR. CARTERS VALLEY	13	4		0		
PVT. DR. CEDAR RIDGE	13	4		0		
PVT. DR. CLARK	35	4		0		
PVT. DR. CLIFFSIDE	107	7		0		
PVT. DR. COLE HOLLOW	16	4		0		
PVT. DR. COUNTRY VIEW	80	7		0		
PVT. DR. CRICKET	134	7		0		
PVT. DR. DALLAS VAUGHN	33	4		0		
PVT. DR. DEAN	104	6		0		
PVT. DR. DEARSTONE	35	4		0		
PVT. DR. DEER RUN	84	5		0		
PVT. DR. DEFRIECE	35	4		0		
PVT. DR. DERICK	79	7		0		
PVT. DR. DOGWOOD	104	6		0		
PVT. DR. DOUGHERTY	123	7		0		
PVT. DR. DOUGLAS	93	7		0		
PVT. DR. DROKE FARM	106	6		0		
PVT. DR. DUNCAN	69	5		0		
PVT. DR. EATONS	52	7		0		
PVT. DR. EDENS	137	7		0		
PVT. DR. EDNA	14	4		0		
PVT. DR. EMORY HARR	48	6		0		
PVT. DR. ESSIES	24	5		0		
PVT. DR. EULA	18	4		0		
PVT. DR. FELTY	18	4		0		

ROAD NAME	MAP#	SECT.	C.D.	LENGTH	R.O.W.	CL
PVT. DR. FERNWOODS	55	5		0		
PVT. DR. FREEMANS	34	4		0		
PVT. DR. GARLANDS	76	6		0		
PVT. DR. GEORGIA	31	4		0		
PVT. DR. GILDERS	107	6		0		
PVT. DR. GOOD VIEW	31	4		0		
PVT. DR. GUY HILL	99	5		0		
PVT. DR. H & E	11	7		0		
PVT. DR. H. BARNETT	55	5		0		
PVT. DR. HELTON	64	4		0		
PVT. DR. HENRYS	121	6		0		
PVT. DR. HILLBILLY	36	7		0		
PVT. DR. HILLSIDE	111	7		0		
PVT. DR. HILLWOODS	56	5		0		
PVT. DR. HINKLE	68	5		0		
PVT. DR. HONEYSUCKLE	104	6		0		
PVT. DR. HOUSTON	63	6		0		
PVT. DR. INDUSTRIAL	64	7		0		
PVT. DR. ISLEYS	122	7		0		
PVT. DR. J.D. WHITE	31	4		0		
PVT. DR. JOURNEYS END	69	5		0		
PVT. DR. JUANITAS	33	4		0		
PVT. DR. KANUGA	41	5		0		
PVT. DR. KESTNER	14	4		0		
PVT. DR. KITES	38	5		0		
PVT. DR. KNOB HILL	66	7		0		
PVT. DR. LA DOUX VIE	109	7		0		
PVT. DR. LAKE HAVEN	140	7		0		
PVT. DR. LEAS	84	5		0		
PVT. DR. LITTRELL	82	5		0		
PVT. DR. LOUIS	99	5		0		
PVT. DR. LONE OAK	36	4		0		
PVT. DR. LOWES	98	5		0		
PVT. DR. LUNSFORD	80	7		0		
PVT. DR. MAPLE HILL	121	6		0		
PVT. DR. McMURRAY	33	4		0		
PVT. DR. MEMORY LANE	96	7		0		
PVT. DR. MISTY WOODS	33	4		0		
PVT. DR. MITCHELL	83	5		0		
PVT. DR. MOODY	118	6		0		
PVT. DR. MORELOCK	103	6		0		
PVT. DR. MORSE	63	6		0		
PVT. DR. MULLINEX	116	6		0		
PVT. DR. MUSSELMAN	106	6		0		
PVT. DR. NOKOMIS	90	6		0		
PVT. DR. OAK HILL	134	7		0		
PVT. DR. ODUM	83	5		0		
PVT. DR. OGDEN LN.	108	7		0		
PVT. DR. OLD PARKER	48	6		0		
PVT. DR. OLLIS ESTATE	70	5		0		
PVT. DR. OSBORNES WAY	18	4		0		

12/11/98

COUNTY ATLAS

ROAD NAME	MAP#	SECT.	C.D.	LENGTH	R.O.W.	CL
PVT. DR. PETERS	53	5		0		
PVT. DR. PINE HILL	56	5		0		
PVT. DR. PLEASANT	83	5		0		
PVT. DR. POINT SHORE	140	7		0		
PVT. DR. POTEAT	78	6		0		
PVT. DR. QUAIL	107	6		0		
PVT. DR. RADIO WAY	64	6		0		
PVT. DR. RAGSDALE	31	4		0		
PVT. DR. RAMSEY	66	7		0		
PVT. DR. REDBIRD	56	5		0		
PVT. DR. RHODES	123	7		0		
PVT. DR. RILEY-JAMES	107	6		0		
PVT. DR. RODGERS OAK DALE	64	6		0		
PVT. DR. ROGERS	41	5		0		
PVT. DR. ROLLIN HILLS	17	4		0		
PVT. DR. ROUSE	40	5		0		
PVT. DR. RUSSELL LN.	39	5		0		
PVT. DR. SAMMONS	65	7		0		
PVT. DR. SET POINT	109	7		0		
PVT. DR. SHANKLE	20	4		0		
PVT. DR. SHELTERED COVE	95	7		0		
PVT. DR. SHILOH	63	6		0		
PVT. DR. SMITH HILL	67	7		0		
PVT. DR. SMITHS	23	5		0		
PVT. DR. SMOKEY HILL	65	7		0		
PVT. DR. STEWART HILL	18	4		0		
PVT. DR. STEWARTS	97	5		0		
PVT. DR. STINE	34	4		0		
PVT. DR. SUGAR HOLLOW ACRES	95	7		0		
PVT. DR. SUMMER	63	6		0.		
PVT. DR. SUNNY LANE	108	7		0		
PVT. DR. TALLMAN	35	4		0		
PVT. DR. TALON	35	4		0		
PVT. DR. TANASE LANE	41	5		0		
PVT. DR. TIMBER MILL	81	7		0		
PVT. DR. TRINITY COVE	41	5		0		
PVT. DR. TRIVETTE	68	6		0		
PVT. DR. TWIN HILL	104	6		0		
PVT. DR. UNDERWOOD SPRINGS	112	5		0		
PVT. DR. VALLEY HIGH	90	6		0		
PVT. DR. VALLEY VIEW	33	4		0		
PVT. DR. VANDERPOOL	32	4		0		
PVT. DR. WALKERS	58	5		0		
PVT. DR. WALTERS	24	5		0		
PVT. DR. WATERSIDE	77	6		0		
PVT. DR. WATKINS	65	7		0		
PVT. DR. WHITELY	15	4		0		
PVT. DR. WHITNEY	89	5		0		
PVT. DR. WILLIAMS	124	7		0		
PVT. DR. WITCHER	70	5		0		
PYLE ROAD	40	5	22	0.14	15-50	4

ROAD NAME	MAP#	SECT.	C.D.	LENGTH	R.O.W.	CL
Q						
QUAIL HILL CIRCLE	106	6	14	0.05	40	2
QUAIL HEIGHTS COURT	106	6	14	0.1	40	2
QUAIL LANE	36	7	5	0.15	50	2
QUAIL POINT	106	6	14	0.04	50	2
QUALLS ROAD	30	4	11	0.2	30-50	3
QUEEN ANN COURT	124	7	9	0.14	40	2
R						
R. MILLER ROAD	80	7	8	0.2	20-50	4
R.C. BARRETT ROAD	102	6	15	0.2	20-50	3
RAGSDALE ROAD	30	4	11	0.05	50	3
RAGSDALE STREET	30	4	11	0.4	50	1
RAGSDALE STREET EXTENSION	30	4	11	0.2	30-50	3
RAINBOW CIRCLE	14	4	10	0.5	50	2
RAMAH ROAD	31	4	11	0.07	50	1
RAMBLING LANE	126	5	16	0.4	15-50	4
RAMBLING ROAD	92	6	14	0.35	40	2
RAMEY ROAD	51	4	5	0.55	40	2
RAMEY STREET	29	4	12	0.07	50	4
RAMSEY AVENUE	29	4	12	0.05	40	2
RANDALL STREET	14	4	10	0.05	30-50	3
RANDICH DRIVE	13	4	11	0.2	50	3
RANGE ROAD	134	7	20	0.4	15-50	4
RANGEWOOD ROAD	134	7	20	1.2	30-50	2
RANIER DRIVE	92	6	14	0.32	50	2
RAVEN CIRCLE	91	6	13	0.09	50	2
RAVEN STREET	14	4	10	0.1	50	2
RAVENTREE DRIVE	119	6	7	0.05	50	2
REBECCA STREET	68	5	4	0.4	30-50	3
RECTOR DRIVE	12	4	12	0.2	30-50	2
RED BUD LANE	50	4	5	0.6	30-50	3
RED CEDAR BRANCH ROAD	62	6	7	0.8	30-50	3
RED DEER ROAD	67	7	4	0.35	50	1
RED OAK LANE	106	6	14	0.17	50	2
RED OAK PLANTATION DRIVE	106	6	14	0.23	50	1
RED ROBIN LANE	48	6	7	0.2	30-50	2
REDSTONE DRIVE	82	5	4	0.25	50	1
REEDY CREEK DRIVE	34	4	6	0.25	30-50	3
REEDY CREEK LANE	34	4	6	0.2	30-50	3
REEDY CREEK ROAD	18	4	6	3.15	30-50	1
REGENCY DRIVE	106	6	14	0.27	50	2
REMINGTON COURT	120	6	14	0.18	50	2
RESERVOIR DRIVE	126	7	16	0.2	15-50	4
RESERVOIR ROAD (SA-8202)	75	6	13	4.72	40-50	1
REST AND BE THANKFUL LANE	91	6	13	0.04	40	2
RHEA AVENUE	51	4	5	0.25	50	1
RHOTON COURT	92	6	14	0.05	50	3
RICE CROSS ROAD	109	7	20	1.35	40	2
RICH DRIVE	30	4	11	0.45	40	2

ROAD NAME	MAP#	SECT.	C.D.	LENGTH	R.O.W.	CL
RICH DRIVE EXTENSION	30	4	10	0.3	40	2
RICHARDS LANE	126	7	16	0.3	15-50	4
RICHLAND DRIVE	92	6	14	0.1	50	3
RIDDLE CREEK ROAD	100	5	1	0.75	15-50	4
RIDDLE STREET	30	4	11	0.3	30-50	3
RIDGE CREST AVENUE	30	4	11,12	0.5	40-50	3
RIDGE DRIVE	95	7	8	1.2	40	2
RIDGE HAVEN DRIVE	30	4	11	0.05	40	2
RIDGE HILL ROAD	52	7	4	0.2	20-50	3
RIDGE ROAD	90	6	15	1.1	30-50	2
RIDGE ROAD (WASH. CO.)	131					
RIDGEDALE DRIVE	54	5	2	0.3	50	1
RIDGEMONT DRIVE	92	6	14	0.15	50	2
RIDGEMONT STREET	36	7	5	0.3	50	1
RIDGEPOINT COURT	96	7	8	0.1	50	
RIDGETOP DRIVE	67	7	4	0.25	50	1
RIDGEWAY DRIVE	95	7	8	0.85	40	2
RIDGEWAY ROAD	76	6	13	0.68	30-50	2
RIDGEWAY STREET	68	5	1	0.1	50	1
RIDGEWOOD DRIVE	31	4	10	0.2	50	2
RILEY HOLLOW ROAD	99	5	3	0.4	20-50	3
RIM ROCK ROAD	91	6	13	0.18	50	2
RIPPLING RUN	92	6	13	0.2	40	2
RITTER COURT	92	6	14	0.04	40	2
RIVER BEND ROAD	70	5	1	1.36	30-60	1
RIVER BRIDGE ROAD	121	7	18	0.15	20-50	3
RIVER ROAD	97	7	16	0.85	50	1
RIVERSIDE ROAD	97	5	16	4.25	30-50	1
RIVERVIEW DRIVE	97	5	16	0.2	20-50	3
RIVERVIEW ROAD	70	5	1	1	30-50	2
ROBERTS LANE	30	4	11	0.2	50	1
ROBIN COURT	48	4	7	0.08	40	3
ROBIN STREET	48	4	7	0.15	40	3
ROBINDALE LANE	92	6	14	0.09	60	2
ROBINWOOD ROAD	107	7	18	1.15	40	2
ROCK CITY ROAD	32	4	10	2.1	30-60	2
ROCK DRIVE	36	7	5	0.15	50	1
ROCK HILL LANE	19	4	6	0.15	20-30	3
ROCK HILL ROAD	136	7	9	1.25	40	1
ROCKHOLD ROAD (STATE-44)	99	5		0		
ROCK LANE	110	7	9	1.15	20-60	1
ROCK LEDGE	83	5	3	0.25	20-50	3
ROCK ROAD	36	7	5	0.2	30-50	1
ROCK SPRINGS DRIVE	104	6	13,15	2.1	30-50	2
ROCK SPRINGS RD. (SA-8204,8201)	77	6	13	6.58	40-60	1
ROCK VALLEY ROAD	105	6	13	0.5	30-50	2
ROCK VALLEY DRIVE	105	6	13	0.24	50	1
ROCKWOOD STREET	48	4	10	0.08	30-50	2
ROCKY BRANCH ROAD	78	6	7	1	50	1
ROCKY LANE	30	4	11	0.25	30-50	3
ROCKY ROAD	30	4	11	0.05	30-50	3

ROAD NAME	MAP#	SECT.	C.D.	LENGTH	R.O.W.	CL
ROCKY SPRINGS ROAD	109	7	20	1.55	60	2
RODEFER DRIVE	34	4	6	0.1	30-50	3
RODEFER HOLLOW ROAD	17	4	6	1.15	30-50	1
RODEFER LANE	34	4	6	0.2	30-50	3
RODGERS OAK DAIL DRIVE	64	6	7	0.17	80-160	2
ROGERS AVENUE	30	4	11	0.5	30-50	1
ROGERS DRIVE	83	5	21	0.3	30-50	3
ROGERS LANE	68	5	21	0.1	20-50	3
ROGERS ROAD	55	5	1	0.2	15-50	4
ROLLER DRIVE	106	6	14	0.24	50	1
ROLLING HILLS	104	6	15	0.1	15-50	3
ROOTY BRANCH ROAD	39	5	1,22	1.3	30-50	1
ROSEBERRY ROAD	103	6	15	0.4	20-50	3
ROSEBERRY ROAD EXTENSION	103	6	15	0.1	10--50	1
ROSECLIFF DRIVE	49	4	5	0.05	50	1
ROSEDALE DRIVE	12	4	12	0.1	30-50	3
ROSEHAVEN COURT	92	6	14	0.1	40	2
ROSEMARY LANE	124	7	9	0.13	40	1
ROSEMONT DRIVE	36	7	5	0.15	50	1
ROSEMONT STREET	90	6	15	0.35	50	1
ROSE TRACE COURT	63	6	7	0.21	50	1
ROSEWOOD CIRCLE	63	6	7	0.1	40	1
ROSEWOOD DRIVE	31	4	10	0.19	50	1
ROSEWOOD LANE	63	6	7	0.25	40	1
ROWAN DRIVE	36	7	5	0.15	50	1
ROXANA DRIVE	64	4	7	0.07	50	1
ROXBURY LANE	63	6	7	0.1	40	1
ROYAL CIRCLE	105	6	13	0.06	50	2
ROYAL DRIVE	107	6	14	0.4	50	1
ROYAL OAK DRIVE	66	7	4	0.32	50	1
RUNNING DEER TRAIL	92	6	13	0.15	50	1
RUSH DRIVE	25	5	19	0.1	20-50	3
RUSHMORE ROAD	90	6	13	0.45	30-50	2
RUSSELL LANE	39	5	22	0.05	30-50	3
RUSSELL ROAD	66	7	5	0.05	50	1
RUST ROAD	57	5	19	0.3	20-50	4
RUSTIC HILLS DRIVE	31	4	10	0.6	50	2
RUTLEDGE DRIVE	68	5	21	0.2	50	1
RUTLEDGE LANE	950	7	18	0.2	15-50	4
RUTLEDGE ROAD	107	7	18	0.3	25-50	3
RUTLEDGE STREET	68	5	4	0.45	50	1
RYAN ROAD	103	6	15	0.3	20-50	3
RYDER CHURCH ROAD (SA-8227)	84	5	3	4	40-50	2
S						
S. EASTMAN ROAD	61	6	13	1.1	50	1
S. SUMMER SOUND ROAD	110	7	8	0.1	20-50	3
S. VALLEY VIEW CIRCLE	48	4	7	0.3	50	1
S. WILCOX DRIVE (STATE-126)	61	6		0		
SADDLE RIDGE DRIVE	48	6	7	0.2	40	2
SALEM STREET	30	4	11	0.15	40	2

ROAD NAME	MAP#	SECT.	C.D.	LENGTH	R.O.W.	CL
SALLEY STREET	31	4	11	0.05	11--50	2
SALVATION ROAD	30	4	11	0.03	30-50	3
SAM GAMMON ROAD	107	7	18	0.35	20-50	3
SAMOLA ROAD	49	4	5	0.7	30-50	2
SAMOSSET DRIVE	75	6	13	0.15	30-50	2
SAMUEL STREET	14	4	10	0.3	30-50	2
SAND BAR ROAD	69	5	1	0.6	15-50	3
SANDERS STREET	94	7	18	0.36	50	1
SANDPIPER CIRCLE	106	6	14	0.1	40	1
SANDRIDGE DRIVE	106	6	14	0.24	40	2
SANDY ROAD	31	4	11	0.07	50	1
SANDY POINTE STREET	94	6	18	0.17	50	2
SANTANA ROAD	48	4	7	0.25	50	1
SARATOGA ROAD	75	6	13	0.65	30-50	2
SASANOVA COURT	105	6	15	0.15	40	2
SAUL ROAD	36	4	5	0.1	20-50	4
SAVOY DRIVE	51	4	5	0.15	50	1
SAWYER CIRCLE	97	7	16	0.05	50	1
SCALF DRIVE	126	7	16	0.3	15-50	4
SCENIC COURT	92	6	14	0.09	40	2
SCENIC DRIVE	54	5	21	0.2	50	1
SCHOOL AVENUE	51	7	5	0.15	30-50	2
SCHOOL DRIVE	51	7	5	0.1	30-50	2
SCOTT LANE	17	4	6	0.95	30-50	1
SCOTT ROAD	16	4	6	0.55	30-50	3
SCOTT STREET	32	4	10	0.05	30-50	3
SEAVER ROAD	75	6	13	0.55	30-50	2
SECOND AVENUE	53	5	21	0.3	50	2
SECOND STREET	36	4	5	0.07	25-50	3
SEDFIELD ROAD	76	6	13	0.09	40	1
SELENA STREET	48	6	7	0.15	30-50	3
SELENA STREET EXTENSION	48	6	7	0.1	30-50	3
SELKIRK DRIVE	63	4	7	0.07	50	1
SELLS ROAD	82	5	4,16	1.65	30-50	2
SEMINOLE LANE	49	4	7	0.15	50	1
SENECA ROAD	49	4	7	0.35	50	1
SENEKER LANE (SA-8234)	35	4	5,6	1.5	30-50	1
SENEKER ROAD	18	4	6	0.2	30-50	2
SEQUOYAH DRIVE	66	7	4	0.26	50	1
SHADOW LANE	63	6	7	0.1	20-50	3
SHADOW WOOD LANE	92	6	13	0.15	50	1
SHADOWTOWN ROAD (SA-8212)	64	4	7	2.36	40-50	1
SHADY FORD ROAD	40	5	22	0.23	15-50	4
SHADY LANE	41	5	19	0.04	40	3
SHADY VIEW ROAD	91	6	13	2.3	50	1
SHADYSIDE DRIVE	92	6	13	0.65	50	1
SHALE STREET	30	4	11	0.1	30-50	3
SHANKS ROAD	80	7	8	1.01	40	2
SHANNON STREET	63	6	7	0.3	40	1
SHARPS CREEK ROAD	41	5	19	1.8	30-50	2
SHARPS HOLLOW ROAD	83	5	3	1.01	40	2

ROAD NAME	MAP#	SECT.	C.D.	LENGTH	R.O.W.	CL
SHARRON ROAD	30	4	11	0.35	50	1
SHATOLON COURT	80	7	5	0.12	40	2
SHAYER ROAD	95	7	8	0.15	25-50	3
SHAWNEE DRIVE	49	4	7	0.1	40	3
SHELL ROAD (VA-663)	7					
SHERRILL DRIVE	105	6	13	0.11	30-50	4
SHIPLEY FERRY RD. (SA-8210)	64	7	5,7	3.77	40-60	1
SHIPLEY FERRY ROAD E.	92	6	13	0.6	40-50	2
SHIPLEY FERRY ROAD W.	106	6	13	0.65	40-50	2
SHIPP SPRINGS ROAD	30	4	11	0.9	60	1
SHOALS ROAD	77	6	14	0.05	40	3
SHOEMAKER COURT E.	118	6	15	0.03	40	1
SHOEMAKER COURT W.	118	6	15	0.02	40	1
SHORT HILL DRIVE	47	4	11	0.09	30-50	2
SHORT LANE	120	6	14	0.19	20-50	3
SHULER DRIVE	48	6	7	0.4	50	1
SIERRA DRIVE	48	4	10	0.2	50	1
SIGMAN HOLLOW ROAD	126	5	16	1.3	20-50	3
SILER DRIVE	31	4	10	0.11	40	2
SILVER GROVE RD. (SA-8223)	97	5	3,16	3.7	40-60	1
SILVER LEAF COURT	48	6	7	0.27	50	1
SILVER CHAPEL ROAD	16	4	6	1.15	30-50	2
SIMPSON STREET	61	6	13	0.3	40	1
SINKING SPRINGS ROAD	55	5	1	0.5	40	2
SINKING SPRINGS ROAD EXTENSION	55	5	1	0.5	30-50	3
SIOUX DRIVE	49	4	7	0.2	50	1
SIR ECHO DRIVE	106	6	14	0.7	50	1
SIXTH STREET	36	4	5	0.3	25-50	3
SKELTON BLUFF ROAD	13	4	11	0.95	30-50	3
SKY VIEW DRIVE	30	4	11	0.1	30-50	3
SKY WA MO ROAD	126	5	16	2.2	20-50	3
SKYLAND DRIVE	68	6	4,21	0.26	50	1
SLAUGHTER STREET	104	6	13	0.26	20-50	2
SLEEPY HOLLOW ROAD	107	6	14	0.07	20-50	3
SLOAN DRIVE	36	7	5	0.1	40	1
SMILEY CIRCLE	51	4	5	0.2	40	1
SMILEY COURT	51	4	5	0.08	40	3
SMITH DRIVE	48	4	7	0.1	30-50	1
SMITH ROAD	107	6	14	0.1	40	2
SMITH STREET	30	4	11	0.5	30-50	3
SNAPPS FERRY RD. (SA-8204)	119	6	14	0.9	30-60	1
SONNETT COURT	118	6	15	0.2	50	1
SOURWOOD DRIVE	64	4	5	0.05	40	1
SOURWOOD HILL ROAD	19	4	5	0.1	50	1
SOUTH CREEK COURT	91	6	13	0.45	50	1
SOUTH HOLLOW ROAD	35	4	5	1.1	30-50	2
SOUTH HOLSTON DAM RD. (SA-8241)	55	5	1	2.85	40	1
SOUTH ROAD	57	5	19	0.3	20-50	4
SOUTH WIND DRIVE	63	6	7	0.15	50	1
SOUTHRIDGE DRIVE	63	6	7	0.62	50	1
SOUTHWOOD DRIVE	91	6	13	0.6	50	1

ROAD NAME	MAP#	SECT.	C.D.	LENGTH	R.O.W.	CL
SPANGLER ROAD	95	7	8	0.65	30-50	2
SPARDALE STREET	48	6	7	0.15	50	1
SPARROW ROAD	82	5	4	0.1	50	1
SPERRY CIRCLE	54	5	21	0.21	50	1
SPINDLETOP CIRCLE	118	6	15	0.07	50	1
SPINDLETOP COURT	118	6	15	0.04	40	2
SPORTSMAN DOCK ROAD	109	7	20	0.45	40	1
SPRING BROOK DRIVE	106	6	14	0.11	50	1
SPRING COURT	97	5	16	0.05	30-50	4
SPRING DRIVE	34	4	6	0.15	20-50	3
SPRING HILL DRIVE	48	4	7	0.25	40	1
SPRING LANE	92	6	14	0.04	50	2
SPRING STREET	66	7	5	0.25	40	1
SPRING VALLEY ROAD	54	5	2	0.3	50	1
SPRINGDALE DRIVE	39	5	22	1.01	50	3
SPRINGFIELD DRIVE	68	5	4,21	1.01	50	1
SPRINGVIEW STREET	63	6	7	0.2	50	1
SPRINGWOOD LANE	14	4	10	0.2	40	3
SPURGEON DRIVE	51	4	5	0.15	50	1
SPURGEON LANE	79	7	18	1.35	30-50	1
SPURGEON ROAD	64	4	7	0.35	40	2
STAGE COACH TRAIL	36	7	5	0.25	30-50	3
STAGE ROAD	32	4	10	0.8	30-50	2
STANFIELD ROAD	111	7	16	0.9	20-50	2
STANLEY STREET	51	7	5	0.05	30-50	2
STARDUST ROAD	104	6	15	0.6	30-50	1
STARDUST ROAD W.	104	6	15	0.1	30-50	3
STARLIGHT ROAD	104	6	15	0.3	25-30	1
STAEDMAN ROAD	108	7	18	0.7	30-50	2
STEEP HILL ROAD	63	6	7	0.1	40	1
STELLA STREET	12	4	12	0.05	30-50	3
STEVENSON HILL ROAD	108	7	18	1.01	30-50	2
STEVENWOOD DRIVE	36	4	5	0.25	50	1
STEWART ROAD	80	7	5	0.18	50	2
STONE HILL	70	5	1	0.25	30-50	3
STONE HOLLOW ROAD	70	5	1	0.7	20-50	3
STONE POINT ROAD	78	6	7	0.15	30-50	3
STOUT ROAD	125	7	16	0.2	20-50	4
STRATTON PLACE	106	6	14	0.15	40	1
STUFFLE STREET	31	4	11	0.55	50	1
STUFFLE TERRACE	31	4	10	0.2	40	1
SUBURBIA DRIVE	51	4	5	0.1	40	1
SUE STREET	121	6	14	0.15	50	1
SUGAR HOLLOW DRIVE (SA-8239)	69	5	1,21	1.6	30-50	1
SUGAR HOLLOW ROAD	95	7	8	2.1	40-50	1
SUGAR HOLLOW TRAIL	95	7	8	0.8	40-50	1
SUGARTREE DRIVE	64	4	7	0.1	40	1
SUGARTREE ROAD	124	7	9	0.3	50	1
SUGARWOOD DRIVE	107	7	18	0.25	50	1
SUMMER HILLS COURT	106	6	14	0.12	50	2
SUMMER SOUND ROAD	96	7	8	1.7	40	2

ROAD NAME	MAP#	SECT.	C.D.	LENGTH	R.O.W.	CL
SUMMERSET LANE	70	5	1	0.7	20-50	3
SUMMERTIME DRIVE	24	5	22	0.1	20-50	3
SUMMERVIEW COURT	105	6	13	0.1	40	2
SUMMERVILLE ROAD	92	6	13	3.1	40-60	2
SUMMIT OAKS CIRCLE	92	6	13	0.25	40	1
SUMPTER ROAD	105	6	13	1.3	30-50	1
SUNBRIGHT DRIVE	63	6	7	0.17	50	1
SUNBURY COURT	48	6	7	0.07	50	2
SUNNY HILLS DRIVE	36	7	5	0.1	40	1
SUNNY LANE	31	4	11	0.3	30-50	2
SUNNYSIDE STREET	48	6	7	0.1	40	2
SUNNYVIEW DRIVE	12	4	12	0.4	30-50	3
SUNSET DRIVE	31	4	12	0.06	30-50	2
SUNSET ROAD	96	7	8	0.15	20-50	2
SURREY DRIVE	63	6	7	0.05	40	1
SWEET HOLLOW ROAD	1	5	19	1.52	30-50	3
SWEET KNOBS TRAIL	68	5	4	1.23	50	1
SYCAMORE DRIVE	81	7	4	0.5	50	1
SYLVAN DRIVE	92	6	14	0.1	50	2

T

TALL OAK COURT	92	6	14	0.11	50	2
TALL TREE DRIVE	106	6	14	0.35	30-50	3
TALLMAN DRIVE	35	4	5	0.1	40	1
TALLMAN ROAD	36	4	5	0.1	30-50	3
TAMS LANE	91	6	13	0.25	50	2
TANNER COURT	13	4	11	0.09	40	3
TANK HILL ROAD	135	7	9	0.6	20-50	4
TANSEY LANE	31	4	10	0.1	30-50	3
TARKINGTON STREET	30	4	11	0.15	30-50	3
TATE DRIVE	31	4	10	0.05	50	1
TATE ROAD	111	7	16	0.7	30-50	3
TAYLOR DRIVE	135	7	9	0.4	50	1
TAYLOR ROAD	17	4	6	0.2	20-50	3
TEABERRY CIRCLE	106	6	14	0.06	40	3
TEAL COURT	106	6	13	0.1	40	1
TECHNOLOGY COURT	124	7	9	0.09	60	1
TED DYKES ROAD	116	6	15	0.7	20-50	3
TEE DRIVE	66	7	4	0.02	50	1
TEMPLE STAR ROAD EXTENSION	103	6	15	0.1	30-50	2
TEMPLE STAR ROAD	103	6	15	0.25	30-50	2
TENNEVA STREET	12	4	12	0.15	30-50	3
TESTER HOLLOW ROAD	124	7	9	0.6	20-50	3
TEXAS STREET	12	4	12	0.02	20-50	4
THIRD STREET	36	4	5	0.1	25-50	3
THISTLEWOOD DRIVE	121	6	14	0.05	50	1
THOMAS ACRES ROAD	104	6	15	0.2	50	2
THOMAS LANE	82	7	4	1.25	20-50	2
THOMAS ROAD	23	5	22	0.5	12--50	4
THOMAS STREET	30	4	11	0.35	30-50	2
THOMPSON HOLLOW ROAD	124	7	9	0.8	20-50	3

ROAD NAME	MAP#	SECT.	C.D.	LENGTH	R.O.W.	CL
THOMPSON STREET	30	4	11	0.4	50	1
THORNGROVE DRIVE	14	4	10	0.31	50	1
THREE OAKS DRIVE	90	6	15	0.2	30-50	3
TIFFANY COURT	106	6	14	0.13	50	1
TIFFANY LANE	19	4	5	0.2	50	1
TIFFANY STREET	63	6	7	0.07	50	1
TILSON HILL	90	6	13	0.07	30-50	3
TILSON ROAD	90	6	13	0.06	30-50	3
TIM WARREN ROAD	69	5	21	0.9	30-50	1
TIMBER RIDGE ROAD	112	7	16	2.88	30-50	2
TIMBERLAND CIRCLE	91	6	13	0.75	50	1
TIMBERLAND COURT	91	6	13	0.15	50	1
TIMBERTREE BRANCH ROAD	15	4	10	1.3	30-50	1
TIMRICK STREET	48	4	10	0.08	40	2
TINKER LANE	48	6	7	0.17	50	1
TIPTON LANE	51	4	5	0.7	30-50	3
TIPTON STREET	13	4	11	0.05	30-50	3
TODDMAN STREET	14	4	10	0.2	40	2
TOP TREE	66	7	4	0.05	50	1
TOPPER AVENUE	14	4	10	0.15	40	2
TORBETT ROAD	134	7	20	0.3	20-50	3
TORY ROAD	13	4	11	0.03	40	3
TOY CRAWFORD ROAD	103	6	15	0.07	20-50	4
TRAILS END ROAD	131	6	15	0.2	20-50	3
TRAILS END STREET	90	6	15	0.05	50	1
TRAVIS CIRCLE	14	4	10	0.05	40	2
TREVOR DRIVE	30	4	11	0.15	30-50	3
TRI-STATE LIME ROAD	16	4	6	1.01	40	1
TRIVETTE LANE	84	5	3	0.2	30-50	3
TROUBLESOME HOLLOW ROAD	85	5	1	2.7	30-50	2
TROY LANE	125	7	16	0.15	30-50	3
TULIP TREE ROAD	107	7	18	0.05	50	1
TURNER ROAD	99	5	3	1.01	40	1
TVA ROAD SOUTH	70	5	1	0.2	30-50	3
TWAIN CIRCLE	97	7	16	0.05	50	1
TWIN HILLS DRIVE	104	6	15	0.56	30-50	2
TWIN OAKS LANE	35	4	5	0.25	30-50	2
TWIN OAKS ROAD (VA-675)	8					
TYLER STREET	30	4	11	0.2	30-50	2
U						
UNDERWOOD SPRING BRANCH RD.	112	5	16	1.6	20-50	2
UPLAND DRIVE	106	6	14	0.13	50	1
UPLAND WAY	19	4	5	0.05	50	1
V						
V.F.W. ROAD	92	6	14	0.2	50	2
V.I. RANCH ROAD	39	5	22	2.8	40	2
VA DEAD END ROAD #759	9	5	19	0.05	30-50	3
VALE AVENUE	69	5	21	0.15	30-50	1
VALLEY PIKE ROAD	38	5	2	0.5	30-50	2

ROAD NAME	MAP#	SECT.	C.D.	LENGTH	R.O.W.	CL
VALLEY DRIVE	64	7	5	1.2	30-60	1
VALLEY ROAD	66	7	5	0.25	40	1
VALLEY STREET	30	4	11	0.18	40	3
VALLEYDALE DRIVE	119	6	13	0.34	50	1
VAN HORN STREET	14	4	10	0.2	30-50	3
VANCE LANE	126	7	16	0.06	20-50	3
VANCE TANK ROAD (SA-8226)	54	5	21	2.53	30-50	2
VANDERBILT WAY	105	6	13	0.13	40	1
VERMONT DRIVE	30	4	11	0.6	30-50	2
VESTA AVENUE	76	6	13	0.7	15-50	4
VICKARS ROAD	111	7	9,16	3.25	40	1
VICTORY LANE	105	6	13	0.25	40	2
VIEW STREET	92	6	14	0.05	50	1
VINCENT LANE	75	6	13	0.1	20-50	3
VINE STREET	64	4	7	0.04	40	1
VIOLET STREET	121	6	14	0.35	40	1
VIRGINIA DRIVE	13	4	12	0.15	30-50	3

W

W. CLAY STREET	90	6	15	0.05	30-50	2
W. VALLEY VIEW CIRCLE	63	4	7	0.15	50	1
W. CARTERS VALLEY RD. (STATE-34)	12	4		0		
WACO COURT	91	6	13	0.05	50	2
WAGON WHEEL LANE	91	6	13	0.05	40	2
WAHOO DRIVE	107	7	18	0.1	50	3
WAHOO VALLEY RD. (SA-8210)	93	7	18	2.4	50	2
WAKEFIELD COURT	120	6	14	0.25	50	1
WALKER DRIVE	77	6	14	0.11	30-50	3
WALLACE LANE	39	5	22	0.15	20-50	3
WALLING ROAD	95	7	8	0.4	30-50	2
WALNUT GROVE ROAD	111	7	16	3.1	30-50	1
WALNUT HILL ROAD	36	4	5	0.75	50	1
WALNUT LANE	125	7	16	0.1	40	3
WALNUT TRAIL	36	4	5	0.1	30-50	2
WALTON COURT	92	6	14	0.26	50	1
WALTZ LANE	92	6	14	0.03	50	2
WAMPLER ROAD	53	5	21	0.5	10--50	4
WARD LANE	33	4	6	0.1	30-50	3
WARD PLACE	61	6	13	0.1	30-50	2
WARD ROAD	135	7	9	0.07	12--50	4
WARREN DRIVE	123	7	20	1.6	20-50	3
WARREN ROAD (SA-8216)	123	7	9,20	1.45	60	2
WARRICK DRIVE	61	6	13	0.09	40	2
WARRIOR DRIVE	92	6	14	0.4	30-50	2
WASSUM LANE	126	7	16	0.4	15-50	3
WATAUGA ROAD	23	5	22	0.3	15-50	4
WATERFORD DRIVE	63	6	7	0.35	50	1
WATERS EDGE DRIVE	83	5	3	0.21	50	1
WAYNE CONSTRUCTION ROAD	32	4	10	0.5	30-50	1
WAYNE STREET	30	4	11	0.1	30-50	2
WEAVER BRANCH RD. (SA-8218)	110	7	9,16	4.24	60	1

ROAD NAME	MAP#	SECT.	C.D.	LENGTH	R.O.W.	CL
WEAVER CREEK ROAD	113	5	3	1.1	20-50	3
WEAVER LANE	33	4	7	0.1	30-50	1
WEAVER PIKE (SPLIT-STATE-358)	54	5		0		
WEBB COURT	38	5	2	0.2	40	2
WEBB DRIVE	136	7	9	0.1	20-50	4
WEBB ROAD	124	7	9	0.8	40	2
WEBBER ROAD	18	4	5	0.35	20-50	3
WEDGEWOOD CIRCLE	30	4	11	0.03	40	2
WELCH ROAD	30	4	11	0.35	50	1
WELK ROAD	29	4	12	0.06	30-50	3
WEMBECK DRIVE	48	4	7	0.3	40	2
WENTWORTH STREET	31	4	10	0.1	30-50	3
WESLEY DRIVE	123	7	20	0.29	50	2
WESSEX DRIVE	92	6	14	0.1	40	1
WEST CAMPGROUND ROAD	131	6	15	1.4	30-50	2
WEST CENTRAL	36	4	5	0.2	40	2
WEST VALLEY DRIVE	118	6	15	1.4	50-60	1
WESTBROOK DRIVE	92	6	13	0.16	50	1
WESTFIELD DRIVE	105	6	13	1.5	30-50	1
WESTFIELD PLACE	105	6	13	0.42	40	1
WESTMINISTER PLACE	106	6	14	0.05	40	2
WESTVIEW DRIVE	65	7	5	0.15	40	2
WEXFORD LANE	64	7	5	0.25	50	1
WHIRLAWAY CIRCLE	118	6	15	0.04	50	1
WHISPERING HAVEN ROAD	118	6	15	0.3	50	2
WHISPERING HILL ROAD	35	4	5	0.15	40	2
WHISPERING HILLS DRIVE	76	6	13	0.25	40	1
WHISPERING WAY	92	6	14	0.36	50	1
WHISPERING WOODS DRIVE	82	5	4	0.4	50	1
WHITAKER ROAD	134	7	9	0.4	20-50	3
WHITAKER STREET	36	4	5	0.1	50	1
WHITCOMB STREET	48	4	10	0.07	30-50	1
WHITE HAWK WAY	92	6	13	0.1	40	2
WHITE HOLLOW ROAD	99	5	3	0.6	15-50	3
WHITE OAK LANE	92	6	14	0.12	50	2
WHITE ROAD	84	5	3	0.4	20-50	3
WHITE TOP CIRCLE	68	5	4	0.18	50	1
WHITE TOP ROAD (SA-8226)	82	5	4	2.22	40	2
WHITEHAVEN DRIVE	14	4	10	0.35	50	3
WHITEHEAD ROAD	110	7	16	0.75	40	3
WHITEHILLS ROAD	14	4	10	0.15	50	2
WHITNEY LANE	69	5	21	0.2	50	1
WICKLOW DRIVE	64	4	7	0.06	50	1
WIDENER ROAD	92	6	14	0.09	50	2
WIL-RHO CIRCLE	31	4	10	0.3	30-50	3
WILD ROSE LANE	15	4	10	0.1	40	3
WILDWOOD ROAD (SA-8210)	93	7	18	0.85	30-50	2
WILLARD DRIVE	92	6	18	0.19	50	2
WILLIAMS LANE	36	4	5	0.4	50	1
WILLOW BROOK DRIVE	81	7	4	0.2	50	2
WILLOW HOLLOW ROAD	106	6	14	0.15	40	3

ROAD NAME	MAP#	SECT.	C.D.	LENGTH	R.O.W.	CL
WILLOW VIEW DRIVE	90	6	15	0.15	12-50	3
WILMONT DRIVE	92	6	14	0.15	50	1
WIMBERLY CIRCLE	36	7	5	0.25	50	1
WIMBERLY PLACE	30	4	11	0.05	40	2
WIMBERLY WAY	36	7	5	0.3	50	1
WINCHESTER LANE	19	4	5	0.05	50	1
WINDALE AVENUE	30	4	11	0.07	20-50	3
WINDING ROAD	51	4	5	0.15	40	2
WINDING WAY	51	4	5	0.15	40	2
WINDMERE PLACE	76	6	13	0.04	50	1
WINDSOR FOREST DRIVE	92	6	14	0.37	50	1
WINDY HILLS ROAD	68	5	4	0.5	15-50	4
WINE CIRCLE	49	4	7	0.85	50	1
WINEGAR AVENUE	12	4	12	0.05	30-50	3
WINEGATE ROAD	64	7	5	0.1	40	1
WINESAP ROAD	106	6	14	0.57	50	1
WINFIELD DRIVE	92	6	13	0.15	50	1
WINSTON CIRCLE	118	6	15	0.1	40	1
WINTERBROOK CIRCLE	120	6	14	0.07	40	2
WINTERBROOK DRIVE	120	6	14	0.07	50	1
WITHERSPOON DRIVE	107	6	14	0.25	40	1
WOLF BROS. ROAD	135	7	9	0.07	30-50	2
WOLFE AVENUE	31	4	10	0.05	20-50	3
WOLFE STREET	31	4	11	0.12	30-50	2
WONDERLAND DRIVE	14	4	10	0.5	50	1
WOOD COURT	106	6	14	0.04	40	2
WOOD HAVEN DRIVE	92	6	14	0.22	50	2
WOODBINE	23	5	22	0.2	30-50	3
WOODBINE LANE	23	5	22	0.03	30-50	4
WOODBERRY CIRCLE	106	6	14	0.04	40	2
WOODBROOK AVENUE	36	7	5	0.15	50	1
WOODCLIFT DRIVE	48	4	10	0.37	50	1
WOODCREST DRIVE	92	6	14	0.65	30-50	3
WOODFIELD DRIVE	90	6	15	0.1	50	1
WOODLAND CIRCLE	41	5	19	0.2	40	1
WOODLAND COURT	41	5	19	0.05	50	2
WOODLARK LANE	14	4	10	0.08	50	1
WOODLAWN DRIVE	103	6	15	0.2	40	3
WOODLAWN ROAD	103	6	15	0.2	40	3
WOODMERE DRIVE	92	6	14	0.08	50	2
WOODOAK DRIVE	63	6	7	0.1	40	1
WOODPOND COURT	63	6	7	0.05	40	1
WOODRIDGE CIRCLE	120	6	14	0.07	40	1
WOODS EDGE DRIVE	17	4	6	0.14	50	
WOODS DRIVE	111	7	16	0.25	30-50	3
WOODS LANE	111	7	16	0.2	30-50	3
WOODS ROAD	125	7	16	1.1	30-50	3
WOODS STREET	33	4	6	0.12	40	1
WOODS WAY	48	4	7	0.3	50	1
WOODSTOCK PLACE	106	6	14	0.1	50	1
WOODSTONE DRIVE	106	6	14	0.15	50	1

12/11/98

COUNTY ATLAS

ROAD NAME	MAP#	SECT.	C.D.	LENGTH	R.O.W.	CL
WOODVALE ROAD	33	4	6	0.1	30-50	2
WOODVIEW COURT	105	6	13	0.21	50	2
WOODWAY CIRCLE	67	7	4	0.4	50	1
WOODWAY DRIVE	81	7	8	0.42	40-50	1
WORLEY DRIVE	55	5	1	0.05	30-50	3
WORLEY VANCE ROAD	125	7	16	0.15	30-50	3
WORTHINGTON DRIVE	91	6	13	0.3	50	2
WREN ROAD	22	5	22	0.2	30-50	3
WRENWOOD COURT	106	6	14	0.06	40	1
WRIGHT LANE	68	5	4	0.17	30-50	3
WYATT CEMETERY ROAD	25	5	19	0.08	20-50	4
WYATT HOLLOW ROAD	25	5	19	1.8	30-50	2
WYLINE LANE	51	7	5	0.1	50	1
WYNFIELD COURT	106	6	14	0.05	40	2
WYNHAVEN DRIVE	92	6	14	0.1	40	1
Y						
YOAKLEY ROAD	95	7	18	0.39	30-50	2
YOKLEY STREET	30	4	11	0.2	40	2
YORKTOWN ROAD	107	6	14	0.15	25-50	2
YOUNG ROAD	76	6	13	0.23	40	2
YOUTH CENTER ROAD	35	4	5	0.2	30-50	2

916.51

TO THE HONORABLE GIL HODGES, COUNTY EXECUTIVE, AND THE MEMBERS OF THE SULLIVAN COUNTY BOARD OF COMMISSIONERS IN Regular SESSION THIS THE 21st OF December 19 98.

RESOLUTION AUTHORIZING Sullivan County School Department amending 1998-99 Budget for General Purpose School for the High Schools That Work Grant

WHEREAS, TENNESSEE CODE ANNOTATED; SECTION _____, AUTHORIZES COUNTIES TO _____

NOW, THEREFORE BE IT RESOLVED by the Board of County Commissioners of Sullivan County, Tennessee, assembled in Regular Session on the 21st day of December 19 98.

THAT WHEREAS, Sullivan County Schools has been awarded \$12,000.00 from the High Schools That Work Grant, the 1998-99 General Purpose School Budget needs to be amended to reflect this grant, and

WHEREAS, the Sullivan County School Board has approved amending the 1998-99 School Budget for the purpose of accepting the High School That Works Grant, now

THEREFORE BE IT RESOLVED, that the Sullivan County Board of Commissioners approve amending the 1998-99 General Purpose School Budget as follows:

Accounting Code	Description	Amount
46790.000	Other Vocational	12,000.00
71300.429	Instructional Supplies and Equipment	3,000.00
72230.355	Travel	5,000.00
72230.457	Staff Development	4,000.00

All resolutions in conflict herewith be and the same rescinded insofar as such conflict exist.

This resolution shall become effective on _____, 19____, the public welfare requiring it.

Duly passed and approved this 18 day of January, 1999.

Jeannie F. Hammon
Attested: _____
County Clerk

Date: 1/18/99

County Executive

INTRODUCED BY COMMISSIONER MAYES ESTIMATED COST: _____
SECONDED BY COMMISSIONER FERGUSON FUND: General Purpose School

Committee Action	Approved	Disapproved	Deferred	Date
Administrative				
Budget				
Executive				

Commission Action	Aye	Nay	Pass	Absent	Total
Roll Call	24				
Voice Vote					

COMMENTS: FIRST READING 12/21/98 APPROVED 01/18/99 ROLL CALL

RESOLUTION NUMBER

198

TO THE HONORABLE GIL HODGES, COUNTY EXECUTIVE, AND THE MEMBERS OF THE
SULLIVAN COUNTY BOARD OF COMMISSIONERS IN Regular SESSION THIS THE 21st OF
December 19 98.

RESOLUTION AUTHORIZING Sullivan County School Department amending 1998-99 Budget
for General Purpose School

WHEREAS, TENNESSEE CODE ANNOTATED; SECTION _____, AUTHORIZES COUNTIES
TO _____

NOW, THEREFORE BE IT RESOLVED by the Board of County Commissioners of Sullivan
County, Tennessee, assembled in Regular Session on the 21st day of December 19 98.

THAT WHEREAS, reserves for various accounts need to be added to the 1998-99 General
Purpose School Budget, and

WHEREAS, the Sullivan County School Board has approved amending the 1998-99 School
Budget for the purpose of making these adjustments, now

THEREFORE BE IT RESOLVED, that the Sullivan County Board of Commissioners
approve amending the 1998-99 School Budget to various accounts in order to meet expenditures.

Accounting Code	Description	Amount
34379.000	Reserve for Career Ladder	79,959.38
34383.000	Reserve for Technology	8,794.22
34990.000	Reserve for Spanish	508.33
71100.127	Career Ladder	79,959.38
71100.429	Instructional Supplies and Materials	5,068.90
71100.722	Regular Instruction Equipment	4,233.65

All resolutions in conflict herewith be and the same rescinded insofar as such conflict exist.

This resolution shall become effective on _____, 19____, the public welfare requiring it.

Duly passed and approved this 18 day of January, 19 99.

Jeanette J. Gammon
County Clerk Date: 1/18/99

County Executive Date: _____

INTRODUCED BY COMMISSIONER MAYES ESTIMATED COST: _____
SECONDED BY COMMISSIONER FERGUSON FUND: General Purpose School

Committee Action	Approved	Disapproved	Deferred	Date
Administrative				
Budget				
Executive				

Commission Action	Aye	Nay	Pass	Absent	Total
Roll Call	24				
Voice Vote					

COMMENTS: FIRST READING 12/21/98 APPROVED 01/18/99 ROLL CALL

TO THE HONORABLE GIL HODGES, COUNTY EXECUTIVE, AND THE MEMBERS
OF THE SULLIVAN COUNTY BOARD OF COMMISSIONERS IN Regular SESSION
THIS THE 21st OF December 1998.

RESOLUTION AUTHORIZING Exclusion of Student Services From Social Security
Coverage for Tennessee Boards of Education.

WHEREAS, TENNESSEE CODE ANNOTATED; SECTION _____, AUTHORIZES
COUNTIES TO _____

NOW, THEREFORE BE IT RESOLVED by the Board of County Commissioners of
Sullivan County, Tennessee, assembled in Regular Session on the 21st day of December
1998.

THAT WHEREAS, HR. 4328, Public Law 105-273 Section 2023 authorizes states to
modify Agreements to exclude from Social Security/Medicare coverage services
performed by a student in the employ of a school where the student is enrolled and
regularly attending classes at such school with respect to services performed after June
30, 2000, and

WHEREAS, Acting under authority of an Emergency Resolution passed and approved
December 21, 1998 the Sullivan County Board of Commissioners authorized and
directed the County Executive, to execute an Agreement with the Old Age &
Survivors, Disability, Health Insurance (Social Security) to the Sullivan County Section
218 Agreement, thereof except those excluded by applicable Federal State laws and
regulations, or by said Resolution, and

WHEREAS, pursuant to Federal law, the State's Agreement may not thereafter be
modified so as to cover service performed by student in the employ of a school where the
student is enrolled and regularly attending classes at such school, and

WHEREAS, notwithstanding any provisions of said Resolution, as amended, it is now
deemed to be in the best interest of Sullivan County and the Sullivan County Board of
Education, to exclude from its coverage group the services of a student in the employ of
a school where the student is enrolled and regularly attending classes at such school.
Agreement must be modified and approved on or after January 1, 1999 and on or before
March 31, 1999, by the State Old Age & Survivors Insurance Agency and the
Commissioner of Social Security, now

THEREFORE, BE IT RESOLVED, Sullivan County Board of Commissioners acting
under authority of said Emergency Resolution, the County Executive is authorized and
directed to execute an amendment to said Agreement to exclude from coverage under
the Federal System of Old Age & Survivors, Disability, Health Insurance (Social Security),
services performed by a student in the employ of a school where the student is enrolled
and regularly attending classes at such school, and

BE IT FURTHER RESOLVED, by the Sullivan County Board of Commissioners that the
Resolution shall be in full force and effect upon passage and approval, for all intent and
purposes, except that the effective date to exclude student service from Social Security
coverage, shall be for service performed on or after June 30, 2000.

All resolutions in conflict herewith be and the same rescinded insofar as such conflict exist.

This resolution shall become effective on _____, 19____, the public welfare requiring
it.

Duly passed and approved this 18 day of January, 1999.

Attested: Jeanie J. Gammon
County Clerk

Date: 1/18/99

Date: _____
County Executive

RESOLUTION NO. 209
Page Two

INTRODUCED BY COMMISSIONER MAYES ESTIMATED COST: _____
SECONDED BY COMMISSIONER FERGUSON FUND: _____

Committee Action	Approved	Disapproved	Deferred	Date
Administrative				
Budget				
Executive				

Commission Action	Aye	Nay	Pass	Absent	Total
Roll Call	21	3			
Voice Vote					

COMMENTS: FIRST READING 12/21/98 APPROVED 01/18/99 ROLL CALL

0519

AGREEMENT TO AMEND AGREEMENT

*Attachment
Res # 20-9*

This Agreement made and entered into this _____ day of _____ 19 _____ by and between this undersigned Director of Old Age & Survivors Insurance Agency State of Tennessee, acting under authority of Chapter 38, Title 8 Section 4-3-2403 Tennessee Code Annotated, and the _____ acting by and through and by its lawfully constituted and duly and authorized officers.

WITNESSETH;

That, WHEREAS, the parties hereto in the above capacities are parties to an Agreement executed on the _____ to which Agreement reference is expressly made for the terms and provisions thereof, and

WHEREAS, by Resolution passed and approved the ____ day of _____ 19 _____ the County Executive was authorized to execute an amendment to said Agreement so as to exclude from its coverage group under the Federal System Old Age & Survivors, Disability, Health, Insurance, (Social Security) service performed by student in the employ of a school where the student is enrolled and regularly attending classes at such school, for services performed on or after June 30, 2000.

NOW THEREFORE, in consideration of the aforementioned Resolution and the provisions and promises hereinafter set out, it is agreed and understood that the Agreement shall be amended to exclude services of a student in the employ of a school where the student is enrolled and regularly attending classes at such school to effective June 30, 2000.

County Executive

County

Approved: _____
Mary E, Smith, Director
Old Age & Survivors Insurance Agency

RESOLUTION NUMBER 2210

TO THE HONORABLE GIL HODGES, COUNTY EXECUTIVE, AND THE MEMBERS OF THE SULLIVAN COUNTY BOARD OF COMMISSIONERS IN REGULAR SESSION THIS THE 21st DAY OF DECEMBER, 19 98.

RESOLUTION AUTHORIZING funding for a new computer system (hardware and software).

WHEREAS, TENNESSEE CODE ANNOTATED; SECTION _____, AUTHORIZES COUNTIES TO

NOW, THEREFORE BE IT RESOLVED by the Board of County Commissioners of Sullivan County, Tennessee, assembled in Regular Session on the 21st day of December, 19 98.

WHEREAS, the Sheriff's Office computer system (Hardware and Law Enforcement Management Software) is not sufficient to properly operate the department and is not "Year 2000 Compliant" (Y2K), and,

WHEREAS, the current system will not generate statistical reports required by management to make sound decisions, and,

WHEREAS, the current system is such that it can not be integrated or connected to other county systems such as the County's Geographic Information System (GIS), and,

WHEREAS, the current system is such that it can not be integrated or connected to other law enforcement management systems such as Cashless Commissary or The Automated fingerprint Livescan System currently installed in the jail, and,

WHEREAS, it is not cost effective to make the current hardware Y2K compliant, and,

WHEREAS, the current hardware was to be make Y2K compliant, the current hardware would still not be compatible with other state systems, and,

WHEREAS, the current software can not be made Y2K compliant and will not submit Tennessee Incident Based Reports (TIBRS) as required by the Tennessee Bureau of Investigation and the Federal Bureau of Investigation, and,

WHEREAS, the Sullivan County Sheriff's Office will become ineligible for future grants from the State Office of Criminal Justice Programs without submitting TIBRS reports, and,

WHEREAS, the current software and hardware for the Sheriff's Office National Crime Information Computer Terminal (NCIC) is not "NCIC 2000" compliant, and,

WHEREAS, the current Sheriff's Office NCIC Terminal can not be made "NCIC 2000 Compliant", and,

WHEREAS, the proposed new system is Y2K compliant, "NCIC 2000" compliant, will submit TIBRS reports, generate any statistical report desired by management, is scalable, state of the art, and has complete integration capability with other systems.

NOW THEREFORE BE IT RESOLVED that the Sullivan County Sheriff's Office requests that the Commission allocates \$249,907 to procure new hardware and Law Enforcement Management Software from undesignated fund balance, Account 39000.000.

All resolutions in conflict herewith be and the same rescinded insofar as such conflict exist.

This resolution shall become effective on _____, 19 ____ the public welfare requiring it.

Duly passed and approved this 18 day of January, 19 99.

Attested: Jeanie F. Hammon
County Clerk

Date: 1-18-99

County Executive

Date: _____

0621

Res # 22 10
Page Two

INTRODUCED BY COMMISSIONER GARY MAYES ESTIMATED COST: _____
 SECONDED BY COMMISSIONER MIKE GONCE FUND: _____

Committee Action	Approved	Disapproved	Deferred	Date
Administrative				
Budget				
Executive				

Commission Action	Aye	Nay	Pass	Absent	Total
Roll Call	23			1	
Voice Vote					

COMMENTS: FIRST READING 12/21/98 APPROVED 01/18/99 ROLL CALL

RESOLUTION NUMBER 2311

TO THE HONORABLE GIL HODGES, COUNTY EXECUTIVE, AND THE MEMBERS OF THE SULLIVAN COUNTY BOARD OF COMMISSIONERS IN REGULAR SESSION THIS THE 21st DAY OF DECEMBER, 19 98.

RESOLUTION AUTHORIZING the Sullivan County Sheriff's Office permission to enter into a five year contract with a Cashless Commissary provider expending zero funds.

WHEREAS, TENNESSEE CODE ANNOTATED; SECTION _____, AUTHORIZES COUNTIES TO

NOW, THEREFORE BE IT RESOLVED by the Board of County Commissioners of Sullivan County, Tennessee, assembled in Regular Session on the 21st day of December, 19 98.

WHEREAS, the Sheriff's Office does not have a Cashless Commissary System.

DELETE - WHEREAS, a Cashless Commissary would generate approximately \$100,000 per year to the County and.

WHEREAS, inmates of the Jail are provided necessary items by family members or friends. This situation invites smuggling of contraband into the Jail, and.

WHEREAS, inmates are allowed to possess money to purchase items from vending machines. This also creates opportunities for theft and gambling, and.

WHEREAS, a Cashless Commissary would provide all necessary inmate items, eliminate the need for items to be brought into the Jail, and eliminate the need for inmates to have cash on their person, and.

WHEREAS, a Cashless Commissary would eliminate the need for Sheriff's Office employees to handle money, and.

WHEREAS, the proposed Cashless Commissary System will be operated by the chosen vendor without placing any additional manpower requirements on the Sheriff's Office, and.

WHEREAS, the vendor is responsible for all equipment and maintains a \$1,000,000 bond and accepts all liability for their products and services, and.

WHEREAS, the vendors employees undergo a FBI background check and any local agency check desired by the Sheriff's Office, and.

WHEREAS, the Cashless Commissary System would integrate into the newly proposed computer system eliminating the need for any data entry into this system, and.

WHEREAS, the Cashless Commissary would provide necessary items to inmates classed as indigent, but also has the capability to recoupe any funds expended on an inmate during a later incarceration if the inmate is no longer classed as indigent.

NOW THEREFORE BE IT RESOLVED that the Sullivan County Sheriff's Office requests permission to enter into a five year contract with a Cashless Commissary vendor (expending zero funds but expect to generate \$100,000 revenue back to the County.) DELETE

All resolutions in conflict herewith be and the same rescinded insofar as such conflict exist.

This resolution shall become effective on _____, 19 ____ the public welfare requiring it.

Duly passed and approved this 18 day of January, 19 99.

Attested: Jeanie J. Gammon Date: 1-18-99
County Clerk

County Executive

Date: _____

0523

Res# 2311
Page TwoINTRODUCED BY COMMISSIONER GARY MAYES ESTIMATED COST: _____
SECONDED BY COMMISSIONER MIKE GONCE FUND: _____

Committee Action	Approved	Disapproved	Deferred	Date
Administrative				
Budget				
Executive				

Commission Action	Aye	Nay	Pass	Absent	Total
Roll Call	24				
Voice Vote					

COMMENTS: FIRST READING 12/21/98 . APPROVED AS AMENDED 01/18/99
ROLL CALL

RESOLUTION NUMBER

24/12

TO THE HONORABLE GIL HODGES, COUNTY EXECUTIVE, AND THE MEMBERS OF THE SULLIVAN COUNTY BOARD OF COMMISSIONERS IN REGULAR SESSION THIS THE 21st DAY OF DECEMBER, 19 98.

RESOLUTION AUTHORIZING permission authorizing the Sullivan County Sheriff to enter into a five year contract with an inmate phone system provider expending zero funds.

WHEREAS, TENNESSEE CODE ANNOTATED; SECTION _____, AUTHORIZES COUNTIES TO

NOW, THEREFORE BE IT RESOLVED by the Board of County Commissioners of Sullivan County, Tennessee, assembled in Regular Session on the 21st day of December, 19 98.

WHEREAS, the current inmate phone system contract has expired, and,

WHEREAS, the current inmate phone system does not provide any management control over the system, and,

WHEREAS, the current inmate phone system does not generate any revenue for local calls, and,

WHEREAS, the current inmate phone system provider's commission rate is twenty percent, and,

WHEREAS, other inmate phone system providers pay forty percent and also pay commissions on local calls, and,

WHEREAS, a new inmate phone system provider will more than double the revenue paid to the county, and,

WHEREAS, a new inmate phone system will integrate into the proposed Cashless Commissary and management computer system eliminating data entry into this system.

NOW THEREFORE BE IT RESOLVED that the Sullivan County Sheriff's Office request for permission to enter into a five year contract with an inmate phone system provider expending zero funds.

All resolutions in conflict herewith be and the same rescinded insofar as such conflict exist.

This resolution shall become effective on _____, 19 ____ the public welfare requiring it.

Duly passed and approved this 18 day of January, 19 99.

Jeanie J. Hammon
Attested: _____
County Clerk

Date: 1-18-99

County Executive

Date: _____

INTRODUCED BY COMMISSIONER GARY MAYES ESTIMATED COST: _____
SECONDED BY COMMISSIONER MIKE GONCE FUND: _____

Committee Action	Approved	Disapproved	Deferred	Date
Administrative				
Budget				
Executive				

Commission Action	Aye	Nay	Pass	Absent	Total
Roll Call	24				
Voice Vote					

COMMENTS: FIRST READING 12/21/98 APPROVED 01/18/99 ROLL CALL

RESOLUTION NUMBER 2513

TO THE HONORABLE GIL HODGES, COUNTY EXECUTIVE, AND THE MEMBERS OF THE SULLIVAN COUNTY BOARD OF COMMISSIONERS IN REGULAR SESSION THIS THE 21st DAY OF DECEMBER, 19 98.

RESOLUTION AUTHORIZING additional personnel and related equipment for the Sullivan County Sheriff's Office and Jail.

WHEREAS, TENNESSEE CODE ANNOTATED; SECTION _____, AUTHORIZES COUNTIES TO

NOW, THEREFORE BE IT RESOLVED by the Board of County Commissioners of Sullivan County, Tennessee, assembled in Regular Session on the 21st day of December, 19 98.

WHEREAS, the Sullivan County Sheriff's Office (SCSO) wishes to run effectively and efficiently, and,

WHEREAS, the Sullivan County Sheriff's Office is responsible for providing Bailiff and Court Security Personnel to all County Courts, including new courts when established, and,

WHEREAS, the Sullivan County Sheriff's Office has seen a vast increase in workload requirements placed in our Records Department because of new T.B.I. and F.B.I. reporting methods, "Tennessee Incident Based Reports" (TIBRS), and,

WHEREAS, the Sullivan County Sheriff's Office needs to improve on inadequacies in its inventory and equipment controls, and,

WHEREAS, the Sullivan County Sheriff's office wishes to improve on its coverage of increased "Calls" placed upon the Road officers, and,

WHEREAS, the Sullivan County Sheriff's Office has seen an increase in the amount of "Process" that needs to be served, and,

WHEREAS, the Sullivan County Jail needs to keep level with an overloaded and increasing jail population,

NOW THEREFORE BE IT RESOLVED that the Sullivan County Sheriff's Office and Jail request additional personnel with related benefits and one-time equipment costs per the attached, from undesignated fund balance, Account 39000.000.

Breakdown is as Follows: AMENDED WITH ATTACHED

Sheriff	54110-100	Personnel	\$444,192.32	134,409.11
Sheriff	54110-300	Contracted Services	8,750.00	
Sheriff	54110-400	Supplies & Materials	50,147.58	
Sheriff	54110-700	Capital Outlay	297,741.48	186,951.29
Jail	54210-100	Personnel	239,896.80	
Jail	54210-300	Contracted Services	3,500.00	
Jail	54210-400	Supplies & Materials	13,869.80	
Benefits			182,060.74	
Undesignated Fund Balance 39000.000			\$1,240,158.72	

All resolutions in conflict herewith be and the same rescinded insofar as such conflict exist.

This resolution shall become effective on _____, 19 ____ the public welfare requiring it.

Duly passed and approved this 18 day of JANUARY, 19 99.

Jeannie J. Hammond
County Clerk

Date: 1-18-99

County Executive

Date: _____

0626

Resolution 25/3
page two

INTRODUCED BY COMMISSIONER GARY MAYES ESTIMATED COST: 25
SECONDED BY COMMISSIONER MIKE GONCE FUND: _____

Committee Action	Approved	Disapproved	Deferred	Date
Administrative				
Budget				
Executive				

Commission Action	Aye	Nay	Pass	Absent	Total
Roll Call	21	3			
Voice Vote					

COMMENTS: FIRST READING 12/21/98 APPROVED AS AMENDED 01/18/99
ROLL CALL

0627

Attachment
Bo# 13PERSONNEL REQUEST
1/14/99

QTY	POSITION	CLASS	RATE OF PAY	ANNUAL SALARY	FEB.1 THRU JUN.30.99	BENEFITS @ 30 %
1	BAILIFF	K	\$ 11.82	\$ 27,044.16	\$ 11,441.76	\$ 3,432.53
1	COURT SECURITY	F	\$ 9.65	\$ 22,079.20	\$ 9,341.20	\$ 2,802.36
1	RECORDS CLERKS	D	\$ 8.14	\$ 18,624.32	\$ 7,879.52	\$ 2,363.86
1	ROAD OFFICERS	F	\$ 9.65	\$ 22,079.20	\$ 9,341.20	\$ 2,802.36
1	ROAD OFFICERS	F	\$ 9.65	\$ 22,079.20	\$ 9,341.20	\$ 2,802.36
1	ROAD OFFICERS	F	\$ 9.65	\$ 22,079.20	\$ 9,341.20	\$ 2,802.36
1	ROAD OFFICERS	F	\$ 9.65	\$ 22,079.20	\$ 9,341.20	\$ 2,802.36
	SUB TOTAL				\$ 66,027.28	\$ 19,808.18
1	CORRECTION OFFICERS	F	\$ 9.65	\$ 22,079.20	\$ 9,341.20	\$ 2,802.36
1	CORRECTION OFFICERS	F	\$ 9.65	\$ 22,079.20	\$ 9,341.20	\$ 2,802.36
1	CORRECTION OFFICERS	F	\$ 9.65	\$ 22,079.20	\$ 9,341.20	\$ 2,802.36
1	CORRECTION OFFICERS	F	\$ 9.65	\$ 22,079.20	\$ 9,341.20	\$ 2,802.36
	SUB TOTAL				\$ 37,364.80	\$ 11,209.44

11

TOTAL

TOTAL PERSONNEL \$ 134,409.70

10 UNIFORMS @ \$1,386.98	\$ 13,869.80
11 PHYS/PSYCH @ \$350	\$ 3,850.00
10 OFFICER EQUIP. @ \$1,001	\$ 10,010.00
1 VEHICLES @ \$24,811.79	\$ 24,811.79

GRAND TOTAL \$ 186,961.29

SUB TOTAL SHERIFF	\$ 107,616.95
SUB TOTAL JAIL	\$ 48,316.72
COUNTY BENEFITS	\$ 31,017.62

N
1/14
1/14

SULLIVAN COUNTY SHERIFF'S OFFICE
COST TO OUTFIT ONE DEPUTY
12/21/98

ATTACHMENT # 1

2 PAIR PANTS	\$ 161.00
2 LONG SLEEVE SHIRT	\$ 69.00
2 SHORT SLEEVE SHIRT	\$ 67.00
1 TIE W/TIE TAC	\$ 10.90
1 LIGHTWEIGHT JACKET	\$ 66.95
1 WINTER JACKET	\$ 140.50
1 WINTER HAT	\$ 54.50
1 SUMMER HAT	\$ 46.50
2 ACCORNS	\$ 11.98
1 RAIN CAP COVER	\$ 15.95
1 DUTY BELT	\$ 34.50
2 SMALL BELT KEEPERS	\$ 5.90
2 LARGE BELT KEEPERS	\$ 9.90
1 BULLET PROOF VEST	\$ 450.00
1 TRAFFIC VEST	\$ 30.00
HANDCUFFS	\$ 20.50
HANDCUFF CASE	\$ 18.95
RAINCOAT	\$ 166.00
GLOVES	\$ 6.95
TOTAL	\$ 1,386.98

ATTACHMENT # 3					
STATE BID PRICE					
FORD CROWN VIC 99				\$ 21,571.00	
1997 prices					
SECURITY SCREEN			\$ 254.73		
LOWER EXT. PANEL			\$ 31.47		
LIGHT BAR			\$ 716.42		
SHOTGUN RACK			\$ 79.46		
GUN LOCK			\$ 58.47		
RADIO			\$ 1,101.75		
SIREN			\$ 329.46		
SPEAKER			\$ 117.82		
STRIPING			\$ 350.00		
PRICE INCR 15%			455.94		
TOTAL VEHICLE ACCESSORIES				\$ 3,240.79	
TOTAL COST				\$ 24,811.79	

PERSONNEL REQUEST
12/21/98

Attachment 0630
Rev # 25/13

Replaced with
attachment dated
1/14/99

QTY	POSITION	CLASS	RATE OF PAY	ANNUAL SALARY	TOTAL SALARY	BENEFITS @ 30 %	UNIFORMS
1	BAILIFF	K	\$ 11.82	\$ 27,044.16	\$ 27,044.16	\$ 8,113.25	\$ 1,386.98
1	COURT SECURITY	F	\$ 9.65	\$ 22,079.20	\$ 22,079.20	\$ 6,623.76	\$ 1,386.98
3	RECORDS CLERKS	D	\$ 8.14	\$ 18,624.32	\$ 55,872.96	\$ 16,761.89	\$ -
1	QUARTERMASTER	F	\$ 9.65	\$ 22,079.20	\$ 22,079.20	\$ 6,623.76	\$ -
2	ROAD OFFICERS	F	\$ 9.65	\$ 22,079.20	\$ 44,158.40	\$ 13,247.52	\$ 2,773.96
2	ROAD OFFICERS	G	\$ 10.21	\$ 23,360.48	\$ 46,720.96	\$ 14,016.29	\$ 2,773.96
3	ROAD OFFICERS	H	\$ 10.71	\$ 24,504.48	\$ 73,513.44	\$ 22,054.03	\$ 4,160.94
3	ROAD OFFICERS	I	\$ 11.00	\$ 25,168.00	\$ 75,504.00	\$ 22,651.20	\$ 4,160.94
9	P-TIME ROAD OFFICERS		\$ 11.00	\$ 8,580.00	\$ 77,220.00	\$ -	\$ 12,482.82
SUB TOTAL					\$ 444,192.32	\$ 110,091.70	\$ 29,126.58
2	CORRECTION OFFICERS	F	\$ 9.65	\$ 22,079.20	\$ 44,158.40	\$ 13,247.52	\$ 2,773.96
2	CORRECTION OFFICERS	G	\$ 10.21	\$ 23,360.48	\$ 46,720.96	\$ 14,016.29	\$ 2,773.96
3	CORRECTION OFFICERS	H	\$ 10.71	\$ 24,504.48	\$ 73,513.44	\$ 22,054.03	\$ 4,160.94
3	CORRECTION OFFICERS	I	\$ 11.00	\$ 25,168.00	\$ 75,504.00	\$ 22,651.20	\$ 4,160.94
SUB TOTAL					\$ 239,896.80	\$ 71,969.04	\$ 13,869.80
35							
	see uniform cost attach #1*						
				TOTAL			
TOTAL PERSONNEL (with benefits & uniforms)				\$ 909,146.24			
35	PHYS/PSYCH @ \$350			\$ 12,250.00			
21	OFFICER EQUIP. (attach #2)			\$ 21,021.00			
12	VEHICLES (attach #2)			\$ 297,741.48			
SUB TOTAL SHERIFF				\$ 910,923.08			
SUB TOTAL JAIL				\$ 329,235.64			
GRAND TOTAL				\$ 1,240,158.72			

Revised
with att. dated
1/14/99

0631

Replace with
attachment date
1/14/99
ATTACHMENT #2

OFFICER EQUIPMENT

1 bailiff, 1 court security, 3 records clerks, 1 quartermaster, 19 road officers

QTY		AMT	
21	GLOCK 22 W/HOLSTER	\$ 425.00	\$ 8,925.00
21	PEPPER SPRAY	\$ 25.00	\$ 525.00
21	2 CLIPS	\$ 5.00	\$ 105.00
21	SHOT GUN	\$ 400.00	\$ 8,400.00
21	POCKET GUIDES	\$ 10.00	\$ 210.00
21	BLANKET	\$ 5.00	\$ 105.00
21	FLASHLIGHT W/HOLDER	\$ 75.00	\$ 1,575.00
21	TRAFFIC FLARES qty 12	\$ 20.00	\$ 420.00
21	FIRE EXTINGUISHER	\$ 21.00	\$ 441.00
21	FIRST AID KITS	\$ 15.00	\$ 315.00
	TOTAL	\$ 1,001.00	\$ 21,021.00

VEHICLES

12	CRUISERS (see attached #3)	\$ 24,811.79	\$ 297,741.48
	TOTAL	\$ 24,811.79	\$ 297,741.48

PERSONNEL REQUEST
1/14/99

QTY	POSITION	CLASS	RATE OF PAY	ANNUAL SALARY	FEB.1 THRU JUN.30.99	BENEFITS @ 30 %
1	BAILIFF	K	\$ 11.82	\$ 27,044.16	\$ 11,441.76	\$ 3,432.53
1	COURT SECURITY	F	\$ 9.65	\$ 22,079.20	\$ 9,341.20	\$ 2,802.36
1	RECORDS CLERKS	D	\$ 8.14	\$ 18,624.32	\$ 7,879.52	\$ 2,363.86
1	ROAD OFFICERS	F	\$ 9.65	\$ 22,079.20	\$ 9,341.20	\$ 2,802.36
1	ROAD OFFICERS	F	\$ 9.65	\$ 22,079.20	\$ 9,341.20	\$ 2,802.36
1	ROAD OFFICERS	F	\$ 9.65	\$ 22,079.20	\$ 9,341.20	\$ 2,802.36
1	ROAD OFFICERS	F	\$ 9.65	\$ 22,079.20	\$ 9,341.20	\$ 2,802.36
SUB TOTAL					\$ 66,027.28	\$ 19,808.18
1	CORRECTION OFFICERS	F	\$ 9.65	\$ 22,079.20	\$ 9,341.20	\$ 2,802.36
1	CORRECTION OFFICERS	F	\$ 9.65	\$ 22,079.20	\$ 9,341.20	\$ 2,802.36
1	CORRECTION OFFICERS	F	\$ 9.65	\$ 22,079.20	\$ 9,341.20	\$ 2,802.36
1	CORRECTION OFFICERS	F	\$ 9.65	\$ 22,079.20	\$ 9,341.20	\$ 2,802.36
SUB TOTAL					\$ 37,364.80	\$ 11,209.44

11

TOTAL

TOTAL PERSONNEL \$ 134,409.70

10 UNIFORMS @ \$1,386.98	\$ 13,869.80
11 PHYS/PSYCH @ \$350	\$ 3,850.00
10 OFFICER EQUIP. @ \$1,001	\$ 10,010.00
1 VEHICLES @ \$24,811.79	\$ 24,811.79

GRAND TOTAL \$ 186,951.29

SUB TOTAL SHERIFF	\$ 107,616.95
SUB TOTAL JAIL	\$ 48,316.72
COUNTY BENEFITS	\$ 31,017.62

TO THE HONORABLE GIL HODGES, COUNTY EXECUTIVE, AND THE MEMBERS OF THE SULLIVAN COUNTY BOARD OF COMMISSIONERS IN Regular SESSION THIS THE 21st DAY OF December 1998.

RESOLUTION AUTHORIZING Amending the FY 1998-99 Health Department Budget in the Amount of \$42,422.85 for Central Files and Van

WHEREAS, TENNESSEE CODE ANNOTATED; SECTION _____ AUTHORIZES COUNTIES TO _____

NOW, THEREFORE BE IT RESOLVED by the Board of County Commissioners of Sullivan County, Tennessee, assembled in Regular Session on the 21st day of December 1998.

THAT WHEREAS, The State of Tennessee has provided the Health Department revenue in the amount of \$42,422.85, and

WHEREAS, The Health Department is in need of a van for handling supplies and for transportation to meetings, and

WHEREAS, The central file system is overloaded and more filing space is desperately needed,

NOW, THEREFORE BE IT RESOLVED, That the Sullivan County Board of Commissioners approves amending the FY 1998-99 Budget of the Health Department as follows:

ACCT. No. 46310-110 (Revenue) \$42,422.85

Acct. 55110-426 (Construction Supplies & Materials)	2,000.00
Acct. 55110-711 (Central Files)	10,000.00
Acct. 55110-718 (Vehicle Purchase)	20,000.00
Acct. 39000.000 (Undesignated Fund Balance)	10,422.85
TOTAL	\$42,422.85

All resolutions in conflict herewith be and the same rescinded insofar as such conflict exist.

This resolution shall become effective on _____, 19____, the public welfare requiring it.

Duly passed and approved this 18 day of January, 1999

Jeannie J. Dammann
 Jeannie J. Dammann
 County Clerk

Date: 1/18/99

County Executive

Date: _____

INTRODUCED BY COMMISSIONER Hyatt ESTIMATED COST: _____
 SECONDED BY COMMISSIONER Harr FUND: _____

Committee Action	Approved	Disapproved	Deferred	Date
Administrative				
Budget				
Executive				

Commission Action	Aye	Nay	Pass	Absent	Total
Roll Call	18	6			
Voice Vote					

COMMENTS: FIRST READING 12/21/98 APPROVED 01/18/99 ROLL CALL

TO THE HONORABLE GIL HODGES, COUNTY EXECUTIVE, AND THE MEMBERS OF THE SULLIVAN COUNTY BOARD OF COMMISSIONERS IN Regular SESSION THIS THE 18th DAY OF January 19 99.

RESOLUTION AUTHORIZING Reappointments to the Solid Waste Region Planning Board

WHEREAS, TENNESSEE CODE ANNOTATED; SECTION _____, AUTHORIZES COUNTIES TO _____

NOW, THEREFORE BE IT RESOLVED by the Board of County Commissioners of Sullivan County, Tennessee, assembled in Regular Session on the 18th day of January 19 99

THAT BE IT RESOLVED, That two members of the Sullivan County Solid Waste Region Planning Board whose terms have expired be reappointed as follows:

MEMBER:	REPRESENTING:	TERM:
Roy Settle District Conservationist USDA Soil Conservation Service	Sullivan County	6 Years
Jack Hurlbert Consulting Engineer	Sullivan County	6 Years

All resolutions in conflict herewith be and the same rescinded insofar as such conflict exist.

This resolution shall become effective on _____, 19__, the public welfare requiring it.

Duly passed and approved this 18 day of January, 19 99

Jeanie F. Lamm
Attested: _____
County Clerk

Date: 1/18/99

County Executive

Date: _____

INTRODUCED BY COMMISSIONER Blaock ESTIMATED COST: _____
SECONDED BY COMMISSIONER Ferguson FUND: _____

Committee Action	Approved	Disapproved	Deferred	Date
Administrative				
Budget				
Executive				

Commission Action	Aye	Nay	Pass	Absent	Total
Roll Call	24				
Voice Vote					

COMMENTS: Approved 01/18/99 Roll Call

0635

First
Tennessee
Development
District

207 North Boone Street, Suite 800 • Johnson City, Tennessee 37604
(423) 928-0224 • Fax (423) 928-5209

Carter
Greeneville
Washington

January 6, 1999

Greene
Blountville
Blountville
Blountville
Blountville

Executive Gil Hodges
Courthouse
P.O. Box 509
Blountville, TN 37617

Hancock
Shelbyville

Dear Gil,

Hawkins
Blountville
Blountville
Blountville
Blountville

I am writing to inform you that Roy Settles' and Jack Hurlbert's terms on the Sullivan County Regional Solid Waste Planning Board expired in November 1998. As you know this Board was established in 1991 pursuant to the Tennessee Solid Waste Management Act. State law requires that you appoint representatives to this Board which are approved by the County Commission. These two men have been serving since 1992 as representatives of Sullivan County. The Board is also comprised of representatives from Bristol, Bluff City, and Kingsport.

Johnson
Blountville

These men can be re-appointed or you may wish to appoint new representatives. In any case your appointees will serve 6 year terms as mandated by State law. Please notify me or the Board chair Leah Ross at 224-5855 when your appointments have been approved by the County Commission. These positions need to be filled as soon as possible to ensure that the Board is at full strength as we begin work on the 1999 Annual Progress Report. Please feel free to call me if you have any questions.

Sullivan
Blountville
Blountville
Blountville

Sincerely,

Christopher L. Craig

Unicol
Blountville
Blountville

Christopher L. Craig
Director of Environmental Programs

Washington
Blountville
Blountville



*Attachment
Rev# 16*

RESOLUTION NUMBER 17

TO THE HONORABLE GIL HODGES, COUNTY EXECUTIVE, AND THE MEMBERS OF THE SULLIVAN COUNTY BOARD OF COMMISSIONERS IN Regular SESSION THIS THE 18th DAY OF January 1999.

RESOLUTION AUTHORIZING Appointing Commissioner Samuel C. Jones to the Northeast Tennessee Corridor Review Commission

WHEREAS, TENNESSEE CODE ANNOTATED; SECTION _____, AUTHORIZES COUNTIES TO _____

NOW, THEREFORE BE IT RESOLVED by the Board of County Commissioners of Sullivan County, Tennessee, assembled in Regular Session on the 18th day of January 1999

THAT WHEREAS, Sullivan County and the City of Kingsport joined in passage of a private act known as the "Northeast Tennessee Corridor Overlay District Act", and

WHEREAS, Provisions of this act created a governing body known as the "Northeast Tennessee Corridor Review Commission" composed of seven members, three of whom are appointed by the County Governing Body, three appointed by the Municipal Governing Body and one which is jointly appointed by both governing bodies,

WHEREAS, Pursuant to the provisions of the Private Act, a representative of the County legislative body is required to serve on the Joint Gateway Review Commission,

NOW, THEREFORE BE IT RESOLVED, That the Sullivan County Board of Commissioners appoints Commissioner Samuel C. Jones to the Joint Gateway Review Commission; the term of office to coincide with the term of office as County Commissioner.

All resolutions in conflict herewith be and the same rescinded insofar as such conflict exist.

This resolution shall become effective on _____, 19__, the public welfare requiring it.

Duly passed and approved this 18 day of January, 1999

Jeanie J. Hammon
Attested: _____
County Clerk

Date: 1/18/99

County Executive

Date: _____

INTRODUCED BY COMMISSIONER Ferguson ESTIMATED COST: _____
SECONDED BY COMMISSIONER Williams FUND: _____

Committee Action	Approved	Disapproved	Deferred	Date
Administrative				
Budget				
Executive				

Commission Action	Aye	Nay	Pass	Absent	Total
Roll Call	22		1	1	

COMMENTS:

APPROVED 01/18/99 ROLL CALL

0637



CITY OF KINGSFORT, TENNESSEE

December 4, 1998

*attachment
Rev# 17*

Mr. Gil Hodges, Sullivan County Executive
P.O. Box 509
Blountville, TN. 37617

RE: Appointments to the Joint Gateway Review Commission

Dear Mr. Hodges:

It has come to the attention of the Joint Gateway Review Commission that Mr. Ray Conkin, previous Sullivan County Commissioner, was our appointee from the Sullivan County Commission. His term has been left unexpired and a new representative from the Sullivan County Commission is needed according to the state legislation enacting the Gateway Commission. The Joint Commission is proceeding with new Design Guidelines and expects to be in full effect by spring, 1999. Your assistance in facilitating a new appointment is greatly appreciated.

If you have any questions or need additional information, please do not hesitate to contact me at 229-9368.

Sincerely,

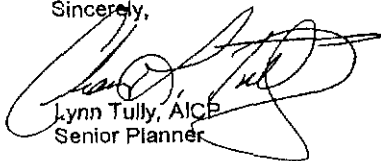
Lynn Tully, AICP
Senior Planner

appointment
Sam Jones

LT/ct

c: Jeff Fleming
Van Emery

[hodges.123]

City Hall 225 West Center Street Kingsport, TN 37660-4237 (423) 229-9400

The Model City - Built by design and planning for the future.

RESOLUTION NUMBER 24

TO THE HONORABLE GIL HODGES, COUNTY EXECUTIVE, AND THE MEMBERS OF THE SULLIVAN COUNTY BOARD OF COMMISSIONERS IN Regular SESSION THIS THE 18th DAY OF January 19 99.

RESOLUTION AUTHORIZING Clarification for Appraisal Value for Mitigation Plan

WHEREAS, TENNESSEE CODE ANNOTATED; SECTION _____, AUTHORIZES COUNTIES TO _____

NOW, THEREFORE BE IT RESOLVED by the Board of County Commissioners of Sullivan County, Tennessee, assembled in Regular Session on the 18th day of January 1999.

THAT WHEREAS, The Sullivan County Commission allocated funding for the Evergreen Ledge Mitigation; and

WHEREAS, There was some clarification needed relative to the two appraisals;

NOW, THEREFORE BE IT RESOLVED, That an offer to purchase property be presented on any adjusted appraisal value, providing that any offer does not over-run the Count's original appropriation.

WAIVER OF RULES REQUESTED

All resolutions in conflict herewith be and the same rescinded insofar as such conflict exist.

This resolution shall become effective on _____, 19__, the public welfare requiring it.

Duly passed and approved this ____ day of _____, 19__.

Attested: _____ Date: _____ Date: _____
County Clerk County Executive

INTRODUCED BY COMMISSIONER Gonce ESTIMATED COST: _____
SECONDED BY COMMISSIONER Blalock/Patrick/Vance FUND: _____

Committee Action	Approved	Disapproved	Deferred	Date
Administrative				
Budget				
Executive				

Commission Action	Aye	Nay	Pass	Absent	Total
Roll Call					
Voice Vote					

COMMENTS: WITHDRAWN 01/18/99

TO THE HONORABLE GIL HODGES, COUNTY EXECUTIVE, AND THE MEMBERS OF THE SULLIVAN COUNTY BOARD OF COMMISSIONERS IN REGULAR SESSION THIS THE 18 DAY OF JANUARY, 1999.

RESOLUTION AUTHORIZING JAIL CONSTRUCTION.

WHEREAS, TENNESSEE CODE ANNOTATED; AUTHORIZES COUNTIES TO

NOW, THEREFORE BE IT RESOLVED by the Board of County Commissioners of Sullivan County, Tennessee assembled in Regular Session on the 18 day of January, 1999;

WHEREAS: the Jail has experienced considerable problems with overcrowding and

WHEREAS: this Commission approved Public Building Obligations to finance construction at the Jail, and

WHEREAS: the Engineering firm has submitted plans to relieve the present overcrowding problem and begin the first phase of construction.

THEREFORE, BE IT RESOLVED THAT bids be advertised for the first phase of construction, and

THAT funding for this phase not to exceed \$5,550,000 be approved.

All resolutions in conflict herewith be and the same rescinded insofar as such conflict exist.

This resolution shall become effective on _____, the public welfare requiring it.

Duly passed and approved this 18 day of January, 1999.

Jeanette J. Hammond
County Clerk

County Executive

Date: _____

INTRODUCED BY COMMISSIONER WILLIAMS ESTIMATED COST: _____
SECONDED BY COMMISSIONER HARR FUND: _____

Committee Action	Approved	Disapproved	Deferred	Date
Administrative				
Budget				
Executive				

Commission Action	Aye	Nay	Pass	Absent	Total
Roll Call	23			1	
Voice Vote					

COMMENTS: APPROVED 01/18/99 ROLL CALL

1/17/99 9:00 PM

AND THEREUPON COUNTY COMMISSION ADJOURNED
UPON MOTION MADE BY COMM. MAYES AND SECONDED BY
COMM. VANCE TO MEET AGAIN IN REGULAR SESSION ON
FEBRUARY 15, 1999.

GIL HODGES
COMMISSION CHAIRMAN

